

RESERVE ACTION SHEET - CONSERVATION RESERVES

RESERVE No. 13603

REASON FOR ACTION

Amendment to the purpose and vesting of reserve 27230 from "Water" (unvested) to "Conservation of Flora and Fauna" (Conservation Commission).

Area: 26.1 hectares

Reserve 13603 comprises a number of very healthy communities of vegetation that are poorly represented on conservation reserves in the Wheatbelt. The remnant vegetation on reserve 13603 differs from the types of vegetation that occur on conservation reserves near by (10 km and 12 km away). Furthermore, the reserve contains mature trees that provide nesting opportunities and shelter for birds and mammals.

- Date of DOLA's advice: 26 February 2001 See folio: 24
- Plans at folios: 23 & 25.

OFFICER	ACTION	
1 CONSERVATION ^{HV} ESTATE OFFICER	- Fill in above details - Attach copies of DOLA's advice to file Send copies of advice & maps to: - Lisa Wright, Woodvale - District Manager, Narrogin - Regional Manager, Wheatbelt Recommended IUCN classification:	_____ ✓ _____ ✓ _____ ✓ _____ ✓ _____ ✓ _____ 1a
2 LAND ACQUISITIONS OFFICER	To note:	_____
3 MANAGER, PLANNING & VISITOR SERVICES	To note & approve IUCN classification:	_____
4 DIRECTOR, NATURE CONSERVATION/ NATIONAL PARKS	To note:	_____
5 INDEX CLERK, RECORDS	To note:	_____
6 CONSERVATION ESTATE OFFICER	Ensure that relevant papers are attached to new file and attach copy of Reserve Details to inside cover of new file	_____

**Customer Advices for Reserve Actions
1/09/2001 - 30/09/2001**

Shire of Kulin 1/09/2001 - 30/09/2001

Reserve No.	Land Description	DOLA File No.	Volume/Folio	Action	Document No.	Registered	Street Name	Area	Public Plans
13602	Williams Location 10345 on Deposited Plan 27568	02415-1987-01RO	3084-194	Amendment of Reserve to To comprise Williams Location 10345 on Land Administration Plan Williams 609 with the area being reduced (recalculated) to 61.4285 hectares accordingly.	H678294	26/02/2001	Jilakin Flat Rocks Road	61.3706 Ha	Jilakin (50)
13603		02357-1987-01RO	3084-193	Management Order to Conservation Commission of Western Australia Cnr Hackett Drive and Australia II Drive, Crawley, Western Australia 6009 To be utilised for the designated purpose only for the designated purpose of "Conservation of Flora and Fauna"	H678301	26/02/2001	Dandagin Road	26.0256 Ha	Jilakin (50)
13603	Williams Location 10340	02357-1987-01RO	3084-193	Change of Purpose to "Conservation of Flora and Fauna"	H678300	26/02/2001	Dandagin Road	26.0256 Ha	Jilakin (50)
21745	Williams Location 13548	00200-1937-01RO	3111-165	Change of Purpose to "Conservation of Flora and Fauna"	H670824	16/02/2001	Jitarning Road West	62.2274 Ha	Harrismith NE 1:25000
21745	Williams Location 13548	00200-1937-01RO	3111-165	Amendment of Reserve to To comprise Williams Location 13548 on Land Administration Diagram 93951 with its area being increased to 62.2274 hectares accordingly	H670822	16/02/2001	Jitarning Road West	62.2274 sqm	Harrismith NE 1:25000
21745		00200-1937-01RO	3111-165	Management Order to Conservation Commission of Western Australia of corner of Hackett Drive and Australia II Drive, Crawley, Western Australia 6009 To be utilised for the designated purpose only for the designated purpose of "Conservation of Flora and Fauna"	H803352	06/07/2001	Jitarning Road West	62.2274 Ha	Harrismith NE 1:25000

↑ 21745 { TENIS d base amended (WBR/Narogin - now NR)
 ↑ 13603 { - white folder

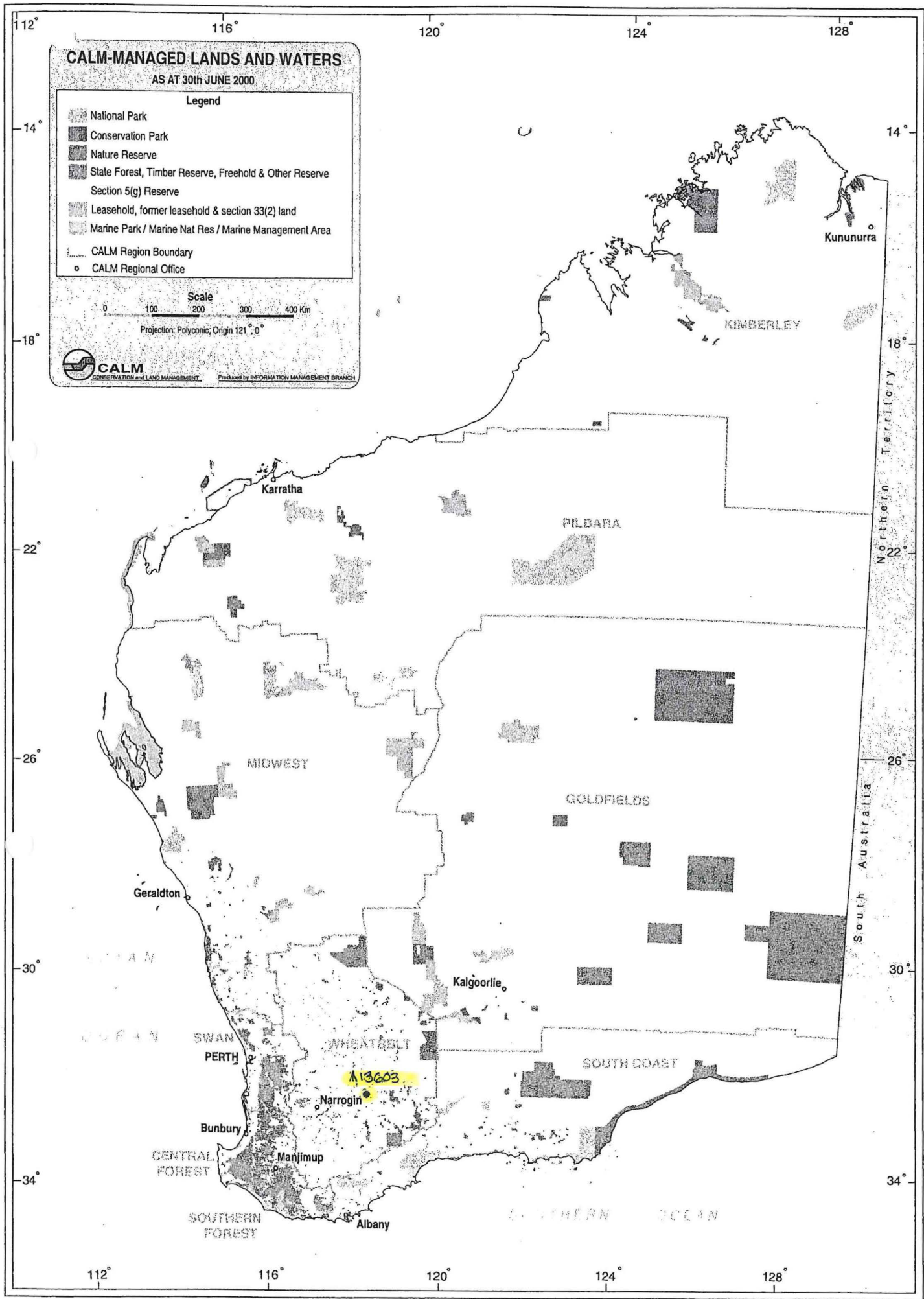

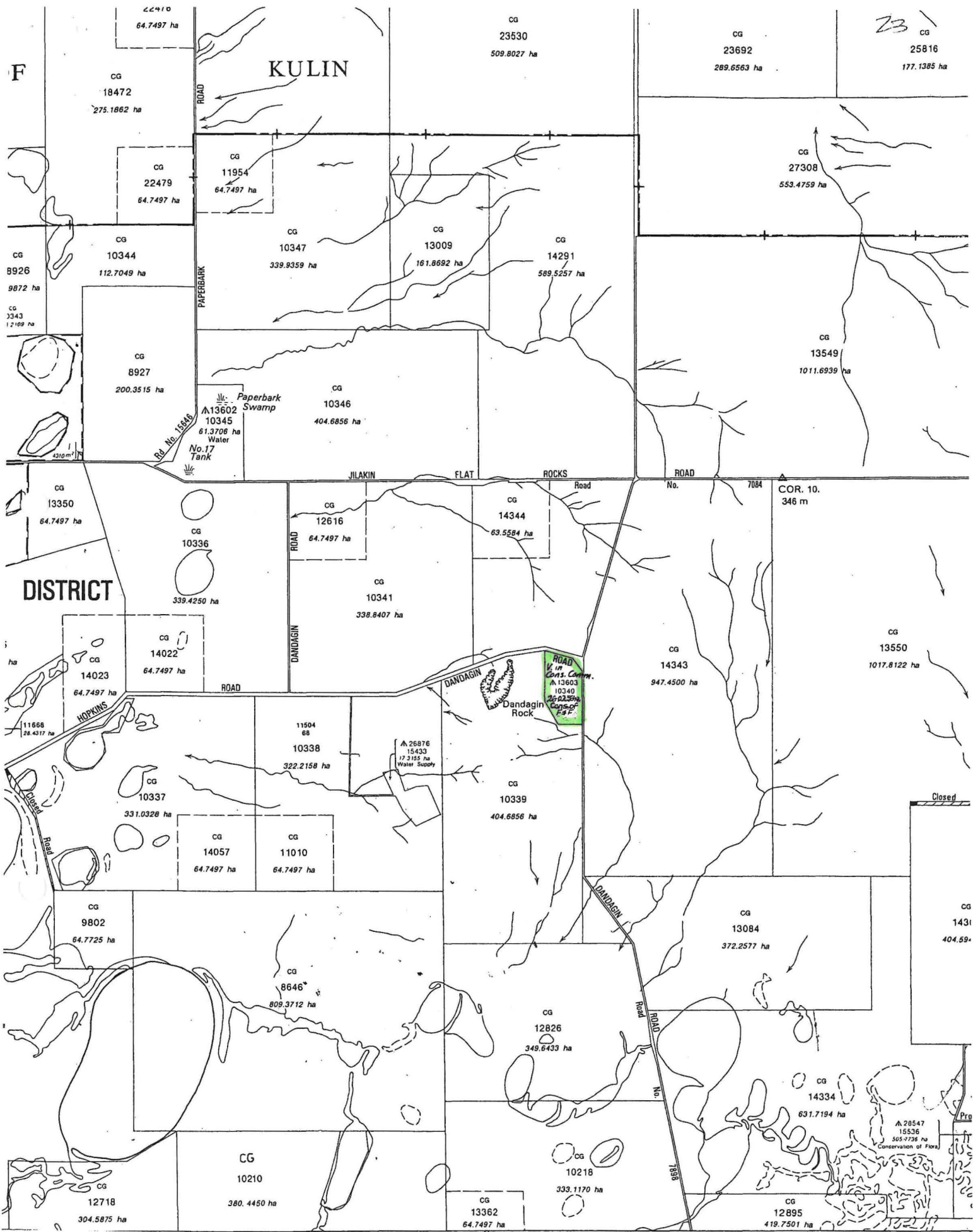

PART DOLA PLAN
 JILAKIN (2532-1)

SCALE 1:50 000

The representation on this map of any road or track is not necessarily a guarantee of public right of way

JILA