

NAMING OF RESERVES

Department of Land Administration,
Perth, 19 December 1986.

Corres. No. 3583/981.

IT is hereby notified for general information that the Reserves listed in the Schedule hereunder are by this Notice, named in accordance with the said Schedule.

- Reserve No; Reserve Name; Public Plan
- 22262; Wundowlin Nature Reserve; Mukinbudin 1:50 000.
31715; Barbalin Nature Reserve; Mukinbudin 1:50 000.
13051; Calcaling Nature Reserve; Calcaling 1:50 000.
30705; South Wilgoyne Nature Reserve; Calcaling 1:50 000.
31629; Cookinbin Nature Reserve; Nungarin 1:50 000.
23835; Karloning Nature Reserve; Karloning 1:50 000.
29303; North Bonnie Rock Nature Reserve; Blain 1:50 000.
20530; Portion of Joverdine Nature Reserve; Bonnie Rock 1:50 000.
37034; Portion of Joverdine Nature Reserve; Bonnie Rock 1:50 000.
36526; Lake Cronin Nature Reserve; Lake Cronin 1:50 000.
A17186; Walyormouring Nature Reserve; Botherling S.W. & S.E.
A4313; Eaton Nature Reserve; Quelagetting 1:50 000.
14510; Hindmarsh Nature Reserve; Quelagetting 1:50 000.
A9228; Moonijin Nature Reserve; Cadoux S.E.
15794; Cullimbin Nature Reserve; Cadoux N.E.
10991; Carrimbin Rock Nature Reserve; 33/80.
21719; Wallambin Nature Reserve; Yelbeni 1:50 000.
10992; Elashgin Nature Reserve; Bulagin 1:50 000.
23887; Wyalkatchem Nature Reserve; Wyalkatchem 1:10 000 5.6 & 5.7.
34385; Nembudding Nature Reserve; Yelbeni 1:50 000.
15386; Yelbeni Nature Reserve; Yelbeni Townsite.
35413; Walcancobbing Nature Reserve; Trayning 1:50 000.
15570; East Wallambin Nature Reserve; Lake Wallambin S.E.
20986; Marindo Nature Reserve; Beacon 1:50 000.
22457; North Beacon Nature Reserve; Beacon 1:50 000.
26911; Beebeegnying Nature Reserve; Gabbing 1:50 000.
17923; Mungarri Nature Reserve; Beacon 1:50 000.
24539; Herndermuning Nature Reserve; Beacon 1:50 000.
35679; Danjinning Nature Reserve; Karloning 1:50 000.
12689; Wiacubbing Nature Reserve; Bencubin 1:50 000.
26687; North Wallambin Nature Reserve; Lake Wallambin S.E.
24789; Lake Champion Nature Reserve; 35/80.
23339; Elachbutting Nature Reserve; 67/80.
23338; Geeraning Nature Reserve; 67/80.
16235; Carrabin Nature Reserve; Carrabin Townsite.
1431; Baladjie Nature Reserve; 53/80, 54/80.
A35732; Walyahmoning Nature Reserve; Waroona Townsite.
24465; Yanneymooning Nature Reserve; 54/80.
25194; Anderson Lake Nature Reserve; Toolbrunup S.E.
26162; Three Swamps Nature Reserve; Toolbrunup S.E.
30526; East Balicup Nature Reserve; Toolbrunup S.W.
26381; McDougall Nature Reserve; Merilup S.E.
9237; Portion of Snake Gully Nature Reserve; 88/80, 89/80.
10351; Portion of Snake Gully Nature Reserve; 88/80, 89/80.
36448; Portion of Snake Gully Nature Reserve; 89/80.
27283; Goodlands Nature Reserve; Kalannie 1:50 000.
26259; Carlyarn Nature Reserve; Karrakutta 1:50 000.
18381; Sawyers Nature Reserve; Kalannie 1:50 000.
19650; Old Store Nature Reserve; Kalannie 1:50 000.
33803; Milyu Nature Reserve; Perth 1:2 000 12.21, 12.22, 13.21, 13.22.
16867; Dukin Nature Reserve; Koorda S.E.
24838; Walk Walkin Nature Reserve; Koorda S.W.
9281; Portion of Warramuggan Nature Reserve; Koorda S.E.
16040; Portion of Warramuggan Nature Reserve; Koorda S.E.
4670; Nembudding South Nature Reserve; Yelbeni S.W.
12398; Lake Mears Nature Reserve; Quairading S.W.
36063; Strange Road Nature Reserve; Luptons S.W., S.E.
19740; Bartram Nature Reserve; Luptons S.E.
36519; Pingeculling Nature Reserve; Brookton S.W.
36742; Brookton Highway Nature Reserve; Luptons S.E.
8830; Bulgin Nature Reserve; Cunderdin 1:50 000.
10313; Noonying Nature Reserve; 26C/40.
23566; Tammin Nature Reserve; 26C/40.
17732; North Bungulla Nature Reserve; Kellerberrin 1:50 000.
4667; Lundy Nature Reserve; 26B/40.
24831; Wyola Nature Reserve; 26C/40.
28289; Moulien Nature Reserve; 3B/40.
33990; Bungulla Nature Reserve; Bungulla Townsite.
21153; Morranoppin Nature Reserve; Doodlakine 1:50 000.
22921; Durokoppin Nature Reserve; Kodjikooin 1:50 000.
12329; North Bandee Nature Reserve; Kodjikooin 1:50 000.
24897; Mournucking Nature Reserve; Kellerberrin 1:50 000.
25112; Portion of Glenluce Nature Reserve; Pantapin 1:50 000.
26266; Portion of Glenluce Nature Reserve; Pantapin 1:50 000.
30903; Craig Nature Reserve; Pantapin 1:50 000.
5456; Dead Mans Swamp Nature Reserve; Hillman S.E. Moodiarup N.E.
25904; Boolading Nature Reserve; Boolading Townsite.
16904; Hillman Nature Reserve; Hillman N.W.
21521; Williams Nature Reserve; Williams N.E.
29313; Borgey Nature Reserve; Highbury N.W. Williams N.E.
32448; Moorapulling Nature Reserve; Dwarda S.W.
30563; Moomagul Nature Reserve; Dattening N.W.
19784; Haddleton Springs Nature Reserve; Blackwood River N.W., S.W.
29322; Weam Nature Reserve; Brookton S.W., N.W.
31913; Haddleton Nature Reserve; Blackwood River N.W., N.E.
13373; Benjabbering Nature Reserve; Benjabbering Townsite.
15895; Folly Nature Reserve; Yorkrakine 1:50 000.
14920; Dingo Well Nature Reserve; Wyalkatchem 1:50 000.
13242; Gabwotting Nature Reserve; Wyalkatchem 1:50 000.
A23756; Portion of Kooljerrenup Nature Reserve; Lake Clifton N.E.
36126; Portion of Kooljerrenup Nature Reserve; Lake Clifton N.E.
B4990; Portion of Austin Bay Nature Reserve; Mandurah 1:10 000, 2.7.
B24036; Portion of Austin Bay Nature Reserve; Pinjarra N.W.
28087; Portion of Austin Bay Nature Reserve; Mandurah S.E., N.E. Pinjarra S.W., N.W.
24739; McLarty Nature Reserve; Mandurah 1:10 000, 1.5.
33749; Boodalan Nature Reserve; Mandurah 1:10 000, 2.7.
16907; Nine Mile Lake Nature Reserve; Pinjarra S.W.
22199; Buller Nature Reserve; Hamel N.W., S.W.
12049; Harvey Flats Nature Reserve; Hamel S.W.
12632; Riverdale Nature Reserve; Hamel S.W.
24472; Crampton Nature Reserve; Lake Preston N.E., N.W.
22797; Falls Brook Nature Reserve; Harvey N.E. Tallanalla N.W.
34811; Benger Swamp Nature Reserve; Harvey S.W.
1740; Wild Horse Swamp Nature Reserve; Blackwood River S.E.
24917; Tawerring Nature Reserve; Moddiarup N.W.
30668; Arthur River Nature Reserve; East Arthur N.W. Hillman N.E.
7349; Jandabup Nature Reserve; Swan 1:10 000, 3.2.
A31048; Portion of Lake Joondalup Nature Reserve; Swan 1:10 000, 2.2.
A21708; Portion of Lake Joondalup Nature Reserve; Swan 1:10 000, 2.2.
30809; Woodvale Nature Reserve; Swan 1:2 000, 8.03, 8.04, 9.04.
25919; Copley Dale Nature Reserve; Swan 1:10 000, 6.3.
30667; Beechina Nature Reserve; 3B/40.

Records *3* LAND CLERK *21-7-88*
Please ensure that title of list is correct

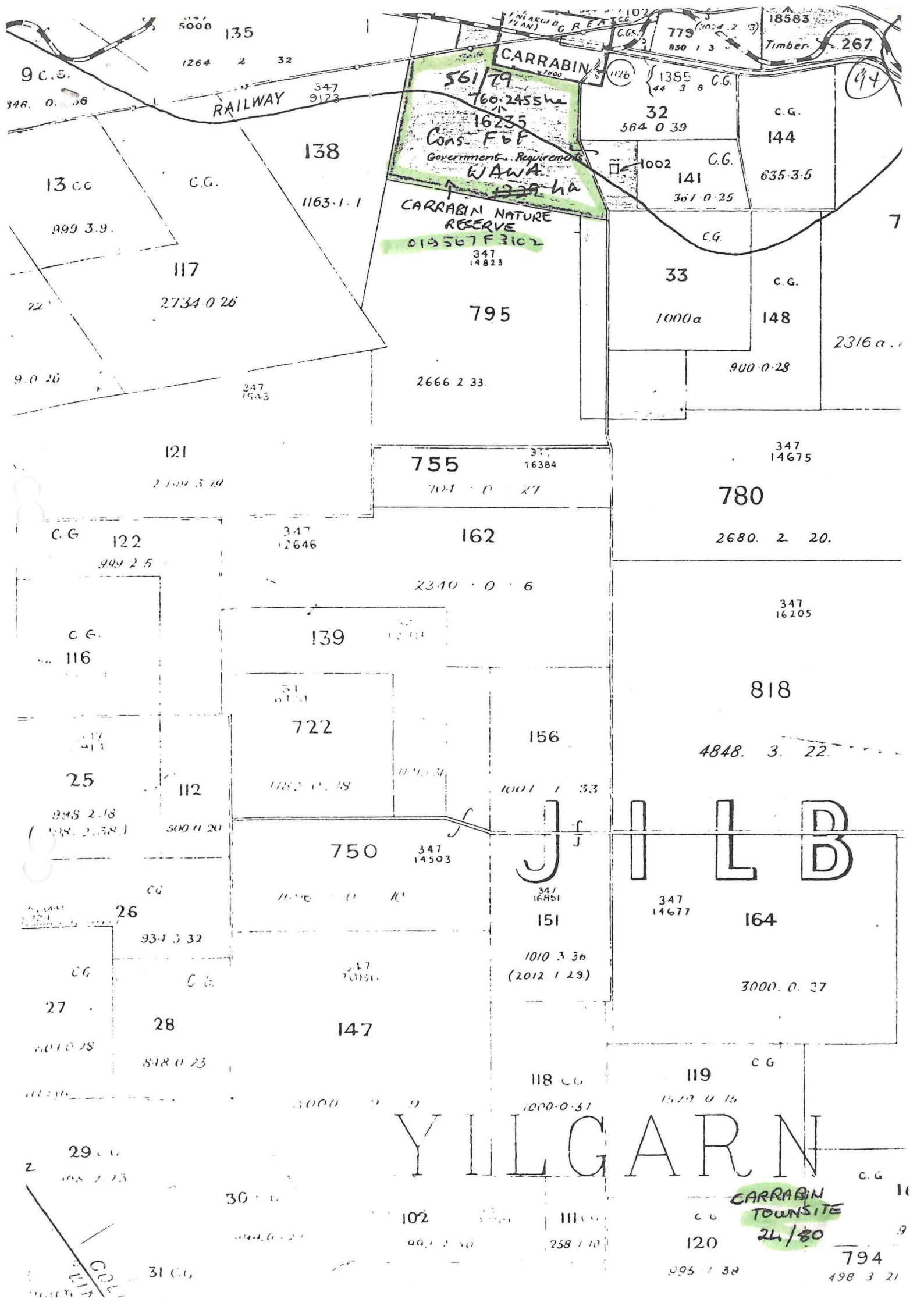

RAILWAY

CARRABIN

CARRABIN NATURE RESERVE

Cons. F&P
Government Requirements
WAWA

YILGARN

CARRABIN TOWNSITE 24/80

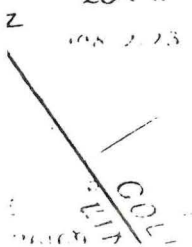

5008 135

1264 2 32

347 9123

779 (300.2.3) 18583
830 1 3 Timber 267

561/79
760.245ha
16235
Cons. F&P
Government Requirements
WAWA

1126 { 1385
44 3 8 C.G.
32
564 0 39

c.g.
144
635.3.5

C.G.

138

1163.1.1

1002 C.G.
141
361 0 25

C.G.

33

C.G.

148

2316 a...

795

1000a

900 0 28

2666 2 33

121

2739 3 10

755

347 16384

701 0 27

347 14675

780

2680. 2 20.

C.G. 122
999 2 5

347 12646

162

2340 0 6

347 16205

818

4848. 3. 22.

139

1271

722

156

1001 1 33

J I L B

750

347 14503

347 16851
151

347 14677

164

1010 3 36
(2012. 1 29)

3000. 0. 27

26

934 3 32

347 70351

27

28

147

118 C.G.

119 C.G.

1000 0 37

1529 0 15

29 C.G.
108 2 23

30 C.G.

102

113 C.G.

C.G.

120

794

31 C.G.

99.2 2 50

258 1 10

995 1 38

498 3 21

W 561/79 MAPPING

87



DEPARTMENT OF LANDS AND SURVEYS

Cathedral Avenue,
Perth,
Western Australia 6000

24/80 ✓
Don't understand
what has to be
done.

Department of Conservation
and Land Management
- 8 MAY 1986
COMO, W.A.

Your Ref. 561/79 DH:AH
Our Ref. 2830/985 CN:LF
Telephone Enquiries 3231278

EXECUTIVE DIRECTOR
DEPARTMENT OF CONSERVATION AND
LAND MANAGEMENT

CARRABIN NATURE RESERVE NO 16235 PROPOSED 50B STATION SEC

I refer to your memo of October 24, 1985 and advise for your information that Executive Council has:

1. approved of the amendment of Reserve No. 16235 (Jilbadji Locations 983 and 984) "Conservation of Flora and Fauna" to exclude that portion of Location 984 now comprised in Jilbadji Location 1002 and of its area being reduced to 760.2455 hectares.
2. approved of Jilbadji Location 1002 being set apart as Reserve No 39430 for the purpose of "Sub Station Site (State Energy Commission)" and issued an Order in Council directing that Reserve No 39430 for the purpose of "Sub Station Site (State Energy Commission)" and issued an Order in Council directing the Reserve No 39430 (Jilbadji Location 1002) shall vest in and be held by the State Energy Commission of Western Australia in trust for the purpose of "Sub Station Site (State Energy Commission)".

Notice to this effect was published in the Government Gazette of April 18, 1986 and I enclose a print showing the said amendment.

Carrabin Township) - NO.
24/80 E1

B. J. O'Meara
UNDER SECRETARY FOR LANDS

Yf 8.10.86

May 7, 1986

1. Mr. Hampton noted
2. S.C. RESERVES (see 4.85 also. DH)
MS

A 16235
984
Res. Plan 197

AMENDMENTS

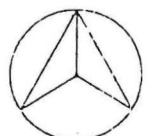
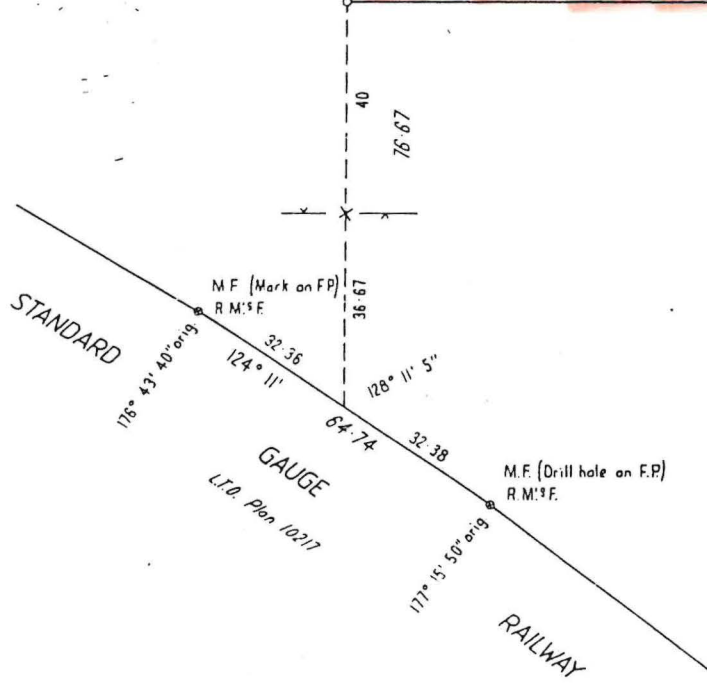
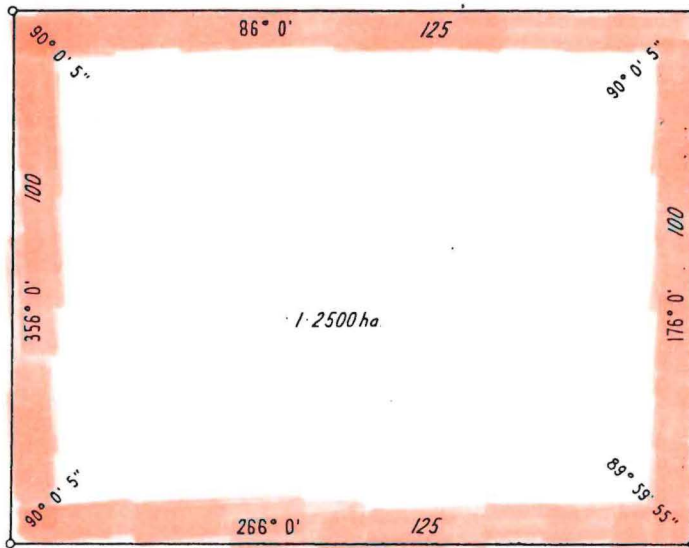

LAND DISTRICT JILBADJI		LOCATION 1002		FILE No. 2030/985
				SCALE 1:1000 REDUCED All measurements in metres
SURVEYOR'S CERTIFICATE I hereby certify that this survey was performed by me personally (or under my personal supervision, inspection and field check), in strict accordance with the Licensed Surveyors (Guidance of Surveyors) Regulations. Licensed Surveyor Date		Azimuth observed at or assumed from Date of marking 1-12-1985 Surveyor W.P. STEWART Field Book No. 42 Page 6-8 Cadastral Plan 24/80 Reference E1 Diagram Drawn N. PALLOTTA Date 21-1-86		Calc. Bk. No. Fol. Compared with F.B. <i>B.A. Roy</i> Examined <i>B.A. Roy</i> 27-2-86 Diagram passed Inspector of Plans and Surveys Date
				SURVEY APPROVED Date Surveyor General Recorded on Public Plan Registered On Key Plan 24/80 <i>N. Palotta</i> Custodian of Plans 1.1986 DEPT. OF LANDS AND SURVEYS DIAGRAM No 87788

NATURE RESERVE

RESERVE NO: 16235

GOVERNMENT GAZETTE
Date Page No.

FILE NUMBER: 561/79 1148/980

PURPOSE: Cons. of Flora & Fauna

15.7.83

2541

NAME:

CLASS (Land Act):

AREA: 761.4955 ha

15.7.83

2541

VESTING: W.A.W.A.

LOCATION NO(S): Jilbaji Loc 983, 984

CLASSIFICATION:
(Wildlife Act
Section 12A)

LITHO: 24/80 (Near Carrabin Townsite)

LOCAL AUTHORITY: Westonia

Notes: