

File No. 1487/1969
Ex. Co. No. 1119

LOCAL GOVERNMENT ACT 1960
PUBLIC WORKS ACT 1902
LAND RESUMPTION

Road Widening—Smerdon Road—Road No. 18523—Shire of Lake Grace

Notice is hereby given, and it is hereby declared, that pursuant to a resolution of the Shire of Lake Grace passed at a meeting of the Council held on or about January 1992 the piece or parcel of land described in the Schedule hereto, being in the Roe District has, in pursuance of the written approval and consent of His Excellency the Governor, acting by and with the advice of the Executive Council, dated the Nineteenth day of July 1994, been set apart, taken or resumed for the purpose of the following public work, namely:—Road Widening—Smerdon Road—Road No. 18523—Shire of Lake Grace.

And further notice is hereby given that the said piece or parcel of land so set apart, taken, or resumed is marked off and more particularly described on Department of Land Administration Diagram 91314 which may be inspected at the Department of Land Administration, Midland. The additional information contained in the Schedule after the land descriptions is to define locality only and in no way derogates from the Transfer of Land Act description. And it is hereby directed that the said lands shall vest in Her Majesty for an estate in fee simple in possession for the public work herein expressed, freed and discharged from all trusts, mortgages, charges, obligations, estates, interests, rights-of-way or other easements whatsoever.

Schedule

Owner or Reputed Owner	Occupier or Reputed Occupier	Description	Area (approx.)
Brandenburg Nominees Pty. Ltd.	Brandenburg Nominees Pty. Ltd.	Portion of Roe Location 1593 being the land contained in Certificate of Title Volume 1498 Folio 618.	1.2114 ha

Certified correct this 11th day of July 1994.

GEORGE CASH, Minister for Lands.

Dated this 19th day of July 1994.

MICHAEL JEFFERY, Governor in Executive Council.

File No. 1487/1969
Ex. Co. No. 1119

LOCAL GOVERNMENT ACT 1960
PUBLIC WORKS ACT 1902
LAND RESUMPTION

Road Widening—Smerdon Road—Road No. 18523—Shire of Lake Grace

Notice is hereby given, and it is hereby declared, that pursuant to a resolution of the Shire of Lake Grace passed at a meeting of the Council held on or about January 1992 the several pieces or parcels of land described in the Schedule hereto, being all in the Roe District have, in pursuance of the written approval and consent of His Excellency the Governor, acting by and with the advice of the Executive Council, dated the Nineteenth day of July 1994, been set apart, taken or resumed for the purpose of the following public work, namely:—Road Widening—Smerdon Road—Road No. 18523—Shire of Lake Grace.

And further notice is hereby given that the said pieces or parcels of land so set apart, taken, or resumed are marked off and more particularly described on Department of Land Administration Diagram 91314 which may be inspected at the Department of Land Administration, Midland. The additional information contained in the Schedule after the land descriptions is to define locality only and in no way derogates from the Transfer of Land Act description. And it is hereby directed that the said lands shall vest in Her Majesty for the public work herein expressed, freed and discharged from all trusts, mortgages, charges, obligations, estates, interests, rights-of-way or other easements whatsoever.

CLERK, WOODVILLE - F.Y.I.

3228

Schedule

Owner or Reputed Owner	Occupier or Reputed Occupier	Description	Area (approx.)
Crown	National Parks and Nature Conservation Authority (vestee).	Portion of Roe Location 3099 set aside as Reserve 29860 for the purpose of Conservation of Flora and Fauna.	1.4964 ha

Certified correct this 11th day of July 1994.

GEORGE CASH, Minister for Lands.

Dated this 19th day of July 1994.

MICHAEL JEFFERY, Governor in Executive Council.

File No. 1485/1901/2
Ex. Co. No. 1120

LOCAL GOVERNMENT ACT 1960

PUBLIC WORKS ACT 1902

LAND RESUMPTION

Road Widening—Lowood Road—Road No. 1063—Shire of Plantagenet

Notice is hereby given, and it is hereby declared, that pursuant to a resolution of the Shire of Plantagenet passed at a meeting of the Council held on or about March 22, 1994 the piece or parcel of land described in the Schedule hereto, being in the Plantagenet District has, in pursuance of the written approval and consent of His Excellency the Governor, acting by and with the advice of the Executive Council, dated the Nineteenth day of July 1994, been set apart, taken or resumed for the purpose of the following public work, namely:—Road Widening—Lowood Road—Road No. 1063—Shire of Plantagenet.

And further notice is hereby given that the said piece or parcel of land so set apart, taken, or resumed is marked off and more particularly described on Department of Land Administration Diagram 91945 which may be inspected at the Department of Land Administration, Midland. The additional information contained in the Schedule after the land description is to define locality only and in no way derogates from the Transfer of Land Act description. And it is hereby directed that the said land shall vest in Her Majesty for the public work herein expressed, freed and discharged from all trusts, mortgages, charges, obligations, estates, interests, rights-of-way or other easements whatsoever.

Schedule

Owner or Reputed Owner	Occupier or Reputed Occupier	Description	Area (approx.)
Crown	Shire of Plantagenet (as vestee)	Portion of Mount Barker suburban Lots 123 and 170 set aside as Reserve 7694 for the purpose of "Hall Site Parking Area".	379 m ²

Certified correct this 11th day of July 1994.

GEORGE CASH, Minister for Lands.

Dated this 19th day of July 1994.

MICHAEL JEFFERY, Governor in Executive Council.

Road Dedication

It is hereby notified that the Minister for Lands has approved, pursuant to section 288 of the Local Government Act, the dedication as public street the roads in the various Municipalities as described in the abovementioned resumption notices.

By Order of the Minister for Lands.

Dated this 12th day of August 1994.

A. A. SKINNER, Chief Executive.

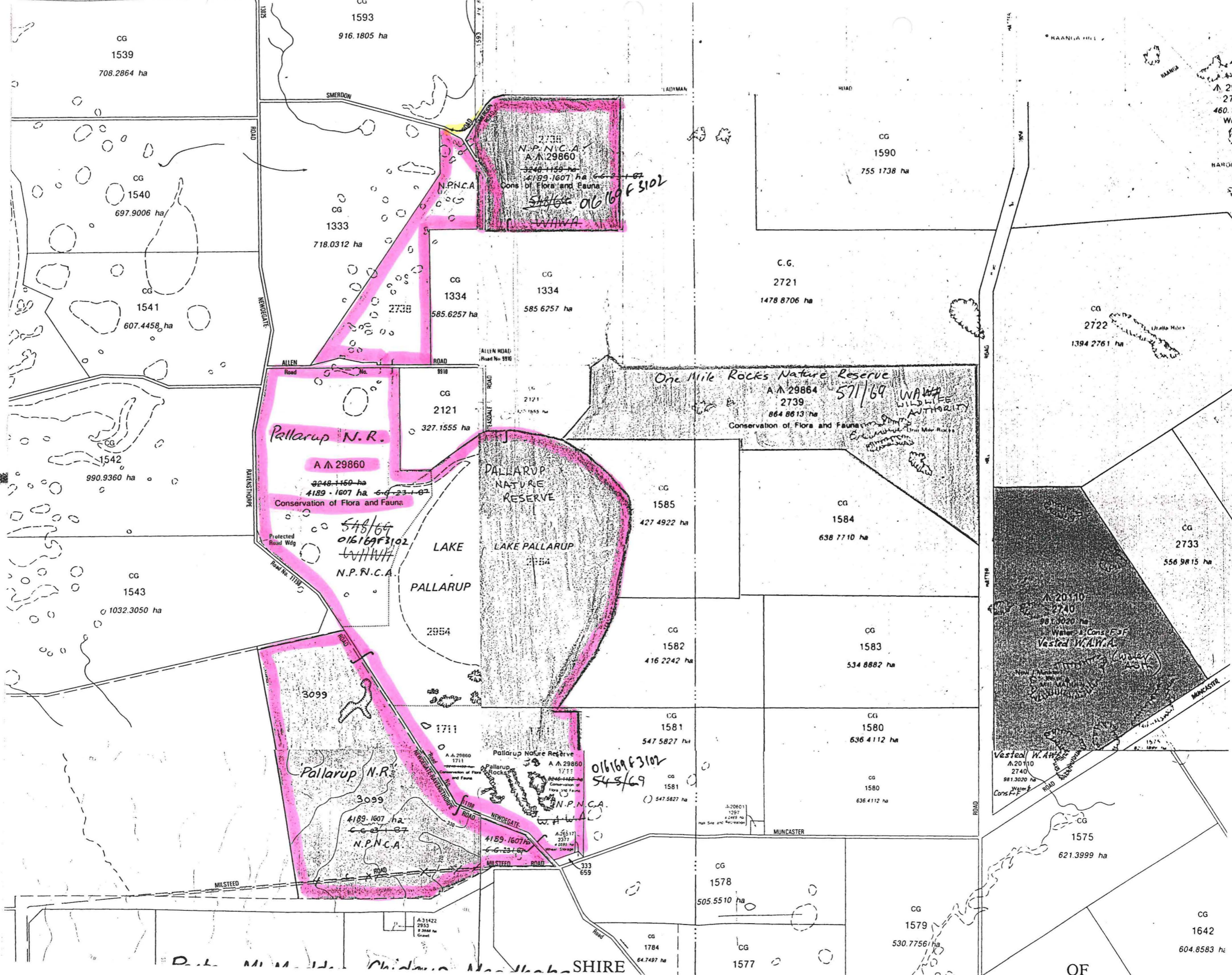

CG
1539
708.2864 ha

CG
1593
916.1805 ha

CG
1540
697.9006 ha

CG
1333
718.0312 ha

2738
N.P.N.C.A.
A.A. 29860
3248.1150 ha
4189.1607 ha
Cons. of Flora and Fauna
548/69 016169 F 3102
W.A.W.A.

CG
1590
755.1738 ha

CG
1541
607.4458 ha

CG
1334
585.6257 ha

CG
1334
585.6257 ha

C.G.
2721
1478.8706 ha

CG
2722
1394.2761 ha

CG
1542
990.9360 ha

Pallarup N.R.
A.A. 29860
3248.1150 ha
4189.1607 ha
Conservation of Flora and Fauna
548/69 016169 F 3102
W.A.W.A.
N.P.N.C.A.

PALLARUP
NATURE
RESERVE

One Mile Rocks Nature Reserve
A.A. 29864
2739
864.8613 ha
Conservation of Flora and Fauna
571/69 W.A.W.A.
WILDLIFE
AUTHORITY

CG
1543
1032.3050 ha

LAKE
PALLARUP

CG
1585
427.4922 ha

CG
1584
638.7710 ha

CG
2733
556.9815 ha

A.A. 20110
2740
981.3020 ha
Water & Cons. F.F.
Vested W.A.W.A.
W.A.W.A.
A.A. 20110
2740
981.3020 ha
Water & Cons. F.F.

3099

CG
1582
416.2242 ha

CG
1583
534.8882 ha

Pallarup N.R.
A.A. 29860
1711
Conservation of Flora and Fauna
3099
4189.1607 ha
N.P.N.C.A.

Pallarup Nature Reserve
A.A. 29860
1711
Conservation of Flora and Fauna
N.P.N.C.A.

016169 F 3102
548/69

CG
1581
547.5827 ha

CG
1580
636.4112 ha

CG
1575
621.3999 ha

MILSTEED

MILSTEED ROAD

CG
1578
505.5510 ha

CG
1579
530.77561 ha

CG
1642
604.8583 ha

SHIRE

OF

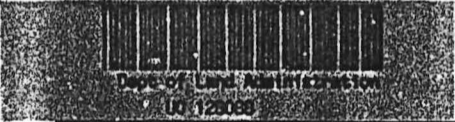
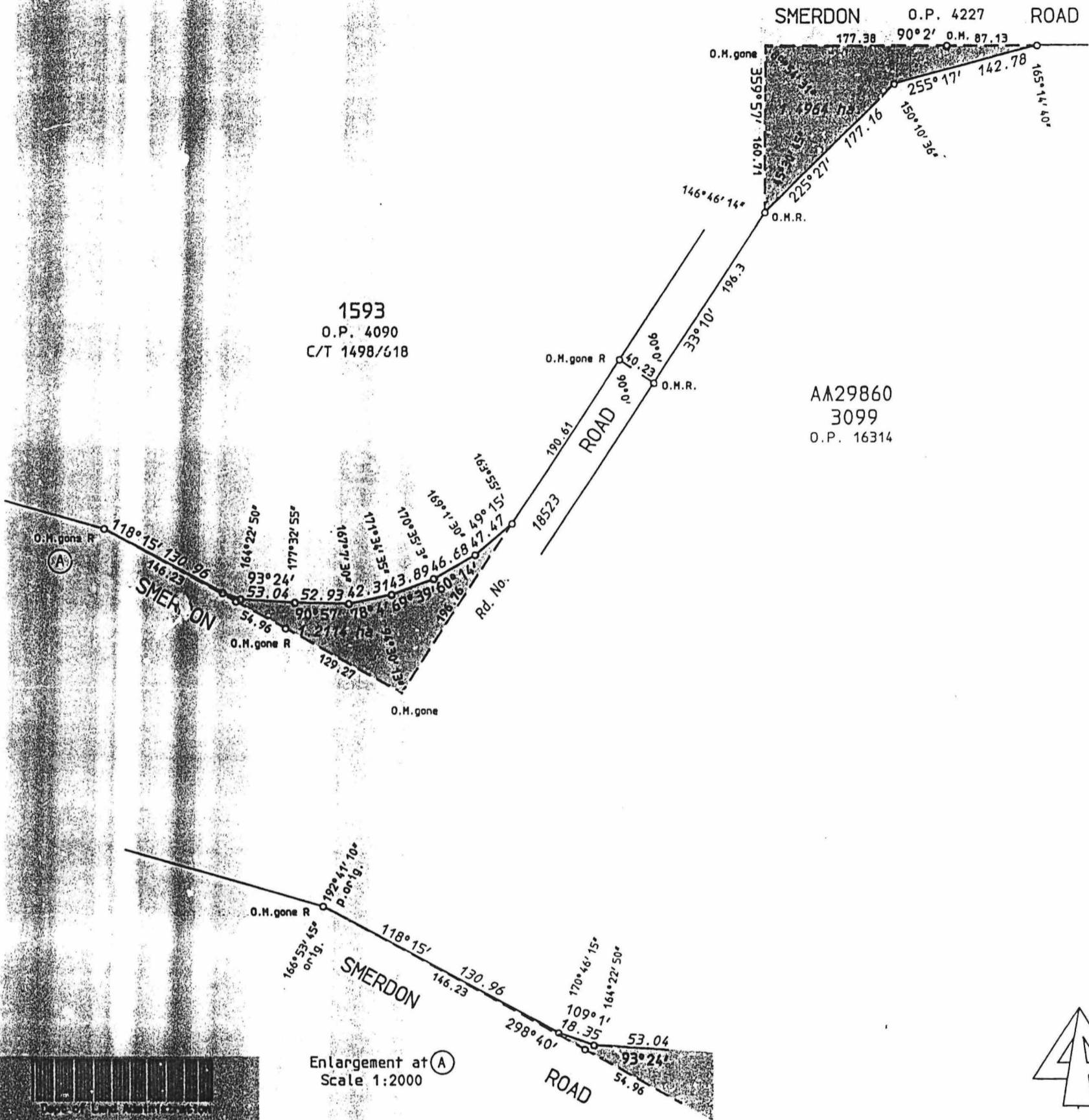

Enlargement at (A)
Scale 1:2000



LAND DISTRICT ROE		ROAD WIDENINGS EX LOCATIONS 1593 & 3099			
SURVEYOR'S CERTIFICATE <small>I hereby certify that:- (a) this plan of survey is a correct and accurate representation of the survey carried out by me personally / under my own personal supervision, inspection and field check and recorded in Fieldbooks lodged for the purpose of this plan of survey; (b) the measurements are in strict accordance with the Licensed Surveyors' Evidence of Surveyors' Regulations 1967 and in particular regulations 23 and 34 of those regulations; and (c) this survey and this plan of survey are in strict accordance with the requirements of the Licensed Surveyors' Evidence of Surveyors' Regulations 1967 and the relevant law in relation to which it is lodged.</small>			SCALE 1:4000		FILE 1487/969
Licensed Surveyor _____ Date _____ <small>(to strike out which ever does not apply)</small>			measurements in metres SURVEYOR F.H.BRAY FIELD BOOK 101 Page 5-10 Date of Marking 25.7.93		PUBLIC PLANS MOUNT MADDEN (50) LAKE KING (50) INDEX PLANS MOUNT MADDEN (50) LAKE KING (50)
Prepared by: P. BROEKEULEN		In order for certification _____ Date _____		AZIMUTH FROM OBS ON O.P. 4090 RECORDED ON KEY PLAN INDEX PLAN MOUNT MADDEN (50) LAKE KING (50)	
Examined <u>P. Broekeulen</u> Date <u>22.9.93</u> In order for further action <u>[Signature]</u> Date <u>28.9.93</u>		DIAGRAM CERTIFIED CORRECT Authorized Land Officer _____ Date _____		RECORDED ON PUBLIC PLAN DEPARTMENT OF LAND ADMINISTRATION LOGGED R.F.P. 20.9.93 DIAGRAM 91314	