

NATURE RESERVE

RESERVE NO: 18583

GOVERNMENT GAZETTE
Date Page No.

FILE NUMBER:

PURPOSE: Cons. of Flora & Fauna 11.8.78 2885

NAME:

CLASS (Land Act):

AREA: 1155.9871 ha

VESTING: W.A.W.A. 11.8.78 2864

LOCATION NO(S): Yilgarn 267

CLASSIFICATION:
(Wildlife Act
Section 12A)

LITHO: 24/80, 35/80

LOCAL AUTHORITY: WESTONIA SHIRE

Notes:

RESERVE ACTION SHEET - CONSERVATION RESERVES

RESERVE No. 18583

REASON FOR ACTION

- Amendment to reserve 18583 to include a portion of discontinued railway. Area of reserve reduced by 97.3 hectares due to a recalculation of location boundaries. Area: 1058.7 hectares.

The discontinued railway, despite being predominantly cleared with limited regeneration of native vegetation, was included into reserve 18583 as the railway is relatively narrow and surrounded by the reserve. Gaining management of the railway also aids in the Department's capacity to control the illegal harvesting of timber for digeridoos, which occurs in the surrounding native vegetation.

- Date of DOLA's advice: 4 October 2000 See folio: 64
- Plans at folios: 61, 62 & 63

OFFICER	ACTION
1 CONSERVATION OFFICER ^{LS} ESTATE OFFICER	<ul style="list-style-type: none"> - Fill in above details ✓ - Attach copies of DOLA's advice to file ✓ <p>Send copies of advice & maps to:</p> <ul style="list-style-type: none"> - Lisa Wright, Woodvale ✓ - District Manager, Merredin ✓ - Regional Manager, Wheatbelt ✓ <p>Recommended IUCN classification: 1a</p> <p>To note: <i>LS</i></p>
2 INDEX CLERK, RECORDS	To note: _____
3 LAND ACQUISITIONS OFFICER	To note: _____
4 MANAGER, PLANNING & VISITOR SERVICES	To note & approve IUCN classification: _____
5 DIRECTOR, NATURE CONSERVATION/ NATIONAL PARKS	To note: _____

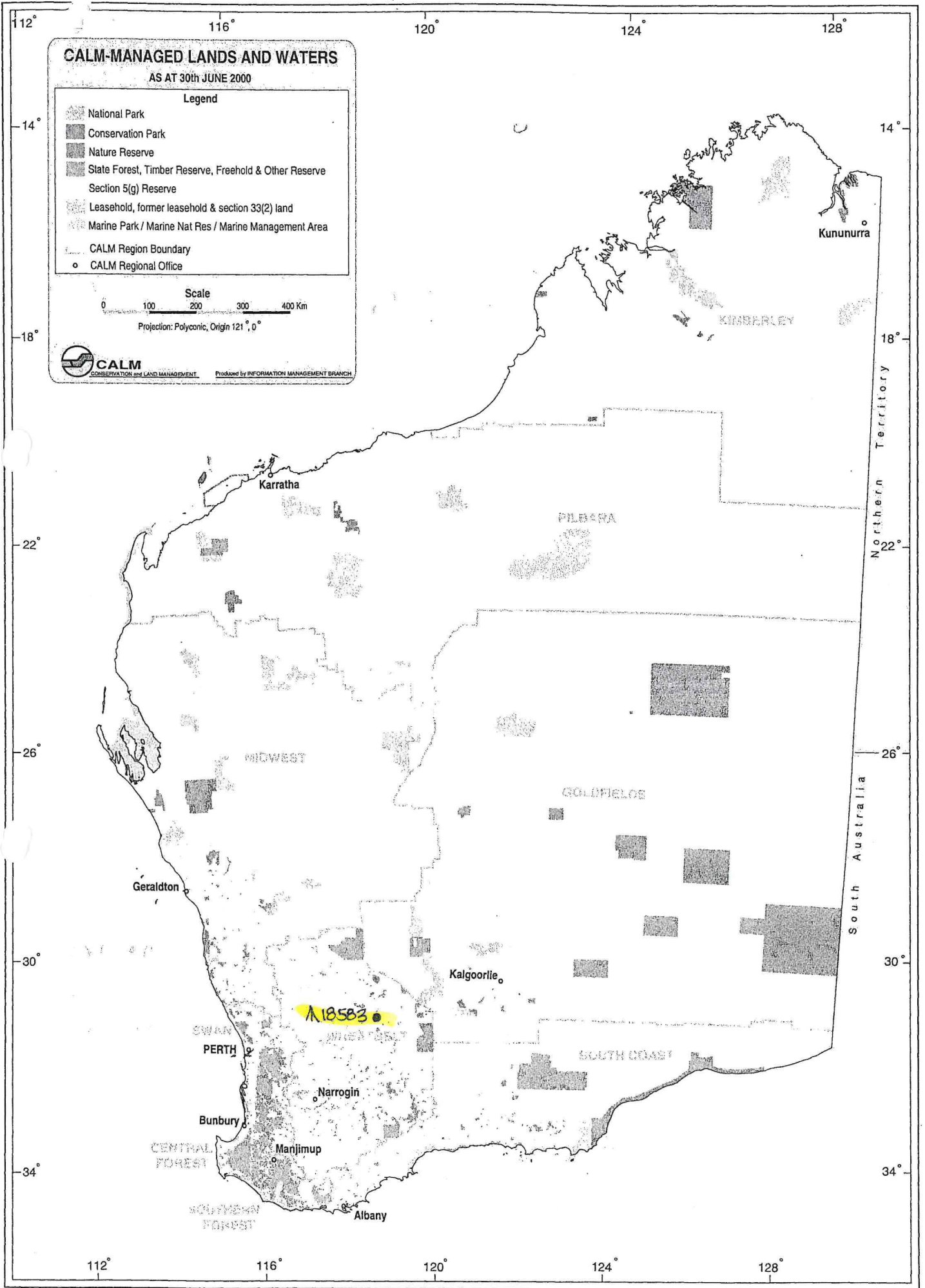

CALM-MANAGED LANDS AND WATERS
AS AT 30th JUNE 2000

Legend

- National Park
- Conservation Park
- Nature Reserve
- Slate Forest, Timber Reserve, Freehold & Other Reserve
- Section 5(g) Reserve
- Leasehold, former leasehold & section 33(2) land
- Marine Park / Marine Nat Res / Marine Management Area
- CALM Region Boundary
- CALM Regional Office

Scale
0 100 200 300 400 Km
Projection: Polyconic, Origin 121° 0'

CALM
CONSERVATION and LAND MANAGEMENT
Produced by INFORMATION MANAGEMENT BRANCH

18583

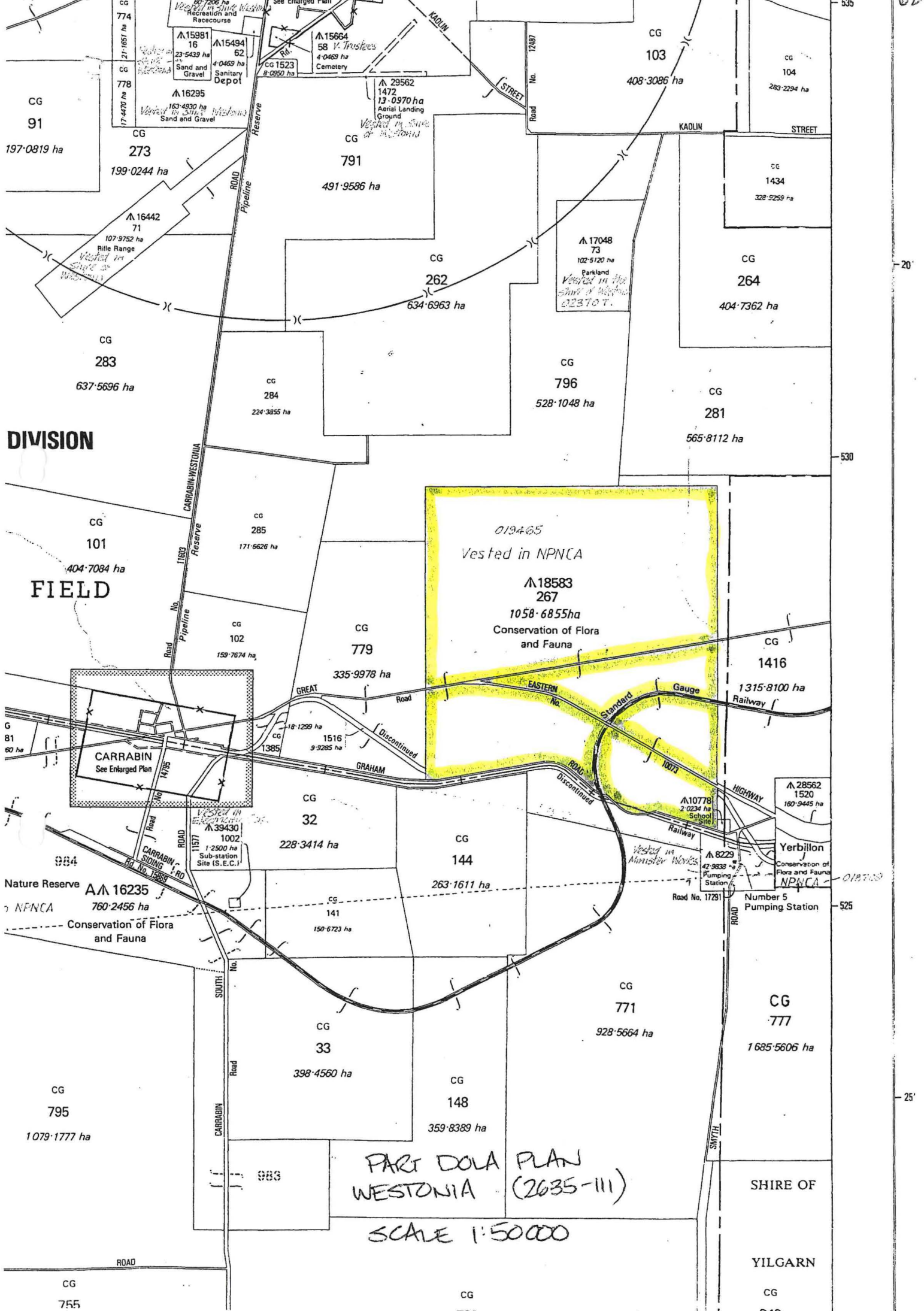

DIVISION
FIELD

PART DOLA PLAN
WESTONIA (2635-111)
SCALE 1:50000

SHIRE OF
YILGARN

CG 91 197-0819 ha
CG 273 199-0244 ha
CG 283 637-5696 ha
CG 101 404-7094 ha
CG 102 159-7674 ha
CG 103 408-3086 ha
CG 104 283-2294 ha
CG 1434 328-5259 ha
CG 264 404-7362 ha
CG 262 634-6963 ha
CG 284 224-3855 ha
CG 281 565-8112 ha
CG 285 171-6626 ha
CG 779 335-9978 ha
CG 1416 1315-8100 ha
CG 141 150-6723 ha
CG 148 359-8389 ha
CG 771 928-5664 ha
CG 777 1685-5606 ha
CG 795 1079-1777 ha
CG 755
CG 796 528-1048 ha
CG 797
CG 798
CG 799
CG 800
CG 801
CG 802
CG 803
CG 804
CG 805
CG 806
CG 807
CG 808
CG 809
CG 810
CG 811
CG 812
CG 813
CG 814
CG 815
CG 816
CG 817
CG 818
CG 819
CG 820
CG 821
CG 822
CG 823
CG 824
CG 825
CG 826
CG 827
CG 828
CG 829
CG 830
CG 831
CG 832
CG 833
CG 834
CG 835
CG 836
CG 837
CG 838
CG 839
CG 840
CG 841
CG 842
CG 843
CG 844
CG 845
CG 846
CG 847
CG 848
CG 849
CG 850
CG 851
CG 852
CG 853
CG 854
CG 855
CG 856
CG 857
CG 858
CG 859
CG 860
CG 861
CG 862
CG 863
CG 864
CG 865
CG 866
CG 867
CG 868
CG 869
CG 870
CG 871
CG 872
CG 873
CG 874
CG 875
CG 876
CG 877
CG 878
CG 879
CG 880
CG 881
CG 882
CG 883
CG 884
CG 885
CG 886
CG 887
CG 888
CG 889
CG 890
CG 891
CG 892
CG 893
CG 894
CG 895
CG 896
CG 897
CG 898
CG 899
CG 900
CG 901
CG 902
CG 903
CG 904
CG 905
CG 906
CG 907
CG 908
CG 909
CG 910
CG 911
CG 912
CG 913
CG 914
CG 915
CG 916
CG 917
CG 918
CG 919
CG 920
CG 921
CG 922
CG 923
CG 924
CG 925
CG 926
CG 927
CG 928
CG 929
CG 930
CG 931
CG 932
CG 933
CG 934
CG 935
CG 936
CG 937
CG 938
CG 939
CG 940
CG 941
CG 942
CG 943
CG 944
CG 945
CG 946
CG 947
CG 948
CG 949
CG 950
CG 951
CG 952
CG 953
CG 954
CG 955
CG 956
CG 957
CG 958
CG 959
CG 960
CG 961
CG 962
CG 963
CG 964
CG 965
CG 966
CG 967
CG 968
CG 969
CG 970
CG 971
CG 972
CG 973
CG 974
CG 975
CG 976
CG 977
CG 978
CG 979
CG 980
CG 981
CG 982
CG 983
CG 984
CG 985
CG 986
CG 987
CG 988
CG 989
CG 990
CG 991
CG 992
CG 993
CG 994
CG 995
CG 996
CG 997
CG 998
CG 999
CG 1000

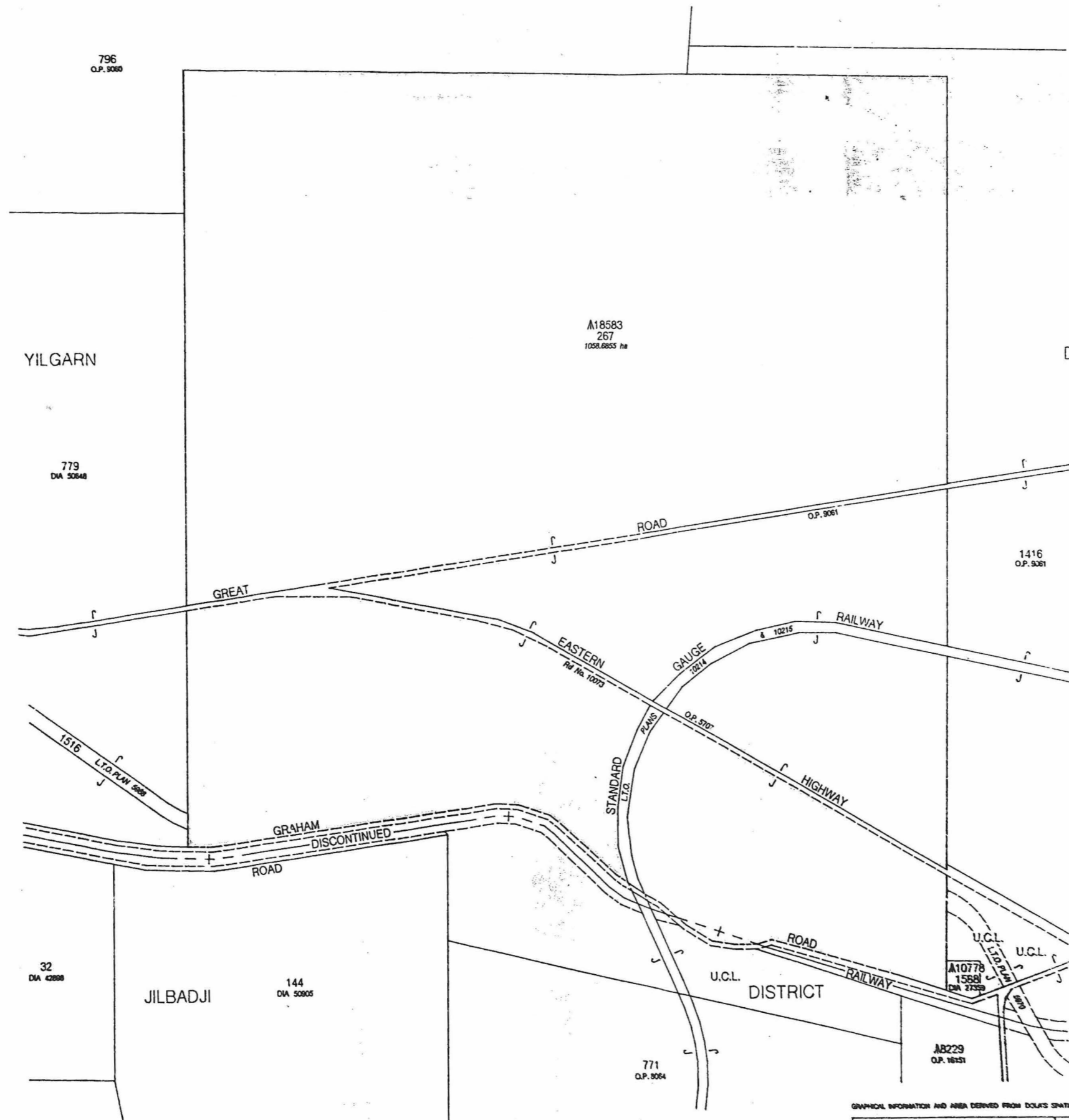

FORMER P1/TENURE
DISCONTINUED RAILWAY (U.C.L.)
CLOSED ROAD

CT / CLT

ON PLANS / DIAGRAMS
L.T.O. PLANS 5988, 5989 & 5970

AMENDMENTS

GRAPHICAL INFORMATION AND AREA DERIVED FROM DOLA'S SPATIAL DATA BASE

DISTRICT YILGARN		LOCATION 267	
LOCAL AUTHORITY SHIRE OF WESTON		SUBJECT TO SURVEY NOT FOR ALIENATION PURPOSES	
FILE 3382/988		APPROVED	
SCALE 1:10000		APPROVED LAND OFFICER	
Public Plan WESTON 100		LAND ADMINISTRATION ACT MISCELLANEOUS	
Reference 7/0		IN CHIEF FOR DELIVER	
Prepared by A.S. Patten Date 31.3.2008		SUBJECT TO RECONSTRUCTION, SEPARATION OF PROPERTY OF DISTRICT BODY OR OTHER BODY	
Checked [Signature] Date 6.9.2008		FOR AUTHORIZED LAND OFFICER USE	
[Signature]		APPROVED	
[Signature]		LAND ADMINISTRATION ACT MISCELLANEOUS	

LAND ADMINISTRATION ACT
MISCELLANEOUS
PLAN 21187

Customer Advice

Customer Advices for Reserve Actions 1/12/2000 - 31/12/2000

Shire of Westonia 1/12/2000 - 31/12/2000

Reserve No.	Land Description	DOLA File No.	Volume/Folio	Action	Document No.	Registered	Street Name	Area	Public Plans
18583	Yilgarn Location 267	03382-1988-01RO	0000-000	Amendment of Reserve to To comprise Yilgarn Location 267 on Land Administration Miscellaneous Plan 21187 and of its area being reduced to 1058.6855 hectares accordingly	H566554	04/10/2000	near Yerbillon	1058.6855 Ha	Westonia (50)
18583		03382-1988-01RO	0000-000	Revocation of Management Order (WA Wildlife Authority) for the designated purpose of "Conservation of Flora & Fauna".	H566553	04/10/2000	near Yerbillon	1155.9871 Ha	Westonia (50)
32162	Westonia Lots 42, 43, 44, 45 and 46 on Land Administration Plan 3296	01231-1973-01RO	3074-838	Amendment of Reserve to To include the section of closed road being Westonia Lot 430 and for Reserve 32162 to comprise Westonia Lot 431 on Land Administration Diagram 93624, formerly Lots 42, 43, 44, 45 and 46, and of its area being increased to 6677 square metres accordingly .	H522913	11/08/2000	Diorite Street	6677 sqm	Westonia Townsite
32162		01231-1973-01RO	3110-956	Management Order to Shire of Westonia of Wolfram Street Westonia for the designated purpose of "Recreation"	H522916	11/08/2000	Diorite Street	6677 sqm	Westonia Townsite
32162		01231-1973-01RO	3074-838	Revocation of Management Order (the Shire of Westonia) for the designated purpose of "Recreation".	H522915	11/08/2000	Diorite Street	5060 sqm	Westonia Townsite

John 820

For plans please

Thanks

Sharon Colliss

30.11.01

TENS d'have awarded (50)

Plan, white folder checked OK *GM*
9/12

COMMAND ==>

CLR-NO LR 3028/846 - ISSUED

Reserve : 18583 (Status : 0) Class : C (04/04/1924 pp 576)
 Orig Gaz : 576 of 04/04/1924 Area : 1058.6855
 Coded Information : (to translate VESTING, RESP AGENCY and LGA = Press PF05)
 Vesting : 15NPN : Resp. Agency : SCLM
 Usage : 9100 : 9200 : 9300 : : 1858 :
 L.G. Auth: 428 : : : : : (Last Change: 27/11/2000)

Gaz-Page and Date.

Text Details

	04/10/2000	1	CA	1058.6855 (H566554)
2885	11/08/1978	1	CP	CONSERVATION OF FLORA & FAUNA
	04/10/2000	1	CV	VEST: NATIONAL PARKS AND NATURE CONSERVATION
	PLUS	2	CV	AUTHORITY (H607287)
	04/10/2000	1	FN	03382-1988-01RD
	04/04/1924	1	LC	YILGARN LOCATION 267
	29/12/1987	1	PP	WESTONIA (50)
	04/04/1924	1	ST	NR.YERBILLON
	04/10/2000	1	SV	LTD: MISC PLAN 21187 (H566554)

----- ADDITIONAL INFORMATION (NEWEST FIRST) -----

PFkeys: 1 = Help 3 = End 4 = Main Menu 5 = Translate Codes 6 = Map Details
 7 = Bkwd 8 = Fwd 9 = Print 10 = Cal List 11 = Graphics 12 = Command Line