

NATURE RESERVE

RESERVE NO: 18735

GOVERNMENT GAZETTE  
Date Page No.

FILE NUMBER: 406/78

PURPOSE: Water & Cons. of Flora  
& Fauna 23.3.78 853

NAME: Graham Rock Nature Reserve 25.2.83 661

CLASS (Land Act):

AREA: 121.4057 ha

VESTING: Min. for Water Supply etc. 23.3.78 840

LOCATION NO(S): ROE 821

CLASSIFICATION:  
(Wildlife Act  
Section 12A)

LITHO: 346/80, 375/80

LOCAL AUTHORITY: KONDININ SHIRE

Notes:

019190F3102

Clerk Woodvale.

54.  
JC.

Schedule

File No.; Reserve No.; Land Description; Area Hectares; Plan.

- 2766/89; 798; Plantagenet Locations 5070, 5071 and 4420; 50.5073; Mt Barker, S.W. 1:25 000.
- 799/18; 4070; Swan Location 2302; 17.4138; Jumperkine, N.W. 1:25 000.
- 10120/05; 9920; Kojonup Location 3824; 12.5251; Woodanilling, S.W. 1:25 000.
- 2799/17; 16901; Kojonup Location 9256; 17.3313; Martinup, S.E. 1:25 000.
- 2884/17; 16907; Murray Locations 1285, 1294 and 1558; 113.0597; Pinjarra, S.W. 1:25 000.
- 1272/63; 33192; Nelson Location 13134; 18.0605; 442B/40.
- 2452/74; 34772; Meenaar Lot 71; 29.5585; Meenaar Townsite.
- 2015/82; 38303; Pootenup Lots 54 and 56; 47.0300; Pootenup Townsite.

Given under my hand and the Public Seal of Western Australia, at Perth, this 8th day of August 1989.

By His Excellency's Command,

E. K. HALLAHAN,  
Minister for Lands.

GOD SAVE THE QUEEN

Department of Conservation  
and Land Management  
19 DEC 1989  
COMO. WA

- 2821/33; 21180; Ningham Location 4247.; 89.1428; Wialki 1:50 000.
- 6208/51; 23339; Yilgarn Location 1233; 465.9905; Walyahmoning 1:50 000.
- 1922/36; 24465; Yilgarn Locations 1166 and 14043.; 531.7443; Walyahmoning 1:50 000.
- 1548/58; 25126; Yilgarn Location 365; 79.8850; Coorancooping 1:50 000.
- 4157/67; 29249; Roe Locations 223 and 2963.; 317.1124; Mt. Walker and Borayukkin 1:50 000.
- 3252/78; 36448; Ninghan Location 4223.; 12.0883; 89/80.
- 1472/84; 38796; Victoria Location abt 11544.; 32.6500; 156/80.
- 2023/85; 39186; Ninghan Location 3000.; 102.6308; Mollerin 1:50 000.
- 1180/84; 39621; Kojonup Location 9267.; 369.2109; Lake Clabburn N.E. 1:25 000.

Given under my hand and the Public Seal of Western Australia, at Perth, this 8th day of August, 1989.

By His Excellency's Command,

E. K. HALLAHAN,  
Minister for Lands.

GOD SAVE THE QUEEN !

Land Act 1933

PROCLAMATION

WESTERN AUSTRALIA  
FRANCIS BURT,  
Lieutenant-Governor,  
and Administrator.  
[L.S.]

His Excellency the Honourable Sir Francis Theodore Page Burt, Companion of the Order of Australia, Knight Commander of the Most Distinguished Order of Saint Michael and Saint George, Queen's Counsel, Lieutenant-Governor and Administrator of the State of Western Australia.

WESTERN AUSTRALIA  
FRANCIS BURT,  
Lieutenant-Governor,  
and Administrator.  
[L.S.]

Residential Tenancies Act 1987

PROCLAMATION

His Excellency the Honourable Sir Francis Theodore Page Burt, Companion of the Order of Australia, Knight Commander of the Most Distinguished Order of Saint Michael and Saint George, Queen's Counsel, Lieutenant-Governor and Administrator of the State of Western Australia.

UNDER section 2 of the Residential Tenancies Act 1987, I, the Lieutenant-Governor and Administrator, acting with the advice and consent of the Executive Council, do hereby fix 1 October 1989 as the day on which the Residential Tenancies Act 1987 shall come into operation.

Given under my hand and the Seal of the State on 8th August 1989.

By His Excellency's Command,

YVONNE HENDERSON,  
Minister for Consumer Affairs.

GOD SAVE THE QUEEN !

Schedule

File No.; Reserve No.; Land Description; Area (Hectares); Plan.

- 2747/83; 641; Victoria Location 7252.; 40.4200; 192/80.
- 2018/00; 7128; Kojonup Location 122.; 40.4686; Carlecatup S.W. 1:25 000.
- 12033/03; 10753; Avon Location 5513.; 54.2279; Mears S.W. 1:25 000.
- 6001/07; 11717; Jennaberring Agricultural Area Lot 31.; 36.4217; Pantapin S.W. 1:25 000.
- 3576/04; 11776; Avon Location 6097.; 40.4686; Younedequin N.E. 1:25 000.
- 12235/09; 12712; Avon Locations 10102, 21305 and 21628.; 45.3097; Babakin N.E. 1:25 000.
- 18280/10; 15702; Avon Locations 6418 and 17381.; 301.4908; Mt. Dillon N.W. 1:25 000.
- 13061/08; 15794; Avon Location 20683.; 40.4686; Cadoux N.E. 1:25 000.
- 54/16; 16479; Williams Location 8999.; 77.1837; Sewell S.E. 1:25 000.
- 164/17; 16896; Pintharuka Lot 33.; 4.2567; Pintharuka Townsite.
- 306/21; 17648; Roe Locations 30 and 1005.; 348.0297; Burngup 1:50 000.
- 4702/24; 18735; Roe Location 821.; 121.4057; Lake O'Connor 1:50 000.
- 1899/82; 18773; Jilbadji Location 241.; 450.8198; Moorine Rock 1:50 000.
- 52/26; 19327; Avon Location 23857.; 6.0703; Pikaring S.W. 1:25 000.

AT a meeting of the Executive Council held in the Executive Council Chambers, at Perth, on 8 August 1989 the following Orders in Council were authorised to be issued.

Child Welfare Act 1947

ORDER IN COUNCIL

WHEREAS by section 19(2)(a) of the Child Welfare Act 1947, it is provided that the Lieutenant-Governor and Administrator may appoint such persons, male or female, as he may think fit, to be members of any particular Children's Court and may determine the respective seniorities of such members and whereas by section 19(1)(b)(ii) of the said Act, the Lieutenant-Governor and Administrator may amend, vary or revoke any such appointment: Now therefore His Excellency the Lieutenant-Governor and Administrator by and with the advice and consent of the Executive Council doth hereby appoint the person named in the First Schedule hereto to be a member of the Children's Court at the place mentioned and doth hereby revoke the appointment of the person named in the Second Schedule hereto to be a member of the Children's Court at the place mentioned.

First Schedule

Kununurra—Dennis Barr O'Brien.

Second Schedule

Kununurra—Arthur Donald Gray.

G. PEARCE,  
Clerk of the Council.

31/8/89

File LANDS CLERK

4

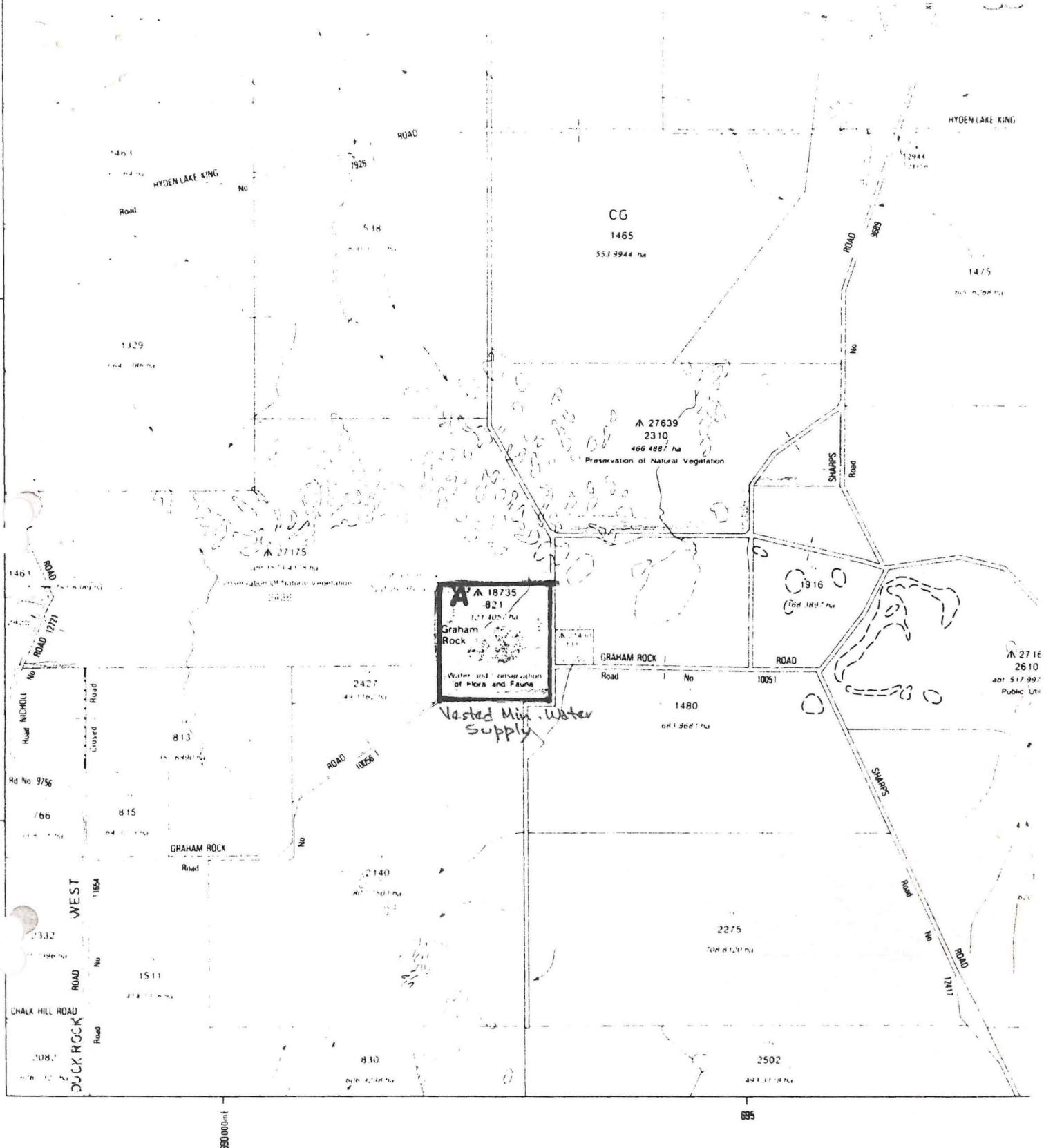

# Pt Plan Lake O'Connor

Information shown on this map should not be used for legal purposes, but reference made to original documents.

1:50000  
 1000 Metres

GRID CONVERGENCE AT SHEET CENTRE



- |                                |               |                                 |
|--------------------------------|---------------|---------------------------------|
| Surveyed Boundary              | _____         | Tenure Freehold Lease           |
| Unsurveyed Boundary            | _____         | Reserve Land Act, Forest Act    |
| Goldfield Boundary             | _____         | Agricultural Area or Estate Lot |
| Townsite under Local Gov't Act | _____         | Locations                       |
| Townsite Boundary              | _____ x _____ | Station Name                    |
| State Forest Boundary          | _____ + _____ | Locality Name                   |