

02/0307/002

19007



DEPARTMENT OF LAND ADMINISTRATION

Cathedral Avenue,  
Perth,  
Western Australia 6000

Your Ref.

Our Ref. 4749/20 AP:AP

Telephone Enquiries 323 1278

Department of Conservation  
and Land Management  
1 2 MAR 1987  
COMO, W.A.

EXECUTIVE DIRECTOR  
DEPARTMENT OF CONSERVATION AND  
LAND MANAGEMENT

RE: RESERVES NOS. 39718, 10499, 12807, 12809, 14157, 15031, 19007 AND 29583

I advise for your information that Executive Council has:-

1. Approved of Yilliminning Lots 115 and 116 being set apart as Reserve No. 39718 for the purpose of "Conservation of Flora and Fauna"
2. Approved of the cancellation of:-
  - (a) Reserve No. 10499 (Yilliminning Lot 83) "Recreation".
  - (b) Reserve No. 12807 (Yilliminning Lot 64) "Public Buildings Commonwealth".
  - (c) Reserve No. 12809 (Yilliminning Lots 51, 63 and 71) "Excepted from Sale".
  - (d) Reserve No. 14157 (Yilliminning Lot 47) "Agricultural Hall Site".
  - (e) Reserve No. 15031 (Yilliminning Lot 95) "Railways".
  - (f) Reserve No. 19007 (Yilliminning Lot 46) "Church Site Anglican".
  - (g) Reserve No. 29583 (Yilliminning Lot 111) "Government Requirements".

Notice to this effect was published in the Government Gazette of December 24, 1986 and I enclose a print showing the said amendment.

*A. W. Muckle*

DIRECTOR  
LAND OPERATIONS DIVISION

11 March 1987

enc

*DONE AMY. 26.7.88*

*17.3.87*

*D.S.C. Resurvey*

*Land Clerk Reserve Action Sheet*

File No. 1210/986.

CANNING.—No. 39712 (Drainage), Location No. 3536, formerly Portion of Canning Location 21 and being Lot 2 the subject of Diagram 70072 (6 678 square metres). (Public Plan Perth 1:2 000 15.12 (Beasley Road).)

File No. 1868/986.

SUSSEX.—No. 39714 (Parkland), Location No. 4819 (7 917 square metres). (Diagram 87698, Public Plan Whicher NW 1:25 000 (Chapman Hill Road).)

File No. 3204/986.

HALLS CREEK.—No. 39715 (Housing (Shire of Halls Creek)), Lot No. 120 (1 194 square metres). (Original Plan 6819, Public Plan Halls Creek Townsite 1:2 000 32.25 (Roberta Avenue).)

File No. 2134/986.

HALLS CREEK.—No. 39716 (Recreation), Lot Nos 409 and 410 (3 598 square metres). (Original Plan 16477, Public Plan Halls Creek Townsite 1:2 000 32.25 (Gordon Court and Moyle Crescent).)

File No. 3001/985.

YILLIMINNING.—No. 39717 (Park), Lot Nos. 98, 99, 100, 112, 113 and 117 (23.188 0 hectares). (Reserve/Diagram 592, Original Plan 16405, Public Plan Yilliminning Townsite (Railway Parade, Murray and Forrest Streets).)

File No. 4749/20.

YILLIMINNING.—No. 39718 (Conservation of Flora and Fauna), Lot Nos. 115 and 116 (39.944 6 hectares). (Diagram 87035 and Reserve Diagram 593, Public Plan Yilliminning Townsite (Moss and Cowcher Streets).)

File No. 2018/986.

WILUNA.—No. 39719 (Aboriginal Medical Service), Lot No. 1471 (4 138 square metres). (Diagram 87660, Public Plan Wiluna Townsite (Lennon Street).)

File No. 3100/986.

ROCKINGHAM.—No. 39721 (Water Supply), Lot No. 1565, formerly portion of each of Rockingham Lots 639 and 1490 and being Lot 2 on Diagram 69930 (2 816 square metres). (Public Plan Peel 1:2 000 07.30, 07.31 and 08.31 (Ward and Jecks Roads).)

File No. 2065/985.

SWAN.—No. 39722 (Public Recreation), Location No. 10856, formerly portion of Swan Location K1 and being Lot 38 on Plan 15132 (3 832 square metres). (Public Plan Perth 1:2 000 11.35 (Blackdoune way).)

File No. 1224/986.

GLEN FORREST.—No. 39724 (Public Recreation), Lot No. 375, formerly portion of Greenmount Suburban Lot 75 and being Lot 31 on Diagram 69845 (1 566 square metres). (Public Plan Perth 1:2 000 27.30 (near Johnmoore Court).)

File No. 498/986.

SWAN.—No. 39726 (Public Recreation), Location No. 10859, formerly portion of Swan Location 1370 and being Lot 49 on Plan 15394 (1.544 6 hectares). (Public Plan Swan 1:10 000 1.2 and 2.2 (Southern Cross Circle).)

File No. 1891/984.

PLANTAGENET.—No. 39727 (Public Recreation), Location No. 7622, formerly portion of Plantagenet Location 2238 and being Lot 249 on Plan 14650 (56.556 3 hectares). (Public Plan Ratcliffe NW 1:25 000 (Lights Road).)

File No. 2747/985.

GREGORY.—No. 39728 (Public Recreation), Location No. 69, formerly portion of Gregory Location 46 and being Lot 865 on Plan 15337 (8.474 9 hectares). (Public Plan Tom Price 1:2 000 11.10 and 11.11 West and Mine Roads.)

File No. 306/03.

FREMANTLE.—No. 39729 (Recreation), Suburban/Lot No. 85 (1.563 1 hectares). (Diagram 60/155, Public Plan Perth 1:2 000 07.11 (Ocean Road).)

N. J. SMYTH,  
Executive Director.

Department of Conservation  
and Land Management

22 JAN 1987

AMENDMENT OF RESERVES  
COMO, W.A.  
Department of Land Administration,  
Perth, 24 December 1986.

HIS Excellency the Governor in Executive Council has been pleased to approve, under section 37 of the Land Act 1933 of the amendment of the following Reserves:—

File No. 1893/95V2.—No. 315 (Pinjarra Lots 57 to 61 inclusive, Lots 64 to 68 inclusive and Lot 307) "Civic Centre" to include Pinjarra Lot 222 an of its area being increased to 1.611 7 hectares accordingly. (Plan Pinjarra 1:2 000 14.30 (Murray Street).)

File No. 1599/98.—No. 5342 (Swan and Canning Districts) "Camping Ground in connection with Helena Reservoir Works" to exclude that portion now comprised in Canning Location 3500 as surveyed and shown bordered red on Lands and Surveys Diagram 87593 and of its area being reduced to 133.106 3 hectares accordingly. (Plan Perth 1:10 000 7.5 (Mundaring Weir Road).)

File No. 5860/99.—No. 6834 (at Mt Magnet) "Water" to comprise Mt Magnet Lot 503 as surveyed and shown bordered red on Lands and Surveys Diagram 87321 in lieu of Mt Magnet Lot 198 and of its area being increased to 5.190 4 hectares accordingly. (Plan Mt Magnet Townsite (Welcome Street).)

File No. 5129/03.—No. 8882 (Victoria District) "Mining" to comprise Victoria Location 11677 as surveyed and shown bordered red on Land Administration Diagram 87624 and of its area being reduced to 11.754 7 hectares accordingly. (Plan 160 D/40 (Wundi Road).)

File No. 8843/08.—No. 11598 (Swan District) "Recreation" to comprise Swan Location 10823 as surveyed and shown bordered red on Land Administration Diagram 87676 and of its area being increased to 60.557 6 hectares accordingly. (Plan Swan 1:10 000 2.3 and 2.4 (Pinjar Road).)

File No. 6552/12.—No. 14354 (Hampton District) "Water" to comprise Hampton Location 194 as shown delineated and bordered red on Land Administration Reserve Diagram 597 and of its area being increased to 63.514 1 hectares accordingly. (Plan 71/80 (Road No. 1897).)

File No. 2643/30.—No. 20523 (Ninghan District) "Water" to comprise Ninghan Location 4248 as surveyed and shown bordered red on Land Administration Original Plan 16659 in lieu of Ninghan Location 4111 and of its area being reduced to 963.102 0 hectares accordingly. (Plan Tampu 1:50 000 (Bimbijy Road).)

File No. 1130/36.—No. 21604 (Ninghan District) "Recreation (Golf Links)" to comprise Ninghan Locations 3768 and 4200 as surveyed and shown bordered red on Land and Surveys Original Plan 16111 and Lands and Surveys Diagram 81589 respectively and of its area being increased to 292.010 3 hectares accordingly. (Plan Wialki 1:50 000 (Bonnie Rock-Burakin Road).)

File No. 4755/50 V2.—No. 23128 (Roe Location 2114) "Recreation and Conservation of Flora" to exclude that portion now comprised in Hyden Lots 131 to 148 inclusive on Land Administration Original Plan 16720 and the area shown coloured dark brown on that Plan and of its area being reduced to 94.340 4 hectares accordingly. (Plan Hyden 1:2 000 29.08 and Hyden 1:50 000 (Radbourne Drive).)

File No. 942/62.—No. 26401 (Halls Creek Lots 120 and 121) "Housing (Main Roads Department)" to exclude Halls Creek Lot 120 and of its area being reduced to 1 194 square metres accordingly. (Plan Halls Creek Townsite 1:2 000 32.25 (Roberta Avenue).)

File No. 1558/895V4.—No. 27080 (Broadwater Suburban Lot 33) "Conservation of Flora and Fauna" to include Sussex Location 4827 (formerly portion of Sussex Location 5 and being Lot 76 on Plan 15296) and of its area being increased to 79.776 3 hectares accordingly. (Plan Broadwater 1:2 000 21.33 and 21.34 (Hungerford Road in the Shire of Busselton).)

File No. 2382/10.—No. 27352 (Broome Lot 826) "Church Purposes" to agree with recalculation of area and of its area being increased to 1 621 square metres accordingly. (Plan Broome 1:2 000 30.13 (Herbert Street).)

File No. 2005/65.—No. 27741 (Swan District) "School Site" to comprise Swan Location 7932 as surveyed and shown bordered red on Land Administration Diagram 87639 and of its area being reduced to 5.839 6 hectares accordingly. (Plan Perth 1:2 000 08.31 and 08.30 (Saint Brigids Terrace).)

File No. 3924/67.—No. 30053 (Swan Location 10775) "Public Recreation" to include Swan Location 10849 (formerly portion of Helena Location 20b and being Lot 503 on Diagram 65121) and of its area being increased to 2.003 6 hectares accordingly. (Plan Perth 1:2 000 24.29 (Katharine Street).)

File No. 2344/69.—No. 30558 (Goomalling Lot 456) "Shire Depot" to include Goomalling Lot 396 as surveyed on Lands and Surveys Original Plan 11443 and of its area being increased to 1.449 7 hectares accordingly. (Plan Goomalling 1:2 000 30.18 (Waterhouse Way).)

File (139715, Yilliminning)

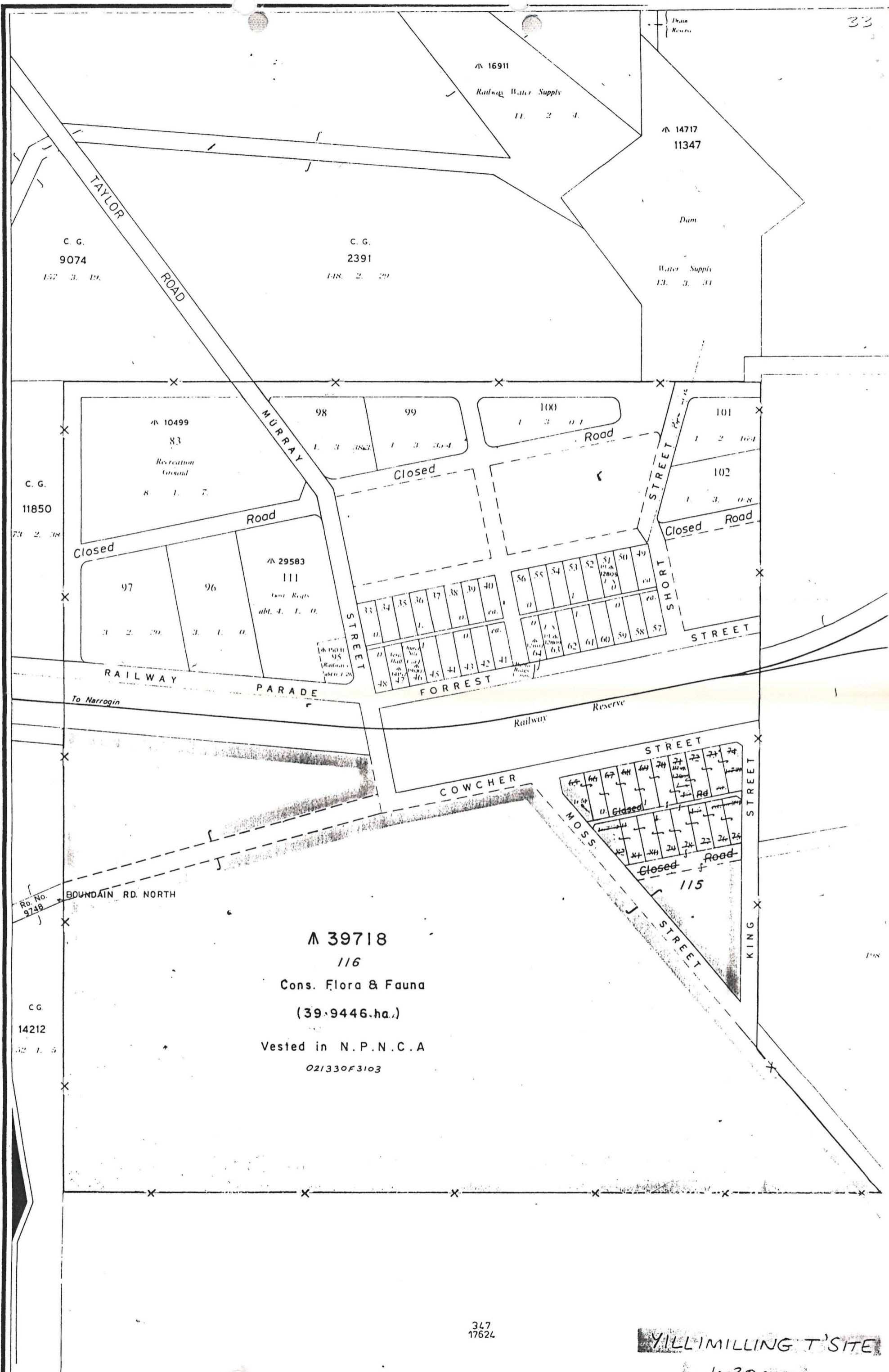

C. G.  
9074  
157 3. 19.

C. G.  
2391  
148. 2. 29

16911  
14717  
11347

Dam  
Water Supply  
13. 3. 31

C. G.  
11850  
79 2. 38

10499  
83  
Recreation Ground  
8 1. 7.

29583  
111  
Cust. Rights  
abt. 4. 1. 0.

15011  
95  
Railway  
abt. 1. 29

Ro. No.  
9748

BOUDAIN RD. NORTH

C. G.  
14212  
32 1. 5

**A 39718**

116

Cons. Flora & Fauna

(39.9446 ha.)

Vested in N.P.N.C.A

021330F3103