

**RESERVE GAZETTAL ACTION SHEET
FOR REGIONS AND DISTRICTS**

LANDS CLERK: Attach a copy of a map and forward to the following:

1. REGIONAL MANAGER:
CENTRAL FOREST, MIDWEST, GOLDFIELDS, KIMBERLEY, SWAN REGION,
PILBARA, SOUTH COAST, SOUTHERN FOREST, WHEATBELT
2. DISTRICT MANAGER: KATANNING
3. DISTRICT WILDLIFE OFFICER: NARROGIN
4. CLERK WOODVALE
5. O.I.C. INVENTORY BUNBURY/KELMSCOTT/MANJIMUP

REASON FOR GAZETTAL:

*Change in purpose from "Timber" (Mallet) to
"Conservation of Flora & Fauna". Change in
vesting from subvested to NPNC A. Area reduced
by 88.0 ha to 1770.0 ha due to excision for
a proposed shale gravel reserve.*

RESERVE NUMBER: 20349

CALM FILE NUMBER: 02170RF3102

NAME OF RESERVE: -

PURPOSE: Conservation of Flora + Fauna

CLASS: 'c'

AREA: 1770.0 ha

VESTING: NPNC A

DATE OF CURRENT GAZETTAL: 12-3-93

MAP REFERENCE: 2731(II) Old Ravensthorpe Road

SHIRE: Lake Grace

LANDS CLERK
09 367 0221

3340 430

18.5.93
DATE

Gazetted: 12/3/93 PVH

DOLA File 1664/980.

Reserve No. 38658 (Victoria Locations 11425 and 11522) "Public Recreation" to exclude:

- (i) that portion of Location 11522 now comprised in Location 11918 as surveyed and shown bordered pink on Land Administration Diagram 90966 and
- (ii) that portion now comprised in Location 11935 (Reserve No 37496) as surveyed and shown bordered pink on Land Administration Diagram 90817 and of its area being reduced to 3.2114 hectares accordingly.

Public Plans: BE43 (2) 16.12 and 16.13 Glengarry Court.

Local Authority—Shire of Greenough.

DOLA File 2732/979.

Reserve No. 37496 (Victoria District) "Recreation" to comprise Location 11935 as surveyed and shown bordered pink on Land Administration Diagram 90817 in lieu of Location 11427 and of its area being increased to 4846 square metres accordingly.

Public Plan: BE43 (2) 16.13 Highbury Street.

Local Authority—Shire of Greenough.

DOLA File 5000/954.

Reserve No. 20350 (Roe Locations 2454 and 2455) "Timber (Mallet)" to:

- (i) include Location 2456 as surveyed on Land Administration Plan 10118 excluding that portion now comprised in Location 3122 on Diagram 90836 and
- (ii) exclude that portion of Location 2454 now comprised in Location 3123 as surveyed and shown bordered pink on Land Administration Plan 18211 and of its area being increased to 1948.7253 hectares accordingly.

Public Plans: 2731 (II & III) Ardler Road.

Local Authority—Shire of Lake Grace.

DOLA File 4999/954.

Reserve No. 20349 (Roe Location 2457) "Timber (Mallet)" to exclude that portion now comprised in Location 3124 as surveyed and shown bordered pink on Land Administration Plan 18212 and of its area being reduced to 1770.0334 hectares accordingly.

Public Plan: 2731 (II) Old Ravensthorpe Road.

Local Authority—Shire of Lake Grace.

DOLA File 2784/978.

Reserve No. 36260 (Denmark Lot 965) "Waste Water Treatment Works" to include Lot 1030 as surveyed and shown bordered pink on Land Administration Plan 18245 and of its area being increased to 34.2922 hectares accordingly.

Public Plan: BJ26 (2) 21.10, 21.11 Hodgson Street.

Local Authority—Shire of Albany.

DOLA File 1761/924.

Reserve No. 33520 (Plantagenet Location 7254) "Recreation and Parkland" to include Location 2633 as surveyed and shown on Land Administration Diagram 41684 and of its area being increased to 48.1690 hectares accordingly.

Public Plan: Pallinup (50).

Local Authority—Shire of Albany.

DOLA File 321/932V9.

Reserve No. 27853 (Cockburn Sound Locations 2056 to 2059 inclusive and 2600) "Recreation" to exclude that portion now comprised in Locations 2733 and 2734 as surveyed and shown bordered pink on Land Administration Plan 15851 and of its area being reduced to about 156.9141 hectares accordingly.

Public Plans: BG33 (2) 04.28, 04.29 and 05.28 Point Peron Road.

Local Authority—City of Rockingham.

DOLA File 130/968.

Reserve No. 30940 (Cockburn Sound Location 2193) "Drain" to exclude that portion now comprised in Location 2733 as surveyed and shown bordered pink on Land Administration Plan 15851 and of its area being reduced to 2.0652 hectares accordingly.

Public Plans: BG33 (2) 04.28, 04.29 and 05.28.

Local Authority—City of Rockingham.

DOLA File 1016/978.

Reserve No. 35176 (Rockingham Lot 1513) "Park and Recreation" to exclude that portion now comprised in Lot 1531 as surveyed and shown bordered pink on Land Administration Plan 15849 and of its area being reduced to 1.1529 hectares accordingly.

Public Plans: BG33 (2) 05.28 & 06.28 Lake Street.

Local Authority—City of Rockingham.

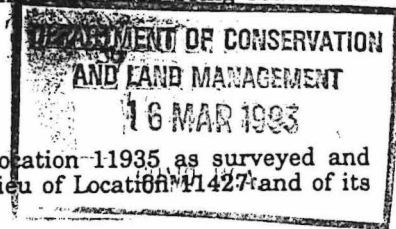

1/ File. 2- Lands Clerk 18.3.93

021708 F 2172

85

DOLA File 3732/980.

Reserve No. 37432 (Broome Lot 1644) being changed from "Tourist Bureau" to "Tourist Bureau and Bus Terminal".

Public Plan: CG73 (2) 30.15 Bagot Street.

Local Authority—Shire of Broome.

DOLA File 2491/992

Reserve No. 32961 (Boulder Lot 4546) being changed from "Education Endowment" to "Park, Drainage and Recreation"

Public Plan: Kalgoorlie-Boulder (2) 29.34

Clancy Street

Local Authority—City of Kalgoorlie-Boulder

DOLA File 1239/989.

Reserve No. 24511 (Esperance Location 2064) being changed from "Conservation of Flora" to "Conservation of Flora and Fauna"

Public Plans: 3230 -II, CG29 (10) 3.3 and 3.4.

Local Authority—Shire of Esperance.

Reserve 24511 is automatically vested in the National Parks and Nature Conservation Authority pursuant to Section 7 of CALM Act 1984.

DOLA File 2732/979.

Reserve No. 37496 (Victoria Location 11935) being changed from "Recreation" to "Recreation and Drainage".

Public Plan: BE43 (2) 16.13 Highbury Street

Local Authority—Shire of Greenough.

DOLA File 5000/954.

Reserve No. 20350 (Roe Locations 2454, 2455 and 2456) being changed from "Timber (Mallet)" to "Conservation of Flora and Fauna"

Public Plans: 2731 (II & III)

Local Authority—Shire of Lake Grace.

Reserve 20350 is automatically vested in the National Parks and Nature Conservation Authority pursuant to Section 7 of CALM Act 1984

DOLA File 4999/954.

Reserve No. 20349 (Roe Location 2457) being changed from "Timber (Mallet)" to "Conservation of Flora and Fauna".

Public Plan: 2731 (II) Old Ravensthorpe Road.

Local Authority—Shire of Lake Grace.

Reserve 20349 is automatically vested in the National Parks and Nature Conservation Authority pursuant to Section 7 of CALM Act 1984.

DOLA File 3536/968.

Reserve No. 32119 (Canning Location 2487) being changed from "Recreation" to "Public Recreation".

Public Plan: BG34 (2) 23.19 Falls Road

Local Authority—Shire of Kalamunda.

DOLA File 3036/974.

Reserve No. 33251 (Rockingham Lot 1515) to be changed from "Government Requirements (Mental Health Services)" to "Day Centre".

Public Plans: BG34 (2) 06.28, 07.28 and 07.29 Patterson Road

Local Authority—City of Rockingham.

DOLA File 2028/970.

Reserve No. 31481 (Cockburn Sound Location 2231) being changed from "School Site" to "Use and Requirements of the Minister for Works"

Public Plans: BG33 (2) 5.26 and 6.26 Fawdon Street

Local Authority—City of Rockingham.

DOLA File 1530/984.

Reserve No. 38799 (Trayning Lot 174) being changed from "Hall Site" to "Community Centre".

Public Plan: Trayning Townsite. Railway Street.

Local Authority—Shire of Trayning.

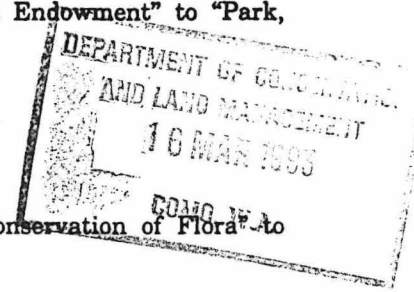

18-3-93

Handwritten notes at the bottom of the page: "L.A. to Lands Clerk 40185, 186"

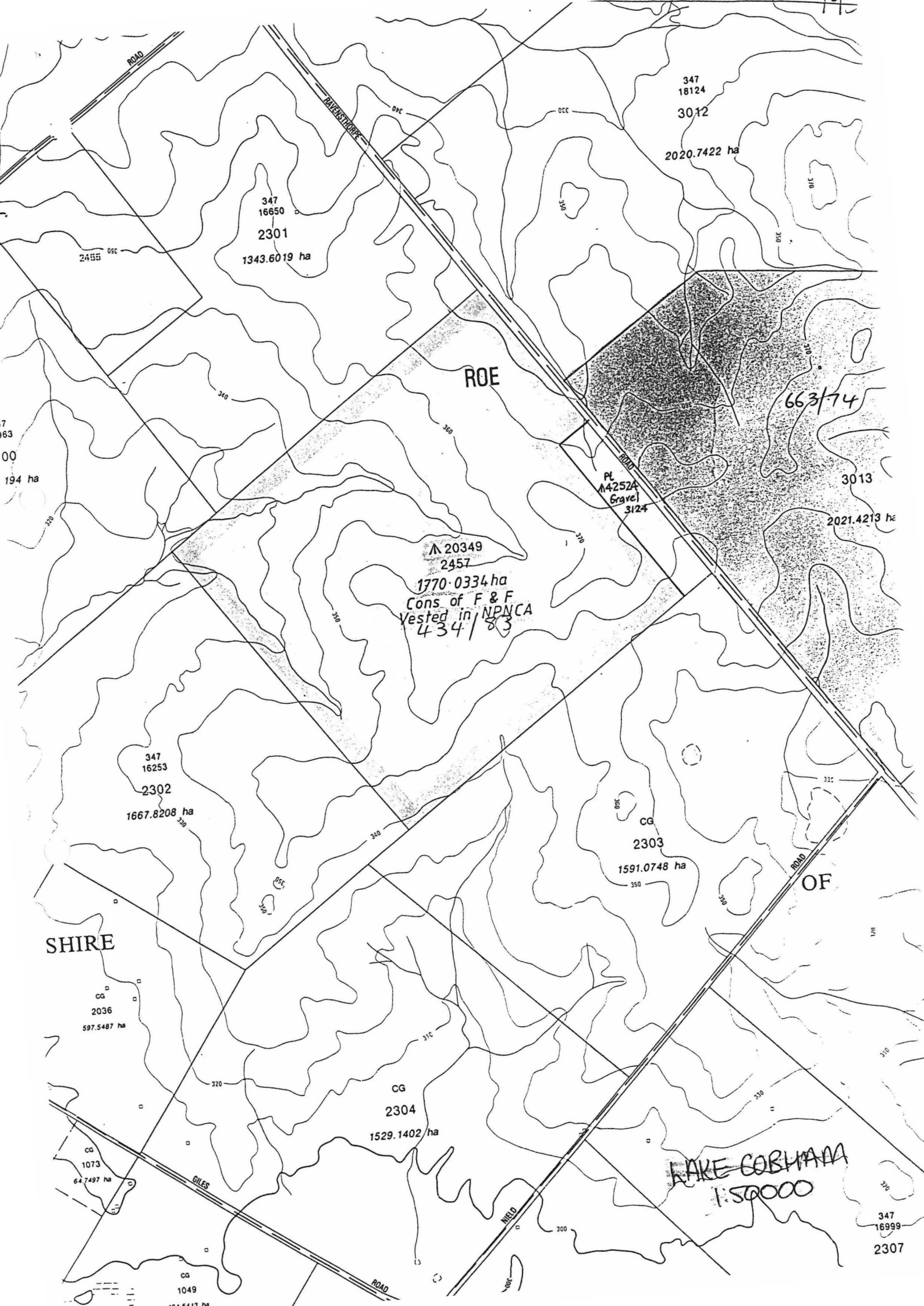

347
18124
3012
2020.7422 ha

347
16650
2301
1343.6019 ha

ROE

663/74

PL
A4252A
Gravel
3124

△ 20349
2457
1770.0334 ha
Cons of F & F
Vested in NPNCA
434/83

2021.4213 ha

347
16253
2302
1667.8208 ha

CG
2303
1591.0748 ha

SHIRE

CG
2036
597.5487 ha

CG
2304
1529.1402 ha

CG
1073
64.7497 ha

LAKE COBYNANA
1:50000

347
16999
2307