

NATURE RESERVE

RESERVE NO: 21175

GOVERNMENT GAZETTE  
Date Page No.

FILE NUMBER: 1019

PURPOSE: Conservation of Flora 12.6.59 1562

NAME:

CLASS (Land Act):

AREA: 125.4525 ha 12.6.59 1562

VESTING:

LOCATION NO(S): Victoria Loc. 10533

CLASSIFICATION:  
(Wildlife Act  
Section 12A)

LITHO: 90/80 F2

LOCAL AUTHORITY: COOROW SHIRE

Notes:

W 1019/76 231

22



DEPARTMENT OF LANDS AND SURVEYS

Cathedral Avenue,  
Perth,  
Western Australia 6000

Department of Conservation  
and Land Management  
23 APR 1986  
COMO, W.A.

Your Ref. W1019/76, W85/78 PT 10  
Our Ref. 3907/27V2 CN:AP  
Telephone Enquiries 323 1278

EXECUTIVE DIRECTOR  
DEPARTMENT OF CONSERVATION  
AND LAND MANAGEMENT

RESERVES 21175, 24325 and 28669

I refer to your memo of March 20, 1986 and advise for your information that Executive Council has:

- 1) approved of the amendment of Reserve No. 21175 (Victoria District) "Conservation of Flora" to comprise Victoria Location 11674 and of its area being increased to 121.5769 hectares.
- 2) approved of the purpose of Reserve No. 21175 (Victoria Location 11674) being changed from "Conservation of Flora" to "Conservation of Flora and Fauna" and issued an Order in Council directing that Reserve No 21175 shall vest in and be held by the National Parks and Nature Conservation Authority in trust for the purpose of Conservation of Flora and Fauna".

Notice to this effect was published in the Government Gazette of March 21, 1986 and I enclose a print showing the said amendment and the relevant Vesting Order.

Map enclosed (Mt Hawke  
1:50,000)  
cf 22/8/86

B. L. C. HALLIDAY  
UNDER SECRETARY FOR LANDS

17 April 1986

enc

30 30/A  
21/4/86

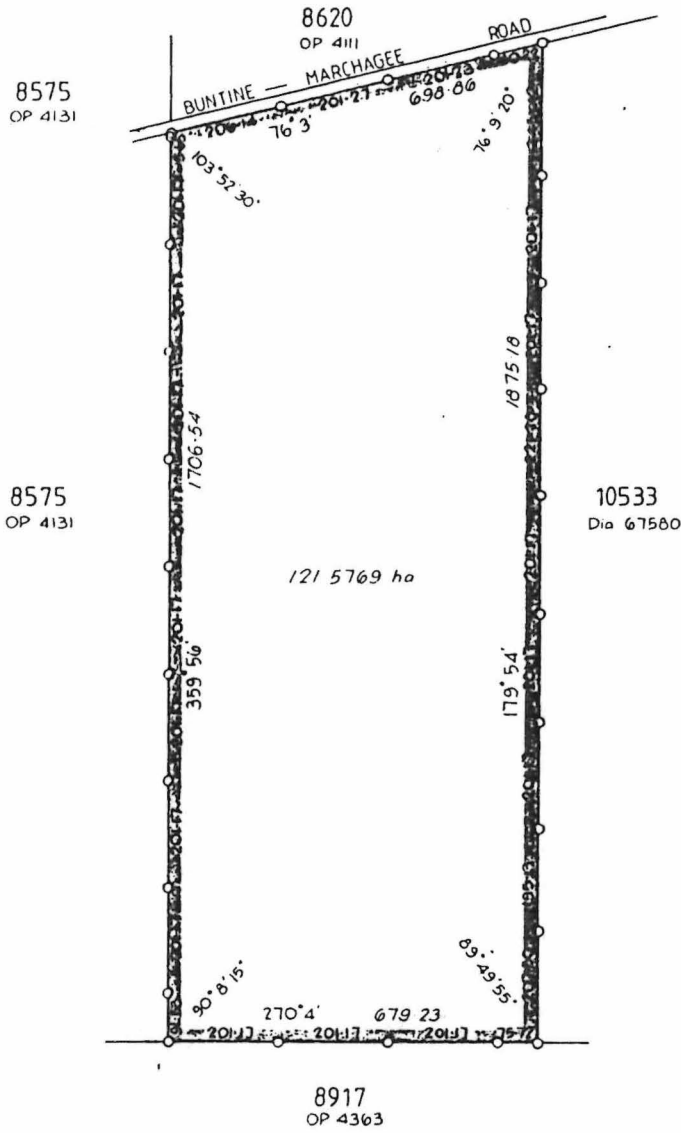

LAND DISTRICT VICTORIA	LOCATION 11674 (A 21175)		FILE No. 3907/27 V2
			SCALE 1:10 000 All measurements in metres
SURVEYOR'S CERTIFICATE I hereby certify that this survey was performed by me personally (or under my personal supervision, inspection and field check), in strict accordance with the Licensed Surveyors (Guidance of Surveyors) Regulations.  Date _____ Licensed Surveyor _____	Azimuth observed at _____ or assumed from <u>Diagram 67500</u> Date of marking _____ Surveyor _____ Field Book No. <u>COMPILED</u> Page _____ Cadastral Plan <u>Mount Howe 1:50 000</u> Reference <u>434670</u> Diagram Drawn <u>J.Berg</u> Date <u>20.11.05</u>	Calc. Bk. No. _____ Fol. _____ Compared with F.B. <u>[Signature]</u> Examined <u>[Signature] 18.2.06</u> Diagram passed _____ Inspector of Plans and Survey _____ Date _____	SURVEY APPROVED Date _____ Surveyor General _____ Recorded on Public Plan _____ Registered Key Plan No. <u>11674-1:50000</u> Custodian of Plans <u>3.12.05</u> DEPT. OF LANDS AND SURVEYS DIAGRAM No. <u>87248</u>