

**Customer Advices for Reserve Actions
1/12/1999 - 31/12/1999**

P. 33
ADVICE

Shire of Yilgarn 1/12/1999 - 31/12/1999

Reserve No.	Land Description	DOLA File No.	Volume/Folio	Action	Document No.	Lodge Date	Street Name	Area	Public Plans
17009		00291-1918-01RO	3111-708	Management Order to Water and Rivers Commission of Hyatt Centre 3 Plain Street East Perth for the designated purpose of "Water"	H323544	24/12/99	Bullfinch - Evanston Road	191.404 Ha	Jackson (250)
17009		00291-1918-01RO	3111-708	Revocation of Management Order () for the designated purpose of "Water"	H323545	24/12/99	Bullfinch - Evanston Road	194.2491 Ha	JACKSON (250)
17009	Yilgarn Location 1598 on Land Administration Miscellaneous Diagram 93796	00291-1918-01RO	3111-708	Amendment of Reserve to To comprise Yilgarn Location 1598 on Land Administration Miscellaneous Diagram 93796 and its area being recalculated (reduced) to 191.4040 hectares.	H323546	24/12/99	Bullfinch - Evanston road	191.404 Ha	Jackson (250)
18773		01899-1982-01RO	3060-738	Revocation of Management Order (Waters and Rivers Commission) for the designated purpose of "Water and Conservation of Flora and Fauna".	H308238	13/12/99	Gobetti Road	447.5926 Ha	Moorine Rock (50)
18773		01899-1982-01RO	3060-738	Management Order to Water and Rivers Commission of Hyatt Centre 3 Plain Street, East Perth Power to Lease for the designated purpose of ""	H308237	13/12/99	Gobetti Road	447.5926 Ha	Moorine Rock (50)
18773	Jilbadji Location 241	01899-1982-01RO	3060-738	Amendment of Reserve to To comprise Jilbadji Location 241 on Land Administration Diagram 94039 and its area being reduced (recalculated) to 447.5926 hectares.	H308239	13/12/99	Gobetti Road	447.5926 Ha	Moorine Rock (50)
18920		01900-1982-01RO	3092-832	Revocation of Management Order (Water & Rivers Commission) for the designated purpose of "Water".	H323549	24/12/99	Irving Road cnr Nulla South Road	178.5002 Ha	Moorine Rock 1: 50000
18920		01900-1982-01RO	3092-832	Management Order to Water and Rivers Commission of Hyatt Centre 3 Plain Street East Perth for the designated purpose of "Water"	H323548	24/12/99	Irving Road cnr Nulla South Road	178.5002 Ha	Moorine Rock 1:50000
20447		01344-1930-01RO	3008-660	Revocation of Management Order () for the designated purpose of "Water Supply".	H323542	24/12/99	Dorothy Street	0.6374 Ha	BM37(2)07.10
20447		01344-1930-01RO	3008-660	Management Order to Water and Rivers Commission of Hyatt Centre 3 Plain Street East Perth for the designated purpose of "Water Supply"	H323540	24/12/99	Dorothy Street	0.6374 Ha	BM37(2)07.10
20447	Bullfinch Lot 302 on Miscellaneous Diagram 94011	01344-1930-01RO	3008-660	Amendment of Reserve to Bullfinch Lot 302 on Land Administration Miscellaneous Diagram 94011 and its area remaining unaltered	H323541	24/12/99	Dorothy Street	0.6374 Ha	BM37(2)07.10
21980		02155-1938-01RO	3072-212	Management Order to National Parks and Nature Conservation Authority of P.O Box 104, Como for the designated purpose of "Conservation of Flora and Fauna."	H323529	24/12/99	Holleton Townsite	1.6997 Ha	Holleton (50)
21980	Leake Location 194 on Land Administration Miscellaneous Diagram 94244	02155-1938-01RO	3072-212	Change of Purpose to "Conservation of Flora and Fauna"	H323532	24/12/99	Holleton Townsite	1.6997 Ha	Holleton (50)
21980	Leake Location 194 on Land Administration Miscellaneous Diagram 94244	02155-1938-01RO	3072-212	Amendment of Reserve to To comprise Leake Location 194 on Land Administration Miscellaneous Diagram 94244 and its area being increased (recalculated) to 1.6997 hectares	H323531	24/12/99	Near Holleton Road	1.6997 Ha	Holleton 1:50000

NOTE FOR C. BATHIGANE ⇒ INCLUDE MILE O'DENMARK IN THE ACTION SHEET 1

C. BATHIGANE 3/2/00
 THANKS
 4/4 9/3
 1/ CLARENCE HOALE (LMB)
 (A) FOR PLAN (B) TO AMEND YOUR RECORDS IF NECESSARY
 46

268

995-1574 ha

306

987-4522 ha

470

816/80

55

465

816/80

LEAKE

EUCLA

△ 19923

3091-7980 ha

Timber (Mining)

△ 19578

192

1.6920 ha

Recreation

Holleton

See Enlarged Plan

△ 21086

8 2556 ha

Aerial

Landing

Ground

△ 20209

189

1246 ha

Water

△ 20161

188

2.0411 ha

Sanitary Site

△ 21980

194

1.6997 ha

(Cons of

Flora & Fauna

Vested in NPWCA

△ 19577

Holleton lot 2

1012 m²

Hall Site

△ 20937

191

4.0469 ha

Cemetery

HOLLETON

ROAD

CG

9

404-8880 ha

CG

8

442-5769 ha

CG

193

661-0060 ha

ROAD

CG

3

482-3347 ha

5460 000mN

ROAD

• LOOKOUT HILL

CG

10

558-8456 ha

SHIRE

OF

NAREM

CG

7

643-6803 ha

ROAD

CG

6

524-9481 ha

ROE DISTRICT
SOUTH-WEST LAND DIVISION

SOUTH WEST MINERAL FIELD

Rd. No. 521
Rd. No. 10715
Cl. 241
520 4991 ha

Part plan Holleton 695
SCALE 1:50,000

32° 00'

119° 00'









650000mE

05'

CALM-MANAGED LANDS AND WATERS

AS AT 30th JUNE 1999

Legend

-  National Park
-  Conservation Park
-  Nature Reserve
-  State Forest, Timber Reserve, Freehold & Other Reserve
-  Section 5(g) Reserve
-  Leasehold in the name of the Executive Director
-  Marine Park / Marine Nat Res / Marine Management Area
-  CALM Region Boundary
-  CALM Regional Office

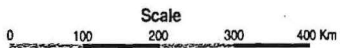

Projection: Polyconic, Origin 121°, 0°



CALM
CONSERVATION and LAND MANAGEMENT

Produced by INFORMATION MANAGEMENT BRANCH

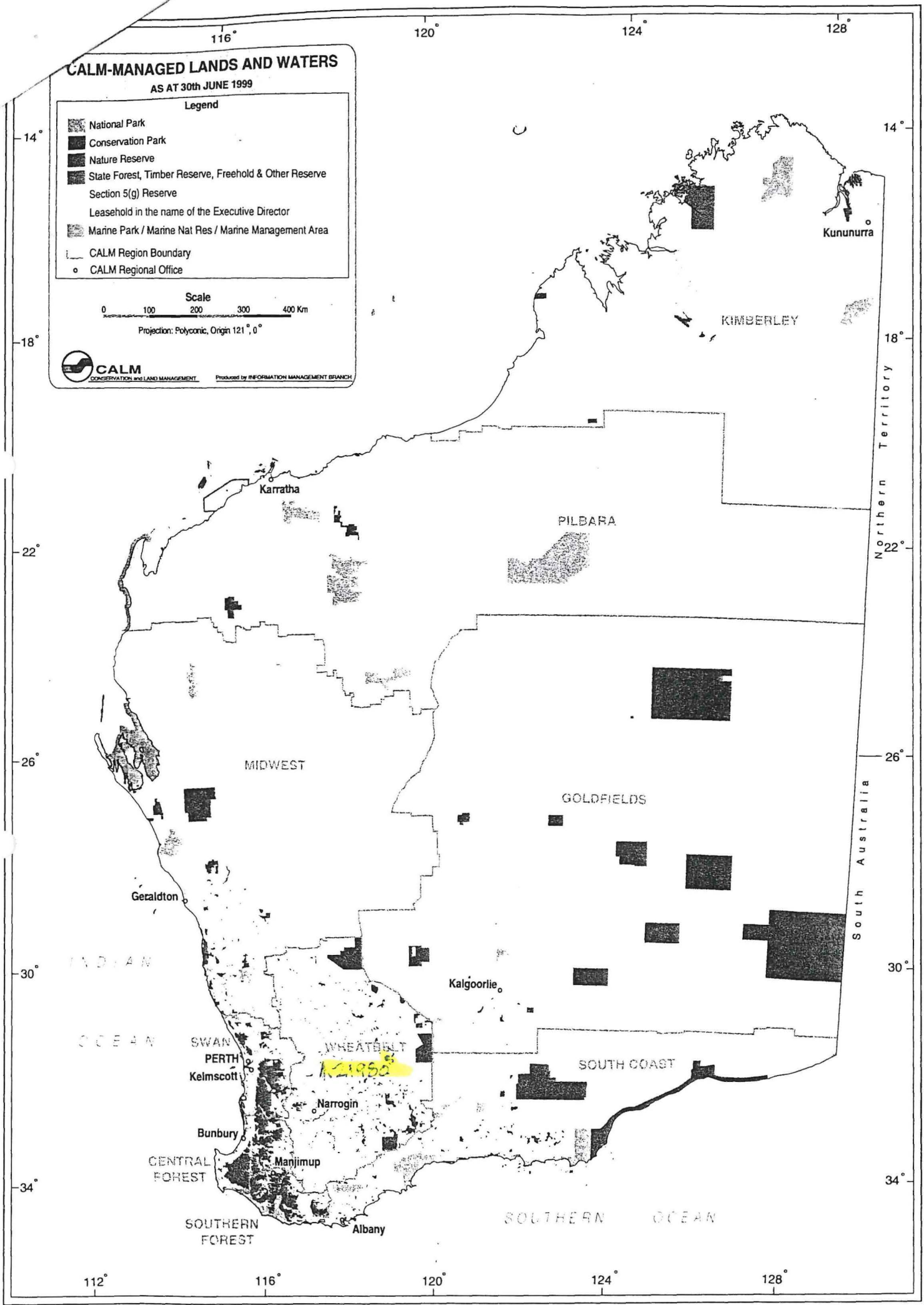

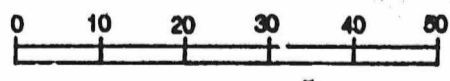
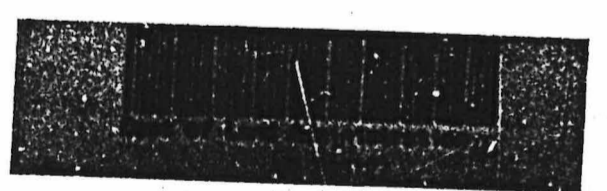
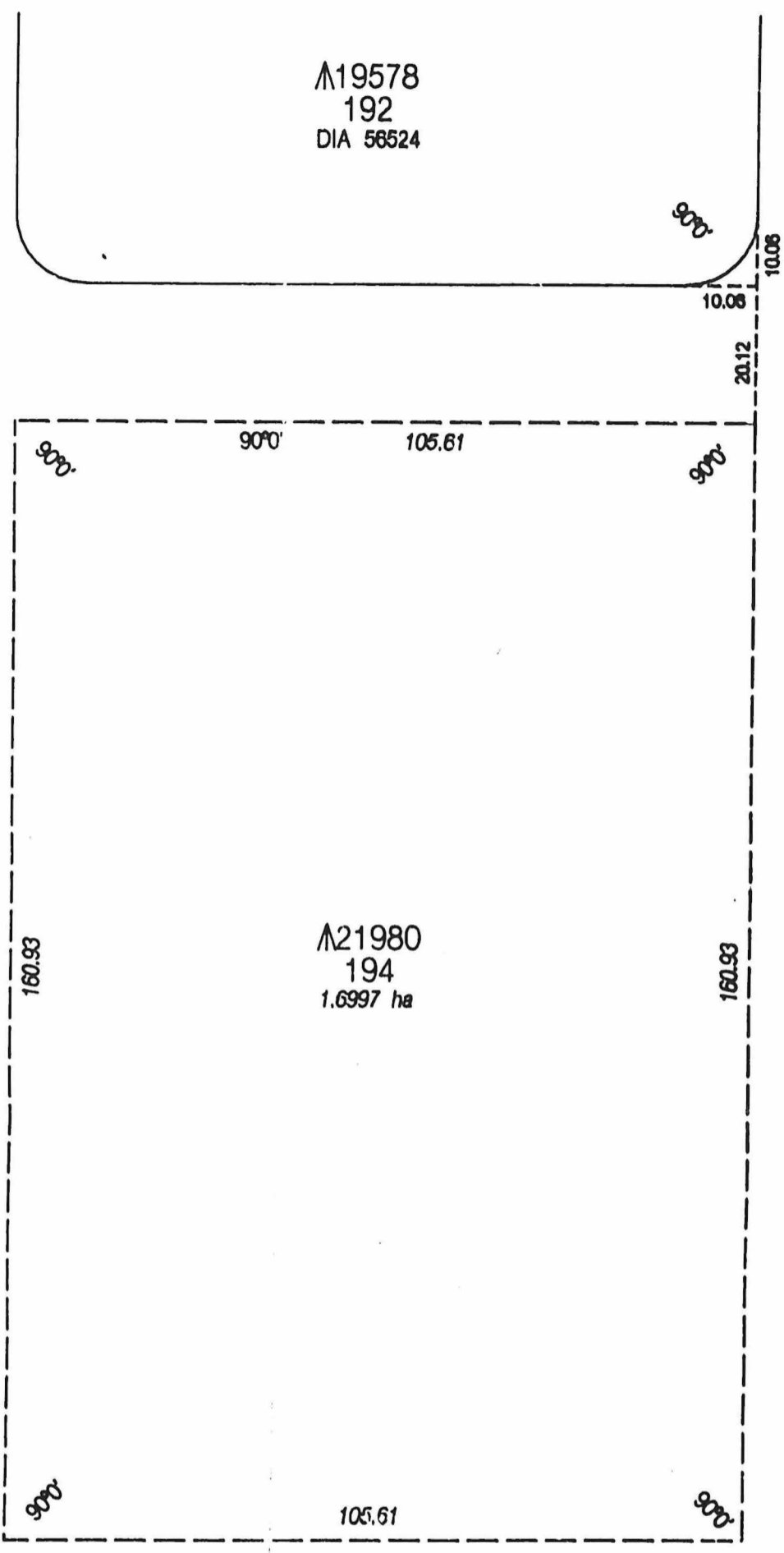

LEAKE		LOCATION 194		IN ORDER FOR DEALINGS	
AUTHORITY SHIRE OF YILGARN				SUBJECT TO	
55/938		SUBJECT TO SURVEY NOT FOR ALIENATION PURPOSES		
1:1000 metres				
LETON (50)		On S.I.P. HOLLEYON (50)		FOR AUTHORIZED LAND OFFICER DATE	
Page				APPROVED	
Date 1.8.99				
Person		Recorded on Public Plan		AUTHORIZED LAND OFFICER Date	
Date 2.6.99		Date		
ECT		Document Registered		LAND ADMINISTRATION ACT	
Date 3.6.99		Date		MISCELLANEOUS	
Manager Statutory Services.		DOLA Department of Land Administration		DIAGRAM 94244	