

File No. 679/982.

CANNING.—40240 (Recreation) Loc. No. 3297 (4.017 7 ha). Diagram 85224 (Public Plan Perth 1:2000 14.19 and 14.20 (Murray Street).)

File No. 2932/985.

MURCHISON.—40237 (Depot Site) Loc. No. 200 (3 525 m²). Original Plan 16410. (Public Plan Byro 1:250 000 (Carnarvon-Mullewa Road).)

File No. 1991/987.

MENZIES.—40232 (Housing—Shire of Menzies).—Lot No. 1081 (1 519 m²). Diagram 88028. (Public Plan Menzies Townsite (Walsh Street).)

File No. 2095/987.

KALGOORLIE and BOULDER.—40203 (Use and Requirements of the Government Employees Housing Authority) Kalgoorlie Lot Nos. 4017, 4041, 4128, 4265, 4268, 4270 and Boulder Lot Nos. 3703, 3722, 3739 and 3745 (8 621 m²). Original Plans 16618, 16428 and 16915. (Public Plan Kalgoorlie-Boulder & Environs 1:2000 CF 37/28.40 (Compton Court, Hicks and Graeme Streets and Morley and Miller Way).)

N. J. SMYTH,
Executive Director.

AMENDMENT OF RESERVES

Department of Land Administration,
Perth, 20 November 1987.

HIS Excellency the Governor in Executive Council has been pleased to approve, under section 37 of the Land Act 1933 of the amendment of the following Reserves—

File No. 2134/986.—No. 39716 (Halls Creek Lots 409 and 410) "Recreation" to include Halls Creek Lot 411 as surveyed on Land Administration Original Plan 16477 and of its area being increased to 5 230 square metres accordingly. (Plan Halls Creek 1:2000 32.25 (Stretch Street).)

File No. 1099/980.—No. 36962 (Corrigin Lot 479) "Shire Depot Site" to include Corrigin Lot 486 as surveyed on Lands and Surveys Diagram 83962 and of its area being increased to 4.168 5 hectares accordingly. (Plan Corrigin 1:2000 12.22 (Rendell Street).)

File No. 791/79.—No. 35897 (Broome Lots 1330, 1652, 1686 and 1687) "Drain" to exclude Lot 1652 and include Broome Lot 2089 as surveyed on Land Administration Original Plan 16767 and of its area being increased to 4 570 square metres accordingly. (Plan Broome 1:2000 29.13 (Livingston Street).)

File No. 1091/73.—No. 34206 (Murchison District) "Recreation" to comprise Murchison Location 199 as surveyed and shown bordered red on Lands and Surveys Original Plan 16410 in lieu of Murchison Location 178 and of its area being increased to 343.817 1 hectares accordingly. (Plan Byro 1:250 000 (Carnarvon-Mullewa Road).)

File No. 2791/69.—No. 31502 (Kalbarri Lots 564 and 565) "Rubbish Disposal Site" to exclude Lot 564 and of its area being reduced to 2.098 5 hectares accordingly. (Plan Kalbarri Regional 1:10 000 BD:46/Pts 5.2, 5.3, 6.2 and 6.3 (Atkinson Crescent).)

File No. 1698/63.—No. 30138 (Murchison District) "Municipal Buildings" to comprise Murchison Location 201 as surveyed and shown bordered red on Lands and Surveys Original Plan 16410 in lieu of Murchison Location 170 and of its area being increased to 3.735 5 hectares accordingly. (Plan Byro 1:250 000 (Carnarvon-Mullewa Road).)

File No. 1946/48.—No. 22797 (Wellington District) "Conservation of Flora and Fauna" to comprise Wellington Locations 5525 and 5526 as surveyed and shown bordered red on Land Administration Original Plan 16920 in lieu of Locations 2746 and 3920 and of its area being increased to 374.388 7 hectares accordingly. (Plan Harvey N.E. and Tallanalla N.W. 1:25 000 (Falls Brook Nature Reserve).)

File No. 1234/92V7.—No. 10876 (Victoria District) "Stock Route" to agree with recalculation of area and of its area being reduced to 990.282 1 hectares accordingly.

File No. 10061/04.—No. 9751 (at Wannamal) "Recreation" to comprise Wannamal Lot 57 as surveyed on Lands and Surveys Diagram 19599 and of its area remaining unaltered. (Plan Wannamal Regional 1:10 000 (Bindoon-Moora Road).)

File No. 12127/897D.—No. 6346 (Menzies Lot 101) "Public Buildings" to exclude that portion now comprised in Menzies Lot 1081 as surveyed and shown on Land Administration Diagram 88028 and of its area being established at 1.659 1 hectares accordingly. (Plan Menzies Townsite (Walsh Street).)

File No. 3678/94.—No. 2906 (De Grey District) "Common" to exclude those portions now comprised in De Grey Locations 70, 72 to 76 inclusive and the portions coloured dark brown on Land Administration Original Plan 16831 and of its area being reduced to 20 125.136 0 hectares accordingly. (Plan Marble Bar Regional 1:10 000 BN64/04.04) (Garden Road).

File No. 2423/76.—No. 1224 (Swan District) "Camping" to comprise Swan Location 11028 as surveyed on Lands and Surveys Original Plan 6481 and of its area remaining unaltered. (Plan Mindarra S.W. 1:25 000 (Off Brand Highway).)

N. J. SMYTH,
Executive Director.

CANCELLATION OF RESERVES

Department of Land Administration,
Perth, 20 November 1987.

HIS Excellency the Governor in Executive Council has been pleased to approve, under section 37 of the Land Act 1933 of the cancellation of the following Reserves—

File No. 165/60.—No. 25589 (Bodallin Lots 20 and 21) "Water Supply Purposes". (Plan Bodallin Townsite (Griffiths Road).)

File No. 5909/23.—No. 22958 (Wellington Location 3930) "Public Utility". (Plan Tallanalla NW 1:25 000 (near Road No. 10370).)

File No. 2680/07.—No. 14564 (Wellington Location 2258) "Timber for Settlers". (Plan Tallanalla NW 1:25 000 (near Stirling Road in the Shire of Harvey).)

File No. 6396/06.—No. 10745 (Wellington District) "Preservation of Waterfall". (Plan Harvey NE 1:25 000 (Road No. 4217).)

File No. 4096/09 V2.—No. 10456 (Doodlakine Lots 34, 52, 60, 126, 130, 139, 140 and 178) "Excepted from Sale". (Plan Doodlakine 1:2 000 12.23 and 13.23 (Station Street).)

N. J. SMYTH,
Executive Director.

CHANGE OF PURPOSE OF RESERVE

Department of Land Administration,
Perth, 20 November 1987.

HIS Excellency the Governor in Executive Council has been pleased to approve, under section 37 of the Land Act 1933, of the purpose of the following Reserves—

File No. 1291/980.—No. 37089 (Karratha Lot 2507) being changed from "Depot Site" to "Depot Site (CALM)". (Public Plan Karratha 1:2 000 32.24 and 33.24 (Fisher Way).)

File No. 1099/980.—No. 36962 (Corrigin Lots 479 and 486) being changed from "Shire Depot Site" to "Depot Site". (Public Plan Corrigin 1:2 000 12.22 (Rendell Street).)

File No. 1091/73.—No. 34206 (Murchison Location 199) being changed from "Recreation" to "Recreation and Aerial Landing Ground". (Public Plan Byro 1:250 000 (Carnarvon-Mullewa Road).)

File No. 2689/63.—No. 31163 (Avon Location 28224) being changed from "Biological Station and Conservation of Flora and Fauna" to "Research and Conservation of Flora and Fauna". (Public Plan Woyerling NW 1:25 000 (Marshall Road).)

File No. 4791/13 V6.—No. 29241 (Cockburn Sound Location 2130) being changed from "Conservation of Fauna (University Marsupial Research)" to "Research and Conservation of Flora and Fauna". (Public Plan Perth 1:10 000-BG 34/3.1 (Russell Road).)

File No. 11706/01.—No. 26542 (Mariginiup Lot 38) being changed from "Camping and Recreation" to "Recreation". (Public Plan Swan 1:2 000 10.09 (Pinjar Road).)

CHERK WOODVALE - Note: The cancelled reserve has been included in 20.6.88
22797

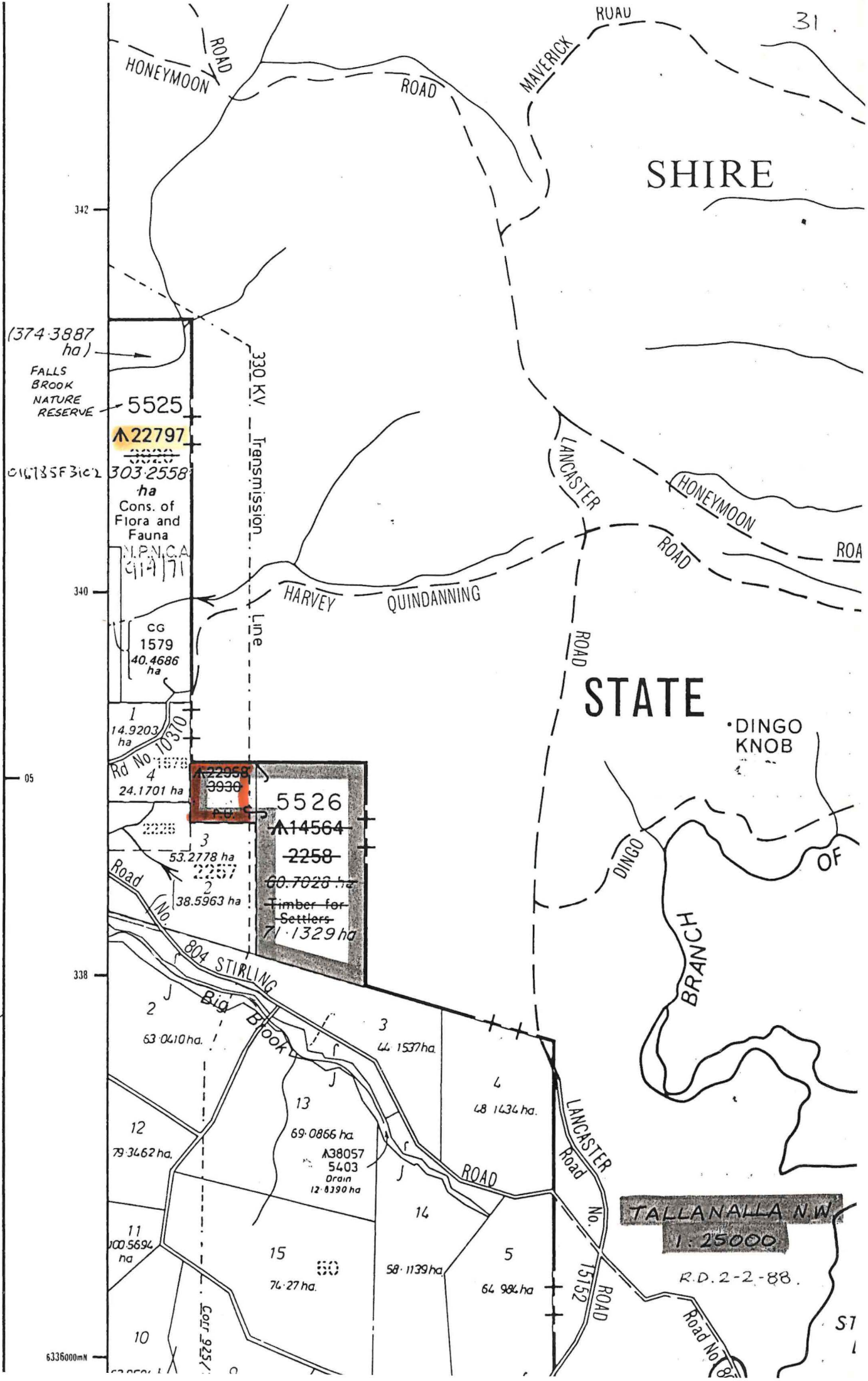

SHIRE

STATE

DINGO KNOB

TALLANALLA N.W.
1:25000

R.D. 2-2-88.

HONEYMOON ROAD

ROAD

MAVERICK ROAD

ROAD

31

342

(374.3887 ha)

FALLS BROOK NATURE RESERVE

5525

A22797

016135F3ic2

303.2558 ha

Cons. of Flora and Fauna

N.P.N.C.A. 919171

340

330 KV Transmission Line

HARVEY

QUINDANNING

LANCASTER ROAD

HONEYMOON ROAD

ROAD

CG 1579 40.4686 ha

1 14.9203 ha

Rd No. 1578 4 24.1701 ha

22956 3936

5526

A14564

2258

60.7028 ha

Timber for Settlers 71.1329 ha

3 53.2778 ha

2 38.5963 ha

338

804 STIRLING ROAD

2 63.0410 ha

3 44.1537 ha

4 48.1434 ha

12 79.3462 ha

13 69.0866 ha
A38057 5403 Drain 12.8390 ha

14

LANCASTER ROAD

11 100.5694 ha

15 76.27 ha

14 58.1139 ha

5 64.984 ha

LANCASTER ROAD No. 15152

TALLANALLA N.W. 1:25000

R.D. 2-2-88.

6336000M

ST