

NATURE RESERVE

RESERVE NO: "A" 23187

GOVERNMENT GAZETTE
Date Page No.

FILE NUMBER: 630/67

PURPOSE: Cons. of Flora & Fauna 16.9.66 2471

NAME: "Nangeen Hill Wildlife Sanctuary" 28.1.72 181
Nature Reserve 4-5-73 1147

CLASS (Land Act): "A" 11.3.77 751

AREA: 176.4429 ha (approx)

VESTING: W.A.W.A. 28.9.70 2683

LOCATION NO(S): Kwolyn A.A. 361

CLASSIFICATION: Prohibited Area 18.12.70 3818
(Wildlife Act
Section 12A)

LITHO: 4/80 A,B2 and 1:50,000 sheet 2434-111 - FANTAPINS.









LOCAL AUTHORITY: BRUCE ROCK SHIRE

Notes:

CALM-MANAGED LANDS AND WATERS

AS AT 30th JUNE 1999

Legend

-  National Park
-  Conservation Park
-  Nature Reserve
-  State Forest, Timber Reserve, Freehold & Other Reserve
-  Section 5(g) Reserve
-  Leasehold in the name of the Executive Director
-  Marine Park / Marine Nat Res / Marine Management Area
-  CALM Region Boundary
-  CALM Regional Office

Scale
0 100 200 300 400 Km

Projection: Polyconic, Origin 121° 0'



CALM
CONSERVATION AND LAND MANAGEMENT

Produced by INFORMATION MANAGEMENT BRANCH

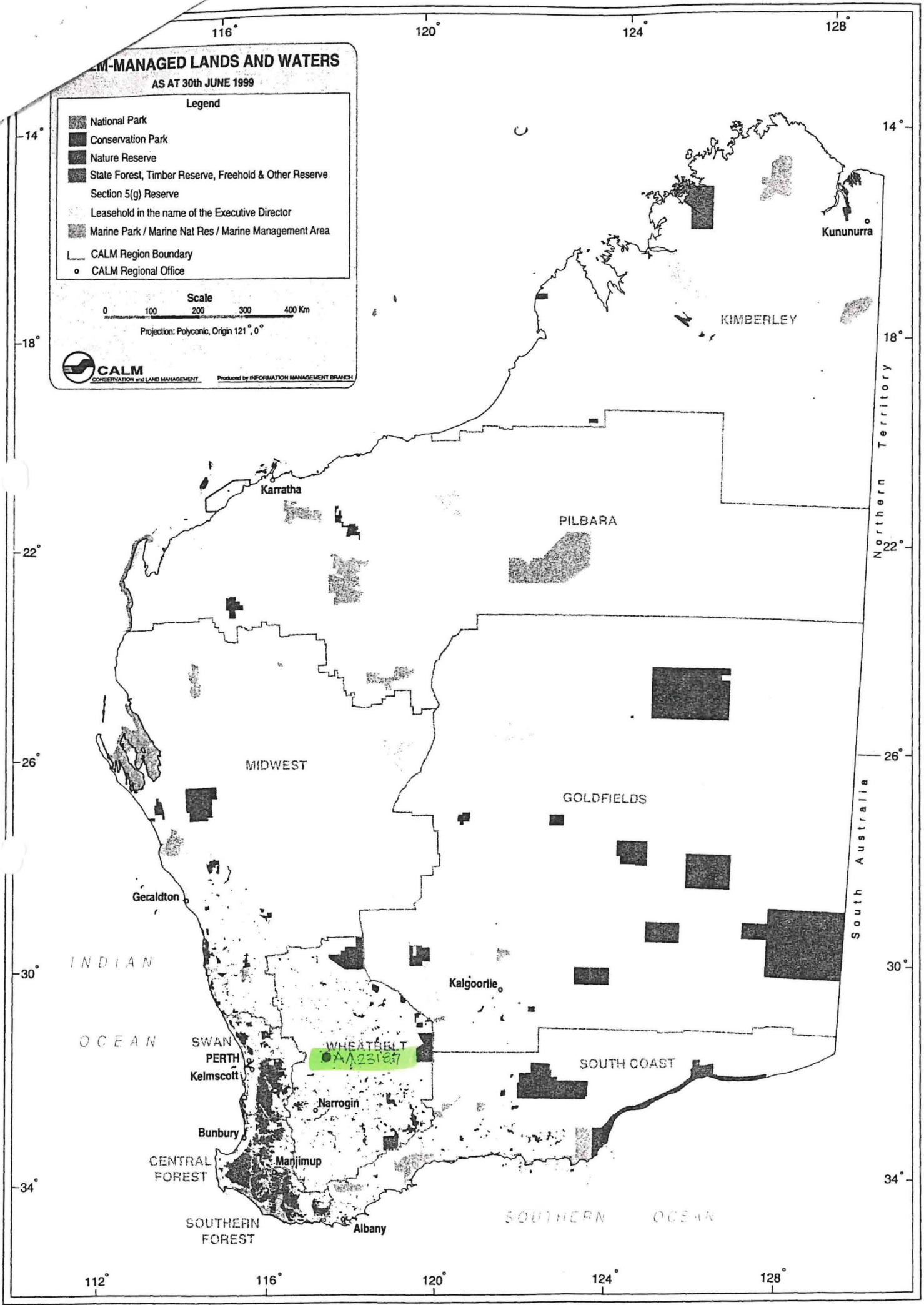

INCLUDES A.A. LOT 361 (A9431)
SUPERSEDES PT O.P. AVON 944

KWOLYIN

98
DIA 35134

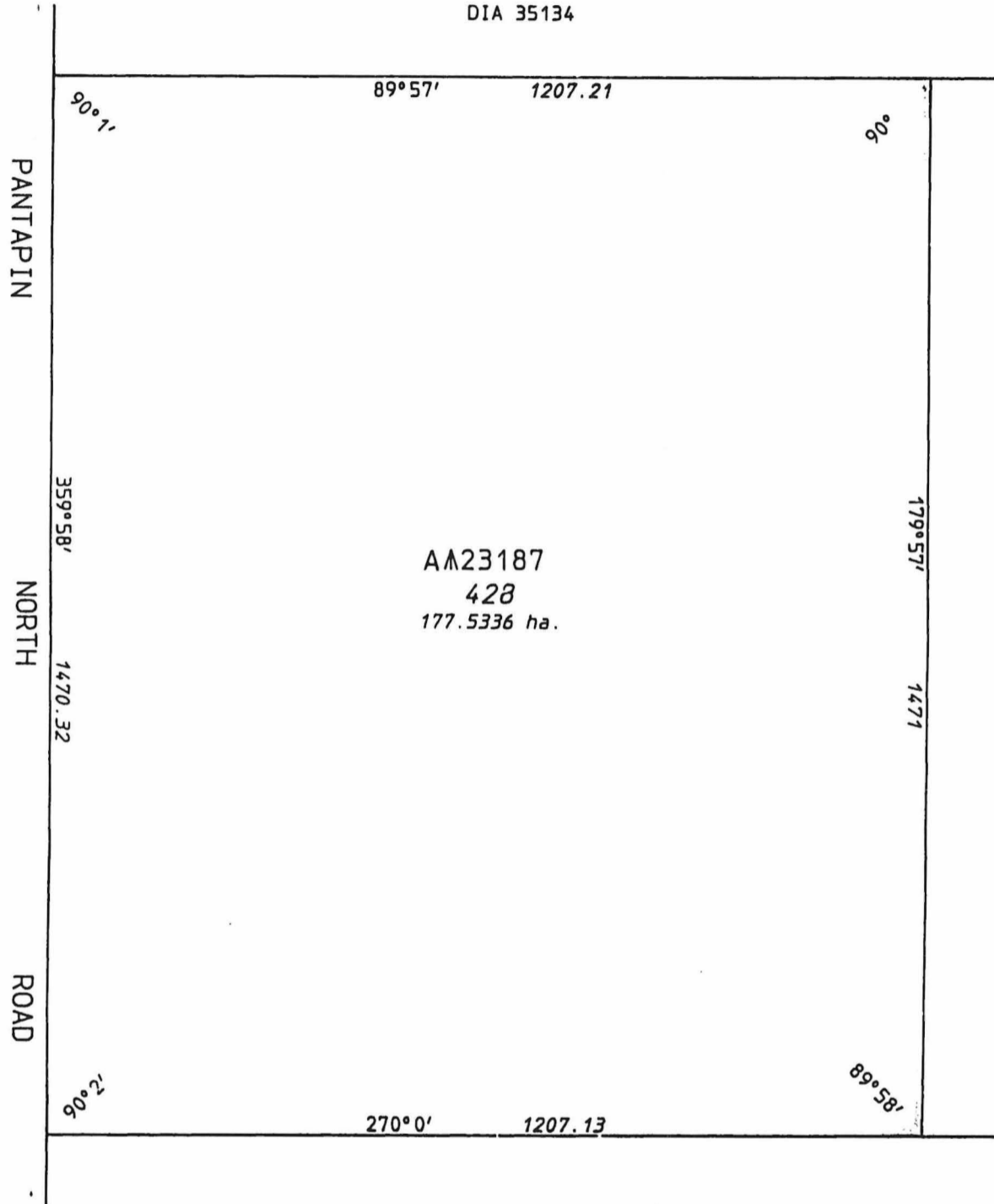

I, K. M. DUFTY hereby certify that-
(a) this plan of survey is a correct and accurate representation of the survey(s) for the subject land; and
(b) this plan conforms with the relevant law in relation to which it is lodged.

100
O.P. AVON 944 AGRICULTURAL AREA



DATE: 5/7/95 LICENSED SURVEYOR: [Signature]

COMPILED FROM O.P. AVON 944 & DIA's 35134 & 35135

| | | | | | |
|---|--|---|--|--|---|
| LAND DISTRICT AVON | | KWOLYIN AGRICULTURAL AREA LOT 428 | | | |
| SURVEYOR'S CERTIFICATE I hereby certify that:- (a) this plan of survey is a correct and accurate representation of the survey carried out by me personally / under my own personal supervision, inspection and field check and recorded in fieldbooks lodged for the purpose of this plan of survey; (b) the measurements are in strict accordance with the Licensed Surveyors (Guidance of Surveyors) Regulations 1981 and in particular regulations 23 and 34 of those regulations; and (c) this survey and this plan of survey are in strict accordance with the requirements of the Licensed Surveyors (Guidance of Surveyors) Regulations 1981 and the relevant law in relation to which it is lodged. Licensed Surveyor <u>COMPILED</u> Date _____ (to strike out which ever does not apply) | | | SCALE 1:8000 measurements in metres | FILE 13617/908 V2 | |
| Prepared by: JOHN BULLOCK & ASSOCIATES | | IN ORDER FOR DEALINGS: <u>Reserve action</u> SUBJECT TO | | SURVEYOR FIELD BOOK _____ Page _____ Date of Marking _____ | PUBLIC PLAN(S): PANTAPIN NE (25) RECORDED: _____ Date: _____ SURVEY INDEX PLAN(S): PANTAPIN NE (25) RECORDED: T. B. D. Date: 20.7.95 |
| TYPE OF VALIDATION Full Audit: <u>[Signature]</u> Date <u>20.7.95</u> Legal Component: _____ Date _____ | | AUTHORIZED LAND OFFICER <u>[Signature]</u> DATE <u>2.2.2000</u> APPROVED Authorized Land Officer Date _____ | | AZIMUTH FROM OBS ON O.P. AVON 944 LOCAL AUTHORITY: SHIRE OF BRUCE ROCK LOCALITY: LODGED N. K. K. 10.7.95 | DEPARTMENT OF LAND ADMINISTRATION DIAGRAM 92332 |
| In order for further action <u>[Signature]</u> Date <u>20.7.95</u> | | | | | |

015902F3102