



DEPARTMENT OF LANDS AND SURVEYS

Cathedral Avenue,
Perth,
Western Australia 6000

DEPARTMENT OF CONSERVATION
AND LAND MANAGEMENT
2 - JUL 1985
C.D.O. W.A.

Your Ref.

F & W 887/76.

Our Ref.

846/30 CN:KMH.

Telephone
Enquiries

323 1278.

Executive Director,
Department of Conservation and
Land Management,
State Operations Headquarters,
50 Hayman Road,
COMO C.D.O.

RESERVES 1017 AND 23772.

I refer to your memo of February 19, 1985 and advise for your information that Executive Council has:-

1. approved of:-
 - a) the cancellation of Reserve No. 23772 (Victoria District) "Townsite".
 - b) the amendment of Reserve No. 1017 (Victoria Location 9316) "Protection of Flora" to include Victoria Location 11565 and of its area being increased to 548.5286 hectares.
 - c) the purpose of Reserve No. 1017 (Victoria Locations 9316 and 11565) being changed from "Protection of Flora" to "Conservation of Flora and Fauna".
2. issued an Order in Council directing that Reserve No. 1017 (Victoria Locations 9316 and 11565) shall vest in and be held by the Western Australian Wildlife Authority in trust for the purpose of "Conservation of Flora and Fauna".

Notice to this effect was published in the Government Gazette of February 15, 1985 and I enclose a print showing the said amendment and the relevant Vesting Order.

Please accept my apologies for any inconvenience caused by my delay in advising you.

Yours faithfully,

UNDER SECRETARY FOR LANDS

June 28, 1985.

Encl:

slr
slr
① J.C. Reeves

Map previously done.
156/80.

cf 29.8.86

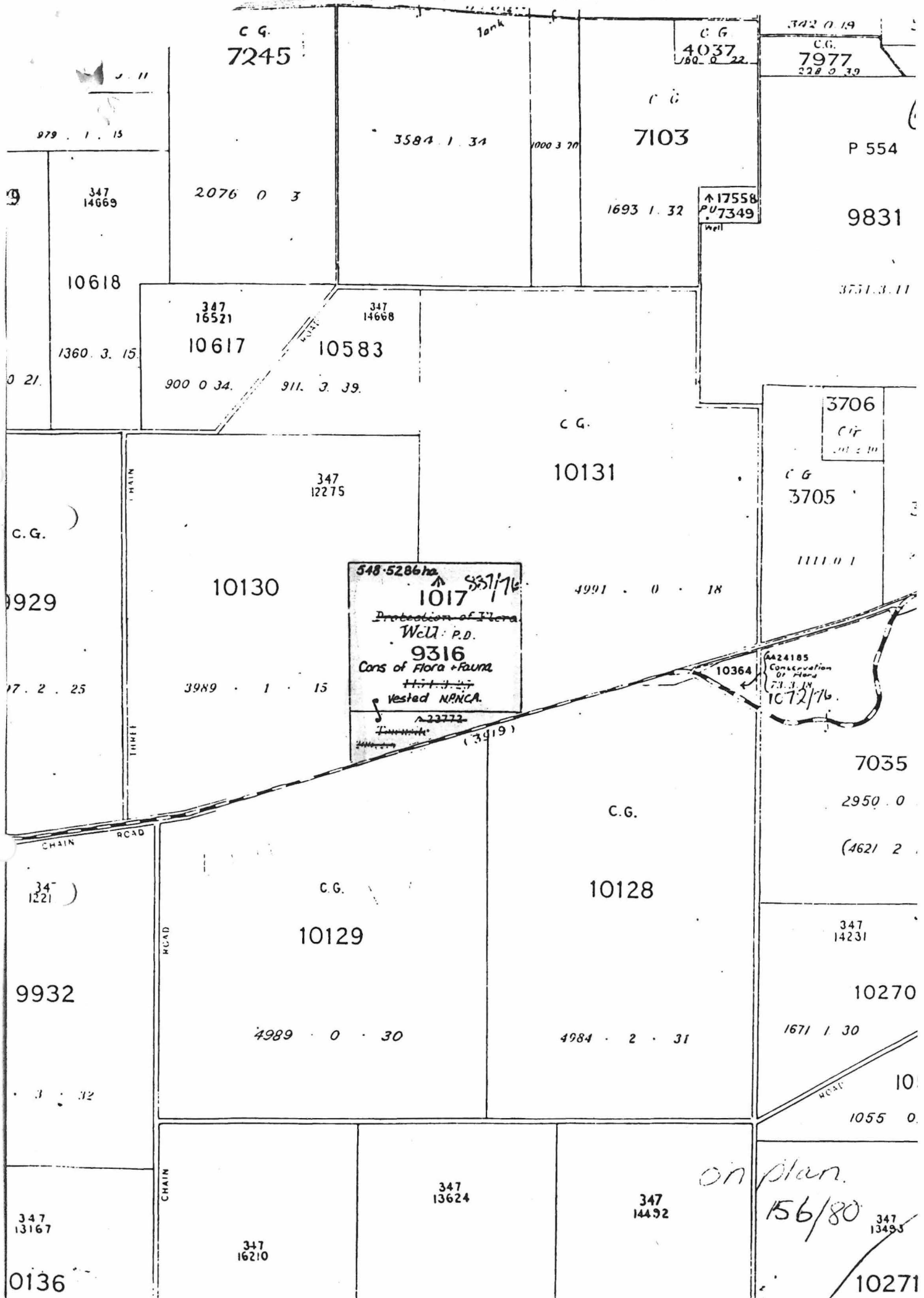

C.G.
7245

C.G.
4037
180.0.22

342.0.19
C.G.
7977
228.0.39

3584.1.34

C.G.
7103

P 554

9831

3751.3.11

347
14669

2076.0.3

1693.1.32

↑17558
PU7349
Well

10618

347
16521

347
14668

10617

10583

900.0.34

911.3.39

1360.3.15

3706

C.G.
10131

C.G.
3705

1111.0.1

C.G.
10131

347
12275

10130

548.5286ha
↑ 357/76
1017
Protection of Flora
Wetland P.D.
9316
Cons of Flora + Fauna
Vested NPWS
23772
(3919)

4991.0.18

10364

424185
Conservation of Flora
7.3.14
1072/76

7035

2950.0

(4621.2)

C.G.

C.G.
10128

C.G.

10129

4989.0.30

4984.2.31

347
14231

10270

1671.1.30

10

1055.0

347
1221

9932

347
13167

0136

347
13624

347
16210

347
14492

on plan
156/80

347
13493

10271