

Department of  
**LAND ADMINISTRATION**

File: 024959F3201

CLERK, WOODVALE

23  
R

Your Ref:

Our Ref: 2531/54V3 CA:LW

Telephone: 323 1614 C. ABEY  
Enquiries:

Department of Conservation  
and Land Management  
17 JAN 1989  
GOMU, W.A.

┌

┐

EXECUTIVE DIRECTOR  
DEPARTMENT OF CONSERVATION AND  
LAND MANAGEMENT  
CDO

└

┘

24491

RESERVE NO. -23589 AT MERREDIN

I advise for your information that in accordance with Reserves and Land Revestment Act No. 67 of 1988 that:-

Reserve No. 24491, classified as of Class A, containing 39.975 hectares or thereabouts, set apart for "National Park" and vested in the National Parks and Nature Conservation Authority is hereby amended by:-

- (a) excluding an area of 16.1900 hectares being Victoria Location 11736.
- (b) including an area of 16.1900 hectares being Victoria Location 10359.

Further formal action as a result is now necessary and when finalised you will be informed accordingly.

I enclose a print showing the said reserve.

M.

S. BURGESS  
ACTING MANAGER  
PROPERTY MANAGEMENT BRANCH  
LAND OPERATIONS DIVISION

January 13, 1989

Enc.

PM012LW1

23-1-89

1/DMA p291

2/SC Reserves

19. Class A Reserve 4561 "Parklands" to comprise Canning Location 3597 as shown on Original Plan 16929 and of its area being increased to 498.228 3 hectares. Public Plans Perth 1:2 000 23.01, 24.01 Peel 1:2 000 23.38, 23.39, 23.40, 24.39, 24.40, 25.39 and Peel 1:10 000 10.16. File 2295/97V2.
20. Class A Reserve 1668 "Recreation" to comprise Swan Location 10693 as shown on Diagram 87053 and of its area being reduced to 9.132 7 hectares. Public Plan Perth 1:2 000 09.19. File 3128/47.
21. Class A Reserve 1624 "Recreation" to comprise Swan Location 10694 as shown on Original Plan 16425 and of its area being increased to 8.450 hectares. Public Plan Perth 1:2 000 09.19. File 3128/47.
22. Class A Reserve 12397 "Water" to comprise Avon Location 28942 as shown on Diagram 88385 and of its area being reduced to 3.710 9 hectares. Public Plan Mears NW 1:25 000. File 79/06V2.
23. Class A Reserve 15860 "Parklands and Recreation" to comprise Bridgetown Lot 894 as shown on Original Plan 16454 and of its area being increased to 4.670 hectares. Public Plans Bridgetown 1:2 000 30.01, 31.01. File 434/981.
24. Class A Reserve 24491 "National Park" to exclude that portion now comprised in Victoria Location 11736 as shown on Diagram 88283 and include Victoria Location 10359 as shown on Original Plan 6632 and of its area remaining unaltered. Public Plan Tanche 1:50 000. File 2531/54V3.
25. Class A Reserve 35118 "Historical Site and Buildings" to include Onslow Lot 699 and of its area being increased by 20.487 2 hectares. Public Plan Onslow Townsite Sheet 1. File 2070/70.
26. Class A Reserve 6627 "Conservation of Flora and Fauna" to include Murray Location 1847 and of its area being increased by 19.424 9 hectares. Public Plan Mandurah and Environs 1.10 000 1-5. File 3543/99.
27. Class A Reserve 18705 "National Park" to exclude the area coloured pink on Miscellaneous Plan 1657 and of its area being reduced by 590 hectares. Public Plans Deeside SW, SE, Mount Johnston NW, Shannon NE, SE, SW, NW Wainbup NE, NW 1:25 000. File 1851/22V4.
28. Class A Reserve 17495 "National Park" to exclude that portion now comprised in Nelson Location 13304 as shown on Diagram 88657 and of its area being reduced by 98.940 hectares. Public Plan Gardner River NW 1:25 000. File 894/44V4.
29. Class A Reserve 38881 "Recreation, Camping, Caravan Park and Holiday Cottages" to include Nelson Location 13304 and of its area being increased by 98.940 hectares. Public Plan Gardner River NW 1:25 000. File 894/44V4.

Change of Purpose of Reserves

The purposes of the following reserves have been changed:—

1. Class A Reserve 39825 from "Conservation and the Agreement defined in Section 2 of the Alumina Refinery Agreement Act 1961" to "National Park" Public Plans Jarrahdale 1:2 000 25.22, Peel 1:10 000 5.3, 5.4, 5.5, 6.5, Jarrahdale NW, SW 1:25 000. File 449/987.
2. Class A Reserve 1624 from "Recreation" to "Parkland and Recreation". Public Plan Perth 1:2 000 09.19. File 3128/47.
3. Class A Reserve 17826 from "Park and Gardens" to "Park Gardens and Parking". Public Plans Perth 1:2 000 14.23, 14.24. File 2745/21.
4. Class A Reserve 27322 from "Park and Recreation" to "Recreation and Foreshore Management".

Cancellation of Reserve

Class A Reserve 8103 "Recreation" vested in the Shire of Boulder has been cancelled. Public Plan Kalgoorlie-Boulder and Environs 30.32. File 4095/01.

N. J. SMYTH,  
Executive Director,  
Department Land Administration.

LAND ACT 1933

Notice of Intention to grant a special lease under Section 116

Department of Land Administration,  
Perth, 23 December 1988.

Corres. 2786/984

IT is hereby notified that it is intended to grant a lease over Roe Location 3098 to Co-Operative Bulk Handling Limited for a term of twenty one (21) years for the purpose of "Grain Handling Facilities".

N. J. SMYTH,  
Executive Director.

LAND ACT 1933

Notice of Intention to Grant a Special Lease Under section 116

Department of Land Administration,  
Perth, 13 January 1989.

Corres. 792/987.

IT is hereby notified that it is intended to grant a lease over Luman Location 51 to the Yarrunga Community for a term of fifty (50) years for the purpose of "The Use and Benefits of Aboriginal Inhabitants and Land Management".

N. J. SMYTH,  
Executive Director.

LAND ACT 1933

Department of Land Administration,  
Perth, 13 January 1989.

File 2316/33.

I HEREBY appoint, pursuant to section 173 (1) of the Land Act 1933 Eric James Horlin as an Authorised Land Officer.

YVONNE HENDERSON,  
Minister for Lands.

INDUSTRIAL DEVELOPMENT (RESUMPTION OF LAND) ACT 1945

Dedication of Land

Department of Land Administration,  
Perth, 13 January 1989.

File 2254/980.

HIS Excellency the Governor in Executive Council has been pleased to approve, under section 11 of the Industrial Development (Resumption of Land) Act 1945 of the dedication of Clarence Lot 150 to the purposes of that Act.

N. J. SMYTH,  
Executive Council.

CORRIGENDUM

Department of Land Administration,  
Perth, 13 January 1989.

File 3280/970.

IN the Notice at page 2920 of the Government Gazette dated 19 August 1988 with reference to Reserve No. 351, in line four amend about 299 hectares to read about 290 hectares.

N. J. SMYTH,  
Executive Director.

Records pls file 2 Asst. Reserves  
6.2.89

# INCLUSION OF VICTORIA LOCATION 10359 AND EXCISION OF VICTORIA LOCATION 11736 FROM CLASS "A" RESERVE 24491

PUBLIC PLAN TANCHE 1:50 000

CORR. No. 2531/54 Vol.3

S.G.H. 30.5.88  
*Fréd.*

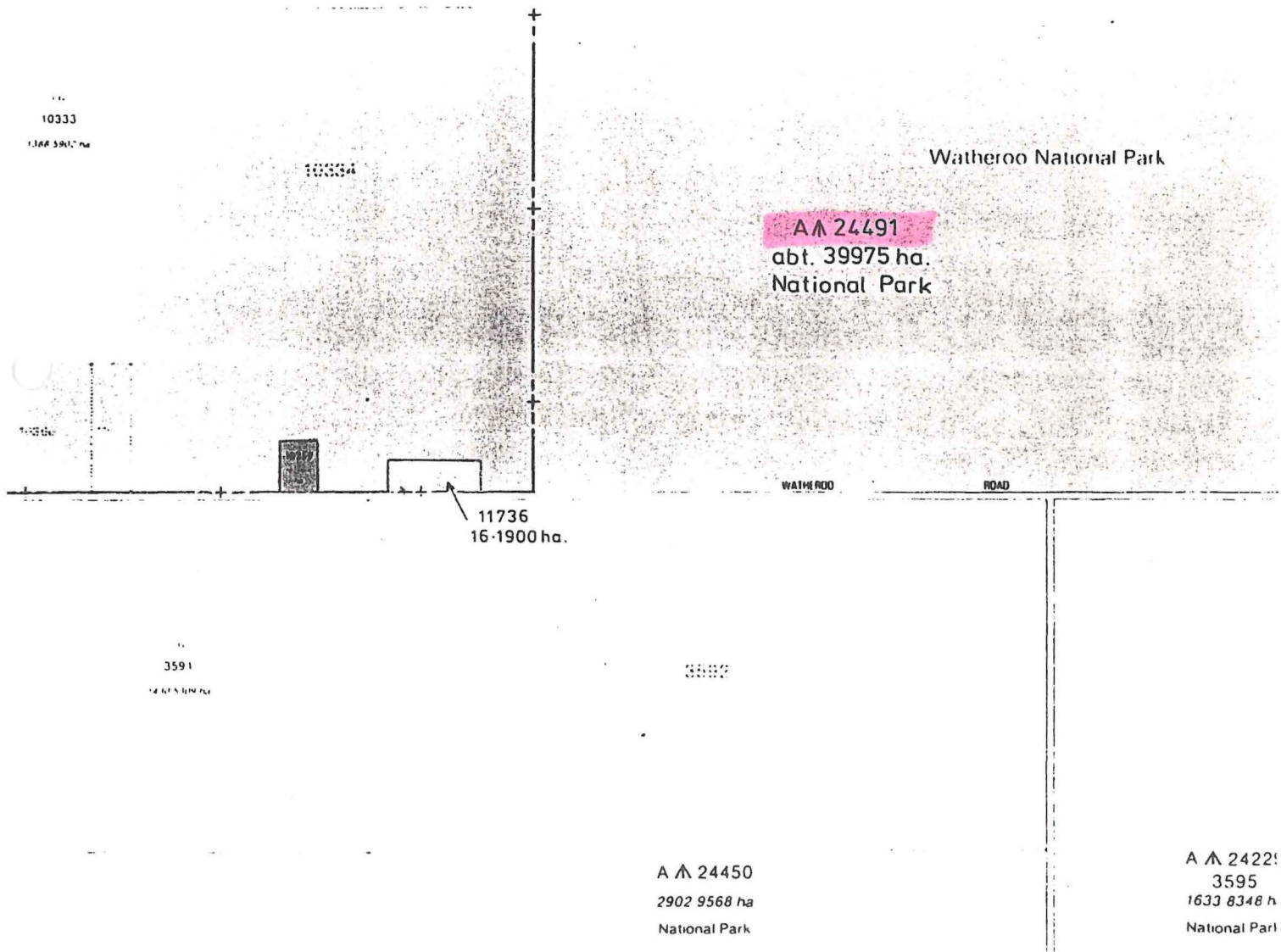

AUSTRAL

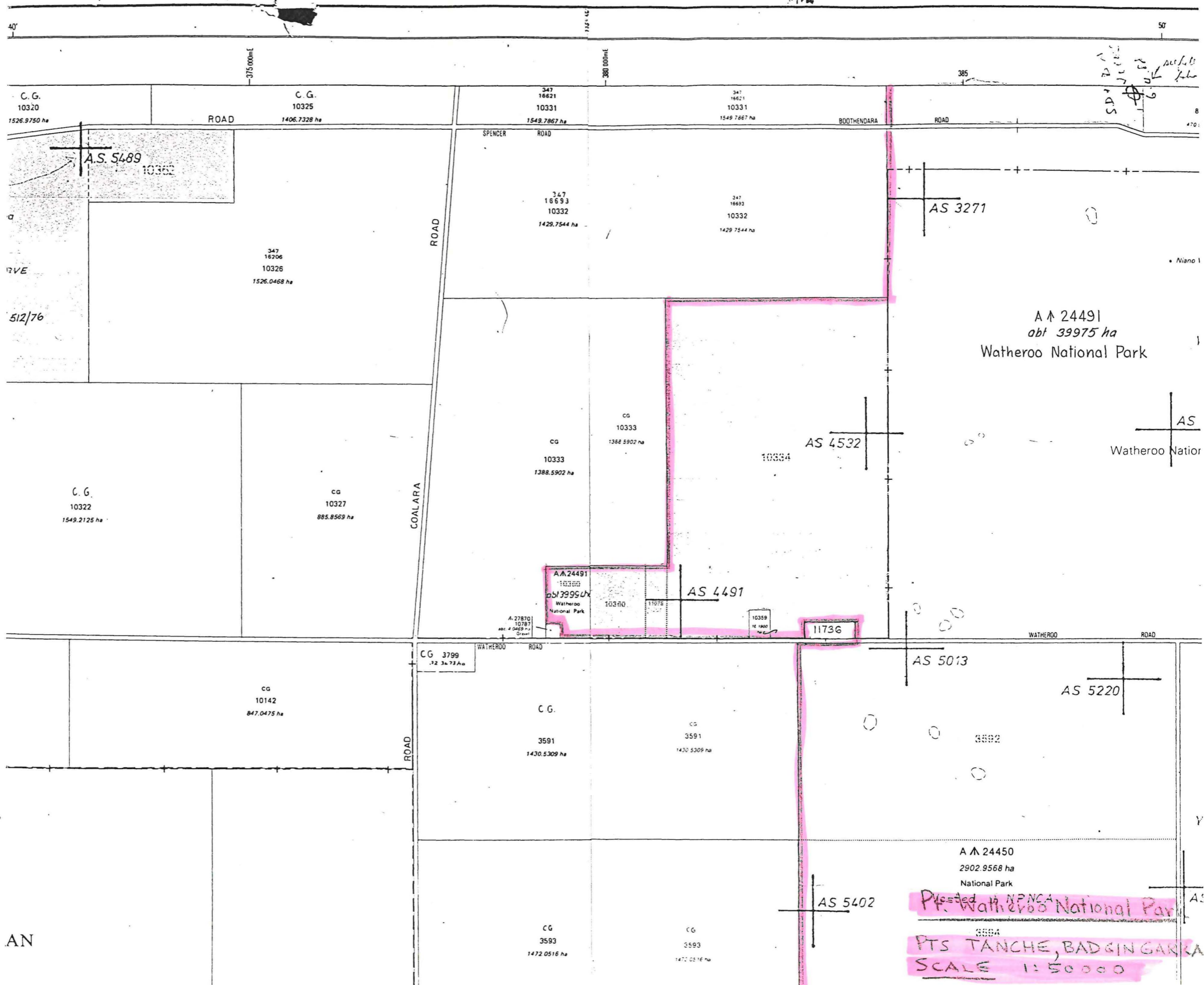

AN

AA 24450  
2902.9568 ha  
National Park

*Plotted in NP Watheroo National Park*

PTS TANCHE, BADGINGANKA

SCALE 1:50000