

NATURE RESERVE

RESERVE NO: 24835

GOVERNMENT GAZETTE  
Date Page No.

FILE NUMBER: 1093/76

PURPOSE: Conservation of Flora  
& Fauna

1090

NAME: <sup>ULVA</sup> Ulua Nature Reserve

16/11/84 3698

CLASS (Land Act):

AREA: 59.1282 ha

3/8/84 2287

VESTING: W.A.W.A.

3/8/84 2273

LOCATION NO(S): 27920

CLASSIFICATION:  
(Wildlife Act  
Section 12A)

LITHO: 25/80 F3  
PLAN 237

LOCAL AUTHORITY: MERREDIN SHIRE

Notes:

Notice to this effect was published in the Government Gazette of May 5, 1989 and I enclose the relevant Vesting Orders.

Would you please return to this Office the superseded Vesting Orders for cancellation.

Yours faithfully

*for* *Clawell*  
P. COYNE  
MANAGER  
PROPERTY MANAGEMENT BRANCH  
LAND OPERATIONS DIVISION

May 29, 1989

Enc.

PM146LW3



*clerk, woodvale - FYI*

01860153102

56  
JF

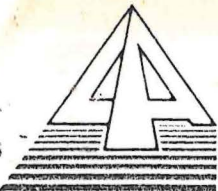

Department of  
**LAND ADMINISTRATION**

Department of Conservation  
and Land Management  
65-11-83  
COMM. W.A.

Your Ref:

Our Ref: 1900/984 CC:LW

Telephone: 323 1614 C. CARROLL

Enquiries:

EXECUTIVE DIRECTOR  
DEPARTMENT OF CONSERVATION  
AND LAND MANAGEMENT

ST  
DIRECT

DEPARTMENT OF CONSERVATION  
AND LAND MANAGEMENT  
31 MAY 1989  
COMM. W.A.

Dear Sir

I advise for your information that Executive Council has:-

1. Issued an Order in Council revoking the Orders in Council whereby Reserve No.s 17946, 18340, 18342, 18381, 18950, 19036, 19093, 19116, 19118, 19650, 20262, 20479, 20482, 20834, 21056, 21153, 21230, 21830, 21981, 22792, 23008, 23141, 23156, 23171, 23316, 23325, 23566, 23665, 23934, 24532, 24534, 24677, 24835, 24891, 24912, 24944, 24979, 25112, 25546, 25809, 26196, 26266, 26403, 26508, 26564, 26569, 26661, 26687, 26792, 26809, 26819, 27108, 27146, 27283 and 27354 were vested in the Western Australian Wildlife Authority in trust for the purpose of "Conservation of Flora and Fauna" and approve the cancellation of the relevant Vesting Orders accordingly.
2. Issued a Proclamation cancelling the reservation as of Class "B" of Reserve No. 24979 "Conservation of Flora and Fauna".
3. Issued a Proclamation classifying as of Class "A" Reserve No.s 17946, 18340, 18342, 18381, 18950, 19036, 19093, 19116, 19118, 19650, 20262, 20479, 20482, 20834, 21056, 21153, 21230, 21830, 21981, 22792, 23008, 23141, 23156, 23171, 23316, 23325, 23566, 23665, 23934, 24532, 24534, 24677, 24835, 24891, 24912, 24944, 24979, 25112, 25546, 25809, 26196, 26266, 26403, 26508, 26564, 26569, 26661, 26687, 26792, 26809, 26819, 27108, 27146, 27219, 27283 and 27354 "Conservation of Flora and Fauna".
4. Issued Orders in Council directing that Class "A" Reserve No.s 17946, 18340, 18342, 18381, 18950, 19036, 19093, 19116, 19118, 19650, 20262, 20479, 20482, 20834, 21056, 21153, 21230, 21830, 21981, 22792, 23008, 23141, 23156, 23171, 23316, 23325, 23566, 23665, 23934, 24532, 24534, 24677, 24835, 24891, 24912, 24944, 24979, 25112, 25546, 25809, 26196, 26266, 26403, 26508, 26564, 26569, 26661, 26687, 26792, 26809, 26819, 27108, 27146, 27219, 27283 and 27354 shall vest in and be held by the National Parks and Nature Conservation Authority in trust for the purpose of "Conservation of Flora and Fauna".

records - please file  
+ return. MKK

1/ Asst Reserves

.. /2.

38296	May 16, 1983.
38334	May 31, 1983.
38415	August 2, 1983.
38522	October 25, 1983.
38544	November 22, 1983.
38545	November 8, 1983.
38574	January 24, 1984.
38578	December 20, 1983.
38703	March 20, 1984.
38800	June 26, 1984.
39038	March 12, 1985.

27146	May 3, 1983.
27219	January 10, 1979.
27283	October 1, 1980.
27354	January 14, 1976.

Now, therefore, His Excellency the Governor, by and with the advice and consent of the Executive Council, hereby directs that the beforementioned Orders in Council be revoked and the Vesting Orders cancelled accordingly.

G. PEARCE,  
Clerk of the Council.

File No. 1900/984.—And whereas by Order in Council issued on dates specified in the attached Schedule the respective Reserves were vested in the Western Australian Wildlife Authority in trust for the purpose of "Conservation of Flora and Fauna".

Schedule  
Reserve Nos; Order in Council Date.

17946	January 10, 1984.
18340	March 5, 1980.
18342	September 22, 1976.
18381	October 1, 1980.
18950	May 31, 1983.
19036	May 31, 1983.
19093	June 9, 1972.
19116	June 7, 1978.
19118	January 11, 1978.
19650	February 8, 1979.
20262	September 9, 1970.
20479	March 21, 1979.
20482	August 21, 1984.
20834	May 24, 1978.
21056	January 10, 1973.
21153	August 3, 1981.
21230	March 17, 1971.
21830	July 21, 1977.
21981	September 9, 1970.
22792	October 4, 1979.
23008	February 19, 1985.
23141	November 16, 1977.
23156	May 31, 1983.
23171	June 22, 1977.
23316	May 16, 1983.
23325	August 3, 1981.
23566	November 9, 1978.
23665	October 4, 1979.
23934	August 16, 1978.
24532	July 19, 1983.
24534	May 31, 1983.
24677	July 19, 1978.
24835	July 24, 1984.
24891	January 10, 1979.
24912	April 8, 1970.
24944	August 2, 1983.
24979	October 30, 1976.
25112	August 8, 1979.
25546	September 17, 1980.
25809	February 23, 1977.
26196	September 18, 1979.
26266	August 3, 1981.
26403	May 3, 1983.
26508	September 17, 1980.
26564	February 7, 1984.
26569	July 1, 1970.
26661	August 2, 1983.
26687	March 18, 1981.
26792	May 24, 1978.
26809	September 13, 1978.
26819	December 13, 1978.
27108	October 17, 1979.

Land Act 1933

ORDERS IN COUNCIL

WHEREAS by section 33 of the Land Act 1933, it is made lawful for the Governor to direct that any Reserve shall vest in and be held by any person or persons to be named in the order in trust for the like or other public purposes to be specified in such order: And whereas it is deemed expedient as follows—

File No. 1391/67—That Class "A" Reserve No. 29255 (Sandland Island) should vest in and be held by the National Parks and Nature Conservation Authority in trust for the purpose of "Conservation of Flora and Fauna".

File No. 1390/67—That Class "A" Reserve No. 29254 (Wedge Island) should vest in and be held by the National Parks and Nature Conservation Authority in trust for the purpose of "Conservation of Flora and Fauna".

File No. 1388/67—That Class "A" Reserve No. 29252 (Green Islets Group—North, South and Buller Islands and Whittell Islets) should vest in and be held by the National Parks and Nature Conservation Authority in trust for the purpose of "Conservation of Flora and Fauna".

Now, therefore, His Excellency the Governor, by and with the advice and consent of the Executive Council, does hereby direct that the beforementioned Reserves shall vest in and be held by the aforementioned bodies in trust for the purposes aforesaid, subject nevertheless to the powers reserved to him by section 37 of the said Act.

G. PEARCE,  
Clerk of the Council.

Land Act 1933

ORDER IN COUNCIL

File No. 1900/984.

WHEREAS by section 34B(1) of the Land Act 1933, it is made lawful for the Governor to revoke an Order in Council issued pursuant to section 33 of that Act. And whereas by Order in Council dated 9 November, 1978 Class "B" Reserve No's 29252, 29254 and 29255 were vested in the Western Australian Wildlife Authority in trust for the purpose of "Conservation of Flora and Fauna".

Now, therefore, His Excellency the Governor, by and with the advice and consent of the Executive Council, hereby directs that the beforementioned Order in Council be revoked and the Vesting Order cancelled accordingly.

G. PEARCE,  
Clerk of the Council.

AT a meeting of the Executive Council held in the Executive Council Chambers, at Perth, on 2 May 1989 the following Orders in Council were authorised to be issued.

Land Act 1933

ORDERS IN COUNCIL

WHEREAS by section 33 of the Land Act 1933, it is made lawful for the Governor to direct that any Reserve shall vest in and be held by any person or persons to be named in order in trust for the like or other public purposes to be specified in such order: And whereas it is deemed expedient as follows—

File No. 1136/72—Reserve No. 29876 (Canning Locations 2236 and 2619) should vest in and be held by the Water Authority of Western Australia in trust for the purpose of "Drainage".

1979 at pages 3079-3080 and varied from time to time thereafter by inserting in the Schedule, after Part 15, the following Part—

Part 16

All that portion of land bounded by lines starting from the southernmost southwestern corner of Parburdoo Lot 6, as surveyed and shown on Department of Land Administration Original Plan 16987, and extending generally northeasterly and generally easterly along southeastern and southern boundaries of that lot to the prolongation northerly of the eastern side of Robe Avenue; thence southerly to and along that side and onwards to a northwestern boundary of the southeastern severance of Windell Location 30; thence generally southwesterly, generally westerly, northwesterly and northeasterly along boundaries of that severance to a south-western side of Camp Road; thence generally northwesterly and generally southwesterly along sides of that road to an eastern side of Beasley Road and thence northerly and generally northwesterly along sides of that road to the starting point.

(Department of Land Administration Public Plans Parburdoo Regional and Parburdoo 2000 02.34, 03.34, 03.35, 04.34 and 04.35. "

Given under my hand and the Seal of the State on 2 May 1989.

By His Excellency's Command,

KAY HALLAHAN,  
Minister for Local Government.

GOD SAVE THE QUEEN !

At a Meeting of the Executive Council held in the Executive Council Chamber, at Perth, this 18th day of April 1989, the following Orders in Council were authorised to be issued.

Child Welfare Act 1947

ORDER IN COUNCIL

WHEREAS by section 19 (2) (a) of the Child Welfare Act 1947 it is provided that the Governor may appoint such persons, male or female, as he may think fit, to be members of any particular Children's Court and may determine the respective seniorities of such members and whereas by section 19 (1) (b) (ii) of the said Act the Governor may amend, vary or revoke any such appointment: Now therefore His Excellency the Governor by and with the advice and consent of the Executive Council hereby appoints the person named in the First Schedule hereto to be a member of the Children's Court at the place mentioned and hereby revokes the appointment of the persons named in the Second Schedule hereto to be members of the Children's Court at the place mentioned.

First Schedule

Newman—Rhonda Diane Chapman.

Second Schedule

Newman—

Peter John Alfred Collins.  
Elizabeth Margaret Jayes.

G. PEARCE,  
Clerk of the Council.

Child Welfare Act 1947

ORDER IN COUNCIL

WHEREAS by section 19 (2) (a) of the Child Welfare Act 1947 it is provided that the Governor may appoint such persons, male or female, as he may think fit, to be members of any particular Children's Court and may determine the respective seniorities of such members, and whereas by section 19 (1) (b) (ii) of the said Act the Governor may amend, vary or revoke any such appointment: Now therefore His Excellency the Governor by and with the advice and consent of the Executive Council hereby revokes the appointment of the person named in the Schedule hereto as a member of the Children's Court at the place mentioned.

Schedule

Norseman—Betty Logan.

G. PEARCE,  
Clerk of the Council.

Child Welfare Act 1947

ORDER IN COUNCIL

WHEREAS by section 19 (2) (a) of the Child Welfare Act 1947 it is provided that the Governor may appoint such persons, male or female, as he may think fit, to be members of any particular Children's Court and may determine the respective seniorities of such members and whereas by section 19 (1) (b) (ii) of the said Act the Governor may amend, vary or revoke any such appointment: Now therefore His Excellency the Governor by and with the advice and consent of the Executive Council hereby appoints the persons named in the First Schedule hereto to be members of the Children's Court at the place mentioned and hereby revokes the appointment of the persons named in the Second Schedule hereto to be members of the Children's Court at the place mentioned.

First Schedule

Onslow—

Maisie Hyland.  
John Hayes.  
Elsie Lavinia Munro.

Second Schedule

Onslow—

Alec Francis Tucker.  
Kevin Zanetti.

G. PEARCE,  
Clerk of the Council.

Land Act 1933

ORDERS IN COUNCIL

WHEREAS by section 33 of the Land Act 1933, it is made lawful for the Governor to direct that any Reserve shall vest in and be held by any person or persons to be named in the order in trust for the like or other public purposes to be specified in such order: And whereas it is deemed expedient as follows—

File No. 1900/984.—That Class "A" Reserves 17946, 18340, 18342, 18381, 18950, 19036, 19093, 19916, 19118, 19650, 20262, 20479, 20482, 20834, 21056, 21153, 21230, 21830, 21981, 22792, 23008, 23141, 23156, 23171, 23316, 23325, 23566, 23665, 23934, 24532, 24534, 24677, 24835, 24891, 24912, 24944, 24979, 25112, 25546, 25809, 26196, 26266, 26403, 26508, 26564, 26569, 26661, 26687, 26792, 26809, 26819, 27108, 27146, 27219, 27283 and 27354, should vest in and be held by the National Parks and Nature Conservation Authority in trust for the purpose of "Conservation of Flora and Fauna".

File No. 1900/984.—That Class "A" Reserves 27384, 27387, 27452, 27837, 28047, 28313, 28317, 28318, 28319, 28471, 28940, 29012, 29018, 29019, 29020, 29021, 29022, 29023, 29025, 29026, 29027, 29253, 29256, 29257, 29258, 29259, 29260, 29303, 29322, 29326, 29576, 29589, 29680, 29810, 30430, 30469, 30516, 30903, 30969, 31561, 31742, 31743, 31744, 31799, 31908, 31909, 31913, 32129, 32130, 32131, 32549, 32776, 32783, 32864, 32865, 32993 and 32995, should vest in and be held by the National Parks and Nature Conservation Authority in trust for the purpose of "Conservation of Flora and Fauna".

File No. 1900/984.—That Class "A" Reserves 33113, 33828, 33842, 33854, 34197, 34257, 34295, 35217, 35413, 35428, 35621, 36056, 36183, 36334, 36550, 36608, 36967, 37054, 37316, 38296, 38334, 38415, 38522, 38544, 38545, 38574, 38578, 38703, 38800 and 39038, should vest in and be held by the National Parks and Nature Conservation Authority in trust for the purpose of "Conservation of Flora and Fauna".

File No. 2745/21.—That Class "A" Reserve No. 17826 (Perth Lots S35, 66, 461, 732 and portion of Lot 567) should vest in and be held by the City of Perth in trust for the purpose of "Park Gardens and Parking".

File No. 169/64.—That Class "A" Reserve No. 27139 (Plantagenet Location 5961) should vest in and be held by the National Parks and Nature Conservation Authority in trust for the purpose of "Conservation of Flora and Fauna".

File No. 296/61.—That Class "A" Reserve No. 28167 (Peel Estate Lots 26 and 442) should vest in and be held by the National Parks and Nature Conservation Authority in trust for the purpose of "Conservation of Flora and Fauna".

51  
W

- 1148/980—16235; Jilbadji Locations 983 and 984; 760.2455; Westonia 1:50 000.
- 4361/15—16293; Avon Location 18017; 21.5304; Nangeenan 1:50 000.
- 371/16—16346; Avon Locations 18023 and 28634 and the land coloured blue on Original Plan 11755; 44.3636; Pickering 1:50 000.
- 4225/15—16412; Avon Location 21547; about 60.7028; Quajabin 1:50 000.
- 7455/19—16493; Avon Location 21202; 54.4302; Babakin S.W. 1:25 000.
- 3494/16—16683; Ninghan Location 1123; 82.8948; Lake Wallambin N.E. 1:25 000.
- 2780/18—17055; Kojonup Location 4748; 90.8407; Boscabel N.E. 1:25 000.
- 4827/19—17257; Kojonup Location 4749; about 54.2279; Boscabel N.E. 1:25 000.
- 6820/20—17771; Ninghan Locations 377 and 4191; 104.5455; Lake Wallambin N.E. 1:25 000.
- 1517/21—17778; Ninghan Locations 439, 1088 and 3978; 27.2430; Ballidu S.E. 1:25 000.

- 2773/30—21056; Williams Location 11351; 144.5562; Yilliminning N.W. 1:25 000.
- 621/988—21153; Avon Location 17066; 40.4686; Doodlakine 1:50 000.
- 2580/29—21230; Williams Locations 9325 and 15387; 68.7966; Pingelly S.E. 1:25 000.
- 6835/21—21830; Williams Location 3941; 44.7658; Narrogin N.W. 1:25 000.
- 2236/20—21981; Avon Location 21687; 215.1714; Mt Observation S.E. 1:25 000.
- 671/29—22792; Avon Locations 23870, 28456 and 28701; 668.8153; Wogerlin 1:50 000.
- 5647/48—23008; Avon Location 14881; 64.7978; Koorda S.W. 1:25 000.
- 2517/25—23141; Avon Location 14754; about 60.7028; Pikaring N.E. 1:25 000.
- 1816/982—23156; Avon Location 20153; 343.1734; Cadoux S.W. 1:25 000.
- 4537/48—23171; Hay Locations 2023 and 2024; about 607.0285; Kwooncup S.E. 1:25 000.
- 4643/51—23316; Melbourne Location 3660; 292.0692; Tanche 1:50 000.
- 6041/51—23325; Denmark Estate Lot 378; about 23.4718; Denmark S.W. 1:25 000.
- 3315/52—23566; Avon Location 27288; 255.8726; Kellerberrin S.W. 1:25 000.
- 4440/52—23665; Ninghan Location 1694; about 105.2183; Cadoux N.W. 1:25 000.
- 854/54—23934; Melbourne Location 3726; 212.8369; Capitela S.W. 1:25 000.
- 4106/29—24532; Nangeenan Lots 69, 116, 144 to 149 incl. and 152; 60.7682; Nangeenan Townsite.
- 2628/56—24534; Ninghan Location 3153; 307.3009; Beacon 1:50 000.
- 5915/19—24677; Kojonup Location 7078; 74.6190; Uannap S.W. 1:25 000.
- 7945/08—24835; Avon Location 27920; 59.1282; Nangeenan 1:50 000.
- 4051/56—24891; Plantagenet Location 7475; 103.6680; Redmond S.E. 1:25 000.
- 4830/19—24912; Kojonup Location 9092; about 28.3280; Boscabel N.E. 1:25 000.
- 2526/57—24944; Jilbadji Location 752; 416.8869; Moorine Rock 1:50 000.
- 4505/57—24979; Lancelin and Edwards Islands; about 8.6189; Lancelin 1:2000 21.06.
- 4250/57—25112; Kwoylin Agricultural Area Lot 319; 95.9940; Pantapin N.E. 1:25 000.
- 2156/59—25546; Avon Location 28005; 16.1874; Lomo N.W. and S.W. 1:25 000.
- 943/60—25809; Plantagenet Location 6803 and Elleker Lots 74, 75, 76, 91 and 92; 192.0107; Torbay N.E. and S.E. 1:25 000 and Elleker Townsite.
- 807/13—26196; Wilroy Lot 3; 331.0607; 156/80.
- 912/61—26266; Kwoylin Agricultural Area Lots 362 and 391; 148.4741; Pantapin N.E. 1:25 000.
- 3351/60—26403; Yilgarn Location 356; 113.3651; Coorancooping 1:50 000.
- 2858/20—26508; Nelson Location 12602; 16.1385; Boyup Brook N.E. 1:25 000.
- 834/62—26564; Plantagenet Location 5814; 9.7909; Porongurup S.E. and Noorubup S.W. 1:25 000.
- 2059/62—26569; Kent Location 1371; 128.4573; Ongerup 1:50 000.
- 916/61—26661; Roe Location 2437; about 347.2203; Lake O'Connor 1:50 000.
- 626/62—26687; Avon Location 25285; 303.2893; Lake Wallambin S.W. and S.E. 1:25 000.
- 986/63—26792; Kent Location 1819; 1038.8609; Woodingellup 1:50 000.
- 3411/57—26809; Avon Location 27991; about 107.8487; Kellerberrin N.E. 1:25 000.
- 10365/09—26819; Victoria Locations 10634 and 10635; 347.4505; 122/80.
- 2933/29—27108; Avon Location 20210; 231.7382; Kwoylin 1:50 000.
- 2826/62—27146; Yilgarn Location 1371; 115.9956; Warralakin 1:50 000.
- 1584/64—27219; Melbourne Location 3908; 199.7629; Dandaragan 1:50 000.

Given under my hand and the Public Seal of Western Australia, at Perth, on 18 April 1989.

By His Excellency's Command,  
E. K. HALLAHAN,  
Minister for Lands.

GOD SAVE THE QUEEN !

X

Land Act 1933

PROCLAMATION

WESTERN AUSTRALIA } By His Excellency Professor Gordon Reid, Com-  
GORDON REID, } panion of the Order of Australia, Governor of the  
Governor. } State of Western Australia.  
[L.S.]

File No. 1900/984.

WHEREAS by section 31 (1) (a) of the Land Act 1933, the Governor may by Proclamation and subject to such conditions as may be expressed therein classify as of Class "A" any such lands of the Crown reserved to Her Majesty for any purpose; and whereas it is deemed expedient that the Reserves listed in the attached schedule for the purpose of "Conservation of Flora and Fauna" as described, should be classified as of Class "A"; now, therefore I, the Governor, with the advice and consent of Executive Council do by this my Proclamation classify as of Class "A" the reserve described in the attached schedule.

Schedule

File No.; Reserve No.; Land Description; Area (hectares); Plan.

- 545/22—17946; Victoria Location 11535; 259.0619; 190/80.
- 3676/23—18340; Denmark Estate Lots 409 and 441; 83.6687; Denmark S.W. 1:25 000.
- 866/20—18342; Avon Location 23254; 0.4629; Pantapin 1:50 000.
- 4646/23—18381; Ninghan Location 2129; 16.1975; Kalannie 1:50 000.
- 2786/25—18950; Ninghan Location 969; 4.0469; Lake Wallambin N.E. 1:25 000.
- 1466/25—19036; Ninghan Location 2291; 9.0295; Lake Wallambin N.E. 1:25 000.
- 179/63—19093; Williams Location 14715; about 84.9840; Mugerugging N.W. 1:25 000.
- 2455/54—19116; Williams Locations 8256 and 9355; 129.4994; Mugerugging N.W. 1:25 000.
- 3316/57—19118; Williams Location 14194; 207.7428; Yilliminning 1:50 000.
- 3457/26—19650; Ninghan Locations 1138, 1139 and 2771; 62.3191; Kalannie 1:50 000.
- 3627/29—20262; Jilbadji Locations 478 and 745; 1018.7072; Moorine Rock 1:50 000.
- 6581/13—20479; Williams Location 6277; 64.7497; Piesseville S.W. 1:25 000.
- 629/30—20482; Ninghan Location 4239; 188.5640; Kalannie 1:50 000.
- 2794/62—20834; Williams Location 9988; 63.3333; Piesseville N.E. and S.E. 1:25 000.

24.5.89.  
i. Lands AR

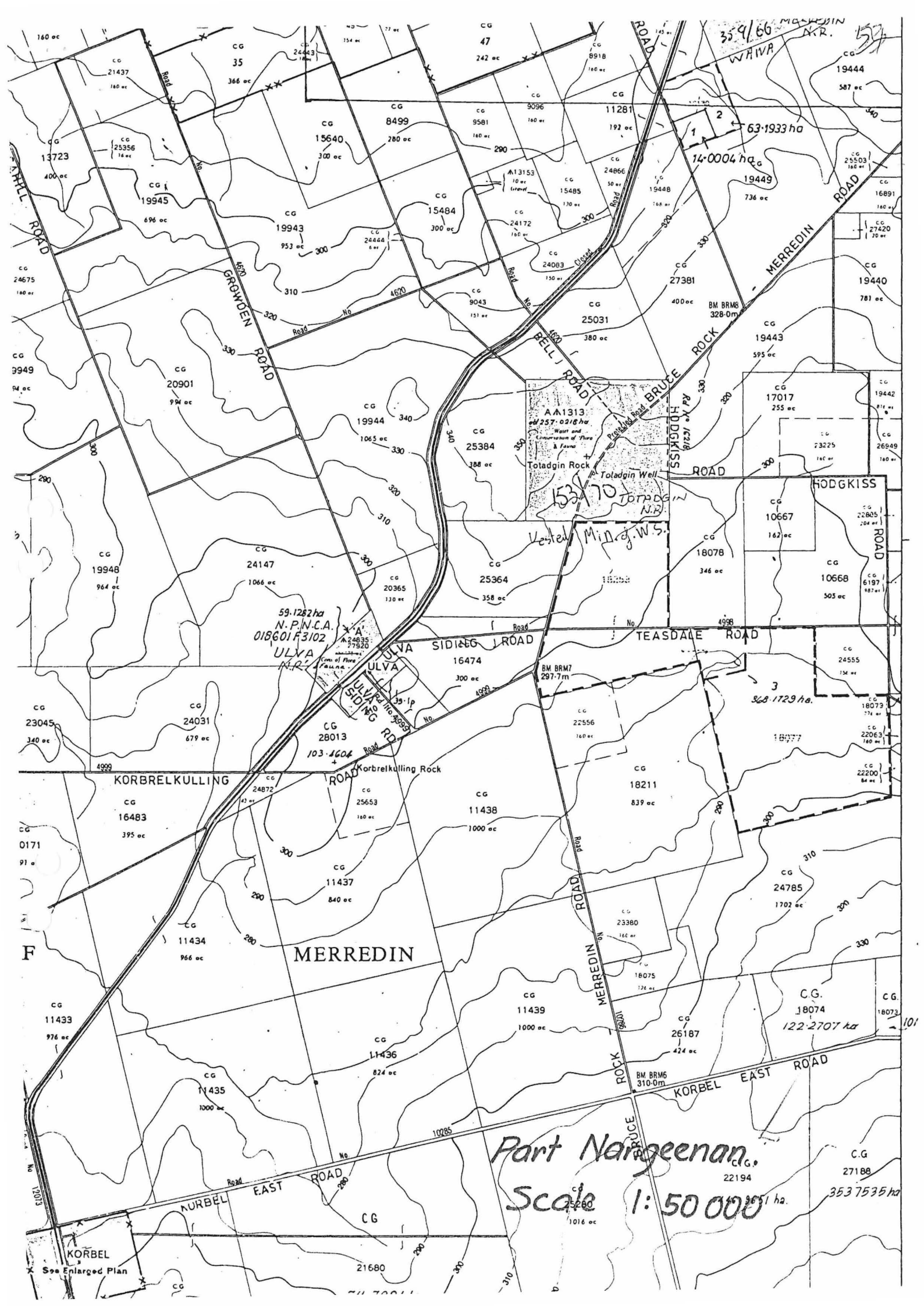

359/60 WAVA 59

63-1933 ha

14-0004 ha

19449 736 ac

19440 781 ac

19443 595 ac

17017 255 ac

19442 216 ac

23225 180 ac

10667 162 ac

10668 505 ac

18078 346 ac

24555 156 ac

18079 224 ac

22063 160 ac

22200 84 ac

18077 170 ac

18075 126 ac

23380 166 ac

24785 1702 ac

24785 1702 ac

18074 122-2707 ha

18073 18073

26187 424 ac

22194

27188

353 7535 ha

1016 ac

59-1282 ha N.P.N.C.A. 018601 F3102 ULVA N.R.

53170 Toladgin N.R. Vestel Midg.W.S.

Part Nargeenan Scale 1:50 000

MERREDIN

F

See Enlarged Plan