

NATURE RESERVE

RESERVE NO: 25919

GOVERNMENT GAZETTE  
Date Page No.

FILE NUMBER: 589/76

PURPOSE: Cons. of Flora & Fauna 5.8.77 2556

NAME: Copley Dale Reserve

CLASS (Land Act):

AREA: 5.4127 ha

VESTING: W.A.W.A. 5.8.77 2528

LOCATION NO(S): Swan 7027

CLASSIFICATION:  
(Wildlife Act  
Section 12A)

LITHO: 28/80 E4

LOCAL AUTHORITY: Swan/Guildford Shire

Notes:

RESERVE ACTION SHEET : CONSERVATION RESERVES

RESERVE NO. 25919

REASON FOR ACTION Gazet.al of Name

OFFICER	ACTION	ACTION TAKEN	DATE
LANDS CLERK <i>[Signature]</i>	Fill in above details	<i>[Signature]</i>	
	Attach copies of gazettal notices to file (folios: 36 )		9/16
	Enter relevant details on file cover		
SENIOR DRAFTSPERSON, LEGAL MAPPING	Amend Litho	<i>[Signature]</i>	2/17
	Attach copy of litho to file (mark litho name/number) (See p. 38)	<i>[Signature]</i>	2/17
LANDS CLERK	Send copies of gazettal notices (or Lands Dept. memo) and map to:		
	<u>Clerk, Woodvale</u>		
	<u>Regional Manager</u>		
	<u>District Manager</u>		
	<u>District Wildlife Officer</u>		
	Note: Information sent must include: (a) Dept's file number (b) Litho number/name		
SENIOR CLERK RESERVES	To note		
MANAGER, WILDLIFE AND LAND ADMIN.	To note		
OFFICER IN CHARGE - RECORDS	For new reserves: <u>Index Reserve's name</u> <u>Index Reserves's number</u>		
DIRECTOR NATURE CONSERVATION/NATIONAL PARKS	To note		

*[Handwritten Signature]*

56

1:10000 6.3

SWAN

101

98

ROAD

100

108

95

COPY DATE

Copy Date  
 A-25919 Nat. Res.  
 7027 WAWA  
 Cons. of  
 Flora & Fauna  
 5.6127ha  
 018316312

PT 94

128

112



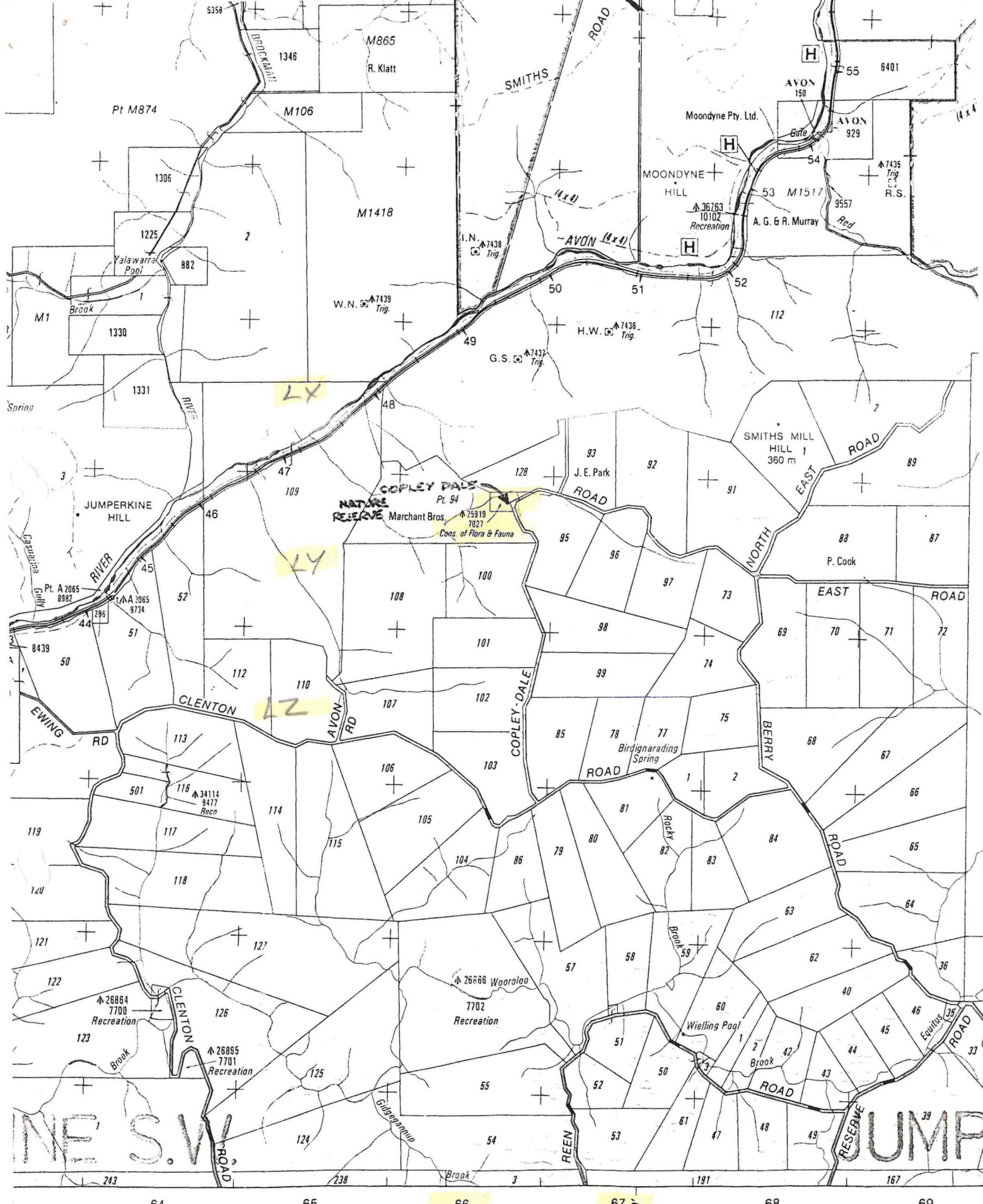

420,000 m SWAN LAND DISTRICT

KEY TO SYMBOLS

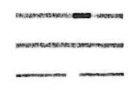

Forests Department  
Sawmill  
Lookout Tower

AVON VALLEY  
1:50 000  
CALMAP



## NAMING OF RESERVES

Department of Land Administration,  
Perth, 19 December 1986.

Corres. No. 3583/981.

IT is hereby notified for general information that the Reserves listed in the Schedule hereunder are by this Notice, named in accordance with the said Schedule.

Reserve No; Reserve Name; Public Plan	
22262; Wundowlin Nature Reserve; Mukinbudin 1:50 000.	36063; Strange Road Nature Reserve; Luptons S.W., S.E.
31715; Barbalin Nature Reserve; Mukinbudin 1:50 000.	19740; Bartram Nature Reserve; Luptons S.E.
13051; Calcing Nature Reserve; Calcing 1:50 000.	36519; Pingeculling Nature Reserve; Brookton S.W.
30705; South Wilgoyne Nature Reserve; Calcing 1:50 000.	36742; Brookton Highway Nature Reserve; Luptons S.E.
31629; Cookinbin Nature Reserve; Nungarin 1:50 000.	8830; Bulgin Nature Reserve; Cunderdin 1:50 000.
23835; Karloning Nature Reserve; Karloning 1:50 000.	10313; Noonying Nature Reserve; 26C/40.
29303; North Bonnie Rock Nature Reserve; Blain 1:50 000.	23566; Tammin Nature Reserve; 26C/40.
20530; Portion of Joverdine Nature Reserve; Bonnie Rock 1:50 000.	17732; North Bungulla Nature Reserve; Kellerberrin 1:50 000.
37034; Portion of Joverdine Nature Reserve; Bonnie Rock 1:50 000.	4667; Lundy Nature Reserve; 26B/40.
36526; Lake Cronin Nature Reserve; Lake Cronin 1:50 000.	24831; Wyola Nature Reserve; 26C/40.
A17186; Walyormouring Nature Reserve; Botherling S.W. & S.E.	28289; Moulien Nature Reserve; 3B/40.
A4313; Eaton Nature Reserve; Quelagetting 1:50 000.	33990; Bungulla Nature Reserve; Bungulla Townsite.
14510; Hindmarsh Nature Reserve; Quelagetting 1:50 000.	21153; Morranoppin Nature Reserve; Doodlakine 1:50 000.
A9228; Moonijin Nature Reserve; Cadoux S.E.	22921; Durokoppin Nature Reserve; Kodjikooin 1:50 000.
15794; Cullimbin Nature Reserve; Cadoux N.E.	12329; North Bandee Nature Reserve; Kodjikooin 1:50 000.
10991; Carrimbin Rock Nature Reserve; 33/80.	24897; Mournucking Nature Reserve; Kellerberrin 1:50 000.
21719; Wallambin Nature Reserve; Yelbeni 1:50 000.	25112; Portion of Glenluce Nature Reserve; Pantapin 1:50 000.
10992; Elashgin Nature Reserve; Bulagin 1:50 000.	26266; Portion of Glenluce Nature Reserve; Pantapin 1:50 000.
23887; Wyalkatchem Nature Reserve; Wyalkatchem 1:10 000 5.6 & 5.7.	30903; Craig Nature Reserve; Pantapin 1:50 000.
34385; Nembudding Nature Reserve; Yelbeni 1:50 000.	5456; Dead Mans Swamp Nature Reserve; Hillman S.E. Moodiarup N.E.
15386; Yelbeni Nature Reserve; Yelbeni Townsite.	25904; Boolading Nature Reserve; Boolading Townsite.
35413; Walcancobbing Nature Reserve; Trayning 1:50 000.	16904; Hillman Nature Reserve; Hillman N.W.
15570; East Wallambin Nature Reserve; Lake Wallambin S.E.	21521; Williams Nature Reserve; Williams N.E.
20986; Marindo Nature Reserve; Beacon 1:50 000.	29313; Borgey Nature Reserve; Highbury N.W. Williams N.E.
22457; North Beacon Nature Reserve; Beacon 1:50 000.	32448; Moorapulling Nature Reserve; Dwarda S.W.
26911; Beebeegnying Nature Reserve; Gabbing 1:50 000.	30563; Moomagul Nature Reserve; Dattening N.W.
17923; Mungarri Nature Reserve; Beacon 1:50 000.	19784; Haddleton Springs Nature Reserve; Blackwood River N.W., S.W.
24539; Herndermuning Nature Reserve; Beacon 1:50 000.	29322; Weam Nature Reserve; Brookton S.W., N.W.
35679; Danjinning Nature Reserve; Karloning 1:50 000.	31913; Haddleton Nature Reserve; Blackwood River N.W., N.E.
12689; Wiacubbing Nature Reserve; Bencubin 1:50 000.	13373; Benjabbering Nature Reserve; Benjabbering Townsite.
26687; North Wallambin Nature Reserve; Lake Wallambin S.E.	15895; Folly Nature Reserve; Yorkrakine 1:50 000.
24789; Lake Champion Nature Reserve; 35/80.	14920; Dingo Well Nature Reserve; Wyalkatchem 1:50 000.
23339; Elachbutting Nature Reserve; 67/80.	13242; Gabwotting Nature Reserve; Wyalkatchem 1:50 000.
23338; Geeraning Nature Reserve; 67/80.	A23756; Portion of Kooljerrenup Nature Reserve; Lake Clifton N.E.
16235; Carrabin Nature Reserve; Carrabin Townsite.	36126; Portion of Kooljerrenup Nature Reserve; Lake Clifton N.E.
1431; Baladjie Nature Reserve; 53/80, 54/80.	B4990; Portion of Austin Bay Nature Reserve; Mandurah 1:10 000, 2.7.
A35732; Walyahmoning Nature Reserve; Waroona Townsite.	B24036; Portion of Austin Bay Nature Reserve; Pinjarra N.W.
24465; Yanneymooning Nature Reserve; 54/80.	28087; Portion of Austin Bay Nature Reserve; Mandurah S.E., N.E. Pinjarra S.W., N.W.
25194; Anderson Lake Nature Reserve; Toolbrunup S.E.	24739; McLarty Nature Reserve; Mandurah 1:10 000, 1.5.
26162; Three Swamps Nature Reserve; Toolbrunup S.E.	33749; Boodalan Nature Reserve; Mandurah 1:10 000, 2.7.
30526; East Balicup Nature Reserve; Toolbrunup S.W.	16907; Nine Mile Lake Nature Reserve; Pinjarra S.W.
26381; McDougall Nature Reserve; Merilup S.E.	22199; Buller Nature Reserve; Hamel N.W., S.W.
9237; Portion of Snake Gully Nature Reserve; 88/80, 89/80.	12049; Harvey Flats Nature Reserve; Hamel S.W.
10351; Portion of Snake Gully Nature Reserve; 88/80, 89/80.	12632; Riverdale Nature Reserve; Hamel S.W.
36448; Portion of Snake Gully Nature Reserve; 89/80.	24472; Crampton Nature Reserve; Lake Preston N.E., N.W.
27283; Goodlands Nature Reserve; Kalannie 1:50 000.	22797; Falls Brook Nature Reserve; Harvey N.E. Tallanalla N.W.
26259; Carlyarn Nature Reserve; Karrakutta 1:50 000.	34811; Benger Swamp Nature Reserve; Harvey S.W.
18381; Sawyers Nature Reserve; Kalannie 1:50 000.	1740; Wild Horse Swamp Nature Reserve; Blackwood River S.E.
19650; Old Store Nature Reserve; Kalannie 1:50 000.	24917; Towering Nature Reserve; Moddiarup N.W.
33803; Milyu Nature Reserve; Perth 1:2 000 12.21, 12.22, 13.21, 13.22.	30668; Arthur River Nature Reserve; East Arthur N.W. Hillman N.E.
16867; Dukin Nature Reserve; Koorda S.E.	7349; Jandabup Nature Reserve; Swan 1:10 000, 3.2.
24838; Walk Walkin Nature Reserve; Koorda S.W.	A31048; Portion of Lake Joondalup Nature Reserve; Swan 1:10 000, 2.2.
9281; Portion of Warramuggan Nature Reserve; Koorda S.E.	A21708; Portion of Lake Joondalup Nature Reserve; Swan 1:10 000, 2.2.
16040; Portion of Warramuggan Nature Reserve; Koorda S.E.	30809; Woodvale Nature Reserve; Swan 1:2 000, 8.03, 8.04, 9.04.
4670; Nembudding South Nature Reserve; Yelbeni S.W.	25919; Copley Dale Nature Reserve; Swan 1:10 000, 6.3.
12398; Lake Mears Nature Reserve; Quairading S.W.	30667; Beechina Nature Reserve; 3B/40.

*Records* *LANDS CHURK*  
Please ensure that title of list is correct