

RESERVE ACTION SHEET - CONSERVATION RESERVES

RESERVE No. 26400

REASON FOR ACTION

The creation of a 5(1)(h) reserve with a management order issued to the Conservation Commission for the purpose 'Conservation, Navigation, Communication, Meteorology and Survey'.
Area: 0.062 hectares

Due to increasing use of satellite aided navigation and AMSA'S desire to rationalise it's property holdings the Commonwealth has been divesting properties containing lighthouses and marine navigational aids. Reserve 26400 on Steep Point is a former AMSA property which will be leased back to AMSA to permit continued operation of lighthouse facilities

- Date of DOLA's advice: 17 January 2001 See folio: 12
- Plans at folios: 15,14



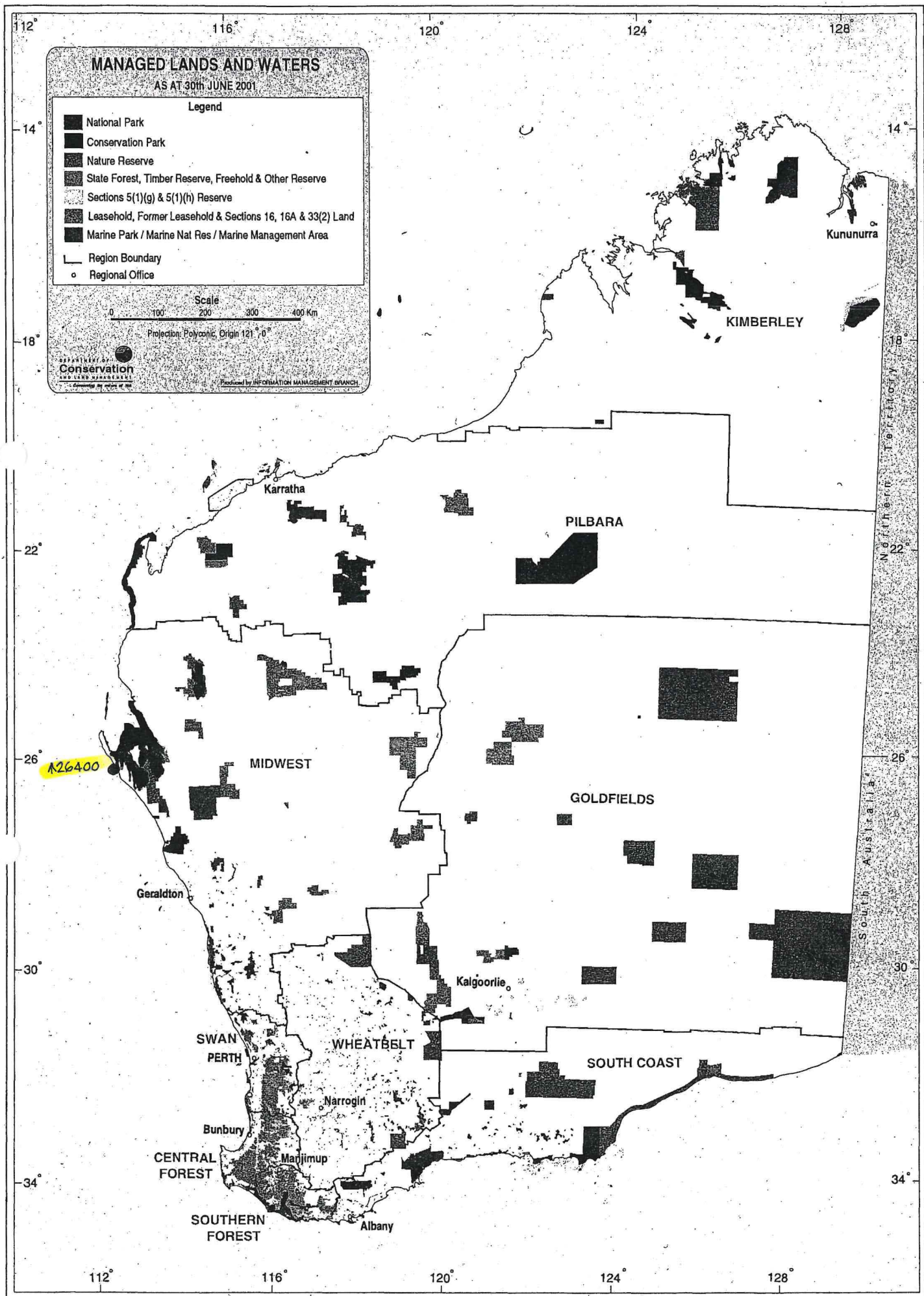





OFFICER	ACTION	
1	CONSERVATION ESTATE OFFICER - Fill in above details - Attach copies of DOLA's advice to file Send copies of advice & maps to: - Lisa Wright, Woodvale - District Manager, Denham - Regional Manager, Geraldton Recommended IUCN classification:	_____ ✓ _____ ✓ _____ ✓ _____ ✓ _____ ✓ _____ ✓
2	LAND ACQUISITIONS OFFICER To note:	_____ _____
3	MANAGER, PLANNING & VISITOR SERVICES To note & approve IUCN classification:	_____ _____
4	DIRECTOR, NATURE CONSERVATION/ NATIONAL PARKS To note:	_____ _____
5	INDEX CLERK, RECORDS To note:	_____ _____
6	CONSERVATION ESTATE OFFICER Attach copy of Reserve Details to inside cover of new file	_____ _____



MANAGED LANDS AND WATERS

AS AT 30th JUNE 2001

Legend

-  National Park
-  Conservation Park
-  Nature Reserve
-  State Forest, Timber Reserve, Freehold & Other Reserve
-  Sections 5(1)(g) & 5(1)(h) Reserve
-  Leasehold, Former Leasehold & Sections 16, 16A & 33(2) Land
-  Marine Park / Marine Nat Res / Marine Management Area
-  Region Boundary
-  Regional Office

Scale
0 100 200 300 400 Km

Projection: Polyconic, Origin 121° 0'



Produced by INFORMATION MANAGEMENT BRANCH

26400

113° 00' 00"

15' 00"

700 710 720 730 740

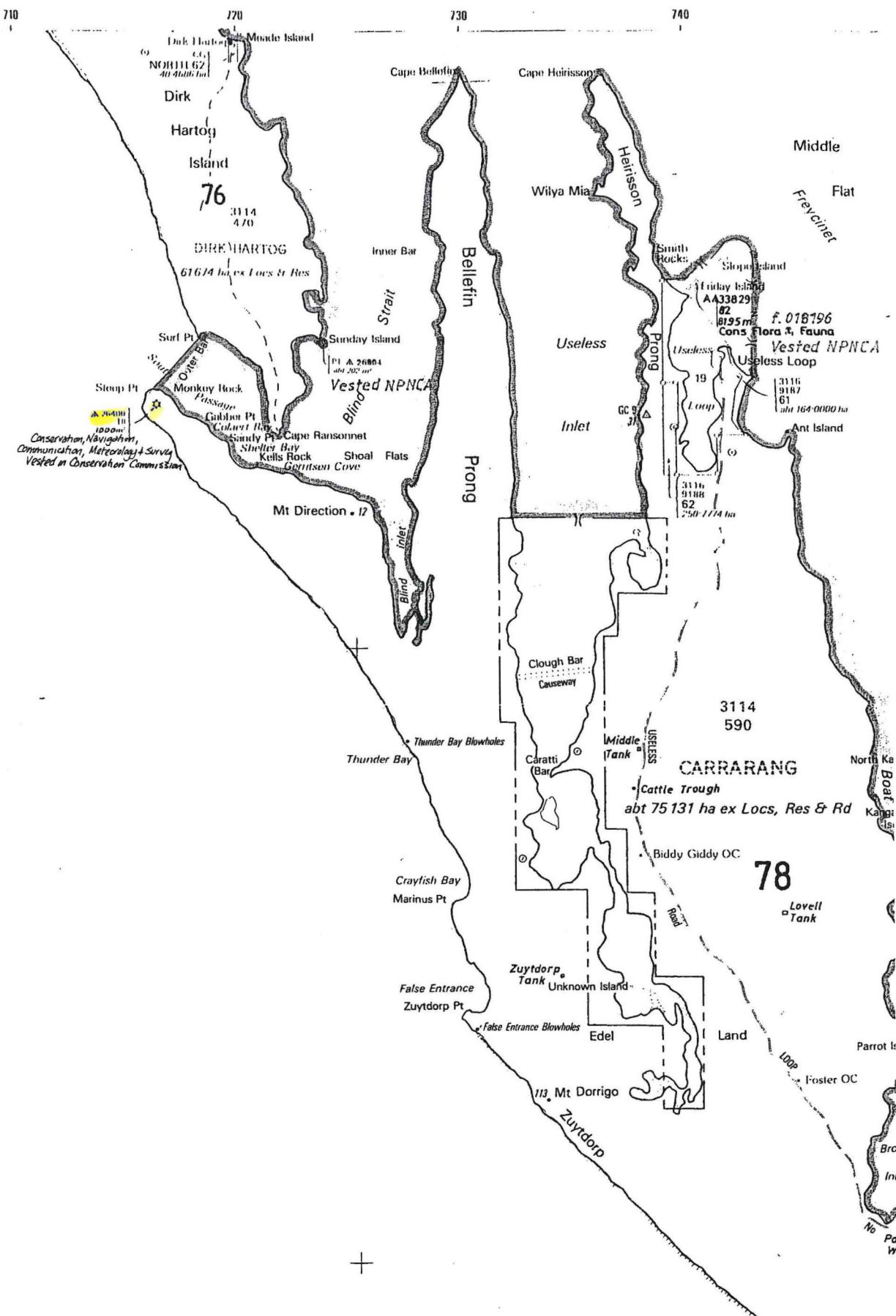

OCEAN

ON PART DOLA PLAN
 EDEL (SG 49-12)
 SCALE 1:250 000

Customer Advices for Reserve Actions
1/07/2001 - 31/07/2001

Shire of Shark Bay 1/07/2001 - 31/07/2001

Reserve No.	Land Description	DOLA File No.	Volume/Folio	Action	Document No.	Registered	Street Name	Area	Public Plans
26400		01751-1961-01RO	3067-261	Management Order to Conservation Commission of Western Australia C/- Department of Conservation and Land Management Locked Bag 104 Bentley Delivery Centre COMO W.A 6152 for the designated purpose of "Conservation, Navigation, Communication, Meteorology and Survey"	H651919	23/01/2001		0.1 Ha	Edel (250)

AMENDMENTS

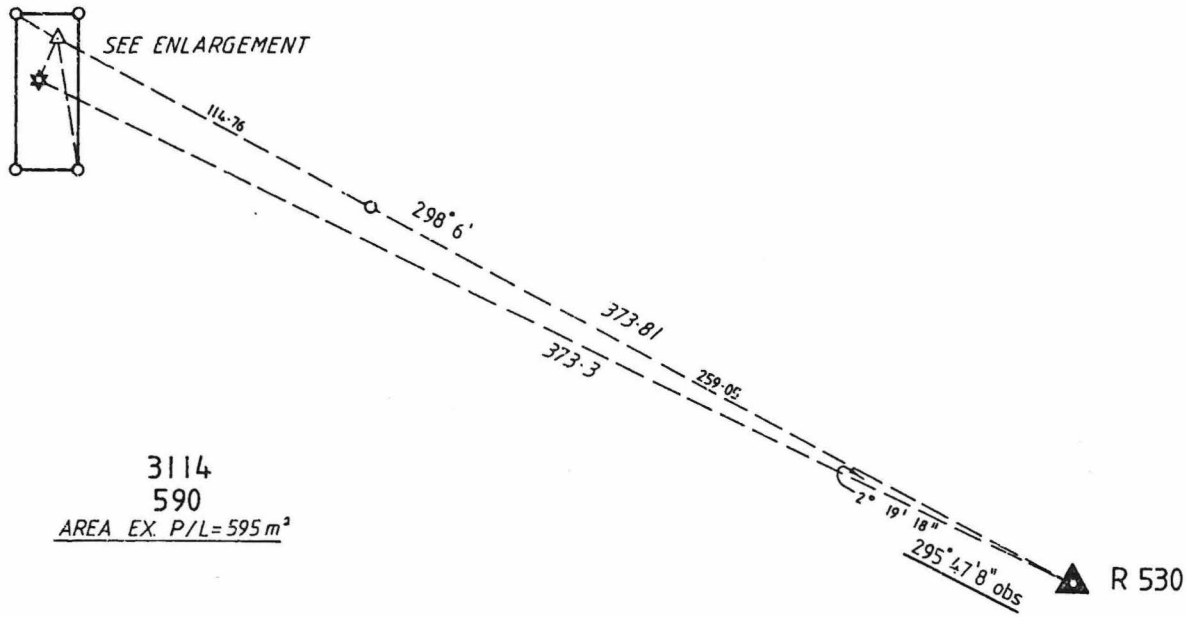

3114
590
AREA EX. P/L = 595 m²

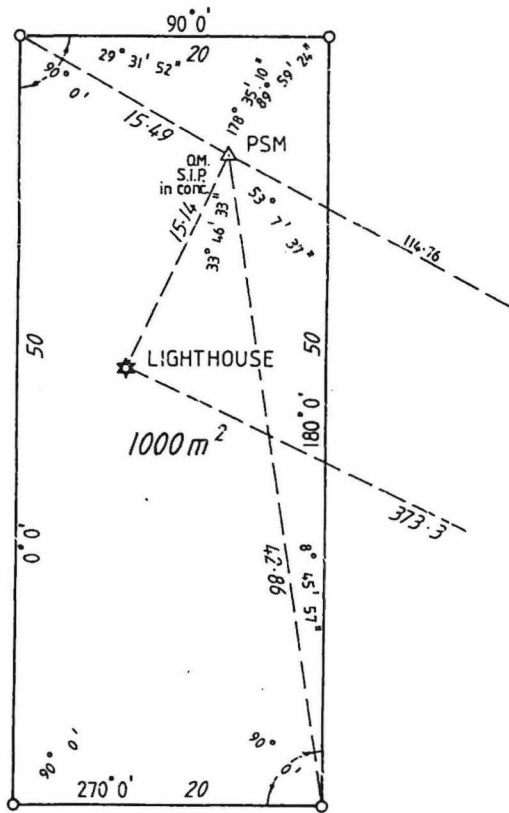

ENLARGEMENT
SCALE 1:400



LAND DISTRICT EDEL	LOCATION 18 (A 26400)		FILE No. 1751 / 61
			SCALE 1:2000 All measurements in metres
SURVEYOR'S CERTIFICATE I hereby certify that this survey was performed by me personally (or under my personal supervision, inspection and field check), in strict accordance with the Licensed Surveyors (Guidance of Surveyors) Regulations. <i>A.C. Millar</i> Licensed Surveyor. Date 27-5-88	Azimuth observed at or assumed from Date of marking 16th MARCH 1988 Surveyor A.C. MILLAR Field Book No. 6 Page 1-3 Cadastral Plan EDEL 1:250 000 Reference 900.745 DEPT. OF ADMIN. SERVICES Date 28-4-88 Diagram Drawn	Calc. Bk. No. G SINGLETON 16 Fl. 17 Compared with F.B. <i>16-3-88</i> Examined <i>A.C. Millar</i> In order for certification <i>P.B. Millar</i> Manager Date 7-8-89 Survey and Tenure Charting	DIAGRAM CERTIFIED CORRECT <i>L. Heaver</i> Date 21-3-89 Authorized Land Officer Recorded on Public Plan G.D. 31-7-1989 Registered On Key Plan EDEL 1:250 000 Supervisor Graphic Bank Crown Surveys 21-6-88 DEPT. OF LAND ADMINISTRATION DIAGRAM No. 88637