

**RESERVE GAZETTAL ACTION SHEET
FOR REGIONS AND DISTRICTS**

LANDS CLERK: Attach a copy of map and forward to the following:

1. REGIONAL MANAGER:
CENTRAL FOREST, GREENOUGH, GOLDFIELDS, KIMBERLEY, SWAN REGION, PILBARA ✓
SOUTH COAST, SOUTHERN FOREST, WHEATBELT
2. DISTRICT MANAGER: Kununurra ✓
3. CLERK, WOODVALE ✓
4. O.I.C. INVENTORY BUNBURY / KELMSCOTT / MANJIMUP
5. DISTRICT WILDLIFE OFFICER: Kununurra ✓

REASON FOR GAZETTAL:

Reclassification from "C" to "A" class - area 91.05 ha

RESERVE DETAILS

RESERVE NUMBER: 26890
 CALM FILE NUMBER: 014392F3201
 MAP REFERENCE: Lennard River 1:250,000
 SHIRE: Derby

CHANGES MADE AT GIVEN GAZETTAL DATE

NAME OF RESERVE: _____
 PURPOSE: National Park Tunnel Creek
 CLASS: "A"
 AREA: 91.05 ha
 VESTING: NPNCA
 DATE AND PAGE NO. OF CURRENT GAZETTAL: 4 September 1992 Page 4454 & 4491

S. Watt
 LANDS CLERK

2/10/92
 DATE

A 31107
abt 2124 ha
of Park
(no Gorge)

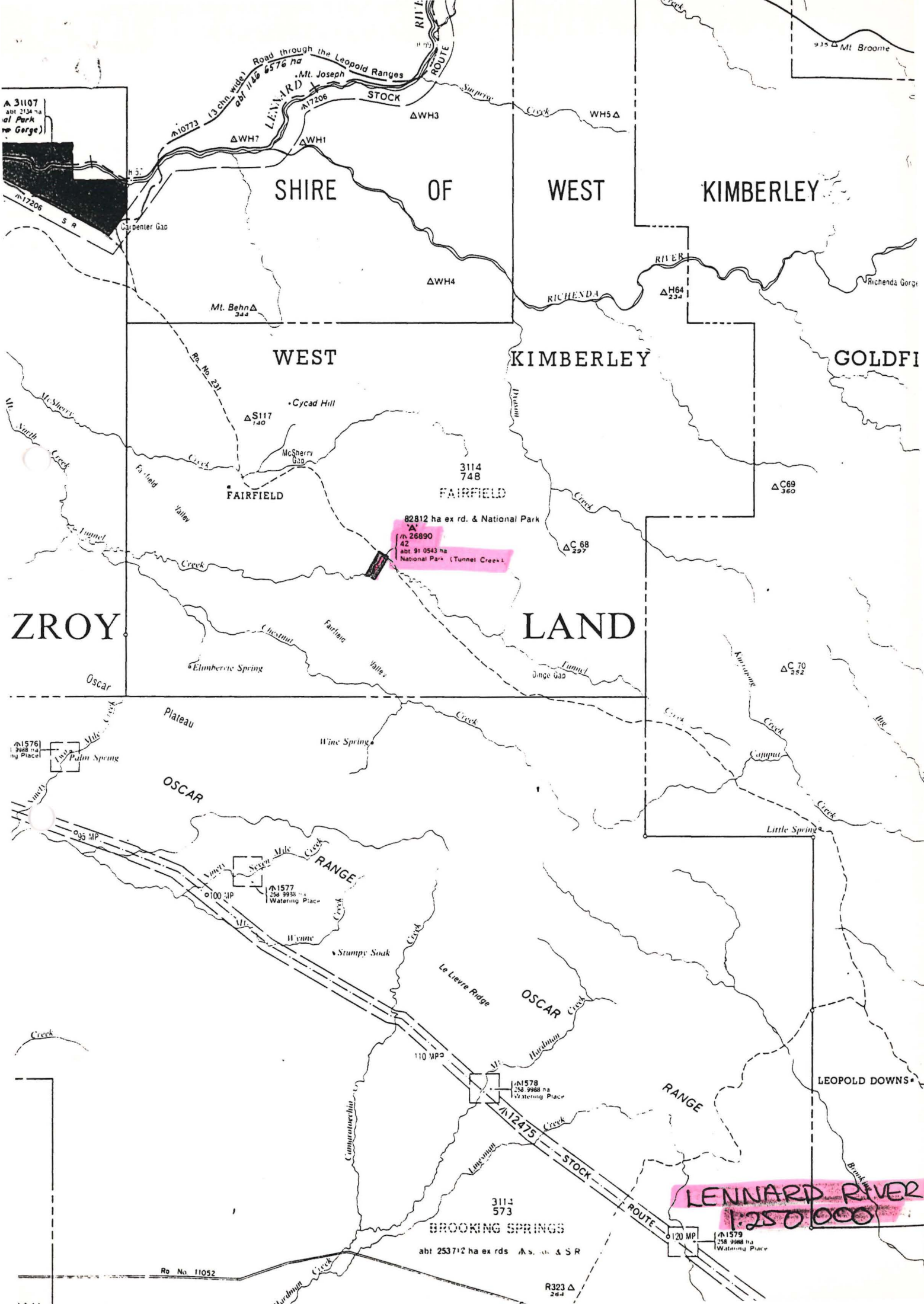
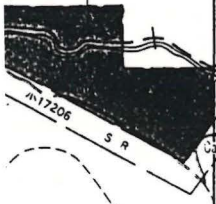

935 Δ Mt Broome

Road through the Leopold Ranges
abt 1146 6576 ha

SHIRE OF WEST KIMBERLEY

WEST KIMBERLEY

GOLDFI

ZROY

LAND

82812 ha ex rd. & National Park
A 26890
42
abt 91 0543 ha
National Park (Tunnel Creeks)

3114
748

FAIRFIELD

OSCAR

SEVEN MILE CREEK RANGE

OSCAR

RANGE

LEOPOLD DOWNS

LENNARD RIVER
1:250 000

BROOKING SPRINGS

abt 2537 1/2 ha ex rds A.S. & S.R

Rd No 11052

R323 Δ
284