

**Customer Advices for Reserve Actions
1/12/2005 - 31/12/2005**

City of Wanneroo 1/12/2005 - 31/12/2005

Reserve No.	Land Description	DOLA File No.	Volume/Folio	Action	Document No.	Registered	Street Name	Area	Public Plans
27575	Lot 3321 on Deposited Plan 219820. Lot 3323 on Deposited Plan 219820. Lot 6270 on Deposited Plan 219820. Lot 10313 on Deposited Plan 219820. Lot 10987 on Deposited Plan 219820. Lot 12903 on Deposited Plan 219820. Lot 12904 on Deposited Plan 219820.	02103-1963-09RO	3051-407 3051-407 3051-407 3051-407 3051-407 3051-407	Amendment of Reserve to To include Lot 999 on Office of Titles Diagram 96200 into Class 'A' Reserve 27575, and with its area being increased to 943.5024 hectares, accordingly.	J476558	19/10/2005	Burns Beach Road, Neerabup.	943.5024 Ha	BG35 (2) 07.10
35890	Lot 11186 on Plan 16754 Lot 14135 on Diagram 78977 Lot 12959 on Plan 16737 Lot 266 on Plan 24155 Lot 12037 on Diagram 78977 Lot 13294 on Plan 21848 Lot 12405 on Plan 20020 Lot 12295 on Plan 19578 Swan Location 9917 on Plans 12464, 12465, 12466, 12467, 12487, 12488 and 12491	01873-1978-03RO	3098-716 3123-104 3111-239 3134-539 3098-715 3113-345 3098-717 3098-718 3098-714 3098-716 3098-716 3098-716 3098-716 3098-716 3098-716 3098-716 3098-716 3098-716 3098-716 3098-716	Amendment of Reserve to To now comprise Lot 3050 on Deposited Plan 47951, the area being reduced to 106.3204 hectares.	J462153	10/10/2005	Mindarie & Tamala Park	106.3204 Ha	BG35(2) 04.14 & 04.13

• TOGIS d'base amended
• whole title
• graphics updated
G/LA 23/1

PIN 1255124
(+ 6.2034 ha)

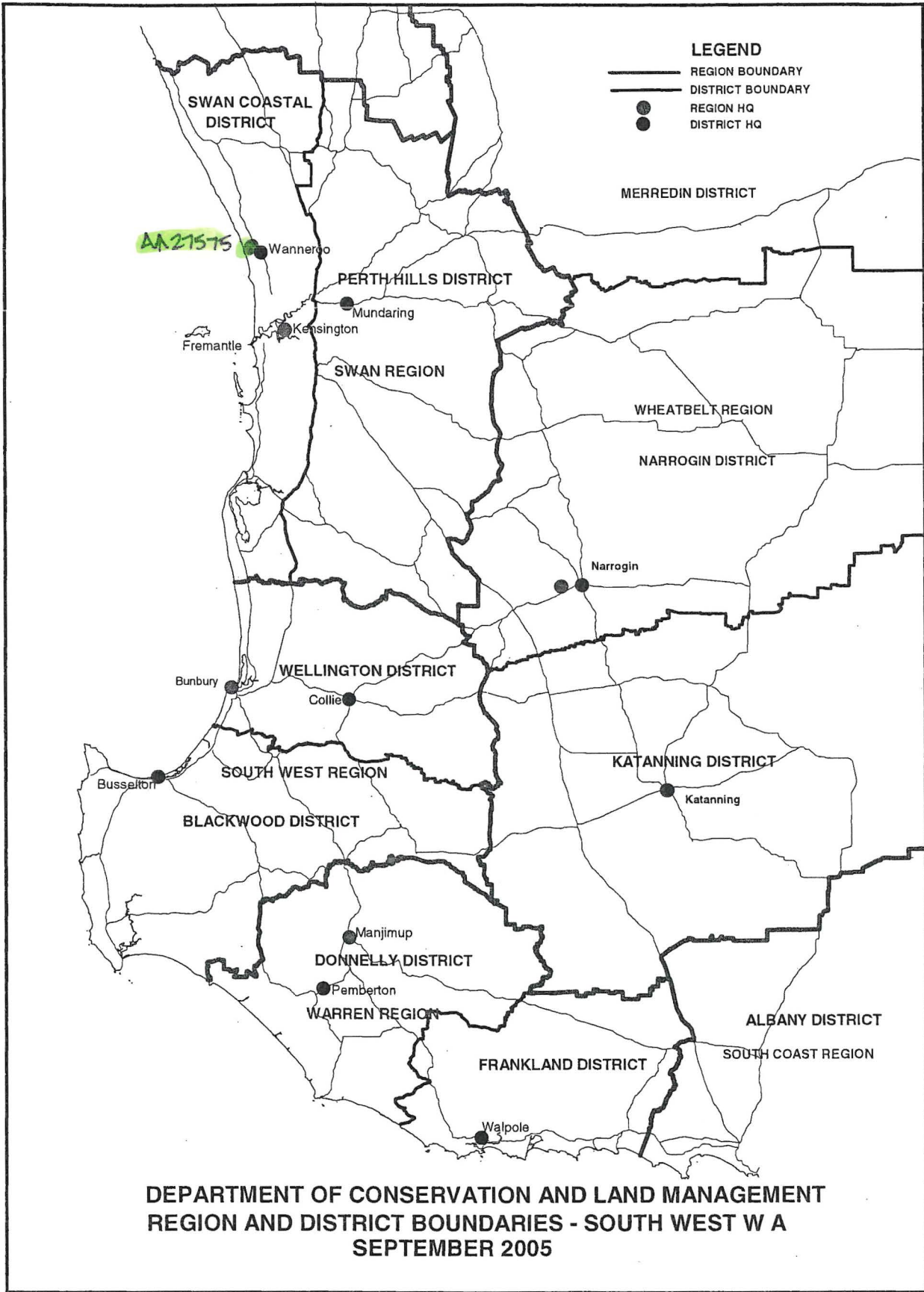

Report Name: Detail Report

Query Criteria

Crown Reserve No. = 27575

Special Comments

Crown Reserve: 27575	Tenure: National Park
Name: Neerabup National Park	Name Approval: Gazetted
	Date: 24-Dec-1976
Vesting: Conservation Commission	Gazettal Date: 29-Sep-1972
Purpose: National Park	Gazettal Date: 02-Jul-1965
Class: A	Gazettal Date: 02-Jul-1965
Area: 943.50	Gazettal Date: 19-Oct-2005
	Surveyed Status: Surveyed
CALM File: 039688F3201	Management Plan:
Remark:	

Notes:

Information shown must be considered in the context of the applied query criteria as detailed in full on the cover sheet.

CALM Tenure Information System - Report Generated on Friday, 10 March 2006

Page 2

Report Name: Gazettal History

Query Criteria

Crown Reserve No. = 27575

Special Comments

Crown Reserve	27575	Class:	A	Name Approval:	Gazetted
Name:	Neerabup National Park		Area:	943.5 ha	
Tenure:	National Park				
Purpose:	National Park				
Vesting:	Conservation Commission				

<u>Date</u>	<u>Gazettal Action</u>	<u>Description</u>
01-Oct-2005	Area Addition	Lot 999 On Office Of Titles Diag 96200 (+6.2034 ha) - An Update from DOLA is pending.
28-Aug-2001	Area	Abt 937.2990 (As Amended By The "Reserves(neerabup National Park) Act 2000") H852251
28-Aug-2001	Area Excision	(-122.5494 ha) - An Update from DOLA is pending.
16-Nov-2000	Comment	Conservation Commission Established Due To CALM Amendment Act 2000 (No 35 of 2000). Supersedes LFC And NPNCA.
09-Dec-1997	Area	Abt 1059.8484 (By Reserves Act 38 Of 1997)
09-Dec-1997	DOLA File	2103/63 & 445/96
09-Dec-1997	Public Plan	Bg35(2) 6.11, (10) 2.3
31-Jan-1992	Area	1068.6380
19-Feb-1988	Area	1094.1797 (By Reserves Act 124 Of 1987)
10-Apr-1987	Area	Abt. 1090.1328 (Act 118 Of 1982)
28-Jul-1978	Area	1077.9912
13-Jan-1978	Area Excision	1085.7575
28-Jan-1977	Area Excision	1111.5539 Act 108 - 1976
24-Dec-1976	Name	Neerabup National Park
10-Dec-1976	Name	Neeribup National Park
17-Oct-1975	Area Addition	Abt 1143.1443
29-Sep-1972	Board	National Parks Board Of W.A.
01-Sep-1972	Vesting Revoked	
15-Oct-1971	Name	Neerabup Lake National Park
24-May-1968	Area Excision	2779.3.9 By Rd. 3590
02-Jul-1965	Class	A
02-Jul-1965	Original Area	Abt 2900.0.0
02-Jul-1965	Purpose	National Park
02-Jul-1965	Street	Wanneroo Rd
02-Jul-1965	Vesting	National Parks Authority Of W A Act 19 - 1976
02-Jul-1965	Vesting	National Parks Board Of W A
	?	Abt 1125.0000, P72
	Area Addition	1090.1328 Include Loc 10313 Act 118 - 1982
	Area Excision	1026.1066 By Loc, 10122 Act 12 - 1981
	Area Excision	2784.1.38 3485/65, P35 Act 72 - 1966
	Location	Swan Loc 6270, 10313, 3323, 3321 And 10987:(by Reserves Act 124 Of 1987), 12880(Ex.min.6/95) 12903, 12904(Ex.min.3/93)
	Survey No.	Misc Plan 19820
02-Jul-1965	Original Gazettal	

RESERVE ACTION SHEET - CONSERVATION RESERVES

RESERVE No. **27575**

REASON FOR ACTION

- Excision of 8.7896 ha from class "A" reserve (Neerabup National Park) vested in the NPNCA for the purpose of "National Park". Area: Abt. 1059.8 ha
- Excision, through Reserves Bill action, results from a request from Water Corporation, and is in line with Cabinet approval. Excised area is to be set aside as a reserve for "Ground Water Treatment Plant", vested in Water Corp. Water Corp is to fund acquisition of (at least) an equivalent area for inclusion into the Park.
- Gazettal date: 9 - 12 - 1997 See folios 82 and 83 and Reserves Bill notes at pages 80 and 81
- Plans at folios 79, 84 and 85

	OFFICER	ACTION
1	RESERVES <i>sc</i>	<ul style="list-style-type: none"> - Fill in above details _____ - Attach copies of gazettal notices to file _____
2	INDEX CLERK, RECORDS	<ul style="list-style-type: none"> - Index reserve's name _____ - Index reserve's number _____
3	RESERVES CLERK <i>sc</i>	Send copies of gazettal notices and Map to: <ul style="list-style-type: none"> - Clerk, Woodvale _____ - District Manager, Perth _____ - Regional Manager, Swan _____
4	CONSERVATION ESTATE OFFICER	To note: <i>Sharon Colliss 16.2.98</i>
5	LAND ACQUISITIONS OFFICER	To note:
6	MANAGER, PLANNING & VISITOR SERVICES	To note:
7	DIRECTOR, NATURE CONSERVATION/ NATIONAL PARKS	To note:

Public Plan/s: BG34 (1) 28.48. Plain and Wickham Streets

Local Authority: City of Perth.

DOLA File: 02482-1995-01RO.

Reserve No 45145 comprising Gnowangerup Lots 412 and 413 with an area of 4304 square metres on Land Administration Diagram 93283 for the designated purpose of "Recreation and Public Utilities Services"

Public Plan/s: BK29 (2) 18.04. Porteous Street

Local Authority: Shire of Gnowangerup.

DOLA File: 01496-1997-01RO.

Reserve No 45147 comprising Northam Lot 436 with an area of 3569 square metres on land Administration Diagram 93035 for the designated purpose of "Health (Hospital and Ancillary Purposes)"

Public Plan/s: BH35 (2) 21.18. Chidlow Street

Local Authority: Town of Northam.

DOLA File: 02403-1997-01RO.

Reserve No 45148 comprising Northam Lot 444 with an area of 1333 square metres on Land Administration Diagram 93035 for the designated purpose of "Health (Staff Housing)"

Public Plan/s: BH35 (2) 21.18. Gairdner Street

Local Authority: Town of Northam.

DOLA File: 01300-1997-01RO.

Reserve No 45151 comprising Seabird Lot 47 with an area of 6867 square metres on Land Administration Plan 11213 for the designated purpose of "Park"

Public Plan/s: BF36 (2) 28.19. Chalon Avenue and McCormick Street

Local Authority: Shire of Gingin.

A. A. SKINNER, Chief Executive.

LA702*

RESERVES ACT 1997

(No.38 of 1997)

DOLA File: 00055-1997-01RO

It is hereby notified for public information, that as of 19 November 1997, the following actions were assented to and enacted.

1. Class A Reserve 2682 (Albany Lot 1373) "Public Park" is amended by excising that portion now described as Lot 1449 as surveyed on Land Administration Diagram 92968, and of its area being reduced to 114.8927 hectares accordingly.

DOLA File: 03857-1894-03RO

Public Plan: BK26 (2) 11.04

Local Authority: Town of Albany

2. The purpose of Class A Reserve 12397 (Avon Location 28942) is changed from "Water" to "Conservation of Flora and Fauna, and Water".

DOLA File: 00079-1906-03RO

Public Plan: Mears (25) NW

Local Authority: Shire of Brookton

3. a) The section of road described below is closed and all rights of way have ceased.

All that portion of Bolganup Road (Road No 11946) as surveyed and shown on Diagrams 2871 and 2872, comprising 2.8859 hectares or thereabouts, starting from the prolongation south-easterly of the eastern boundary of the northern severance of Porongurup Estate Lot 13 and extending generally north-easterly through Lots 14 and 15 of that Estate and north-easterly along the boundary of Lot 16 of that Estate to the prolongation south-easterly of the southernmost south-western boundary of Lot 17 of that Estate.

DOLA File: 02808-1954-01RO

Public Plan: Porongurup (25) SE & SW

Local Authority: Shire of Plantagenet

b) Class C Reserve 17644 (Plantagenet Location 5356) "Quarry (Gravel)" is cancelled.

DOLA File: 07467-1920-01RO

Public Plan: Porongurup (25) SE

Local Authority: Shire of Plantagenet

c) Plantagenet Location 142, held in Certificate of Title Volume 1783 Folio 407, is revested in Her Majesty as of Her former estate and removed from the operation of the Transfer of Land Act 1893 (redescribed as Plantagenet Location 7905).

DOLA File: 08711-1912-04RO

- d) Class C Reserve 24151 (at Porongurup Estate) "Mount Barker Water Supply" is amended to comprise Lot 28 as surveyed on Land Administration Plan 19581 in lieu of Lot 22 and of its area being reduced to 6.3486 hectares accordingly.

DOLA File: 02808-1954-01RO

Public Plan: Porongurup (25) SE & SW

Local Authority: Shire of Plantagenet

- e) Class A 18987 (at Porongurup Estate and Plantagenet District) "National Park" is amended to comprise—

- i) Plantagenet Locations 909, 951, 966, 1036, 1037, 1106, 5058, 5075, 5356, 5878, 7073, 7436, 7526, 7569, 7570, 7904 and 7905 on Diagram 2959, Diagram 3671, Plan Plantagenet 298, Diagram 7448, Diagram A1889, Diagram 49189, Reserve Diagram 1450, Plan 8077, Diagram 80864, Diagram 45/73, Diagram 2957, Diagram 3397 and Plan Plantagenet 99, and

- ii) Porongurup Estate Lots 2, 3, 4, 6, 7, 10, 11, 13, 23, 24, 25, 26 and 27 as shown on Diagrams 49187, 49188, 2865, 49189, 2864, 2873, 2962, ~~2874, 74806, 67297, 43035~~ and Plan 19581 and of its area being established at 2,620.9620 hectares accordingly.

DOLA File: 08711-1912-04RO

Public Plan: Porongurup (25) SE & SW

Local Authority: Shire of Plantagenet

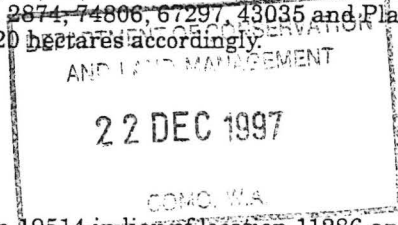

- 4. Class A Reserve 9337 (Swan District) is amended—

- i) to comprise Location 12734 on Land Administration Plan 19514 in lieu of Location 11286 and of its area being reduced to 4.412 hectares, and

- ii) by its purpose being changed from "Recreation" to "Recreation and Occasional Vehicle Parking".

DOLA File: 11699-1902-04RO

Public Plan: BG34 (2) 11.25, 11.26, 12.25 & 12.26

Local Authority: City of Subiaco

- 5. i) Lot 235 on Office of Titles Plan 20781, held in Certificate of Title Volume 2045 Folio 975, is revested in Her Majesty as of Her former estate and removed from the operation of the Transfer of Land Act 1893 (redescribed as Avon Location 29168).

DOLA File: 01061-1921-02RO

- ii) Class A Reserve 21429 (Avon Location 22049) "Conservation of Flora and Fauna" is amended to include Location 29168, formerly Lot 235 on Office of Titles Plan 20781, and of its area being increased to 254.2034 hectares accordingly.

DOLA File: 01061-1921-02RO

Public Plan: BG35 (5) 02.14

Local Authority: Shire of Toodyay

- 6. Class A Reserve 27575 (Swan Locations 3321, 3323, 6270 and 10313) "National Park" is amended by the excision of that portion now described as Location 12520 as surveyed on Land Administration Diagram 92531 and of its area being reduced to about 1,059.8484 hectares accordingly.

DOLA File: 02103-1963-04RO & 00445-1996-01RO

Public Plan: BG35 (2) 6.11 & (10) 2.3

Local Authority: City of Wanneroo.

A. A. SKINNER, Chief Executive.

LA703*

**CONSERVATION AND LAND MANAGEMENT ACT 1984
RESERVATION OF STATE FOREST ORDER**

Made by the Governor under Section 8.

DOLA Files: 00724-1929-03RO, 00832-1961-01RO; CALM File: 011672F3001

It is directed that the areas described in the schedules be dedicated as additions to State Forest No. 41 and 55, respectively.

SCHEDULE

1. The whole of the unnamed road (20.12 metres wide) as surveyed and shown on Land Administration Plan Bridgetown 481, starting from a northwestern side of South Western Highway and extending generally westerly through State Forest No. 41 to its terminus at the northwestern corner of former Nelson Location 7194.

Area: 9.3147 hectares

CLAUSE 10

Reserve No. 27575 (Neerabup National Park) in the City of Wanneroo

- 20 10. Reserve No. 27575, classified as of Class A, comprising 1 068.638 0 hectares or thereabouts set apart for "National Park" and vested in the Authority, is amended by excising an area of 8.789 6 hectares, shown as Swan Location 12520 on Diagram 92531, so that the reserve comprises 1 059.848 4 hectares or thereabouts.

CLAUSE 10

Class "A" "National Park" Reserve 27575 was created and proclaimed in July 1965. It presently contains an area of about 1068.6380 hectares and is under the control of the National Parks and Nature Conservation Authority. The reserve is known as the Neerabup National Park.

At the request of the Water Corporation and in line with Cabinet approval dated 20 November 1995 it is now proposed to excise an area of 8.7896 hectares, surveyed and now identified as Swan Location 12520 on Diagram 92531 from the Class "A" reserve. This area, Location 12520, has been earmarked for the development of a water treatment plant to service the rapidly expanding urban development in the region.

The Water Corporation has given this project a high priority and due to contractual arrangements seek to have the proposed excision considered by Parliament at an early date. Community consultation has occurred, the Corporation has completed the public Preliminaries to Works advertising and consultation processes, clearing the way for Minister for Water Resources to authorise construction.

The National Parks and Nature Conservation Authority support of the proposal was conditional and Cabinet directed the then Water Authority of WA to fund the acquisition of at least an equivalent area of private land for inclusion into the National Park in light of this conditional support. The Water Corporation has funds available and land acquisition is being arranged by the Ministry of Planning as part of a larger addition to the Neerabup National Park.

Should the area be excised from the National Park it is proposed, via the normal Executive Council process to set Swan Location 12520 aside for "Ground Water Treatment Plant" and vest it in the Water Corporation. The Native Title ramifications of this action will be investigated, subject to the approval of the Parliament being obtained for the excision.

This clause seeks the approval of both Houses of Parliament to the excision from the reserve.

Electoral District of Wanneroo
North Metropolitan Electoral Region
City of Wanneroo

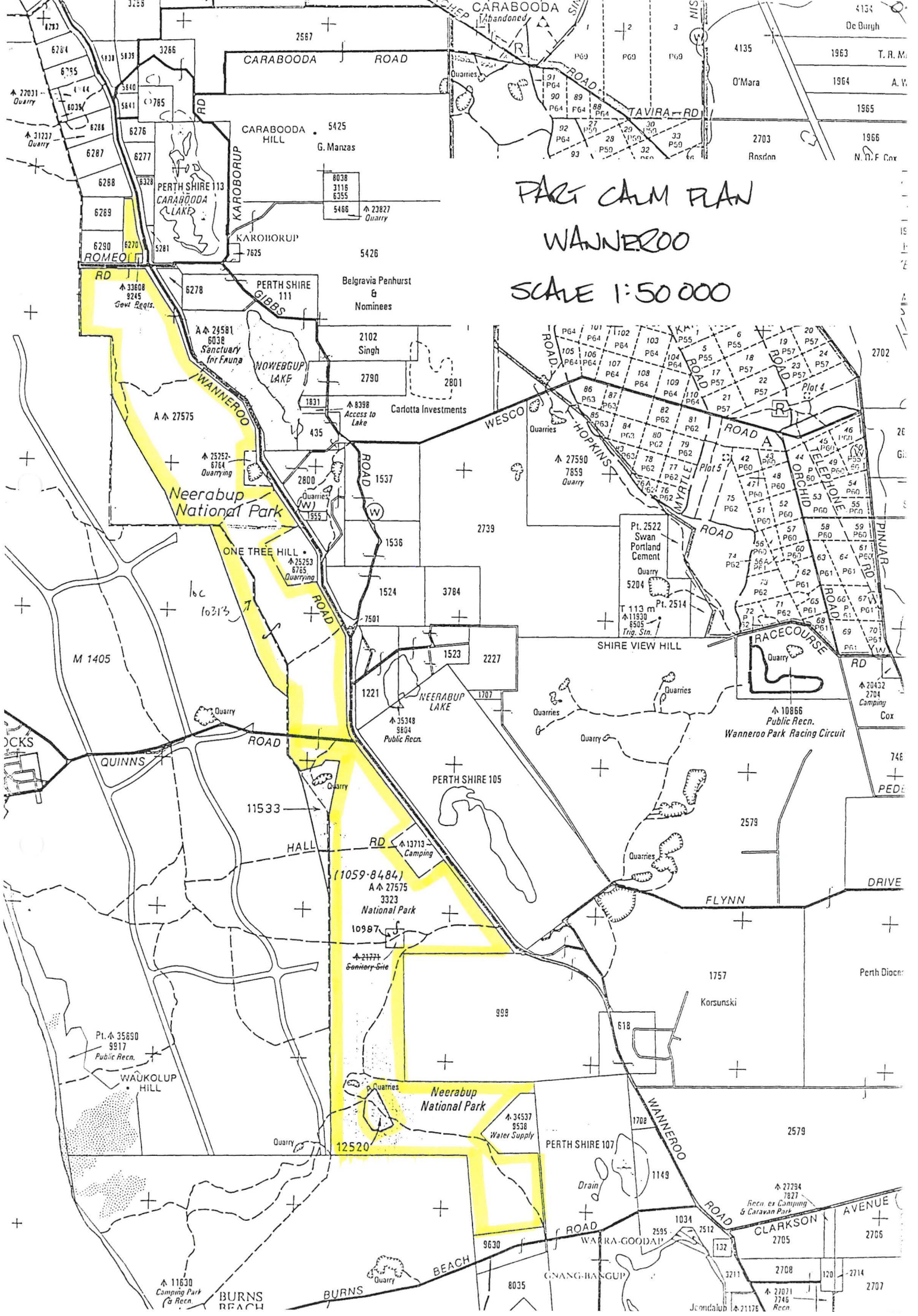

PART CALM PLAN
 WANNEROO
 SCALE 1:50 000

4134	De Burgh
1963	T. R. M.
1964	A. V.
1965	
1966	N. D. F. Cox

3258
 2557
 6284
 6795
 6038
 6286
 6287
 6288
 6289
 6290
 6270
 5281
 33608
 9245
 Govt Regis.
 24581
 6038
 Sanctuary for Fauna
 257575
 25252
 6764
 Quarrying
 25253
 6765
 Quarrying
 10213
 M 1405
 QUINNS ROAD
 WAUKOLUP HILL
 35690
 9917
 Public Recn.
 11630
 Camping Park
 & Recn.
 BURNS BEACH
 11533
 HALL RD
 10987
 21777
 Sanitary Site
 12520
 34537
 9538
 Water Supply
 8035
 2595
 2512
 132
 2708
 2705
 2714
 2707
 21175
 Recn. ex Camping & Caravan Park
 27294
 1827
 2705
 2706
 2714
 2707

CARABOODA ROAD
 CARABOODA HILL
 5425
 G. Manzas
 5426
 Belgravia Penhurst & Nominees
 2102
 Singh
 2790
 2801
 1831
 8398
 Access to Lake
 435
 1537
 1536
 1524
 3784
 7501
 1523
 2227
 1221
 NEERABUP LAKE
 35348
 9804
 Public Recn.
 11930
 8505
 Trig. Stn.
 SHIRE VIEW HILL
 QUARRIES
 10866
 Public Recn.
 Wanneroo Park Racing Circuit
 20432
 2794
 Camping
 COX
 746
 PEDERNAULT DRIVE
 2579
 1757
 Korsunski
 618
 1708
 WANNEROO ROAD
 2579
 1149
 1031
 2512
 132
 2708
 2705
 2714
 2707
 21175
 Recn. ex Camping & Caravan Park
 27294
 1827
 2705
 2706
 2714
 2707

ANNEXURE 2

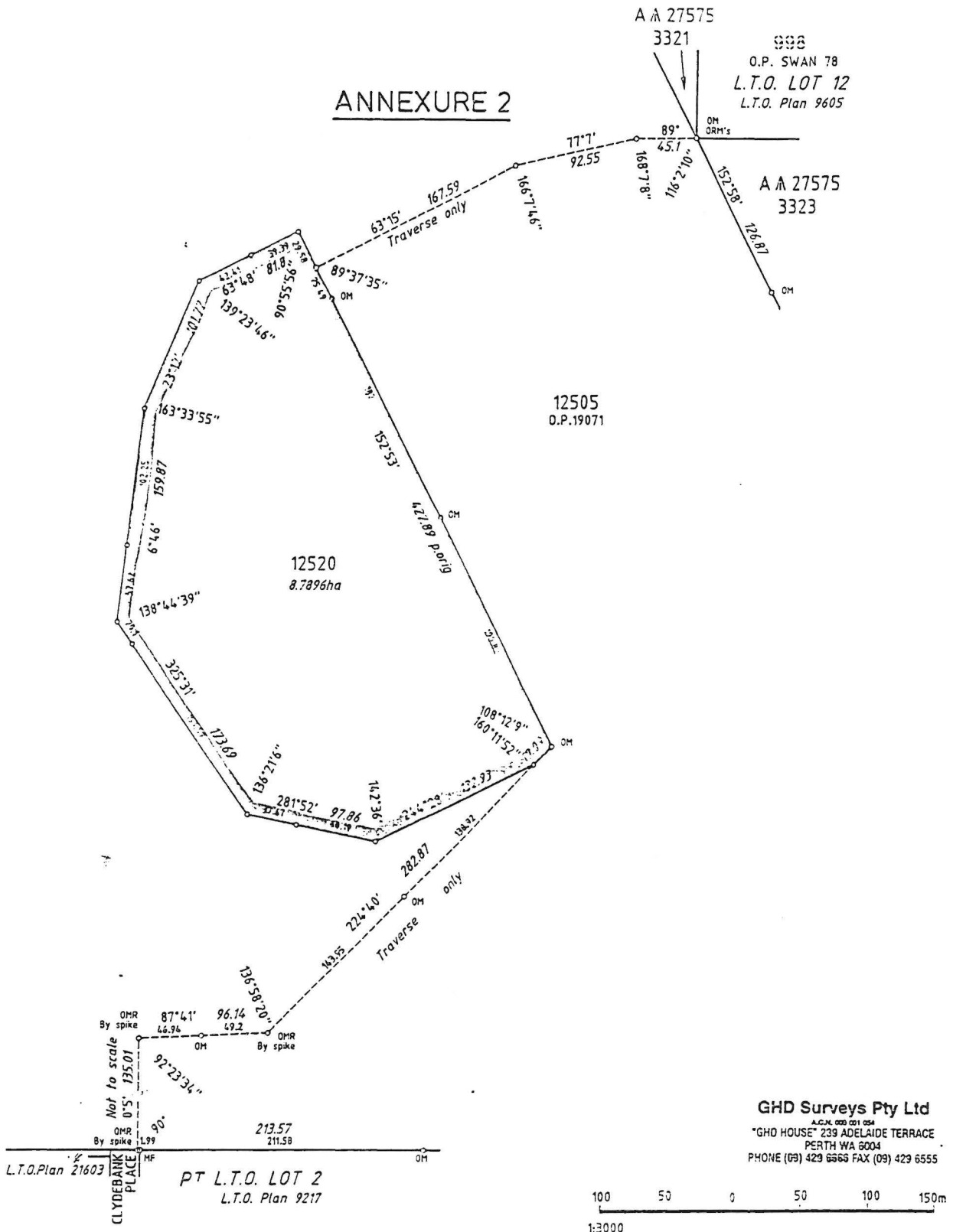

GHD Surveys Pty Ltd
A.C.N. 000 001 054
 "GHD HOUSE" 239 ADELAIDE TERRACE
 PERTH WA 6004
 PHONE (08) 429 6565 FAX (08) 429 6555

L.T.O. Plan 21603
 CLYDEBANK PLACE
 MF
 Not to scale
 0°5' 135.01
 92°23'34"
 87°41' 96.14
 66.94 49.2
 213.57 211.58
 90°
 PT L.T.O. LOT 2
 L.T.O. Plan 9217

100 50 0 50 100 150m
 1:3000

LAND DISTRICT SWAN		LOCATION 12520				
SURVEYOR'S CERTIFICATE				3105-85-V1 REV 0 DISK1757	SCALE 1:3000	FILE 445/996
I certify that: This plan of survey is a correct and accurate representation of the survey carried out by me personally / <i>(Signature)</i> or supervised and checked and recorded in Fieldbooks lodged for the purpose of this plan of survey; the measurements are in strict accordance with the Licensed Surveyors (Guidance of Surveyors) Regulations 1961 and in particular regulations 22 and 34 of those regulations; and the survey and this plan of survey are in strict accordance with the requirements of the Licensed Surveyors Guidance of Surveyors Regulations 1961 and the relevant law in relation to which it is lodged.				Measurements in metres		
Licensed Surveyor <i>(Signature)</i>		Date 12-3-97		PUBLIC PLAN (S) BG35 (2) 6.11 BG35 (10) 2.3		
GHD SURVEYS PTY LTD		In order for certification		RECORDED Date		
DATE OF VALIDATION		DIAGRAM CERTIFIED CORRECT		SURVEY INDEX PLAN (S) BG35 (2) 6.11 BG35 (5) 3.05		
For further action		Authorized Land Officer		RECORDED Date		
Date 1-2-97		Date		LOCAL AUTHORITY: CITY OF WANNEROO LOCALITY: NEERABUP		
				LODGED DJH 18-3-97		
				DEPARTMENT OF LAND ADMINISTRATION DIAGRAM 92531		

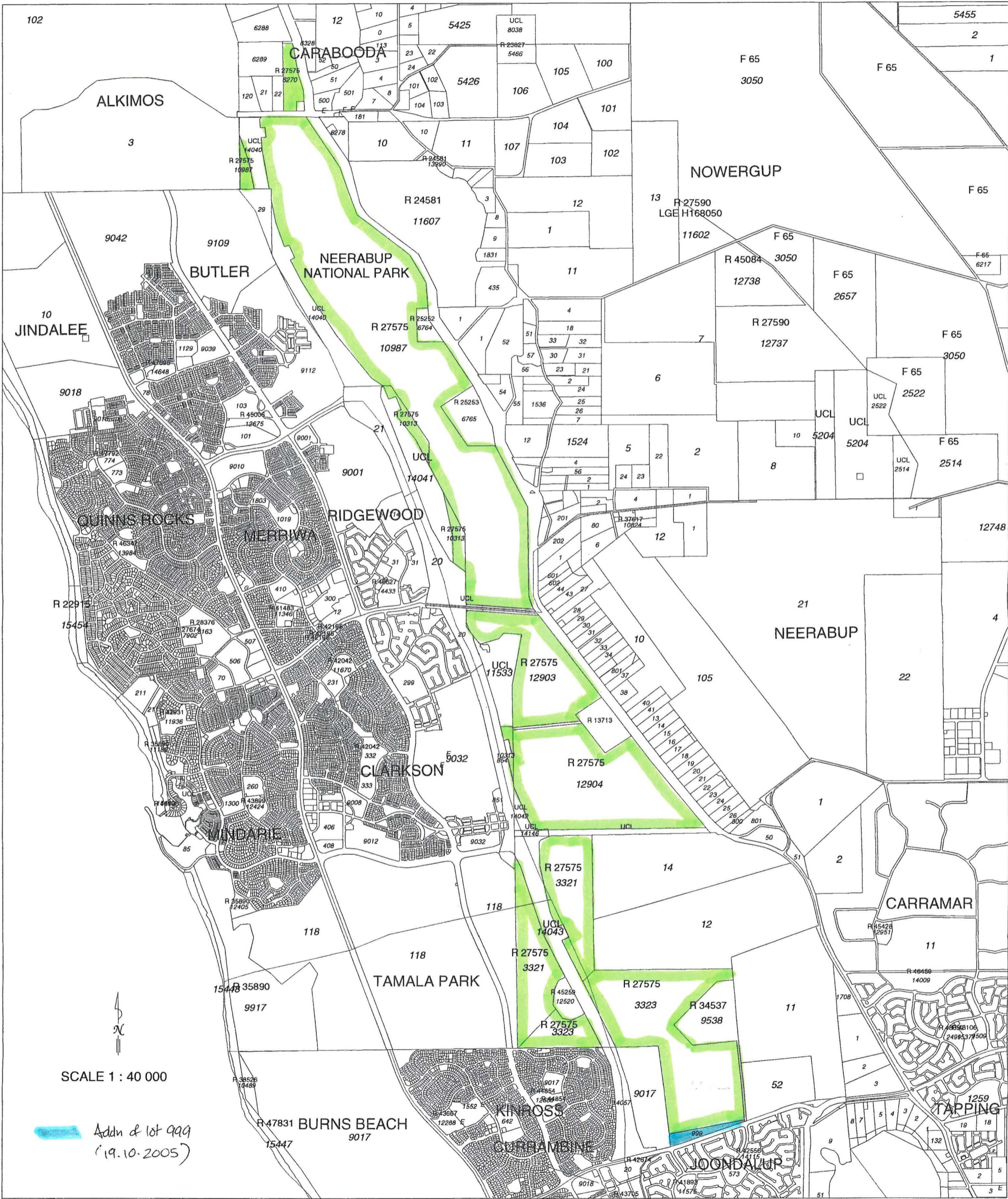

SCALE 1 : 40 000

Addn of lot 999
(19.10.2005)