

NATURE RESERVE

RESERVE NO: 28319

GOVERNMENT GAZETTE  
Date Page No.

FILE NUMBER: 1208/76

PURPOSE: Conservation of Flora  
and Fauna

23.5.80 1555

NAME:

CLASS (Land Act):

AREA: 40.4762 ha

14.10.66 2715

VESTING: W.A.W.A.

23.5.80 1546

LOCATION NO(S): Avon 13181

CLASSIFICATION:  
(Wildlife Act  
Section 12A)

LITHO: 3C/40 E4

LOCAL AUTHORITY: QUAIRADING SHIRE

Notes:

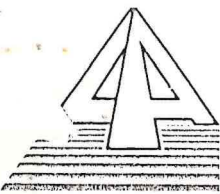

Department of  
**LAND ADMINISTRATION**

Your Ref:

Our Ref: 1900/984 CC:LW

Telephone: 323 1614 C. CARROLL  
Enquiries:

NATIONAL PARKS AND NATURE  
CONSERVATION AUTHORITY  
50 HAYMAN ROAD  
COMO WA 6152

Department of Conservation  
and Land Management

5 SEP 1983

COMO 1111

DEPARTMENT OF CONSERVATION  
AND LAND MANAGEMENT

7 JUN 1989

CCMS:W.A.

Sent direct

Dear Sir

I advise for your information that Executive Council has:-

1. Issued an Order in Council revoking the Orders in Council whereby Reserve No's. 27384, 27387, 27452, 27837, 28047, 28313, 28317, 28318, 28319, 28471, 28940, 29012, 29018, 29019, 29020, 29021, 29022, 29023, 29025, 29026, 29027, 29303, 29322, 29326, 29576, 29589, 29680, 29810, 30430, 30469, 30516, 30903, 30969, 31561, 31742, 31743, 31744, 31799, 31908, 31909, 31913, 32129, 32130, 32131, 32549, 32776, 32783, 32864, 32865, 32993, and 32995 were vested in the Western Australian Wildlife Authority in trust for the purpose of "Conservation of Flora and Fauna" and approve the cancellation of the relevant Vesting Orders accordingly.
2. Issued a Proclamation classifying as of Class "A" Reserve No's. 19784, 21424, 23029, 23085, 27384, 27386, 27387, 27452, 27769, 27837, 28047, 28313, 28317, 28318, 28319, 28471, 28669, 28759, 28846, 28940, 29012, 29018, 29019, 29020, 29021, 29022, 29023, 29025, 29026, 29027, 29303, 29322, 29326, 29576, 29589, 29680, 29810, 30430, 30469, 30516, 30903, 30969, 31561, 31742, 31743, 31744, 31799, 31908, 31909, 31913, 32129, 32130, 32131, 32549, 32776, 32783, 32864, 32865, 32993, 32995, 39379, 39404 and 39465 "Conservation of Flora and Fauna".
3. Issued an Order in Council directing that Class "A" Reserve No's. 27384, 27387, 27452, 27837, 28047, 28313, 28317, 28318, 28319, 28471, 28940, 29012, 29018, 29019, 29020, 29021, 29022, 29023, 29025, 29026, 29027, 29303, 29322, 29326, 29576, 29589, 29680, 29810, 30430, 30469, 30516, 30903, 30969, 31561, 31742, 31743, 31744, 31799, 31908, 31909, 31913, 32129, 32130, 32131, 32549, 32776, 32783, 32864, 32865, 32993, and 32995 shall vest in and be held by the National Parks and Nature Conservation Authority in trust for the purpose of "Conservation of Flora and Fauna".

↓ file.

.. /2.

Lark Woodvale

2- LANDS CLERK.

F. Y. I

Notice to this effect was published in the Government Gazette of May 5, 1989 and I enclose the relevant Vesting Orders.

Would you please return to this Office the superseded Vesting Orders for cancellation.

Yours faithfully

*Clawell*

*Jbr* P. COYNE  
MANAGER  
PROPERTY MANAGEMENT BRANCH  
LAND OPERATIONS DIVISION

June 2, 1989

Enc.

PM151LW1

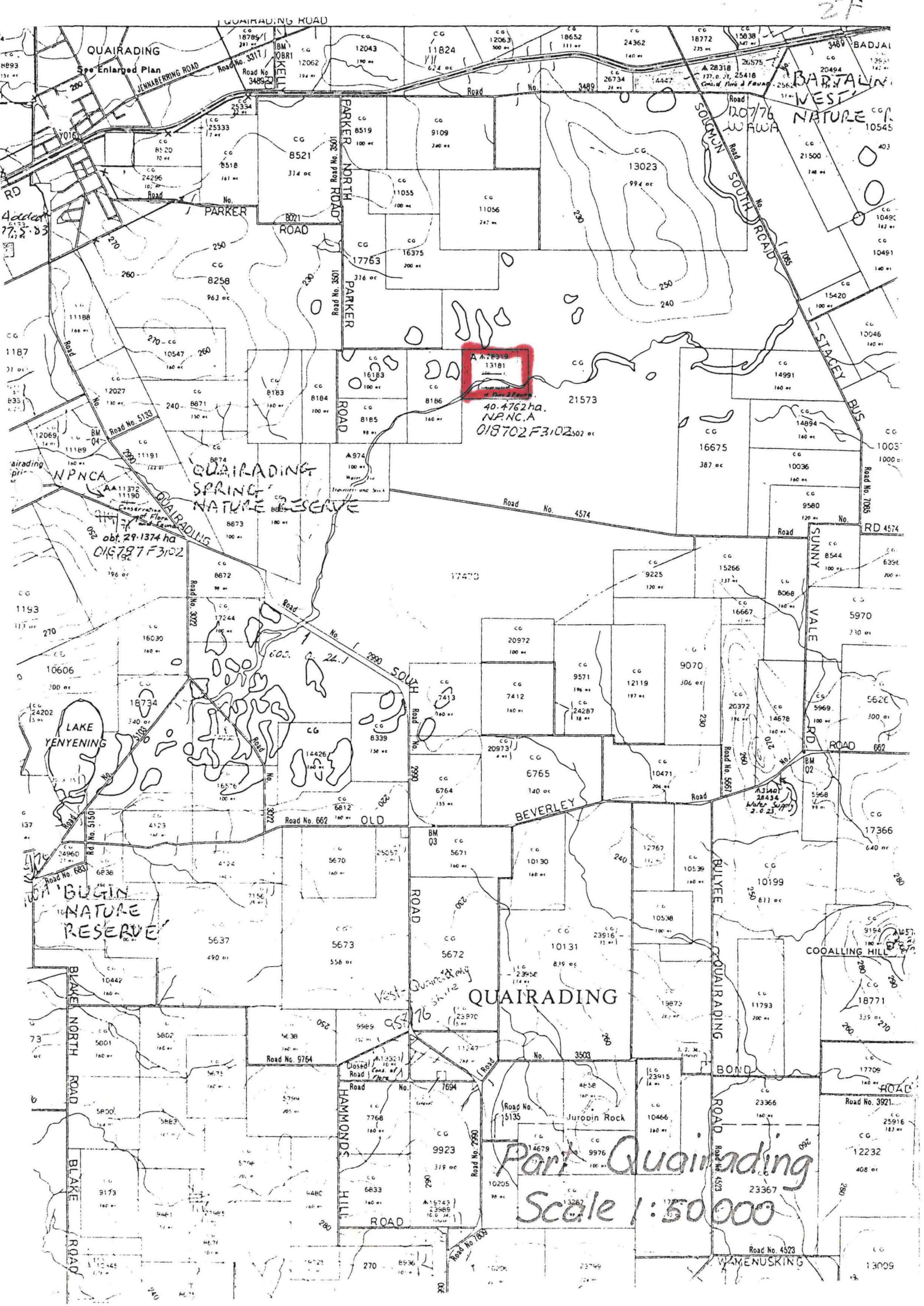

QUAIRADING  
See Enlarged Plan

BADJAI  
WEST  
NATURE  
RESERVE

QUAIRADING  
SPRING  
NATURE RESERVE

LAKE  
YENYENING

BUGIN  
NATURE  
RESERVE

QUAIRADING

Part Quairading  
Scale 1:50,000

A 78918  
13181  
40.4762 ha.  
NP.N.C.A.  
018702 F3102

West-Quairading  
95776

COALLING HILL

BLAKE NORTH ROAD

HAMMONDS HILL ROAD

BOND ROAD

WAMENUSKING ROAD

STACEY BUS ROAD

SUNNYVALE ROAD

BEVERLEY ROAD

PARKER NORTH ROAD

PARKER ROAD

SOLMONS SOUTH ROAD

JENNAMERING ROAD

QUAIRADING ROAD

QUAIRADING ROAD

QUAIRADING ROAD

QUAIRADING ROAD

QUAIRADING ROAD

QUAIRADING ROAD

QUAIRADING ROAD

QUAIRADING ROAD

QUAIRADING ROAD

Addn  
77, 8, 83

airading  
pri-

NP.N.C.A.

LAKE  
YENYENING

BUGIN  
NATURE  
RESERVE

BLAKE NORTH ROAD

HAMMONDS HILL ROAD

BOND ROAD

WAMENUSKING ROAD

QUAIRADING ROAD

CG 10545

CG 10490

CG 10491

CG 10046

CG 10050

CG 10051

CG 5970

CG 5620

CG 17366

CG 18771

CG 17709

CG 12232

CG 13009

CG 10490

CG 10491

CG 10492

CG 10493

CG 10494

CG 10495

CG 10496

CG 10497

CG 10498

CG 10499

CG 10500

CG 10501

CG 10502

CG 10503

CG 10504

CG 10505

CG 10506

CG 10507

CG 10508

CG 10509

CG 10510

CG 10511

CG 10512

CG 10513

CG 10514

CG 10515

CG 10516

CG 10517

CG 10518

CG 10519

CG 10520

CG 10521

CG 10522

CG 10523

CG 10524

CG 10525

CG 10526

CG 10527

CG 10528

CG 10529

CG 10530

CG 10531

CG 10532

CG 10533

CG 10534

CG 10535

CG 10536

CG 10537

CG 10538

CG 10539

CG 10540

CG 10541

CG 10542

CG 10543

CG 10544

CG 10545

CG 10546

CG 10547

CG 10548

CG 10549

CG 10550

CG 10551

CG 10552

CG 10553

CG 10554

CG 10555

CG 10556

CG 10557

CG 10558

CG 10559

CG 10560

CG 10561

CG 10562

CG 10563

CG 10564

CG 10565

CG 10566

CG 10567

CG 10568

CG 10569

CG 10570

CG 10571

CG 10572

CG 10573

CG 10574

CG 10575

CG 10576

CG 10577

CG 10578

CG 10579

CG 10580

CG 10581

CG 10582

CG 10583

CG 10584

CG 10585

CG 10586

CG 10587

CG 10588

CG 10589

CG 10590

CG 10591

CG 10592

CG 10593

CG 10594

CG 10595

CG 10596

CG 10597

CG 10598

CG 10599

CG 10600

CG 10601

CG 10602

CG 10603

CG 10604

CG 10605

CG 10606

CG 10607

CG 10608

CG 10609

CG 10610

CG 10611

CG 10612

CG 10613

CG 10614

CG 10615

CG 10616

CG 10617

CG 10618

CG 10619

CG 10620

CG 10621

CG 10622

CG 10623

CG 10624

CG 10625

CG 10626

CG 10627

CG 10628

CG 10629

CG 10630

CG 10631

CG 10632

CG 10633

CG 10634

CG 10635

CG 10636

CG 10637

CG 10638

CG 10639

CG 10640

with the advice and consent of Executive Council do by this my Proclamation classify as of Class "A" the reserve described in the schedule.

## Schedule

File Number; Reserve Number; Land Description; Area (hectares); Plan.

- 2106/66—33113; Fitzgerald Locations 1589, 1622 and 1623; 8859.5543; 392/80.
- 100/73—33828; Charlie Island; Indeterminable; Edel 1:250 000.
- 3270/06—33842; All those portions of land delineated and bordered red on Lands and Surveys Reserve Plan No. 35 including Hay Locations 788, 158, 216, 113, 110, 111, 142, 692 and 1724 to 1734 (inclusive) together with Plantagenet Locations 1598, 1209, 4367 and 3123 and excluding roads; 3825.4123; Parry Inlet NW & NE and Owingup SW 1:25 000.
- 2361/70—33854; Ninghan Location 4189; 19.5084; 65/80.
- 4281/74—34197; Jilbadji Location 936; 637.4387; 23/80.
- 3265/72—34257; Swan Island; about 29.0322; Yampi 1:250 000.
- 2043/67—34295; Roe Location 2688; 929.0621; 346/80.
- 5433/27—35217; Ninghan Locations 4206 and 4207; 70.1177; 65/80.
- 1375/28—35413; Avon Location 25238; 592.1195; Trayning 1:50 000 and Kodi Kodjin 1:50 000.
- 3736/11—35428; Plantagenet Locations 7412 and 7427; about 97.1726; Tambellup SE 1:25 000.
- 681/52—35621; Denmark Lot 352; 12.3176; Denmark 1:2 000 20.12 and 20.13.
- 3268/72—36056; Rocky Islets; about 40.9500; 422/80.
- 3624/78—36183; Esperance Location 1873; 357.5296; 402/80 and 403/80.
- 1472/78—36334; Pintharuka Lot 37; 61.5892; Pintharuka Townsite.
- 1604/69—36550; Plantagenet Location 7453; 174.0938; Two Peoples Bay NE 1:25 000.
- 3946/77—36608; Fitzgerald Location 1649; 80.6128; Dowak Townsite.
- 3379/980—36967; Kent Location 2042; 145.8710; 418/80.
- 2534/980—37054; Williams Location 15700; 16.3127; Congelin SW 1:25 000.
- 1817/70—37316; Victoria Location 10572; about 60.7028; Wongoondy NW 1:25 000.
- 1237/983—38296; Avon Location 28716; 143.9107; Norpa 1:50 000 and 24/80.
- 800/982—38334; Neridup Location 484; 407.8176; 400/80.
- 573/26—38415; Wellington Location 2642; 40.4686; Muja SE 1:25 000.
- 1747/983—38522; Yarding Lot 37; 69.2599; Yarding Townsite.
- 2788/983—38544; Neridup Location 495; 839.0247; 400/80.
- 3245/982—38545; Neridup Location 488; 1670.5074; 400/80.
- 4340/29—38574; Ninghan Location 4237; 92.1582; Beacon 1:50 000.
- 1108/17—38578; South Kumminin Lot 37 and Avon Location 19666; 81.2932; South Kumminin Townsite.
- 6850/10—38703; Amery Lot 31; 70.2161; Amery Townsite.
- 3097/983—38800; Yilgarn Location 1517; 66.3183; 54/80.
- 2496/28—39038; Ninghan Location 2790; 185.1051; Newcarlbeon NW 1:25 000.

Given under my hand and the Public Seal of Western Australia, at Perth, on 18 April 1989.

By His Excellency's Command,  
E. K. HALLAHAN,  
Minister for Lands.

GOD SAVE THE QUEEN !

Land Act 1933

## PROCLAMATION

WESTERN AUSTRALIA } By His Excellency Professor Gordon Reid, Com-  
GORDON REID, } panion of the Order of Australia, Governor of the  
Governor. } State of Western Australia.  
[L.S.]

File No. 1900/984.

WHEREAS by section 31 (2) of the Land Act 1933, the governor may by Proclamation cancel the reservation of any land classified as of Class "B"; and whereas it is deemed expedient that the Reserves described and listed in the attached Schedule for the purpose of "Conservation of Flora and Fauna" should be cancelled: Now therefore, I, the Governor, with the advice and consent of Executive Council do by this my Proclamation cancel the reservation as of Class "B" the land described in the Schedule.

## Schedule

File numbers; Reserve numbers; Land Description; Area (hectares); Plan.

- 1389/67—29253; North, Middle and South Cervantes Islands; about 4000; Cervantes Regional.
- 1392/67—29256; Fisherman Islands—North and South Islands; about 5.2419; Greenhead and Hill River 1:50 000.
- 1393/67—29257; North, Middle and South Essex Rocks and other unnamed Rocks; about 7.2580; Boullanger and Hill River 1:50 000.
- 1394/67—29258; Outer Rocks; indeterminable; Boullanger and Hill River 1:50 000.
- 1395/67—29259; Milligan, Lipfert, Webb and Snag Islands, Drummond and Orton Rocks; about 6.3709; Greenhead and Lesueur 1:50 000.
- 1396/67—29260; Ronsard Rocks; indeterminable; Boullanger and Hill River 1:50 000.

Given under my hand and the Public Seal of Western Australia, at Perth, on 18 April 1989.

By His Excellency's Command,  
E. K. HALLAHAN,  
Minister for Lands.

GOD SAVE THE QUEEN !

Land Act 1933

## PROCLAMATION

WESTERN AUSTRALIA } By His Excellency Professor Gordon Reid, Com-  
GORDON REID, } panion of the Order of Australia, Governor of the  
Governor. } State of Western Australia.  
[L.S.]

File No. 1900/984.

WHEREAS by Section 31 (1) (a) of the Land Act 1933, the Governor may by Proclamation and subject to such conditions as may be expressed therein classify as of Class "A" any such lands of the Crown reserved to Her Majesty for any purpose; and whereas it is deemed expedient that the reserves listed in the attached schedule for the purpose of "Conservation of Flora and Fauna" as described, should be classified as of Class "A": Now, therefore I, the Governor, with the advice and consent of Executive Council do by this my Proclamation classify as of Class "A" the reserve described in the attached schedule.

## Schedule

File numbers; Reserve numbers; Land Description; Area (hectares); Plan.

- 466/28—19784; Wellington Location 4003; 40.4737; Blackwood River S.W. and N.W. 1:25 000.
- 7129/23—21424; Avon Location 23508; 153.7805; Lomos N.W. 1:25 000.
- 5160/49—23029; Ninghan Location 1311; 161.5202; Mollerin 1:50 000.
- 1742/50—23085; Avon Location 28907; 78.2856; Yorkrakine S.E. 1:25 000.
- 3579/64—27384; Neridup Location 218; 604.7327; Burdett 1:50 000.
- 3584/64—27386; Neridup Location 271; 1417.2235; 402/80.
- 3585/64—27387; Neridup Location 286; 812.2041; Burdett 1:50 000.
- 140/63—27452; Avon Location 28192; 39.4973; Bruce Rock 1:50 000.

24.5.89  
i. Lands AR

4812/01—27769; Kojonup Location 9155; 46.1657; Boscabel S.E. 1:25 000.

245/66—27837; Roe Locations 1120, 2142 and 2972; about 2154; 375/80.

479/61—28047; Roe Location 1401; 628.2922; Lake Liddelow 1:50 000.

2802/66—28313; Victoria Locations 9328 and 10803; 928.9585; 155/80.

2562/66—28317; Avon Location 24828; 26.4134; Quairading N.E. 1:25 000.

3089/66—28318; Avon Locations 14447, 25418 and 26575; 55.5102; Quairading N.E. 1:25 000.

3090/66—28319; Avon Location 13181; 40.4762; Quairading N.E. 1:25 000.

1267/64—28471; Kojonup Locations 8231, 8427 and 8428; about 253.7379; Boscabel N.E. 1:25 000.

1491/67—28669; Victoria Location 10955; 157.7338; Marchagee 1:50 000.

4013/66—28759; Roe Locations 971 and 1176; 397.2774; Magenta and Newdegate 1:50 000.

2922/67—28846; Esperance Location 1886; 56.0236; Bostock Swamp 1:50 000.

2714/46—28940; Jilbadji Locations 913, 969 and 975; 4377.3492; 24/80.

1607/66—29012; Esperance Location 1876; 1403.5257; Scadden 1:50 000.

177/68—29018; Roe Location 2601; 1659.7650; Lake Bidy 1:50 000.

178/68; 29019; Roe Location 2602; 3322.8966; Lake Bidy 1:50 000.

2162/67—29020; Roe Location 2603; 1527.6377; Lake Bryde 1:50 000.

2163/67—29021; Roe Location 2604; 107.0520; Lake Bryde 1:50 000.

2164/67—29022; Roe Location 2606; about 50.0000; Lake Bryde 1:50 000.

2165/67—29023; Roe Location 2607; 1528.8492; Lake Bryde 1:50 000.

2167/67—29025; Roe Location 2609; 206.9158; Burngup 1:50 000.

2168/67—29026; Roe Location 2874; 32.3445; Lake Bryde 1:50 000.

210/68—29027; Roe Locations 2487 and 2488; 1251.9721; 375/80.

1389/67—29253; North, Middle and South Cervantes Islands; about 4.0000; Cervantes Regional.

1392/67—29256; Fisherman Islands—North and South Islands; about 5.2419; Greenhead and Hill River 1:50 000.

1393/67—29257; North, Middle and South Essex Rocks and other unnamed rocks; about 7.2580; Boullanger and Hill River 1:50 000.

1394/67—29258; Outer Rocks; indeterminate; Boullanger and Hill River 1:50 000.

1395/67—29259; Milligan, Lipfert, Webb and Snag Islands, Drummond and Orton Rocks and adjacent unnamed rocks; about 6.3709; Greenhead and Lesueur 1:50 000.

1396/67—29260; Ronsard Rocks; indeterminate; Boullanger and Hill River 1:50 000.

222/67—29303; Ninghan Location 4180; about 194.2491; Blain 1:50 000.

570/17—29322; Avon Locations 6777, 13007, 15043 and 28696; 221.5533; Brookton 1:50 000.

2254/68—29326; Nugadong Lot 39; about 8.4352; Nugadong 1:2 000 20.19.

2541/68—29576; Roe Location 2753; 511.6416; Gulson 1:50 000.

4634/65—29589; Williams Location 15538; 40.4686; Yilliminning N.W. 1:25 000.

2456/25—29680; Red Lake Lots 33, 34, 37 and 38; 76.0624; Red Lake Townsite.

2016/67—29810; Roe Location 2949; about 1133.1198; Lake Liddelow 1:50 000.

2716/46—30430; Yilgarn Location 1477; 120.3257; Boodarockin 1:50 000.

1708/70—30469; Plantagenet Location 7532; 10.3792; Albany 1:2 000 13.14 and 14.14.

2712/46—30516; Avon Location 27093; 106.2198; Norpa 1:50 000.

11956/10—30903; Kwolyin Agricultural Area Lot 420; 11.4324; Pantapin N.E. 1:25 000.

2633/21—30969; Kwolyin Agricultural Area Lots 344 and 345; 283.0043; Kwolyin 1:50 000.

1187/61—31561; Denmark Estate Lot 346; 52.3056; Denmark Regional North.

1739/72—31742; Oldfield Location 1240; 1179.3830; 403/80.

1740/72—31743; Oldfield Locations 1122 and 1262; 95.6854; 403/80.

1741/72—31744; Oldfield Location 1123; 288.3031; 403/80.

2488/72—31799; Neridup Locations 360, 362 and 381; 3617.5380; Lilliecrona 1:50 000.

3263/72—31908; Shelter Island; about 10.0000; Torbay N.E. and S.E. 1:25 000.

3256/72—31909; Glasse Island; about 4.0000; 447/80.

4489/57—31913; Wellington Locations 4010, 4663 and 5141; 1161.2125; Blackwood River N.E. and N.W. 1:25 000.

412/73—32129; Neridup Location 337; 1751.5680; 424/80.

411/73—32130; Neridup Location 334; 2480.5458; 424/80.

413/73—32131; Neridup Location 342; 1057.6586; 424/80.

900/70—32549; Roe Locations 1229, 2976, 3046 and 3072; 3619.0744; Eclipse Lake 1:50 000.

1638/74—32776; Neridup Location 404; 4732.1055; 401/80.

1645/74—32783; Neridup Location 436; 7082.1326; 401/80.

1117/68—32864; Yilgarn Locations 1462 and 1463; 1436.9125; 67/80.

2332/988—32865; Yilgarn Location 1465; 579.1684; 67/80.

569/69—32993; Ninghan Location 4226; 43.5838; 54/80.

2535/72—32995; Jilbadji Location 928; 1886.0468; Holleton 1:50 000.

3195/985—39379; Kulyaling Lots 59 and 60; 17.2617; Kulyaling Townsite.

1859/985—39404; Murray Location 1805; 184.3700; Mandurah 1:10 000 1.4 and 1.5 and 1:25 000 S.E.

1272/986—39465; Sussex Location 4557; 15.9522; Leeuwin N.W. 1:25 000.

Given under my hand and the Public Seal of Western Australia, at Perth, on 18 April 1989.

By His Excellency's Command,

E. K. HALLAHAN,  
Minister for Lands.

GOD SAVE THE QUEEN !

#### Land Act 1933

#### PROCLAMATION

WESTERN AUSTRALIA } By His Excellency Professor Gordon Reid, Com-  
GORDON REID, } panion of the Order of Australia, Governor of the  
Governor. } State of Western Australia.  
[L.S.]

File No. 1900/984.

WHEREAS by section 31 (1) (a) of the Land Act 1933, the Governor may by Proclamation and subject to such conditions as may be expressed therein classify as of Class "A" any such lands of the Crown reserved to Her Majesty for any purpose; and whereas it is deemed expedient that the reserves listed in the attached schedule for the purpose of "Conservation of Flora and Fauna" as described, should be classified as of Class "A": now, therefore I, the Governor, with the advice and consent of Executive Council do by this my Proclamation classify as of Class "A" the reserve described in the attached schedule.

#### Schedule

File No.; Reserve No.; Land Description; Area (hectares);  
Plan.

6134/97—4313; Avon Location 24527; 43.7060; Quelagetting 1:50 000.

8947/96—8830; Avon Location 28513; 23.9117; Cunderdin 1:50 000.

3261/14—15564; Avon Location 9421; about 16.9968; Bencubbin 1:50 000.

2769/54—15570; Avon Location 20307; 40.4686; Lake Wallambin S.E. 1:25 000.

6370/14—16136; Torbay Agricultural Area Lot 183; 15.7777; Torbay N.W. and S.W. 1:25 000.

1979 at pages 3079-3080 and varied from time to time thereafter by inserting in the Schedule, after Part 15, the following Part—

“

Part 16

All that portion of land bounded by lines starting from the southernmost southwestern corner of Paraburdoo Lot 6, as surveyed and shown on Department of Land Administration Original Plan 16987, and extending generally northeasterly and generally easterly along southeastern and southern boundaries of that lot to the prolongation northerly of the eastern side of Robe Avenue; thence southerly to and along that side and onwards to a northwestern boundary of the southeastern severance of Windell Location 30; thence generally southwesterly, generally westerly, northwesterly and northeasterly along boundaries of that severance to a south-western side of Camp Road; thence generally northwesterly and generally southwesterly along sides of that road to an eastern side of Beasley Road and thence northerly and generally northwesterly along sides of that road to the starting point.

(Department of Land Administration Public Plans Paraburdoo Regional and Paraburdoo 2000 02.34, 03.34, 03.35, 04.34 and 04.35. ”

Given under my hand and the Seal of the State on 2 May 1989.

By His Excellency's Command,  
 KAY HALLAHAN,  
 Minister for Local Government.  
 GOD SAVE THE QUEEN !

At a Meeting of the Executive Council held in the Executive Council Chamber, at Perth, this 18th day of April 1989, the following Orders in Council were authorised to be issued.

Child Welfare Act 1947  
 ORDER IN COUNCIL

WHEREAS by section 19 (2) (a) of the Child Welfare Act 1947 it is provided that the Governor may appoint such persons, male or female, as he may think fit, to be members of any particular Children's Court and may determine the respective seniorities of such members and whereas by section 19 (1) (b) (ii) of the said Act the Governor may amend, vary or revoke any such appointment: Now therefore His Excellency the Governor by and with the advice and consent of the Executive Council hereby appoints the person named in the First Schedule hereto to be a member of the Children's Court at the place mentioned and hereby revokes the appointment of the persons named in the Second Schedule hereto to be members of the Children's Court at the place mentioned.

First Schedule

Newman—Rhonda Diane Chapman.

Second Schedule

Newman—  
 Peter John Alfred Collins.  
 Elizabeth Margaret Jayes.

G. PEARCE,  
 Clerk of the Council.

Child Welfare Act 1947  
 ORDER IN COUNCIL

WHEREAS by section 19 (2) (a) of the Child Welfare Act 1947 it is provided that the Governor may appoint such persons, male or female, as he may think fit, to be members of any particular Children's Court and may determine the respective seniorities of such members, and whereas by section 19 (1) (b) (ii) of the said Act the Governor may amend, vary or revoke any such appointment: Now therefore His Excellency the Governor by and with the advice and consent of the Executive Council hereby revokes the appointment of the person named in the Schedule hereto as a member of the Children's Court at the place mentioned.

Schedule

Norseman—Betty Logan.

G. PEARCE,  
 Clerk of the Council.

Child Welfare Act 1947

ORDER IN COUNCIL

WHEREAS by section 19 (2) (a) of the Child Welfare Act 1947 it is provided that the Governor may appoint such persons, male or female, as he may think fit, to be members of any particular Children's Court and may determine the respective seniorities of such members and whereas by section 19 (1) (b) (ii) of the said Act the Governor may amend, vary or revoke any such appointment: Now therefore His Excellency the Governor by and with the advice and consent of the Executive Council hereby appoints the persons named in the First Schedule hereto to be members of the Children's Court at the place mentioned and hereby revokes the appointment of the persons named in the Second Schedule hereto to be members of the Children's Court at the place mentioned.

First Schedule

Onslow—  
 Maisie Hyland.  
 John Hayes.  
 Elsie Lavinia Munro.

Second Schedule

Onslow—  
 Alec Francis Tucker.  
 Kevin Zanetti.

G. PEARCE,  
 Clerk of the Council.

Land Act 1933

ORDERS IN COUNCIL

WHEREAS by section 33 of the Land Act 1933, it is made lawful for the Governor to direct that any Reserve shall vest in and be held by any person or persons to be named in the order in trust for the like or other public purposes to be specified in such order: And whereas it is deemed expedient as follows—

File No. 1900/984.—That Class "A" Reserves 17946, 18340, 18342, 18381, 18950, 19036, 19093, 19916, 19118, 19650, 20262, 20479, 20482, 20834, 21056, 21153, 21230, 21830, 21981, 22792, 23008, 23141, 23156, 23171, 23316, 23325, 23566, 23665, 23934, 24532, 24534, 24677, 24835, 24891, 24912, 24944, 24979, 25112, 25546, 25809, 26196, 26266, 26403, 26508, 26564, 26569, 26661, 26687, 26792, 26809, 26819, 27108, 27146, 27219, 27283 and 27354, should vest in and be held by the National Parks and Nature Conservation Authority in trust for the purpose of "Conservation of Flora and Fauna".

File No. 1900/984.—That Class "A" Reserves 27384, 27387, 27452, 27837, 28047, 28313, 28317, 28318, 28319, 28471, 28940, 29012, 29018, 29019, 29020, 29021, 29022, 29023, 29025, 29026, 29027, 29253, 29256, 29257, 29258, 29259, 29260, 29303, 29322, 29326, 29576, 29589, 29680, 29810, 30430, 30469, 30516, 30903, 30969, 31561, 31742, 31743, 31744, 31799, 31908, 31909, 31913, 32129, 32130, 32131, 32549, 32776, 32783, 32864, 32865, 32993 and 32995, should vest in and be held by the National Parks and Nature Conservation Authority in trust for the purpose of "Conservation of Flora and Fauna".

File No. 1900/984.—That Class "A" Reserves 33113, 33828, 33842, 33854, 34197, 34257, 34295, 35217, 35413, 35428, 35621, 36056, 36183, 36334, 36550, 36608, 36967, 37054, 37316, 38296, 38334, 38415, 38522, 38544, 38545, 38574, 38578, 38703, 38800 and 39038, should vest in and be held by the National Parks and Nature Conservation Authority in trust for the purpose of "Conservation of Flora and Fauna".

File No. 2745/21.—That Class "A" Reserve No. 17826 (Perth Lots S35, 66, 461, 732 and portion of Lot 567) should vest in and be held by the City of Perth in trust for the purpose of "Park Gardens and Parking".

File No. 169/64.—That Class "A" Reserve No. 27139 (Plantagenet Location 5961) should vest in and be held by the National Parks and Nature Conservation Authority in trust for the purpose of "Conservation of Flora and Fauna".

File No. 296/61.—That Class "A" Reserve No. 28167 (Peel Estate Lots 26 and 442) should vest in and be held by the National Parks and Nature Conservation Authority in trust for the purpose of "Conservation of Flora and Fauna".

File No. 1875/960.—And whereas by Order in Council dated 11 May, 1977, Reserve No. 25766 was vested in the Shire of Kalamunda in trust for the purpose of "Municipal Purposes".

File No. 7917/12.—And whereas by Order in Council dated 1 February, 1962, Reserve No. 26205 was vested in the Minister for Native Welfare in trust for the purpose of "Native Housing".

File No. 169/64.—And whereas by Order in Council dated 24 February, 1966, Reserve 27139 was vested in the Fauna Protection Advisory Committee of Western Australia in trust for the purpose of "Conservation of Flora and Fauna".

File No. 296/61.—And whereas by Order in Council dated 29 June, 1966, Reserve 28167 was vested in the Fauna Protection Advisory Committee of Western Australia in trust for the purpose of "Conservation of Flora and Fauna".

File No. 1060/73.—And whereas by Order in Council dated 16 May, 1973, Reserve 32017 was vested in the Minister of Water Supply Sewerage and Drainage in trust for the purpose of "Water Supply".

File No. 1528/79.—And whereas by Order in Council dated 20 February, 1980, Reserve 36519 was vested in the Western Australian Wildlife Authority in trust for the purpose of "Conservation of Flora and Fauna".

File No. 2592/79.—And whereas by Order in Council dated 29 October, 1980, Reserve 36943 was vested in the City of Stirling in trust for the purpose of "Recreation".

File No. 2831/982.—And whereas by Order in Council dated 30 September, 1983, Reserve 38477 was vested in the Shire of Wyndham-East Kimberley in trust for the purpose of "Aged Persons Homes".

File No. 2056/985.—And whereas by Order in Council dated 27 August, 1985, Reserve 39189 was vested in the Shire of Kent in trust for the purpose of "Recreation (Go Kart Racing)" with power, subject to the approval in writing of the Minister for Lands being first obtained, to lease the whole or any portion thereof for any term not exceeding twenty one (21) years from the date of the lease.

File No. 1900/984.—And whereas by Order in Council issued on dates specified in the attached Schedule the respective Reserves were vested in the Western Australian Wildlife Authority in trust for the purpose of "Conservation of Flora and Fauna".

Schedule Reserve Nos; Date of Order in Council.

Table with 2 columns: Reserve Nos, Date of Order in Council. Rows include 4313 (Nov 21, 1980), 8830 (Nov 5, 1975), 15564 (Aug 2, 1983), 15570 (May 1, 1980), 16136 (Apr 29, 1981), 16235 (July 5, 1983), 16293 (March 6, 1984), 16346 (May 24, 1978), 16412 (May 28, 1980), 16493 (October 29, 1980), 16683 (June 21, 1983), 17055 (April 8, 1970), 17257 (April 8, 1970), 17771 (May 31, 1983), 17778 (June 29, 1981).

File No. 1900/984.—And whereas by Orders in Council issued on dates specified in the attached Schedule the respective Reserves were vested in the Western Australian Wildlife Authority in trust for the purpose of "Conservation of Flora and Fauna".

Schedule Reserve Nos; Order in Council Date.

Table with 2 columns: Reserve Nos, Order in Council Date. Rows include 27384 (Aug 3, 1981), 27387 (July 5, 1983), 27452 (September 18, 1979), 27837 (July 11, 1973), 28047 (August 26, 1981), 28313 (July 9, 1980), 28317 (May 1, 1980), 28318 (May 13, 1980), 28319 (May 13, 1980), 28471 (January 26, 1972), 28940 (November 8, 1983).

Table with 2 columns: Reserve Nos, Date. Rows include 29012 (August 2, 1983), 29018 (February 4, 1970), 29019 (February 4, 1970), 29020 (January 14, 1970), 29021 (February 4, 1970), 29022 (January 14, 1970), 29023 (January 14, 1970), 29025 (February 4, 1970), 29026 (February 4, 1970), 29027 (November 21, 1980), 29253 (November 9, 1978), 29256 (November 9, 1978), 29257 (November 9, 1978), 29258 (November 9, 1978), 29259 (November 9, 1978), 29260 (November 9, 1978), 29303 (May 1, 1980), 29322 (May 1, 1984), 29326 (October 1, 1980), 29576 (October 25, 1983), 29589 (July 5, 1983), 29680 (April 15, 1971), 29810 (November 12, 1969), 30430 (July 9, 1980), 30469 (July 19, 1983), 30516 (July 5, 1983), 30903 (August 8, 1979), 30969 (September 5, 1979), 31561 (August 2, 1983), 31742 (August 30, 1983), 31743 (June 29, 1981), 31744 (July 5, 1983), 31799 (May 16, 1983), 31908 (March 21, 1973), 31909 (March 21, 1973), 31913 (March 6, 1984), 32129 (September 30, 1983), 32130 (September 30, 1983), 32131 (July 19, 1983), 32549 (November 21, 1980), 32776 (July 17, 1974), 32783 (July 17, 1974), 32864 (May 3, 1983), 32865 (May 3, 1983), 32993 (May 3, 1983), 32995 (November 27, 1974).

File No. 1900/984.—And whereas by Orders in Council issued on dates specified in the attached schedule the respective Reserves were vested in the Western Australian Wildlife Authority in trust for the purpose of "Conservation of Flora and Fauna".

Schedule Reserve Nos; Date of Order in Council.

Table with 2 columns: Reserve Nos, Date of Order in Council. Rows include 33113 (January 22, 1975), 33828 (January 14, 1976), 33842 (January 28, 1976), 33854 (January 28, 1976), 34197 (August 11, 1976), 34257 (September 8, 1976), 34295 (August 3, 1981), 35217 (August 3, 1978), 35413 (July 5, 1978), 35428 (July 19, 1983), 35621 (August 2, 1983), 36056 (May 2, 1979), 36183 (July 11, 1979), 36334 (October 17, 1979), 36550 (March 5, 1980), 36608 (February 18, 1981), 36967 (November 14, 1980), 37054 (August 2, 1983), 37316 (August 3, 1981).