

NATURE RESERVE

RESERVE NO: 28669

GOVERNMENT GAZETTE
Date Page No.

FILE NUMBER: 1220/76

PURPOSE: Protection of Flora 7.7.67 1766

NAME:

CLASS (Land Act):

AREA: 157.7338 ha 7.7.67 1766

VESTING:

LOCATION NO(S) Vic. 10955

CLASSIFICATION:
(Wildlife Act
Section 12A)

LITHO: 90/80 D,E2

LOCAL AUTHORITY: COOROW SHIRE

Notes:

015859F3102

39
B.L.

with the advice and consent of Executive Council do by this my Proclamation classify as of Class "A" the reserve described in the schedule.

Schedule

File Number; Reserve Number; Land Description; Area (hectares); Plan.

- 2106/66—33113; Fitzgerald Locations 1589, 1622 and 1623; 8859.5543; 392/80.
- 100/73—33828; Charlie Island; Indeterminable; Edel 1:250 000.
- 3270/06—33842; All those portions of land delineated and bordered red on Lands and Surveys Reserve Plan No. 35 including Hay Locations 788, 158, 216, 113, 110, 111, 142, 692 and 1724 to 1734 (inclusive) together with Plantagenet Locations 1598, 1209, 4367 and 3123 and excluding roads; 3825.4123; Parry Inlet NW & NE and Owingup SW 1:25 000.
- 2361/70—33854; Ninghan Location 4189; 19.5084; 65/80.
- 4281/74—34197; Jilbadji Location 936; 637.4387; 23/80.
- 3265/72—34257; Swan Island; about 29.0322; Yampi 1:250 000.
- 2043/67—34295; Roe Location 2688; 929.0621; 346/80.
- 5433/27—35217; Ninghan Locations 4206 and 4207; 70.1177; 65/80.
- 1375/28—35413; Avon Location 25238; 592.1195; Trayning 1:50 000 and Kоди Kodjin 1:50 000.
- 3736/11—35428; Plantagenet Locations 7412 and 7427; about 97.1726; Tambellup SE 1:25 000.
- 681/52—35621; Denmark Lot 352; 12.3176; Denmark 1:2 000 20.12 and 20.13.
- 3268/72—36056; Rocky Islets; about 40.9500; 422/80.
- 3624/78—36183; Esperance Location 1873; 357.5296; 402/80 and 403/80.
- 1472/78—36334; Pintharuka Lot 37; 61.5892; Pintharuka Townsite.
- 1604/69—36550; Plantagenet Location 7453; 174.0938; Two Peoples Bay NE 1:25 000.
- 3946/77—36608; Fitzgerald Location 1649; 80.6128; Dowak Townsite.
- 3379/980—36967; Kent Location 2042; 145.8710; 418/80.
- 2534/980—37054; Williams Location 15700; 16.3127; Congelin SW 1:25 000.
- 1817/70—37316; Victoria Location 10572; about 60.7028; Wongoondy NW 1:25 000.
- 1237/983—38296; Avon Location 28716; 143.9107; Norpa 1:50 000 and 24/80.
- 800/982—38334; Neridup Location 484; 407.8176; 400/80.
- 573/26—38415; Wellington Location 2642; 40.4686; Muja SE 1:25 000.
- 1747/983—38522; Yarding Lot 37; 69.2599; Yarding Townsite.
- 2788/983—38544; Neridup Location 495; 839.0247; 400/80.
- 3245/982—38545; Neridup Location 488; 1670.5074; 400/80.
- 4340/29—38574; Ninghan Location 4237; 92.1582; Beacon 1:50 000.
- 1108/17—38578; South Kumminin Lot 37 and Avon Location 19666; 81.2932; South Kumminin Townsite.
- 6850/10—38703; Amery Lot 31; 70.2161; Amery Townsite.
- 3097/983—38800; Yilgarn Location 1517; 66.3183; 54/80.
- 2496/28—39038; Ninghan Location 2790; 185.1051; Newcarlbeon NW 1:25 000.

Given under my hand and the Public Seal of Western Australia, at Perth, on 18 April 1989.

By His Excellency's Command,
E. K. HALLAHAN,
Minister for Lands.

GOD SAVE THE QUEEN !

Land Act 1933

PROCLAMATION

WESTERN AUSTRALIA } By His Excellency Professor Gordon Reid, Com-
GORDON REID, } panion of the Order of Australia, Governor of the
Governor. } State of Western Australia.
[L.S.]

File No. 1900/984.

WHEREAS by section 31 (2) of the Land Act 1933, the governor may by Proclamation cancel the reservation of any land classified as of Class "B"; and whereas it is deemed expedient that the Reserves described and listed in the attached Schedule for the purpose of "Conservation of Flora and Fauna" should be cancelled: Now therefore, I, the Governor, with the advice and consent of Executive Council do by this my Proclamation cancel the reservation as of Class "B" the land described in the Schedule.

Schedule

File numbers; Reserve numbers; Land Description; Area (hectares); Plan.

- 1389/67—29253; North, Middle and South Cervantes Islands; about 4000; Cervantes Regional.
- 1392/67—29256; Fisherman Islands—North and South Islands; about 5.2419; Greenhead and Hill River 1:50 000.
- 1393/67—29257; North, Middle and South Essex Rocks and other unnamed Rocks; about 7.2580; Boullanger and Hill River 1:50 000.
- 1394/67—29258; Outer Rocks; indeterminable; Boullanger and Hill River 1:50 000.
- 1395/67—29259; Milligan, Lipfert, Webb and Snag Islands, Drummond and Orton Rocks; about 6.3709; Greenhead and Lesueur 1:50 000.
- 1396/67—29260; Ronsard Rocks; indeterminable; Boullanger and Hill River 1:50 000.

Given under my hand and the Public Seal of Western Australia, at Perth, on 18 April 1989.

By His Excellency's Command,
E. K. HALLAHAN,
Minister for Lands.

GOD SAVE THE QUEEN !

Land Act 1933

PROCLAMATION

WESTERN AUSTRALIA } By His Excellency Professor Gordon Reid, Com-
GORDON REID, } panion of the Order of Australia, Governor of the
Governor. } State of Western Australia.
[L.S.]

File No. 1900/984.

WHEREAS by Section 31 (1) (a) of the Land Act 1933, the Governor may by Proclamation and subject to such conditions as may be expressed therein classify as of Class "A" any such lands of the Crown reserved to Her Majesty for any purpose; and whereas it is deemed expedient that the reserves listed in the attached schedule for the purpose of "Conservation of Flora and Fauna" as described, should be classified as of Class "A": Now, therefore I, the Governor, with the advice and consent of Executive Council do by this my Proclamation classify as of Class "A" the reserve described in the attached schedule.

Schedule

File numbers; Reserve numbers; Land Description; Area (hectares); Plan.

- 466/28—19784; Wellington Location 4003; 40.4737; Blackwood River S.W. and N.W. 1:25 000.
- 7129/23—21424; Avon Location 23508; 153.7805; Lomos N.W. 1:25 000.
- 5160/49—23029; Ninghan Location 1311; 161.5202; Mollerin 1:50 000.
- 1742/50—23085; Avon Location 28907; 78.2856; Yorkrakine S.E. 1:25 000.
- 3579/64—27384; Neridup Location 218; 604.7327; Burdett 1:50 000.
- 3584/64—27386; Neridup Location 271; 1417.2235; 402/80.
- 3585/64—27387; Neridup Location 286; 812.2041; Burdett 1:50 000.
- 140/63—27452; Avon Location 28192; 39.4973; Bruce Rock 1:50 000.

23/5-89
I. Lands

- 4812/01—27769; Kojonup Location 9155; 46.1657; Boscabel S.E. 1:25 000.
- 245/66—27837; Roe Locations 1120, 2142 and 2972; about 2154; 375/80.
- 479/61—28047; Roe Location 1401; 628.2922; Lake Liddelow 1:50 000.
- 2802/66—28313; Victoria Locations 9328 and 10803; 928.9585; 155/80.
- 2562/66—28317; Avon Location 24828; 26.4134; Quairading N.E. 1:25 000.
- 3089/66—28318; Avon Locations 14447, 25418 and 26575; 55.5102; Quairading N.E. 1:25 000.
- 3090/66—28319; Avon Location 13181; 40.4762; Quairading N.E. 1:25 000.
- 1267/64—28471; Kojonup Locations 8231, 8427 and 8428; about 253.7379; Boscabel N.E. 1:25 000.
- 1491/67—28669; Victoria Location 10955; 157.7338; Marchagee 1:50 000.
- 4013/66—28759; Roe Locations 971 and 1176; 397.2774; Magenta and Newdegate 1:50 000.
- 2922/67—28846; Esperance Location 1886; 56.0236; Bostock Swamp 1:50 000.
- 2714/46—28940; Jilbadji Locations 913, 969 and 975; 4377.3492; 24/80.
- 1607/66—29012; Esperance Location 1876; 1403.5257; Scadden 1:50 000.
- 177/68—29018; Roe Location 2601; 1659.7650; Lake Bidy 1:50 000.
- 178/68; 29019; Roe Location 2602; 3322.8966; Lake Bidy 1:50 000.
- 2162/67—29020; Roe Location 2603; 1527.6377; Lake Bryde 1:50 000.
- 2163/67—29021; Roe Location 2604; 107.0520; Lake Bryde 1:50 000.
- 2164/67—29022; Roe Location 2606; about 50.0000; Lake Bryde 1:50 000.
- 2165/67—29023; Roe Location 2607; 1528.8492; Lake Bryde 1:50 000.
- 2167/67—29025; Roe Location 2609; 206.9158; Burngup 1:50 000.
- 2168/67—29026; Roe Location 2874; 32.3445; Lake Bryde 1:50 000.
- 210/68—29027; Roe Locations 2487 and 2488; 1251.9721; 375/80.
- 1389/67—29253; North, Middle and South Cervantes Islands; about 4.0000; Cervantes Regional.
- 1392/67—29256; Fisherman Islands—North and South Islands; about 5.2419; Greenhead and Hill River 1:50 000.
- 1393/67—29257; North, Middle and South Essex Rocks and other unnamed rocks; about 7.2580; Boullanger and Hill River 1:50 000.
- 1394/67—29258; Outer Rocks; indeterminable; Boullanger and Hill River 1:50 000.
- 1395/67—29259; Milligan, Lipfert, Webb and Snag Islands, Drummond and Orton Rocks and adjacent unnamed rocks; about 6.3709; Greenhead and Lesueur 1:50 000.
- 1396/67—29260; Ronsard Rocks; indeterminable; Boullanger and Hill River 1:50 000.
- 222/67—29303; Ninghan Location 4180; about 194.2491; Blain 1:50 000.
- 570/17—29322; Avon Locations 6777, 13007, 15043 and 28696; 221.5533; Brookton 1:50 000.
- 2254/68—29326; Nugadong Lot 39; about 8.4352; Nugadong 1:2 000 20.19.
- 2541/68—29576; Roe Location 2753; 511.6416; Gulson 1:50 000.
- 4634/65—29589; Williams Location 15538; 40.4686; Yilliminning N.W. 1:25 000.
- 2456/25—29680; Red Lake Lots 33, 34, 37 and 38; 76.0624; Red Lake Townsite.
- 2516/67—29810; Roe Location 2949; about 1133.1198; Lake Liddelow 1:50 000.
- 2716/46—30430; Yilgarn Location 1477; 120.3257; Boodarockin 1:50 000.
- 1708/70—30469; Plantagenet Location 7532; 10.3792; Albany 1:2 000 13.14 and 14.14.
- 2712/46—30516; Avon Location 27093; 106.2198; Norpa 1:50 000.
- 11956/10—30903; Kwolyin Agricultural Area Lot 420; 11.4324; Pantapin N.E. 1:25 000.
- 2633/21—30969; Kwolyin Agricultural Area Lots 344 and 345; 283.0043; Kwolyin 1:50 000.
- 1187/61—31561; Denmark Estate Lot 346; 52.3056; Denmark Regional North.
- 1739/72—31742; Oldfield Location 1240; 1179.3830; 403/80.
- 1740/72—31743; Oldfield Locations 1122 and 1262; 95.6854; 403/80.
- 1741/72—31744; Oldfield Location 1123; 288.3031; 403/80.
- 2488/72—31799; Neridup Locations 360, 362 and 381; 3617.5380; Lilliecrona 1:50 000.
- 3263/72—31908; Shelter Island; about 10.0000; Torbay N.E. and S.E. 1:25 000.
- 3256/72—31909; Glasse Island; about 4.0000; 447/80.
- 4489/57—31913; Wellington Locations 4010, 4663 and 5141; 1161.2125; Blackwood River N.E. and N.W. 1:25 000.
- 412/73—32129; Neridup Location 337; 1751.5680; 424/80.
- 411/73—32130; Neridup Location 334; 2480.5458; 424/80.
- 413/73—32131; Neridup Location 342; 1057.6586; 424/80.
- 900/70—32549; Roe Locations 1229, 2976, 3046 and 3072; 3619.0744; Eclipse Lake 1:50 000.
- 1638/74—32776; Neridup Location 404; 4732.1055; 401/80.
- 1645/74—32783; Neridup Location 436; 7082.1326; 401/80.
- 1117/68—32864; Yilgarn Locations 1462 and 1463; 1436.9125; 67/80.
- 2332/988—32865; Yilgarn Location 1465; 579.1684; 67/80.
- 569/69—32993; Ninghan Location 4226; 43.5838; 54/80.
- 2535/72—32995; Jilbadji Location 928; 1886.0468; Holleton 1:50 000.
- 3195/985—39379; Kulyaling Lots 59 and 60; 17.2617; Kulyaling Townsite.
- 1859/985—39404; Murray Location 1805; 184.3700; Mandurah 1:10 000 1.4 and 1.5 and 1:25 000 S.E.
- 1272/986—39465; Sussex Location 4557; 15.9522; Leeuwin N.W. 1:25 000.

Given under my hand and the Public Seal of Western Australia, at Perth, on 18 April 1989.

By His Excellency's Command,

E. K. HALLAHAN,
Minister for Lands.

GOD SAVE THE QUEEN !

Land Act 1933

PROCLAMATION

WESTERN AUSTRALIA } By His Excellency Professor Gordon Reid, Com-
GORDON REID, } panion of the Order of Australia, Governor of the
Governor. } State of Western Australia.
[L.S.]

File No. 1900/984.

WHEREAS by section 31 (1) (a) of the Land Act 1933, the Governor may by Proclamation and subject to such conditions as may be expressed therein classify as of Class "A" any such lands of the Crown reserved to Her Majesty for any purpose; and whereas it is deemed expedient that the reserves listed in the attached schedule for the purpose of "Conservation of Flora and Fauna" as described, should be classified as of Class "A"; now, therefore I, the Governor, with the advice and consent of Executive Council do by this my Proclamation classify as of Class "A" the reserve described in the attached schedule.

Schedule

File No.; Reserve No.; Land Description; Area (hectares);
Plan.

- 6134/97—4313; Avon Location 24527; 43.7060; Quelagetting 1:50 000.
- 8947/96—8830; Avon Location 28513; 23.9117; Cunderdin 1:50 000.
- 3261/14—15564; Avon Location 9421; about 16.9968; Bencubbin 1:50 000.
- 2769/54—15570; Avon Location 20307; 40.4686; Lake Wallambin S.E. 1:25 000.
- 6370/14—16136; Torbay Agricultural Area Lot 183; 15.7777; Torbay N.W. and S.W. 1:25 000.

W 1019/76 231

22



DEPARTMENT OF LANDS AND SURVEYS

Cathedral Avenue,
Perth,
Western Australia 6000

Department of Conservation
and Land Management
23 APR 1986
COMO, W.A.

Your Ref. W1019/76, W85/78 PT 10

Our Ref. 3907/27V2 CN:AP

Telephone Enquiries 323 1278

EXECUTIVE DIRECTOR
DEPARTMENT OF CONSERVATION
AND LAND MANAGEMENT

RESERVES 21175, 24325 and 28669

I refer to your memo of March 20, 1986 and advise for your information that Executive Council has:

- 1) approved of the amendment of Reserve No. 21175 (Victoria District) "Conservation of Flora" to comprise Victoria Location 11674 and of its area being increased to 121.5769 hectares.
- 2) approved of the purpose of Reserve No. 21175 (Victoria Location 11674) being changed from "Conservation of Flora" to "Conservation of Flora and Fauna" and issued an Order in Council directing that Reserve No 21175 shall vest in and be held by the National Parks and Nature Conservation Authority in trust for the purpose of Conservation of Flora and Fauna".

Notice to this effect was published in the Government Gazette of March 21, 1986 and I enclose a print showing the said amendment and the relevant Vesting Order.

Map amended (Mt Hawke
1:50,000)
cf 22/8/86

D. L. C. HARRISON
UNDER SECRETARY FOR LANDS

17 April 1986

enc

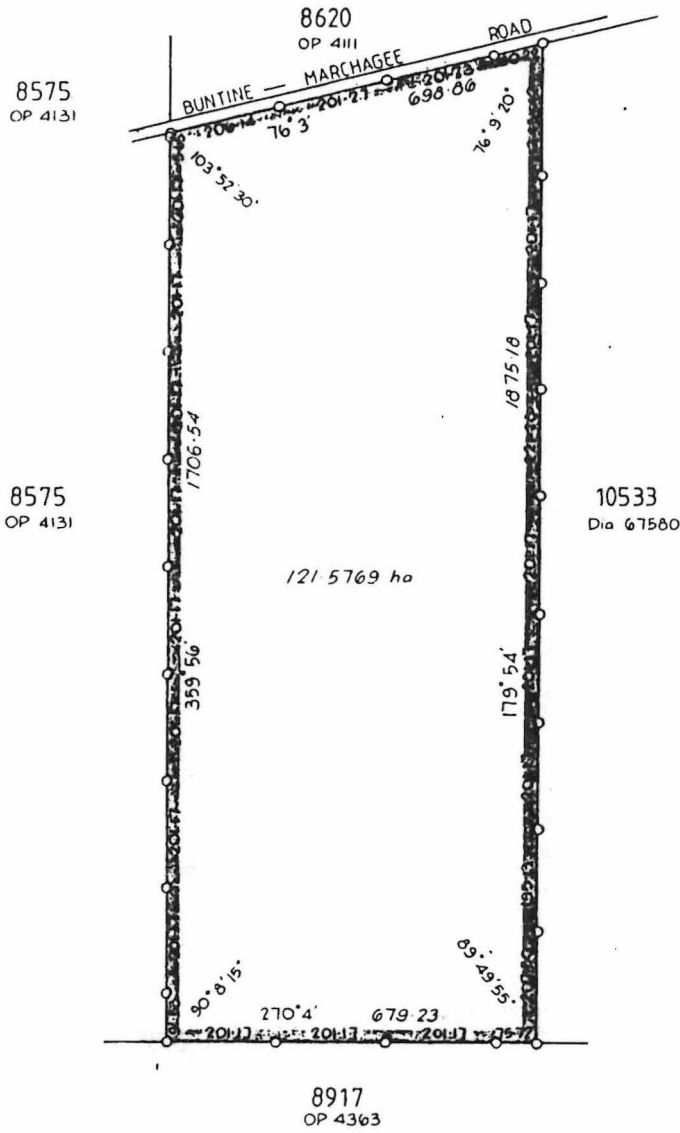

LAND DISTRICT VICTORIA	LOCATION 11674 (A 21175)		FILE No. 3907/27 V2	
			SCALE 1:10 000 All measurements in metres	
<p>SURVEYOR'S CERTIFICATE</p> <p>I hereby certify that this survey was performed by me personally (or under my personal supervision, inspection and field check), in strict accordance with the Licensed Surveyors (Guidance of Surveyors) Regulations.</p> <p>..... Licensed Surveyor</p> <p>Date</p>	Azimuth observed at or assumed from Diagram 67560 Date of marking Surveyor Field Book No. <u>COMPILED</u> Page Cadastral Plan, Mount Hawke 1:50 000 Reference 434676 Diagram Drawn J. Berg Date 20.11.05	Calc. Bk. No. Fol. Compared with F. B. <u>SP</u> Examined <u>[Signature]</u> 18.2.96 Diagram passed Inspector of Plans and Surveys Date	<p>SURVEY APPROVED</p> <p>..... Surveyor General</p> <p>Recorded on Public Plan.</p> <p>Registered Key Plan Mt. Hawke 1:50000 Custodian of Plans 3.12.98</p> <p>DEPT. OF LANDS AND SURVEYS DIAGRAM No. 87248</p>	
				CP 20444/9/85-600

1220/76

32

oh



DEPARTMENT OF LANDS AND SURVEYS

Cathedral Avenue,
Perth,
Western Australia 6000

Your Ref. 85/78 Part 10

Our Ref. 1491/67 CN:JG R11.15

Telephone
Enquiries

DEPARTMENT OF CONSERVATION
AND LAND MANAGEMENT
18 JUL 1985
COMO, W.A.

[Executive Director
Department of Conservation and
Land Management
State Operations Headquarters
50 Hayman Road
L COMO CDO]

NATURE RESERVES OF THE WESTERN AUSTRALIAN WHEATBELT - PART 10: COOROW SHIRE

I refer to your memo of May 20, 1985 and advise for your information that Executive Council has approved of the purpose of Reserve No. 28669 (Victoria Location 10955) being changed from "Protection of Flora" to "Conservation of Flora and Fauna" and issued an Order in Council directing that Reserve No. 28669 shall vest in and be held by the National Parks and Nature Conservation Authority in trust for the purpose of "Conservation of Flora and Fauna".

Notice to this effect was published in the Government Gazette of July 12, 1985 and I enclose a print showing the said reserve and the relevant Vesting Order.

UNDER SECRETARY FOR LANDS

July 16, 1985

enc

① J.C. Reserves ^{ren} 19/7/85

90/80
cf 15/9/86

copy on file 85/78 A10

