

## RESERVE ACTION SHEET: CONSERVATION RESERVES

**RESERVE No.** 28862      **LOCAL GOVERNMENT:** Shire of Serpentine/Jarrahdale

**NAME :** Serpentine National Park

**PURPOSE:** National Park

**VESTING:** Conservation Commission

### ACTION

Inclusion of Lot 4 Falls Road (11.992 hectares), portions of Selkirk Road which are now closed (3.9 hectares), and former Cockburn Location 262 (about 11 hectares) into the Reserve and a redescription and recalculation of the total area, resulting in a nett increase of approximately 30.6 hectares to the reserve's area.

**Total Area:** 663.0 hectares

### REASON FOR ACTION

Portions of the added land overlook the Serpentine Falls area, provide extensive views, and support extensive stands of Rock Sheoak. The addition of this land was recommended in the Serpentine National Park Management Plan 2000.

**Date of amendment:** 14/3/2006

**Maps:** pp. 41, 42, 43, 49 & 50

**Customer advice:** p. 38

**Summary of Action:** see p. 44

**Background Information:** pp. 45-51

**IUCN classification:** 1 (a)

Native Title: Native title is extinguished for Reserve 28862 due to vesting prior to 23 December 1996 (Ward High Court decision).

1	<b>LAND SERVICES CO-ORDINATOR</b>	To note	<i>SC</i>
	<b>LAND &amp; EXTERNAL FUNDING UNIT</b>	Send copies of advice and maps to: <ul style="list-style-type: none"> <li>• Lisa Wright (Woodvale)</li> <li>• District Manager</li> <li>• Regional Manager</li> </ul> Attach TENIS gazettal history to file Add report to Conservation Commission summary	
3	<b>SENIOR POLICY OFFICER, P.V.S.</b>	To note native title clearance	
4	<b>SENIOR POLICY OFFICER, CRAWLEY (for purchases)</b>	To note	
5	<b>DIRECTOR, NATURE CONSERVATION/ DIRECTOR, PARKS AND VISITOR SERVICES</b>	To note	
6	<b>C.I.S.</b>	Please rename file/create new file	
	<b>LAND &amp; EXTERNAL FUNDING UNIT</b>	Delete from District Proposals spreadsheet	

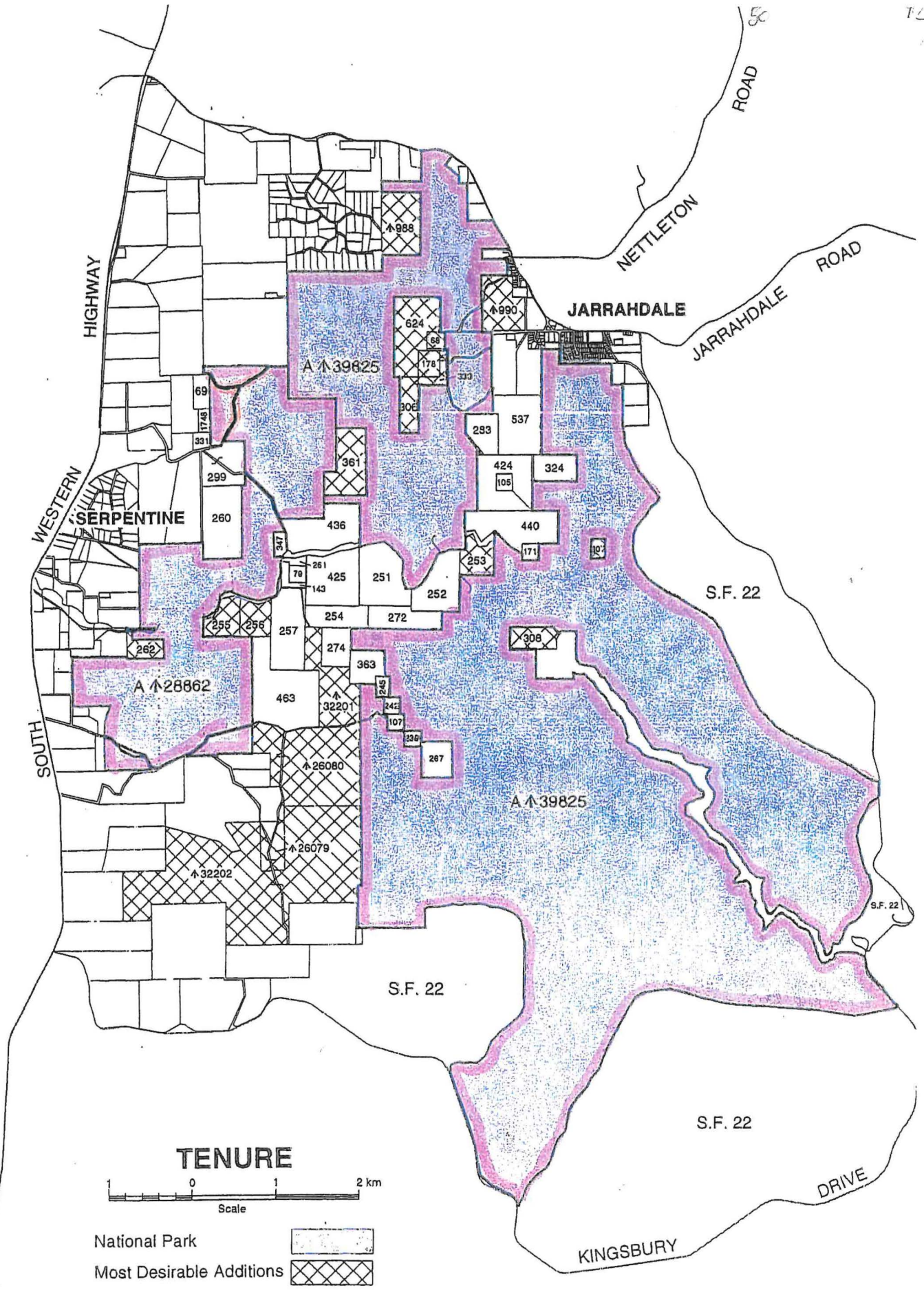



*Serpentine National Park (CA 28862)*  
*closed road to be added to Serpentine National Park.*

Figure 2

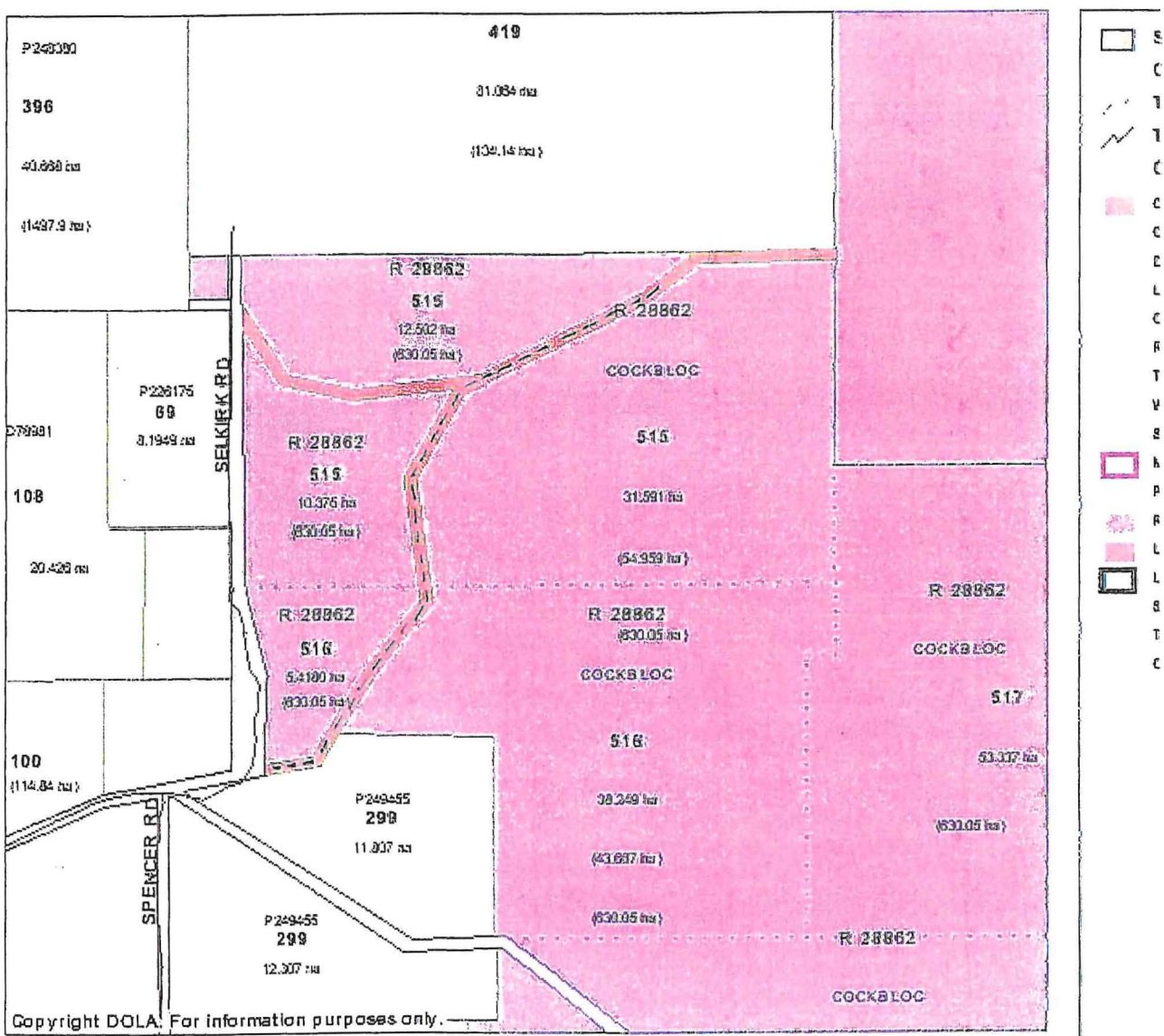
# MAP 2



Scale 1:12853  
 Comment:

-  Serpentine National Park (A#28862)
-  Closed road to be added to Serpentine National Park, that is unconstructed.
-  Closed road to be added to Serpentine National Park, that is constructed (gravel).

Disclaimer

