

NATURE RESERVE

RESERVE NO: 29025

GOVERNMENT GAZETTE
Date Page No.

FILE NUMBER: 248/68

PURPOSE: Conservation of
Flora and Fauna 15.3.68 729

NAME: Lakeland Nature Reserve 20.5.83 1533

CLASS (Land Act):

AREA: 206.9158 ha

VESTING: W.A.W.A. 13.2.70 429

LOCATION NO(S): Roe Loc. 2609

CLASSIFICATION:
(Wildlife Act
Section 12A)

LITHO: 407/80 E1

LOCAL AUTHORITY: LAKE GRACE SHIRE

Notes:

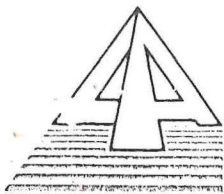

Department of
LAND ADMINISTRATION

Your Ref:

Our Ref: 1900/984 CC:LW

Telephone: 323 1614 C. CARROLL
Enquiries:

NATIONAL PARKS AND NATURE
CONSERVATION AUTHORITY
50 HAYMAN ROAD
COMO WA 6152

Clerk Woodvale

29025

Department of Conserva
and Land Management

5 SEP 1989

COMO, W.A.

DEPARTMENT OF CONSERVATION
AND LAND MANAGEMENT

7 JUN 1989

COMO, W.A.

Sent direct

Dear Sir

I advise for your information that Executive Council has:-

1. Issued an Order in Council revoking the Orders in Council whereby Reserve No's. 27384, 27387, 27452, 27837, 28047, 28313, 28317, 28318, 28319, 28471, 28940, 29012, 29018, 29019, 29020, 29021, 29022, 29023, 29025, 29026, 29027, 29303, 29322, 29326, 29576, 29589, 29680, 29810, 30430, 30469, 30516, 30903, 30969, 31561, 31742, 31743, 31744, 31799, 31908, 31909, 31913, 32129, 32130, 32131, 32549, 32776, 32783, 32864, 32865, 32993, and 32995 were vested in the Western Australian Wildlife Authority in trust for the purpose of "Conservation of Flora and Fauna" and approve the cancellation of the relevant Vesting Orders accordingly.
2. Issued a Proclamation classifying as of Class "A" Reserve No's. 19784, 21424, 23029, 23085, 27384, 27386, 27387, 27452, 27769, 27837, 28047, 28313, 28317, 28318, 28319, 28471, 28669, 28759, 28846, 28940, 29012, 29018, 29019, 29020, 29021, 29022, 29023, 29025, 29026, 29027, 29303, 29322, 29326, 29576, 29589, 29680, 29810, 30430, 30469, 30516, 30903, 30969, 31561, 31742, 31743, 31744, 31799, 31908, 31909, 31913, 32129, 32130, 32131, 32549, 32776, 32783, 32864, 32865, 32993, 32995, 39379, 39404 and 39465 "Conservation of Flora and Fauna".
3. Issued an Order in Council directing that Class "A" Reserve No's. 27384, 27387, 27452, 27837, 28047, 28313, 28317, 28318, 28319, 28471, 28940, 29012, 29018, 29019, 29020, 29021, 29022, 29023, 29025, 29026, 29027, 29303, 29322, 29326, 29576, 29589, 29680, 29810, 30430, 30469, 30516, 30903, 30969, 31561, 31742, 31743, 31744, 31799, 31908, 31909, 31913, 32129, 32130, 32131, 32549, 32776, 32783, 32864, 32865, 32993, and 32995 shall vest in and be held by the National Parks and Nature Conservation Authority in trust for the purpose of "Conservation of Flora and Fauna".

../2.

Notice to this effect was published in the Government Gazette of May 5, 1989 and I enclose the relevant Vesting Orders.

Would you please return to this Office the superseded Vesting Orders for cancellation.

Yours faithfully

Clavell
Jr P. COYNE
MANAGER
PROPERTY MANAGEMENT BRANCH
LAND OPERATIONS DIVISION

June 2, 1989

Enc.

PM151LW1

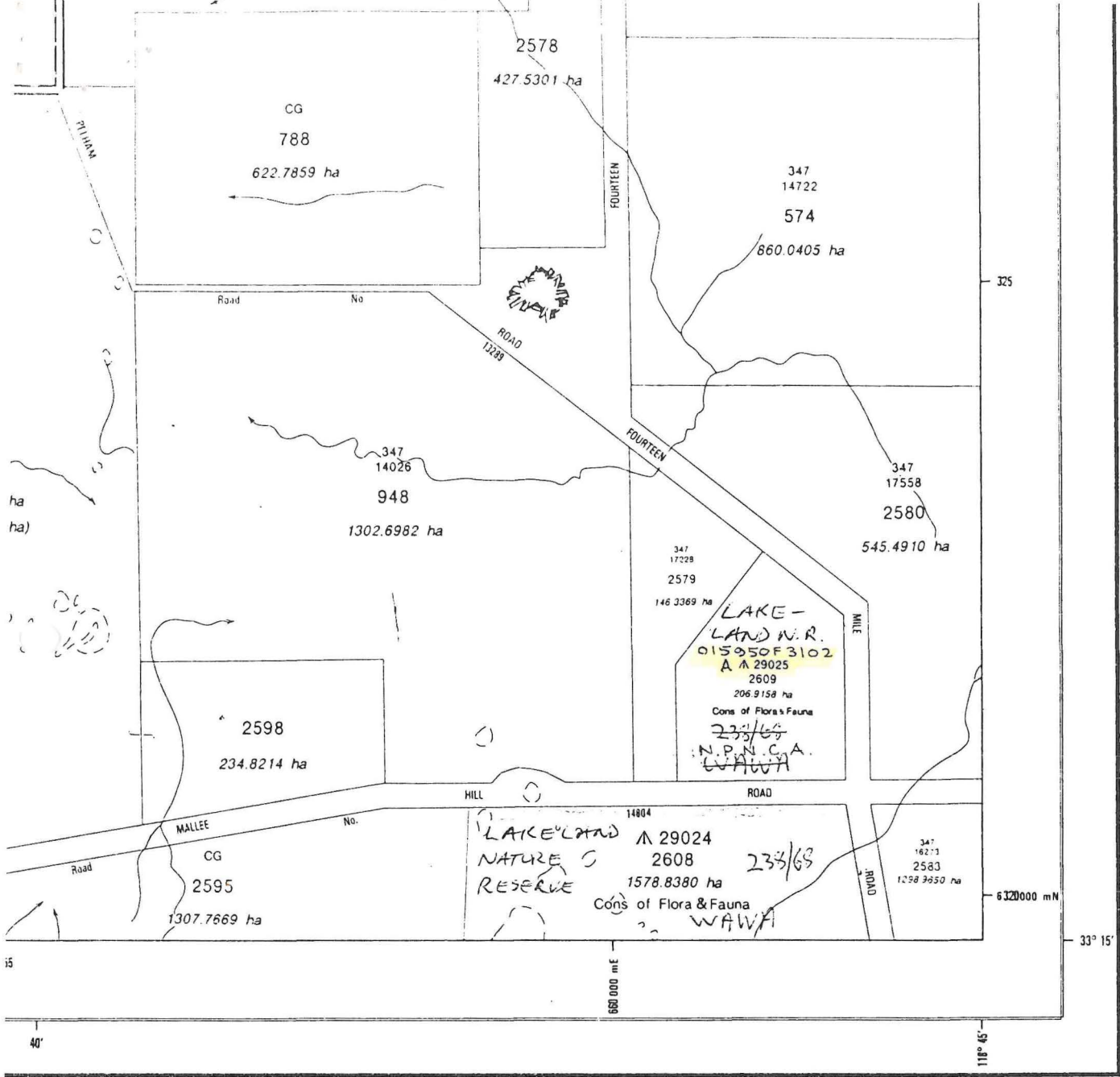

NOTE: The representation on this map of any road or track is not necessarily evidence of public right of way.

BURNGUP

1:50,000

SHEET 2631-IV

INDEX TO ADJOINING SHEETS

2532	2632
II Maubaring	III Pingaring II Eclipse Lake
I Lake Grace	IV Burngup I Lake Biddy
2531	2631
II Lake Dorothy	III Minelup II Lake Bryde

- Subdivided Location Boundary..... - - - - -
- Grouped Location or Lot Boundaries..... ······
- Surveyed Road..... = = = = =
- Unsurveyed Road..... - - - - -
- Transmission Line..... - · - · - · - · - · - · - · - ·
- Railway, Station, Siding..... ————|———|———|———|———|———
- Bridge..... ————|———|———|———|———|———
- Pastoral Lease Boundary (Unsurveyed)..... - · - · - · - · - · - · - · - ·
- Name, unsurveyed and undedicated constructed road..... ————|———|———|———|———|———
- Trigonometrical Station..... ▲

