

NATURE RESERVE

RESERVE NO: 29806

GOVERNMENT GAZETTE
Date Page No.

FILE NUMBER: 1235/76

PURPOSE: Conservation of
Flora and Fauna 23.12.77 4694

NAME:

CLASS (Land Act):

AREA: 2891.8229 ha 6.9.74 3355

VESTING: W.A.W.A. 23.12.77 4677

LOCATION NO(S): Vic. 10902

CLASSIFICATION:
(Wildlife Act
Section 12A)

LITHO: 94/80 C,D3 Eneabba 1:50 000

LOCAL AUTHORITY: CARNAMAH SHIRE

Notes:

NAMING OF RESERVES

Department of Land Administration,
Perth, 18 December 1987.

Corres. No. 3583/981.

IT is hereby notified for general information that the Reserves listed in the Schedule hereunder by this notice named in accordance with the said Schedule.

Schedule

Reserve No.; Name; Public Plan.

- 24257 and 26756; Bampanup Nature Reserve; Gingin SE 1:25 000.
31241; Yeal Nature Reserve; Gingin SW 1:25 000.
A983; Lake Wannamal Nature Reserve; Wannamal NW, SW 1:25 000.
30618; South Mimegarra Nature Reserve; Yatheroo Walvengarra 1:50 000.
7504; Karakin Nature Reserve; Lancelin NE 1:25 000.
29538; Chittering Lakes Nature Reserves; Chittering SW 1:25 000. Bindoon 02, 27.07, 27.08.
4070; Barracca Nature Reserve; Jumperkine NW 1:25 000.
37060; Chandala Nature Reserve; Muchea NE, Gingin SE 1:25 000.
23201; Wyening Nature Reserve; Mortlock River SW 1:25 000.
20738; Koodjee Nature Reserve; 50/80 C, D3, 4.
7615; Sevenmile Well Nature Reserve; Wannamal NE 1:25 000.
26841; Moganmoganing Nature Reserve; Calligrin W, SW; Wannamal NE 1:25 000.
17655; Glendale Nature Reserve; Mortlock River SW, Calingri SW 1:25 000.
23316; Namban Nature Reserve; Tanche 1:50 000.
28674; Manaling Nature Reserve; Tanche 1:50 000.
A2736; Martinjinni Nature Reserve; Miling 1:50 000.
7765; Karamarra Nature Reserve; Moora 10 4.3.
A25210; Pinjarrega Nature Reserve; 90/80 B1 and 2.
24618; Capamauro Nature Reserve; 90/80 BC1, 95/80 BC4.

N. J. SMYTH,
Executive Director.

9091; Cherry Tree Pool Nature Reserve; Woodanilling SW 1:25 000.

9920; Maragoonda Nature Reserve; Woodanilling SW 1:25 000.

17759; Jingalup Nature Reserve; Vannup NW, Kojonup SW 1:25 000.

N. J. SMYTH,
Executive Director.

NAMING OF RESERVES

Department of Land Administration,
Perth, 18 December 1987.

Corres. No. 3583/981.

IT is hereby notified for general information that the Reserves listed in the Schedule hereunder by this notice named in accordance with the said Schedule.

Schedule

Reserve No.; Name; Public Plan

- 17760; South Jingalup Nature Reserve; Uannup NW, Lake Clabburn NE 1:25 000.
27769; Birdwood Nature Reserve; Boscabel SE 1:25 000.
A9307; Mongelup Nature Reserve; Uannup SW 1:25 000.
A16031; Cootayerup Nature Reserve; 438C/40F4.
A16568; Wandoorra Nature Reserve; 437D/40A4.
9308 and 24677; Yellerup Nature Reserve; 437d/40A4, Uannup SW 1:25 000.

N. J. SMYTH,
Executive Director.

PARKS AND RESERVES ACT 1895

Revocation of Appointment

Department of Land Administration,
Perth, 18 December 1987.

File 1073/969V2.

HIS Excellency the Governor, by and with the advice and consent of the Executive Council hereby revokes under the provisions of the Parks and Reserves Act 1895 the appointment of the National Parks Board of Western Australia as a Board to control and manage Class "A" Reserve No. 32376 (Sussex Location 4608) "National Park".

N. J. SMYTH,
Executive Director.

NAMING OF RESERVES

Department of Land Administration,
Perth, 18 December 1987.

Corres. No. 3583/981.

IT is hereby notified for general information that the Reserves listed in the Schedule hereunder by this notice named in accordance with the said Schedule.

Schedule

Reserve No.; Name; Public Plan.

- 23602; Gunyidi Nature Reserve; 90/80 CD4.
29073; Lake Logue Nature Reserve; Beagle Is. and Logue 1:50 000.
29806; Wotto Nature Reserve; Encabba 1:50 000.
16144; Capel Nature Reserve; Capel NW 1:25 000.
A25446; Powlalup Nature Reserve; Balingup NE 1:25 000.
27080; Broadwater Nature Reserve; Broadwater SOB 5D, 6D, 33.
A31634; Sugar Loaf Rock Nature Reserve; Yallingup NW 1:25 000.
20258; Walburra Nature Reserve; Cowaramup NW, Pt Mentellene 1:25 000.
A31188; Sabina Nature Reserve; Busselton 10, 6.8.
23321; Fish Road Nature Reserve; Busselton SE 1:25 000.
37010; Haag Nature Reserve; Yallingup SE 1:25 000.
30626; Gingilup Swamps Nature Reserve; White Point NE, Lake Jasper NW 1:25 000.
32142; Wilgarup Nature Reserve; 439C/40.
A30217; Redhill Nature Reserve; Dinninup NE, Qualeup NW 1:25 000.
18239; Kulikup Nature Reserve; Kulikup Townsite.
8167; Narlingup Nature Reserve; Qualeup NE 1:25 000.
15388; Mettabinup Nature Reserve; Qualeup SW, Lake Clabburn NW 1:25 000.

BODDINGTON TOWNSITE

Amendment of Boundaries

Department of Land Administration,
Perth, 18 December 1987.

File No. 3330/11.

HIS Excellency the Governor in Executive Council has been pleased to approve, under section 10 of the Land Act 1933 of the amendment of the boundaries of Boddington Townsite to include the area described in the Schedule hereunder.

Schedule

All that portion of land bounded by lines starting from the southernmost northeastern corner of Williams Location 15740, as surveyed and shown on Department of Land Administration Original Plan 16453, a point on a present western boundary of Boddington Townsite, and extending northwesterly, northerly and northeasterly along boundaries of that lot to its northernmost southeastern corner, a point on a present western boundary of Boddington Townsite, and thence southerly along that boundary to the starting point.

(Public Plans Boddington Townsite and Marradong NE 1:25 000.)

N. J. SMYTH,
Executive Director.

Records, please file + return to Clarks clerk.

30-12-87

CLERK WOODVALE

DONE CMB. 26.7.88

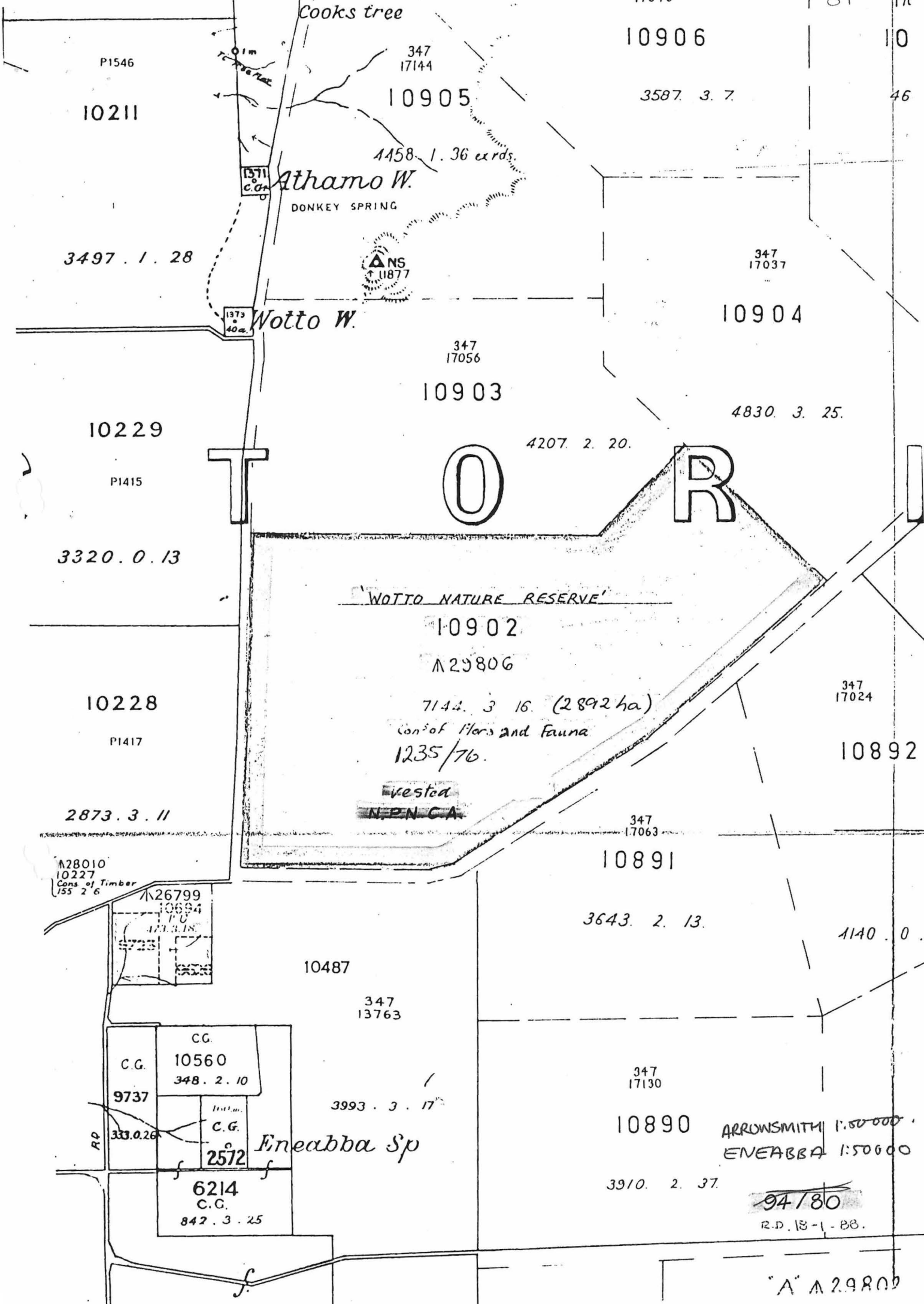

P1546

10211

3497 . 1 . 28

10229

P1415

3320 . 0 . 13

10228

P1417

2873 . 3 . 11

A28010
10227
Cons of Timber
155 2 6

A26799

10694
P.U.
1773.18
15723

CG.
10560
348 . 2 . 10

9737

RD

333.0.26

Dist. C.G.

2572

Eneabba Sp

6214
C.G.

842 . 3 . 25

Cooks tree

347
17144

10905

1458 . 1 . 36 ex rds.

1371
C.G.

Athamo W.

DONKEY SPRING



1373
40 ac.

Wotto W.

347
17056

10903

4207 . 2 . 20.

T O R I

347
17037

10904

4830 . 3 . 25.

WOTTO NATURE RESERVE

10902

A29806

7144 . 3 . 16. (2892 ha)

Cons of Flora and Fauna

1235/76.

vested

N.P.N.C.A.

347
17024

10892

347
17063

10891

3643 . 2 . 13.

1140 . 0 .

10487

347
13763

347
17130

10890

ARROWSMITH 1:50000

ENEABBA 1:50000

3910 . 2 . 37.

94/80

R.D. 13-1-88.

A A29806

17070

10906

3587 . 3 . 7.

81

10

46

3
176