

NATURE RESERVE

RESERVE NO: 30618

GOVERNMENT GAZETTE
Date Page No.

FILE NUMBER: 1247/76

PURPOSE: Conservation of Flora and Fauna
7.11.80 3754

NAME:

CLASS (Land Act):

AREA: 346.0441 ha 16.10.70 3195

VESTING: W.A.W.A. 7.11.80 3736

LOCATION NO(S): Swan Loc. 7810

CLASSIFICATION:
(Wildlife Act
Section 12A)

LITHO: 30/80 D,E1

LOCAL AUTHORITY: GINGIN SHIRE

Notes:

NAMING OF RESERVES

Department of Land Administration,
Perth, 18 December 1987.

Corres. No. 3583/981.

IT is hereby notified for general information that the Reserves listed in the Schedule hereunder by this notice named in accordance with the said Schedule.

Schedule

Reserve No.; Name; Public Plan.

- 24257 and 26756; Bampanup Nature Reserve; Gingin SE 1:25 000.
31241; Yeal Nature Reserve; Gingin SW 1:25 000.
A983; Lake Wannamal Nature Reserve; Wannamal NW, SW 1:25 000.
30618; South Mimegarra Nature Reserve; Yatheroo Walvengarra 1:50 000.
7504; Karakin Nature Reserve; Lancelin NE 1:25 000.
29538; Chittering Lakes Nature Reserves; Chittering SW 1:25 000. Bindoon 02, 27.07, 27.08.
4070; Barracca Nature Reserve; Jumperkine NW 1:25 000.
37060; Chandala Nature Reserve; Muchea NE, Gingin SE 1:25 000.
23201; Wyening Nature Reserve; Mortlock River SW 1:25 000.
20738; Koodjee Nature Reserve; 50/80 C, D3, 4.
7615; Sevenmile Well Nature Reserve; Wannamal NE 1:25 000.
26841; Moganmoganing Nature Reserve; Callingrin W, SW; Wannamal NE 1:25 000.
17655; Glendale Nature Reserve; Mortlock River SW, Calingri SW 1:25 000.
23316; Namban Nature Reserve; Tanche 1:50 000.
28674; Manaling Nature Reserve; Tanche 1:50 000.
A2736; Martinjinni Nature Reserve; Miling 1:50 000.
7765; Karamarra Nature Reserve; Moora 10 4.3.
A25210; Pinjarrega Nature Reserve; 90/80 B1 and 2.
24618; Capamauro Nature Reserve; 90/80 BC1, 95/80 BC4.

N. J. SMYTH,
Executive Director.

NAMING OF RESERVES

Department of Land Administration,
Perth, 18 December 1987.

Corres. No. 3583/981.

IT is hereby notified for general information that the Reserves listed in the Schedule hereunder by this notice named in accordance with the said Schedule.

Schedule

Reserve No.; Name; Public Plan.

- 23602; Gunyidi Nature Reserve; 90/80 CD4.
29073; Lake Logue Nature Reserve; Beagle Is. and Logue 1:50 000.
29806; Wotto Nature Reserve; Eneabba 1:50 000.
16144; Capel Nature Reserve; Capel NW 1:25 000.
A25446; Powlalup Nature Reserve; Balingup NE 1:25 000.
27080; Broadwater Nature Reserve; Broadwater SOB 5D, 6D, 33.
A31634; Sugar Loaf Rock Nature Reserve; Yallingup NW 1:25 000.
20258; Walburra Nature Reserve; Cowaramup NW, Pt Mentellene 1:25 000.
A31188; Sabina Nature Reserve; Busselton 10, 6.8.
23321; Fish Road Nature Reserve; Busselton SE 1:25 000.
37010; Haag Nature Reserve; Yallingup SE 1:25 000.
30626; Gingilup Swamps Nature Reserve; White Point NE, Lake Jasper NW 1:25 000.
32142; Wilgarup Nature Reserve; 439C/40.
A30217; Redhill Nature Reserve; Dinninup NE, Qualeup NW 1:25 000.
18239; Kulikup Nature Reserve; Kulikup Townsite.
8167; Narlingup Nature Reserve; Qualeup NE 1:25 000.
15388; Mettabinup Nature Reserve; Qualeup SW, Lake Clabburn NW 1:25 000.

9091; Cherry Tree Pool Nature Reserve; Woodanilling SW 1:25 000.

9920; Maragoonda Nature Reserve; Woodanilling SW 1:25 000.

17759; Jingalup Nature Reserve; Vannup NW, Kojonup SW 1:25 000.

N. J. SMYTH,
Executive Director.

NAMING OF RESERVES

Department of Land Administration,
Perth, 18 December 1987.

Corres. No. 3583/981.

IT is hereby notified for general information that the Reserves listed in the Schedule hereunder by this notice named in accordance with the said Schedule.

Schedule

Reserve No.; Name; Public Plan

- 17760; South Jingalup Nature Reserve; Uannup NW, Lake Clabburn NE 1:25 000.
27769; Birdwood Nature Reserve; Boscabel SE 1:25 000.
A9307; Mongelup Nature Reserve; Uannup SW 1:25 000.
A16031; Cootayerup Nature Reserve; 438C/40F4.
A16568; Wandoora Nature Reserve; 437D/40A4.
9308 and 24677; Yellerup Nature Reserve; 437d/40A4, Uannup SW 1:25 000.

N. J. SMYTH,
Executive Director.

PARKS AND RESERVES ACT 1895

Revocation of Appointment

Department of Land Administration,
Perth, 18 December 1987.

File 1073/969V2.

HIS Excellency the Governor, by and with the advice and consent of the Executive Council hereby revokes under the provisions of the Parks and Reserves Act 1895 the appointment of the National Parks Board of Western Australia as a Board to control and manage Class "A" Reserve No. 32376 (Sussex Location 4608) "National Park".

N. J. SMYTH,
Executive Director.

BODDINGTON TOWNSITE

Amendment of Boundaries

Department of Land Administration,
Perth, 18 December 1987.

File No. 3330/11.

HIS Excellency the Governor in Executive Council has been pleased to approve, under section 10 of the Land Act 1933 of the amendment of the boundaries of Boddington Townsite to include the area described in the Schedule hereunder.

Schedule

All that portion of land bounded by lines starting from the southernmost northeastern corner of Williams Location 15740, as surveyed and shown on Department of Land Administration Original Plan 16453, a point on a present western boundary of Boddington Townsite, and extending northwesterly, northerly and northeasterly along boundaries of that lot to its northernmost southeastern corner, a point on a present western boundary of Boddington Townsite, and thence southerly along that boundary to the starting point.

(Public Plans Boddington Townsite and Marradong NE 1:25 000.)

N. J. SMYTH,
Executive Director.

Records, please file + return to ~~lands clerk~~ CLERK WOODDUALLE

018738F 3102

AB
S

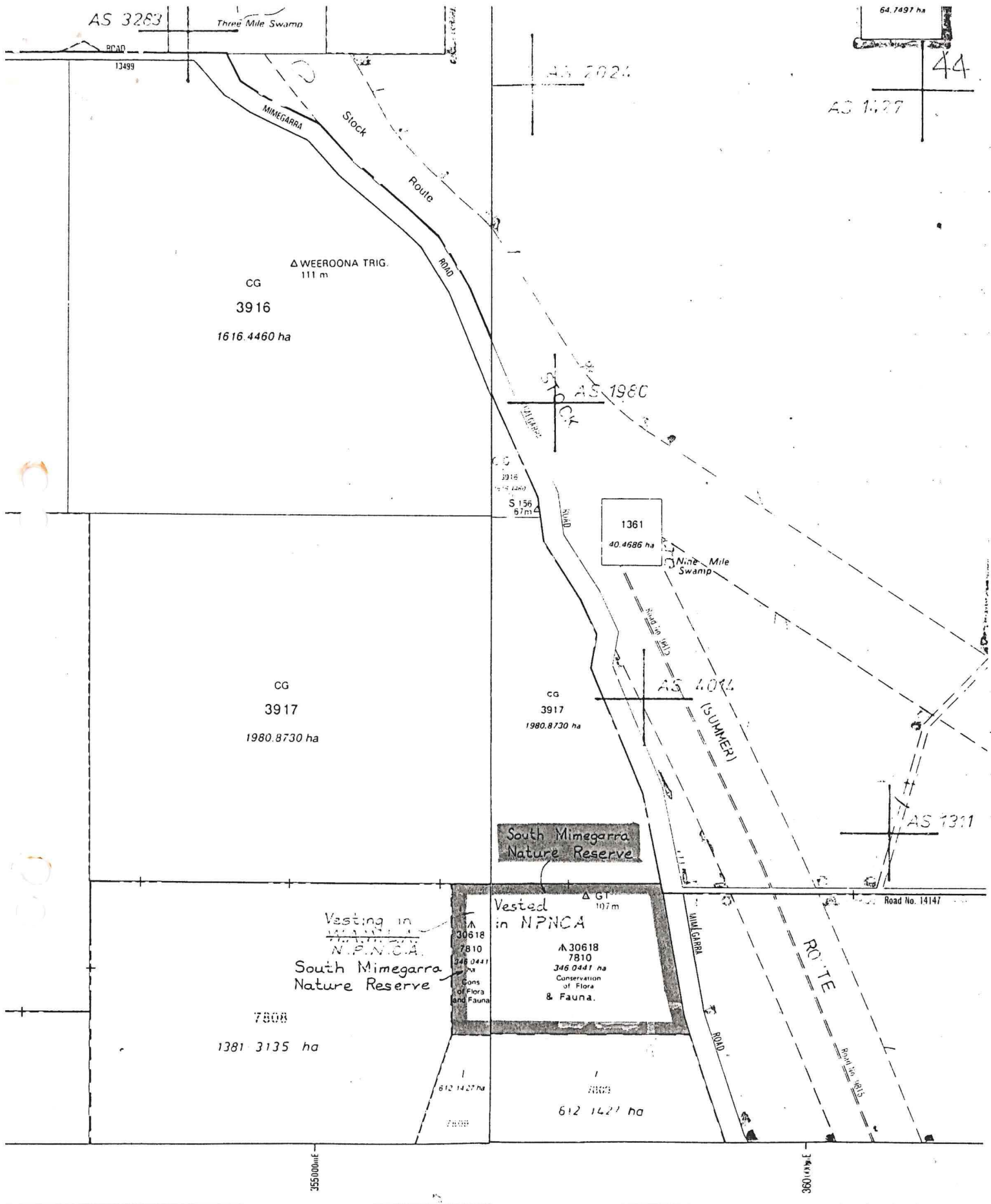

WALYENGARRA

11TH WEST LAND DIVISION
11TH WEST MINERAL FIELD

SHEET 1936-II

WALYENGARRA & YATHEROO

1:50000

R.D. 28-1-88

YATHEROO