

**RESERVE GAZETTAL ACTION SHEET
FOR REGIONS AND DISTRICTS**

LANDS CLERK: Attach a copy of map and forward to the following:

1. REGIONAL MANAGER:
CENTRAL FOREST, GREENOUGH, GOLDFIELDS, KIMBERLEY, SWAN REGION, PILBARA,
SOUTH COAST, SOUTHERN FOREST, WHEATBELT
2. DISTRICT MANAGER: Perth
3. CLERK, WOODVALE ✓
4. O.I.C. INVENTORY BUNBURY / KELMSCOTT / MANJIMUP ✓
5. DISTRICT WILDLIFE OFFICER: Conno

REASON FOR GAZETTAL:

Naming of Cullen Nature Reserve.

RESERVE DETAILS	
RESERVE NUMBER:	<u>31192</u>
CALM FILE NUMBER:	<u>023097F3102</u>
MAP REFERENCE:	<u>Mt. Observation 1:25,000</u>
SHIRE:	<u>York</u>

CHANGES MADE AT GIVEN GAZETTAL DATE	
NAME OF RESERVE:	<u>Cullen Nature Reserve</u>
PURPOSE:	<u>Conservation of Flora & Fauna.</u>
CLASS:	<u>"A"</u>
AREA:	<u>0.90ha</u>
VESTING:	<u>NPWCA</u>
DATE AND PAGE NO. OF CURRENT GAZETTAL:	<u>5/5/92 1897</u>

LANDS CLERK

DATE

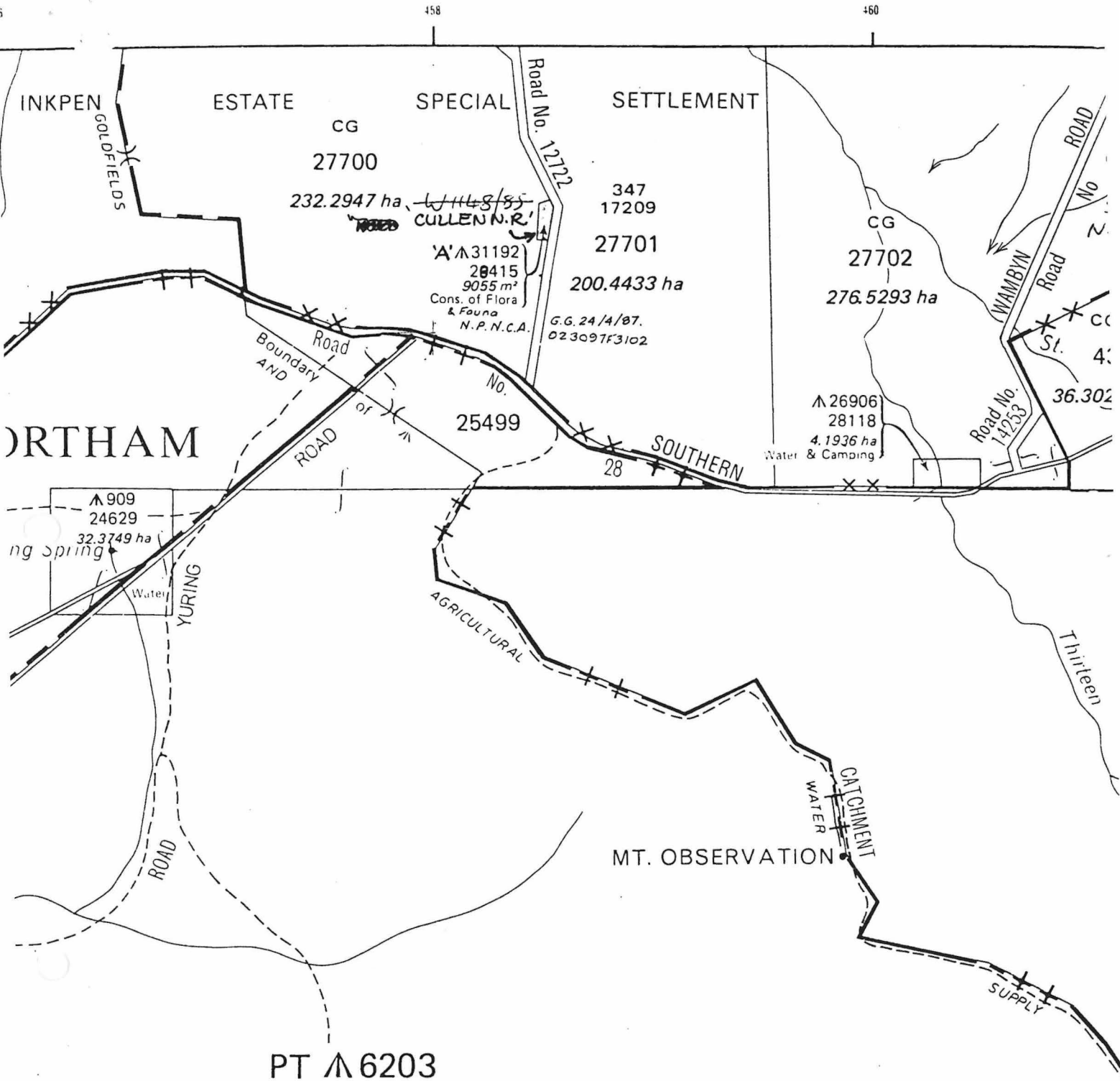

PT Δ 6203
 (abt. 90 741 ha.)

Reservoir Aqueducts Water Courses And Catchment Areas

FIELDS AND AGRICULTURAL WATER-SUPPLY
 BOUNDARIES WEIR CATCHMENT AREA

SHIRE

OF

YO

HELENA

MOUNT OBSERVATION
 S.W. 1:25000