

CONSERVATION ESTATE OFFICER
LAND ADMINISTRATION SECTION
PARK POLICY AND TOURISM BRANCH

A Reserve 31302 within MIDWEST / MOORA Region/District, was
~~created~~/amended, effective from 15 FEBRUARY 2006

- A copy of the customer advice can be found at folio 3.

The ~~addition~~ / excision / ~~amendment~~ is shown on the associated Deposited
Plan / ~~Diagram~~ which is listed below:

Deposited Plan 92280 lot / location 301 folio 2

Other relevant deposited plans / diagrams:

_____ lot / location _____ folio _____

- A locality plan with the ~~addition~~-/ excision / ~~amendment~~ shown highlighted can be found at folio 1.
- Copies of other relevant notifications pertinent to this reserve action have been placed at folios 4.

Would you please advise the relevant offices of this amendment through your Reserve Action Sheet.

Recommended IUCN classification II (no change)



Program Leader
Tenure Group, GIS
Information Management Branch

1.2.07



Customer Advices for Reserve Actions
1/05/2006 - 31/05/2006

Shire of Dandaragan 1/05/2006 - 31/05/2006

Reserve No.	Land Description	DOLA File No.	Volume/Folio	Action	Document No.	Registered	Street Name	Area	Public Plans
24522	Lot 3953 on Deposited Plan 240371 Lot 4048 on Deposited Plan 240371 Lot 4056 on Deposited Plan 240371 Lot 4126 on Deposited Plan 240371 Lot 4127 on Deposited Plan 240371 Lot 4145 on Deposited Plan 240371	02208-1955-03RO	3119-487 3119-488 3119-489 3119-490 3119-491 3119-492	Amendment of Reserve to To include Lot 615 on Deposited Plan 43663 increasing the area by 37.8517 hectares.	J614787	07/02/2006		18356.3821 Ha	
31302	Lot 11094 on Deposited Plan 92218.	02839-1994-01RO	3074-898	Amendment of Reserve to To exclude the land comprised in Lot 301 on Deposited Plan 92280 and its area being reduced by 2500 square metres to 2680.6377 hectares accordingly.	J624929	15/02/2006	Jurien Road	2680.3877 Ha	
31884	Lot 680 on Deposited Plan 215841	02444-1983-01RO	0000-000	Amendment of Reserve to To now comprise Lot 3001 on Deposited Plan 48919 . Its area being reduced to 37.5802 hectares	J616435	08/02/2006	Bashford Street	37.5802 Ha	DP 48919
35819	Lot 615 on Deposited Plan 43663.	03940-1977-01RO	3035-916	Reserve Cancellation ""	J724259	02/05/2006		37.8517 Ha	
38590	Lot 681 on Deposited Plan 215841	02444-1983-01RO	3005-254	Amendment of Reserve to To now comprise Lot 3000 on Deposited Plan 48919. Its area being reduced to 48.4190 hectares.	J616434	08/02/2006	Airstrip Road	48.419 Ha	DP 48919
43786	Lot 301 on Deposited Plan 92280	02839-1994-01RO	0000-000	Reserve Creation for the designated purpose of "Conservation and Trigonometrical Station".	J624930	15/02/2006	East of Cockleshell Gully Road	2500 sqm	Deposited Plan 92280
48490	Lot 3002 on Deposited Plan 48919	02444-1983-01RO	0000-000	Reserve Creation for the designated purpose of "Museum".	J616436	08/02/2006	Bashford Street, Jurien	3199 sqm	DP 48919
48491	Lot 3003 on Deposited Plan 48919	02444-1983-01RO	0000-000	Reserve Creation for the designated purpose of "Senior Citizens Centre".	J616437	08/02/2006	Bashford Street, Jurien	4800 sqm	DP 48919
48491	Lot 3003 on Deposited Plan 48919	02444-1983-01RO	0000-000 0000-000	Management Order to Shire of Dandaragan, PO Box 392 Jurien Bay WA Management Order to the Shire of Dandaragan with Power to Lease for any term not exceeding 21 years subject to the consent of the Minister for Planning and Infrastructure. for the designated purpose of "Senior Citizens Centre"	J616441	08/02/2006	Bashford Street, Jurien	4800 sqm	DP 48919
48492	Lot 3004 on Deposited Plan 48919	02444-1983-01RO	0000-000	Reserve Creation for the designated purpose of "Communication Site".	J616438	08/02/2006	Bashford Street, Jurien	2036 sqm	DP 48919

• TENS d base amended
• white plan amended
• graphics amended
G.H 8/16

• TENS d base amended
• white plan "
• graphics not amended
G.H 8/16

• TENS d base amended
• white plan "
• no graphics
G.H 8/16

↑ 43786: Lat: -30.202268
Long: 115.098363
Pin# 11558924

Report Name: Gazettal History

Query Criteria

Crown Reserve No. = 31302

Special Comments

Crown Reserve **31302**Class: **A**Name: **Drovers Cave National Park**

Name Approval: Gazetted

Tenure: National Park Area: 2,680.4 ha

Purpose: National Park

Vesting: Conservation Commission

<u>Date</u>	<u>Gazettal Action</u>	<u>Description</u>
5-Feb-2006	Area Excision	Lot 301 On Dp 92280 (-0.25 ha) - An Update from DOLA is pending.
16-Nov-2000	Comment	Conservation Commission Established Due To CALM Amendment Act 2000 (No 35 of 2000). Supersedes LFC And NPNCA.
03-Feb-1978	Class	A
03-Feb-1978	Vesting	National Parks Authority Of W A
03-Feb-1978	Vesting Revoked	
09-Mar-1973	Name	Drovers Cave National Park
19-May-1972	Area	6624.0.0
19-May-1972	Board	
19-May-1972	DOLA File	145/56
19-May-1972	Location	Victoria, 11094
19-May-1972	Public Plan	Green Head & Lesueur; Boullanger & Hill River 1:50000
19-May-1972	Purpose	National Park
19-May-1972	Street	Sandy Point Rd
19-May-1972	Vesting	National Parks Board Of W A W P L 21Yrs
	?	Abt 2680.6377, P84
	Vesting	National Parks Authority Act 19 - 1976
19-May-1972	Original Gazettal	

Crown Reserve **43786**Class: **C**

Name:

Name Approval: Un-Named

Tenure: 5(1)(h) Reserve Area: 0.3 ha

Purpose: Conservation And Trigonometrical Station

Vesting: Conservation Commission Of W A

<u>Date</u>	<u>Gazettal Action</u>	<u>Description</u>
21-Apr-2006	Vesting	Conservation Commission Of W A - An Update from DOLA is pending.
15-Feb-2006	Class	C - An Update from DOLA is pending.
15-Feb-2006	Purpose	Conservation And Trigonometrical Station - An Update from DOLA is pending.
15-Feb-2006	Vesting	Conservation Commission Of W A - An Update from DOLA is pending.
15-Feb-2006	Original Gazettal	Lot 301 On Dp 92280 (0.25 ha) - An Update from DOLA is pending.

Green Head

Drovers
Cave
National
Park
A 31302

Jurien Bay

Lesueur NP
A 42032

101 301
11024
(2660.3877ha)
C 35593

Coomallo NR*
C 41933

C 33287

 Current boundary of A 31302
Area excused from A 31302 (101 301) -
15 February 2006
DEC COG Plan 1937 144 shows amendment.

LEGEND

- REGION BOUNDARY
- DISTRICT BOUNDARY
- REGION HQ
- DISTRICT HQ
- WORK CENTRE

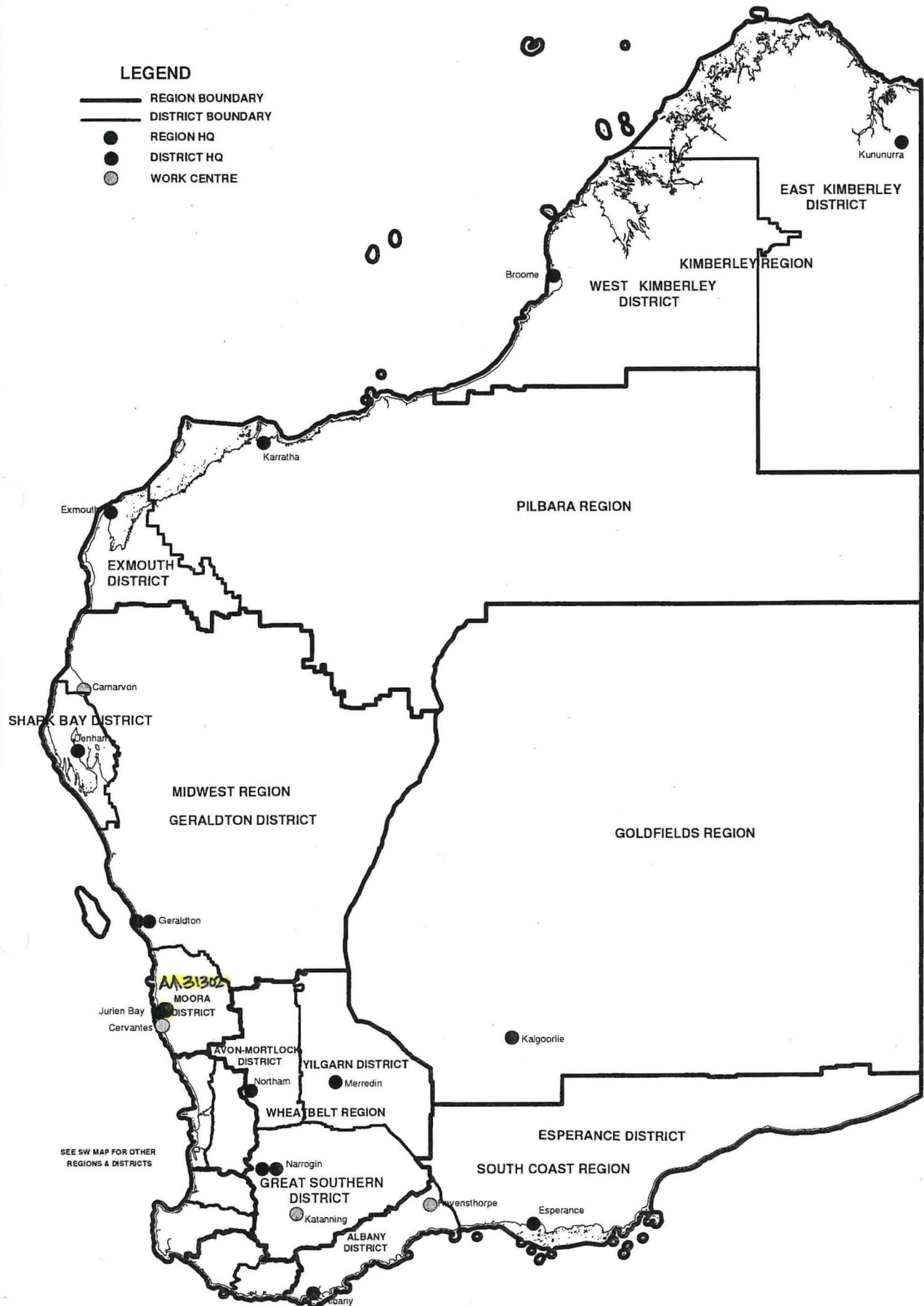

SEE SW MAP FOR OTHER REGIONS & DISTRICTS

**DEPARTMENT OF ENVIRONMENT AND CONSERVATION
REGION AND DISTRICT BOUNDARIES**

JAN 2007

Dimensions shown hereon are SUBJECT TO SURVEY

AA42032
11850
O.P. 17833

AA31302
11094
Reserve Dia: 1236

10598
O.P. 8864

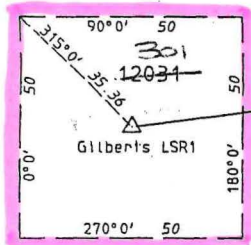

Not 262°28' 10" 1132.17 to 271°12' 3 Scale 181°12'

No. of Scale

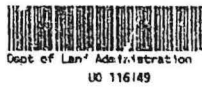

RESERVE No. Area. 2500 m ²		FILE No. 2839/994
Purpose Protection of Trigonometric Station		SCALE 1:1000 All measurements in metres
DISTRICT. VICTORIA	SUBJECT TO SURVEY	
Public Plan LESUEUR & Pt. GREENHEAD 1:50000	AMENDMENTS	
Reference R.D. A.1. Baker A. Page 5	Gazette	Page
Proposed by G. BALDIN Date 1/22/95		Initials
Checked by [Signature] Date 3.2.95		
Approved [Signature] Date 3.2.95		
Manager Statutory Services		
	Gazetted Page	
	Recorded on Public Plan	
	Registered For Manager Statutory Services	
	On Survey Index Plan LESUEUR & Pt. GREENHEAD 1:50000	
	DEPT. OF LAND ADMINISTRATION	
	RESERVE	
	DIAGRAM No 1300	