

NATURE RESERVE

RESERVE NO: #32257

GOVERNMENT GAZETTE  
Date Page No.

FILE NUMBER: 160/70

PURPOSE: Recreation and  
Conservation of Flora and Fauna 5.10.73 3665

NAME: Lake Warden

CLASS (Land Act):

AREA: 709.7000 22.6.79 1701

VESTING: W.A.W.A. 5.10.73 3647

LOCATION NO(S): Lake Warden &  
Esperance Lot Nos. 238 & 239

CLASSIFICATION:  
(Wildlife Act  
Section 12A)

LITHO: 423/80 & Esperance 1:50 000

LOCAL AUTHORITY: ESPERANCE SHIRE

Notes:

## RESERVE ACTION SHEET - CONSERVATION RESERVES

**RESERVE No. 32257 (Lake Warden Nature Reserve)**

**REASON FOR ACTION**

- Addition of Lots 1, 3 & 9 to Lake Warden Nature Reserve, resulting in its area being increased by 1 hectare to 710.7 hectares.
- The addition of these Lots (1, 3 & 9) will aid in the management of the Lake Warden Nature Reserve, helping to protect the conservation values of the area. The additional land is covered in native vegetation including *Nuytsia floribunda* and *Banksia speciosa*
- Date of DOLA's advice: 10 July 2000 See folio: 1 & 2
- Plans at folios: 3-9



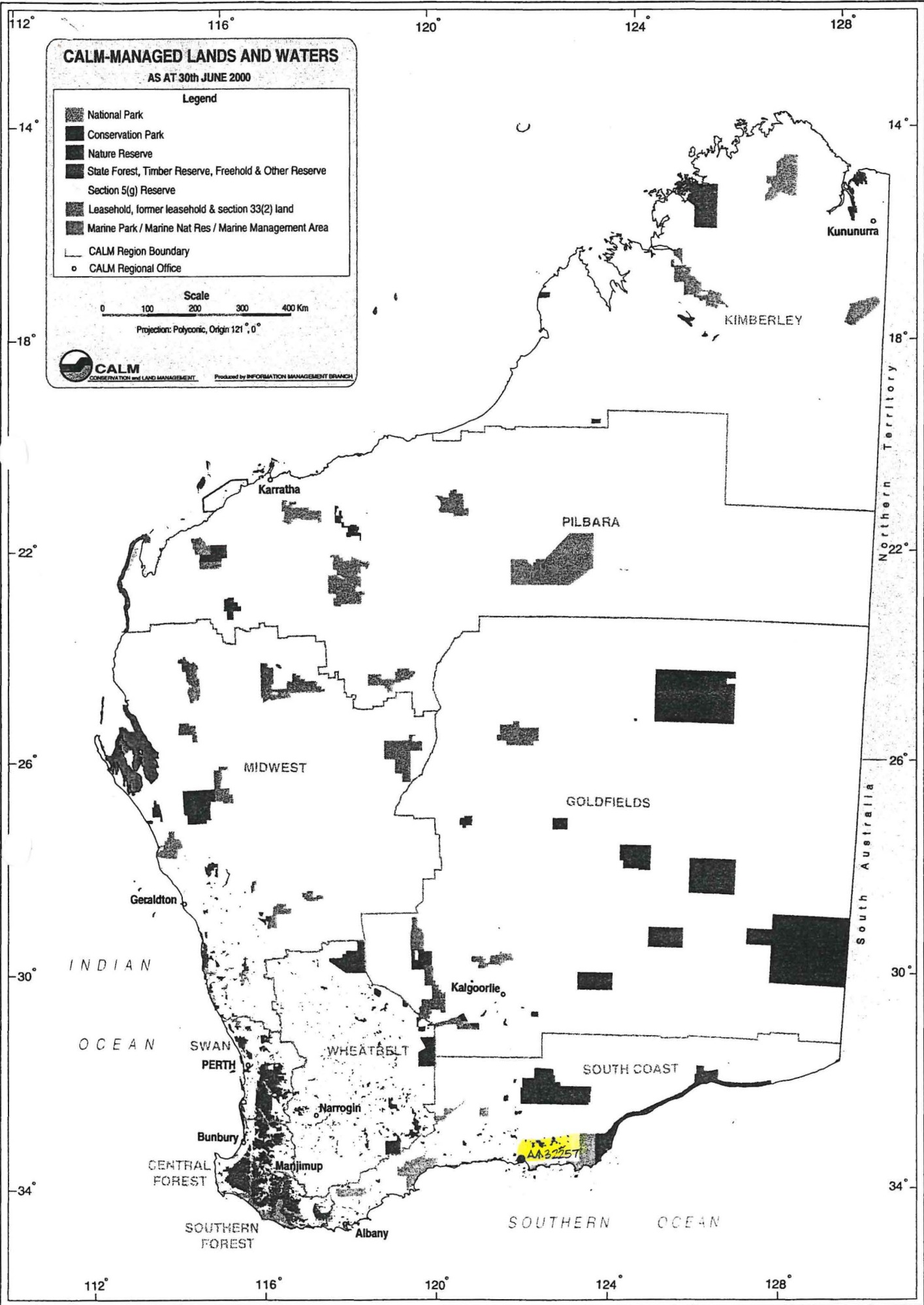





OFFICER	ACTION
<p>1 <b>CONSERVATION ESTATE OFFICER</b></p>	<p>- Fill in above details</p> <p>- Attach copies of DOLA's advice to file</p> <p>Send copies of advice &amp; maps to:</p> <p>- Lisa Wright, Woodvale</p> <p>- Regional Manager, Albany</p> <p>- District Manger, Esperance</p> <p>Rec. IUCN classification: 1a</p> <p>To note:  28/11/00</p>
<p>2 <b>INDEX CLERK, RECORDS</b></p>	<p>Please amend the name of this file to:</p>
<p>3 <b>LAND ACQUISITIONS OFFICER</b></p>	<p>To note:</p>
<p>4 <b>MANAGER, PLANNING &amp; VISITOR SERVICES</b></p>	<p>To note &amp; approve IUCN classification:</p>
<p>5 <b>DIRECTOR, NATURE CONSERVATION/ NATIONAL PARKS</b></p>	<p>To note:</p>
<p>6 <b>PROGRAM LEADER (TENURE)</b></p>	<p>To note &amp; update IUCN records:</p>



**CALM-MANAGED LANDS AND WATERS**

AS AT 30th JUNE 2000

**Legend**

-  National Park
-  Conservation Park
-  Nature Reserve
-  State Forest, Timber Reserve, Freehold & Other Reserve
-  Section 5(g) Reserve
-  Leasehold, former leasehold & section 33(2) land
-  Marine Park / Marine Nat Res / Marine Management Area
-  CALM Region Boundary
-  CALM Regional Office

**Scale**

0 100 200 300 400 Km

Projection: Polyconic, Origin 121°, 0°



CONSERVATION AND LAND MANAGEMENT

Produced by INFORMATION MANAGEMENT BRANCH

INDIAN OCEAN

SOUTHERN OCEAN

Northern Territory

South Australia

KIMBERLEY

PILBARA

MIDWEST

GOLDFIELDS

WHEATBELT

SOUTH COAST

CENTRAL FOREST

SOUTHERN FOREST

Kununurra

Karratha

Geraldton

SWAN PERTH

Kalgoorlie

Narrogin

Bunbury

Manjimup

Albany

AA325T

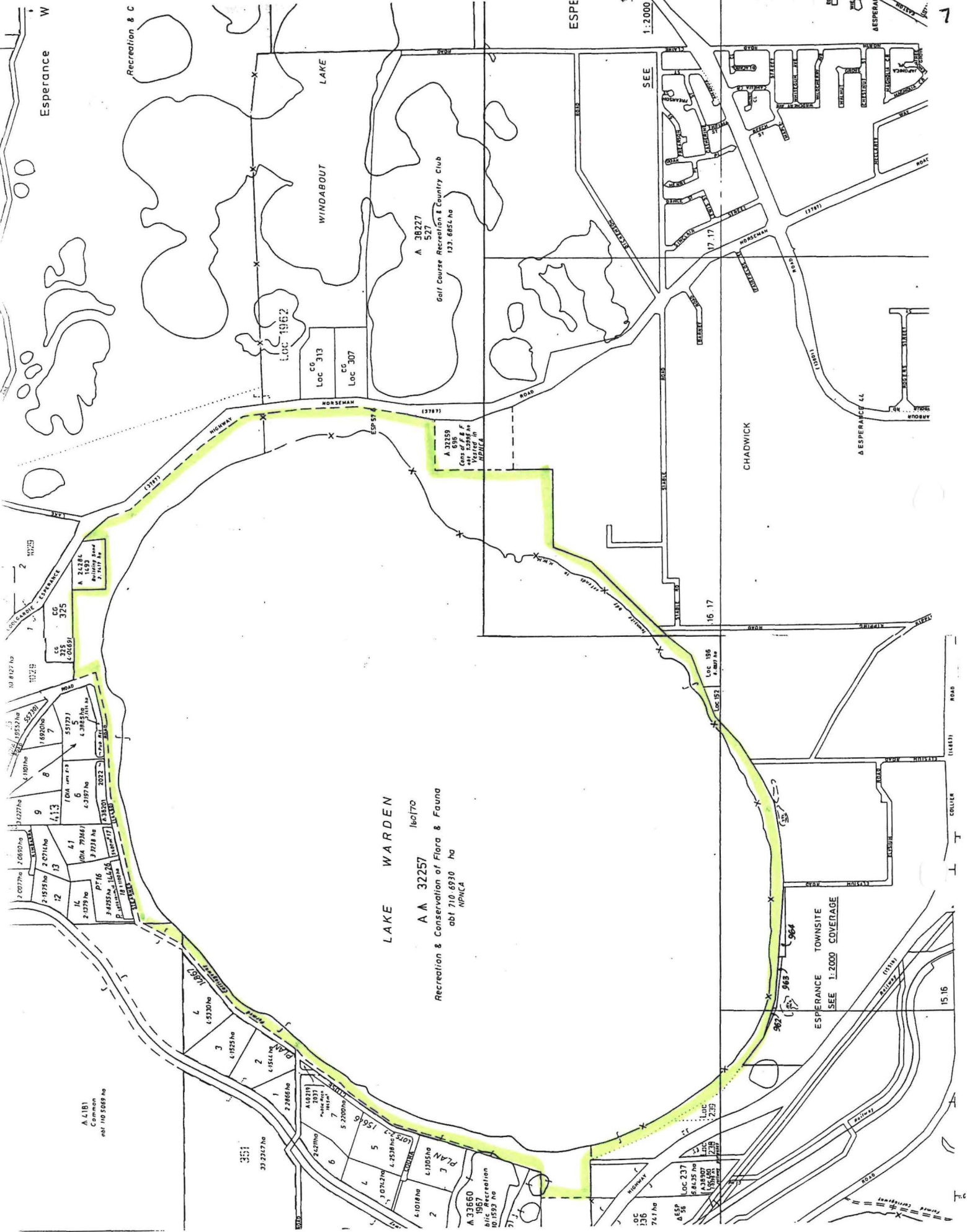

PAGE DOLA PLANS.  
 ESPERANCE ENVIRONS CG29 3.4 & 4.4  
 REDUCED SCALE 1:20 000

**Customer Advices for Reserve Actions  
1/07/2000 - 31/07/2000**

**Shire of Esperance 1/07/2000 - 31/07/2000**

Reserve No.	Land Description	DOLA File No.	Volume/Folio	Action	Document No.	Registered	Street Name	Area	Public Plans
26761	Dalyup Lot 21 on Diagram 68873	00806-1960-01RO	3028-103	Change of Purpose to "Community Purposes"	H507328		Baker Street	2.1827 Ha	CF29(2)39.29
26761		00806-1960-01RO	3028-103	Management Order to Shire of Esperance of PO Box 507, Esperance yes for the designated purpose of "Community Purposes"	H507329		Baker Street	2.1827 Ha	CF29(2)39.29
30544		02094-1969-01RO	3012-483	Revocation of Management Order (Minister for Water Resources) for the designated purpose of "Water Supply Purposes".	H507309		Hammersley Street	4047 sqm	CG29(2)16.13
30544		02094-1969-01RO	3012-483	Management Order to Water Corporation of PO Box 110, Leederville for the designated purpose of "Water Supply Purposes"	H507310		Hammersley Street	4047 sqm	CG29(2)16.13
32257		01646-1958-01RO		Amendment of Reserve to To now comprise of Esperance Location 2148 Crown Land Title Volume 3120 Folio 574 as depicted on Land Administration Reserve Plan 147, Esperance Lot 962 on Office of Titles Diagram 72228, Esperance Lot 963 on Office of Titles Diagram 71776 and Esperance Lot 964 on Office of Titles Diagram 66645. Its area being increased to 710.6930 hectares accordingly.	H500550		Stephens Road	710.693 Ha	Esperance (50)
46228	Esperance Location 2142 on Office of Titles Plan 23554	02230-1999-01RO	3118-691	Reserve Creation for the designated purpose of "Water Supply".	H501460		Eleven Mile Beach Road	385 sqm	Esperance(50)
46228		02230-1999-01RO	3118-691	Management Order to Shire of Esperance of PO Box 507, Esperance for the designated purpose of "Water Supply"	H501461		Eleven Mile Beach Road	385 sqm	Esperance(50)

*lodgement date for 32257 action is 10.7.00 (Advice from Barry Fuller - DOLA)*

*S. Collis 14.8.00*

*C. BATHGATE  
16/8/00*

*THANK YOU*

*FOR PLANS,  
PLEASE*

*GRAHAM  
HENTZE  
GWH 2/9*