

**RESERVE GAZETTAL ACTION SHEET
FOR REGIONS AND DISTRICTS**

LANDS CLERK: Attach a copy of a map and forward to the following:

1. REGIONAL MANAGER:
CENTRAL FOREST, MIDWEST, GOLDFIELDS, KIMBERLEY, SWAN REGION
PILBARA, SOUTH COAST, SOUTHERN FOREST, WHEATBELT
2. DISTRICT MANAGER: Esperance ✓
3. DISTRICT WILDLIFE OFFICER: Esperance ✓
4. CLERK WOODVALE ✓
5. O.I.C. INVENTORY BUNBURY/KELMSCOTT/MANJIMUP

REASON FOR GAZETTAL:

Change in purpose from "Pole Dump (State Electricity Commission)"
to "Conservation of Flora & Fauna" automatically vested in the NPNCA.

RESERVE NUMBER: 32259

CALM FILE NUMBER: 016308F3102

NAME OF RESERVE: _____

PURPOSE: Conservation of Flora & Fauna

CLASS: C

AREA: 7.40ha

VESTING: NPNCA

DATE OF CURRENT GAZETTAL: 5/2/93

MAP REFERENCE: Esperance 16-17 1:20000 & Esperance 4-4 1:10000

SHIRE: Esperance

LANDS CLERK
09 367 0221

9/3/93
DATE

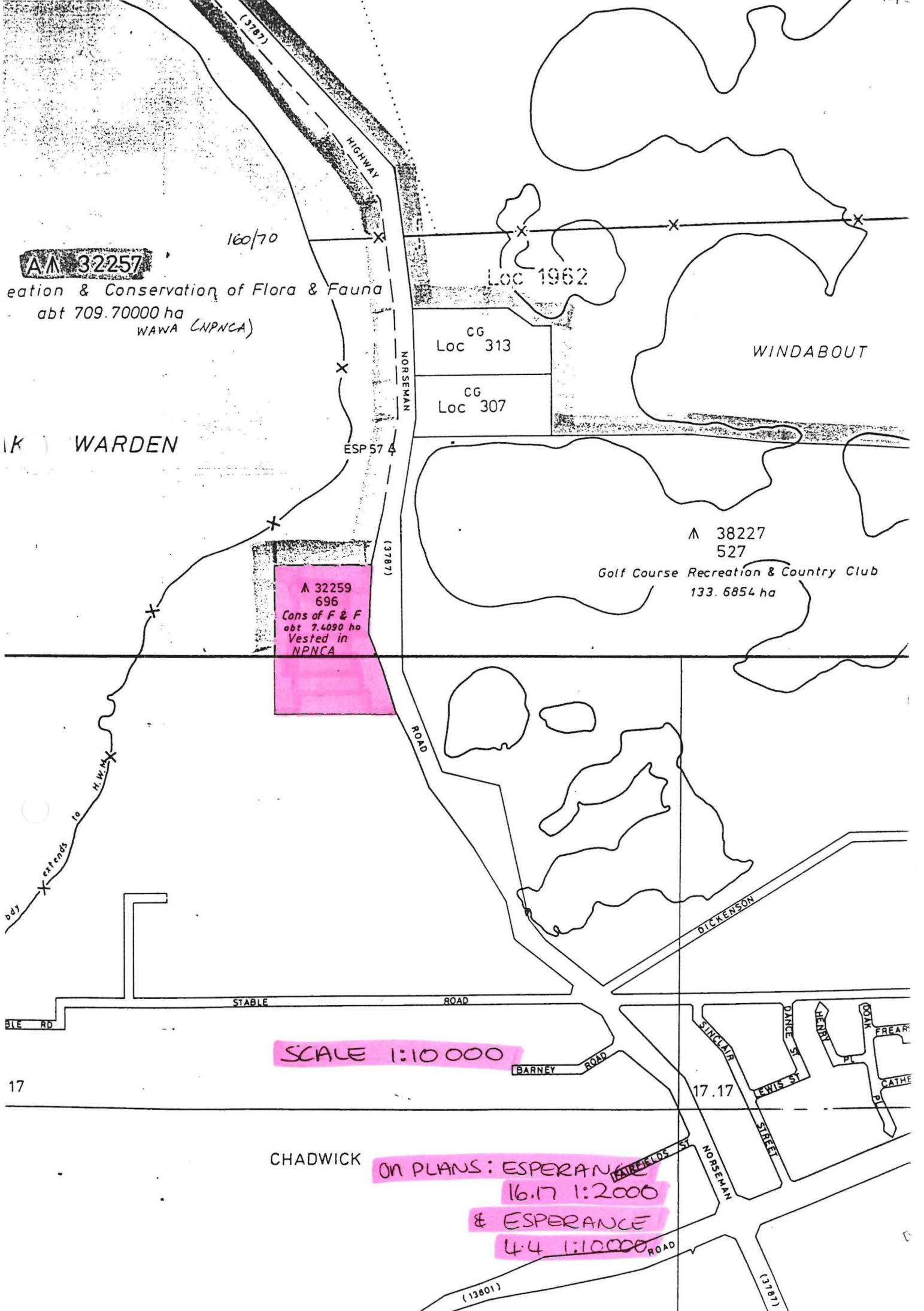

A 32257

Recreation & Conservation of Flora & Fauna
 abt 709.70000 ha
 WAWA (NPNCA)

Loc 1962

CG
 Loc 313

CG
 Loc 307

WINDABOUT

WARDEN

ESP 57

**A 38227
 527**

Golf Course Recreation & Country Club
 133.6854 ha

**A 32259
 696**
 Cons of F & F
 abt 7.4090 ha
 Vested in
 NPNCA

SCALE 1:10 000

17

CHADWICK

**ON PLANS: ESPERANCE
 16.17 1:2000
 & ESPERANCE
 4.4 1:10000**