

RESERVE ACTION SHEET - CONSERVATION RESERVES

RESERVE No. 32478

REASON FOR ACTION

The creation of a 5(1)(h) reserve with a management order issued to the Conservation Commission for the purpose Navigation, Communication, Meteorology, Survey and Conservation'.

Area: 0.36 hectares

Due to increasing use of satellite aided navigation and AMSA'S desire to rationalise it's property holdings the Commonwealth has been divesting properties containing lighthouses and marine navigational aids. Reserve 32478 on Cave Point Island is a former AMSA property which will be leased back to AMSA to permit continued operation of lighthouse facilities.

- Date of DOLA's advice: 23 January 2001 See folio: 18
- Plans at folios: 22,21,20

| OFFICER | ACTION | |
|---------|--|--|
| 1 | CONSERVATION ESTATE OFFICER | <ul style="list-style-type: none"> - Fill in above details - Attach copies of DOLA's advice to file Send copies of advice & maps to: <ul style="list-style-type: none"> - Lisa Wright, Woodvale - District Manager, Albany - Regional Manager, Albany Recommended IUCN classification: |
| | | <div style="text-align: right;"> <hr style="border: none; border-top: 1px solid black; margin-bottom: 5px;"/> <hr style="border: none; border-top: 1px solid black; margin-bottom: 5px;"/> <hr style="border: none; border-top: 1px solid black; margin-bottom: 5px;"/> <hr style="border: none; border-top: 1px solid black; margin-bottom: 5px;"/> <hr style="border: none; border-top: 1px solid black; margin-bottom: 5px;"/> </div> |
| 2 | LAND ACQUISITIONS OFFICER | To note: |
| | | <div style="text-align: right;"> <hr style="border: none; border-top: 1px solid black; margin-bottom: 5px;"/> </div> |
| 3 | MANAGER, PLANNING & VISITOR SERVICES | To note & approve IUCN classification: |
| | | <div style="text-align: right;"> <hr style="border: none; border-top: 1px solid black; margin-bottom: 5px;"/> </div> |
| 4 | DIRECTOR, NATURE CONSERVATION/ NATIONAL PARKS | To note: |
| | | <div style="text-align: right;"> <hr style="border: none; border-top: 1px solid black; margin-bottom: 5px;"/> </div> |
| 5 | INDEX CLERK, RECORDS | To note: |
| | | <div style="text-align: right;"> <hr style="border: none; border-top: 1px solid black; margin-bottom: 5px;"/> </div> |
| 6 | CONSERVATION ESTATE OFFICER | Attach copy of Reserve Details to inside cover of new file |
| | | <div style="text-align: right;"> <hr style="border: none; border-top: 1px solid black; margin-bottom: 5px;"/> </div> |

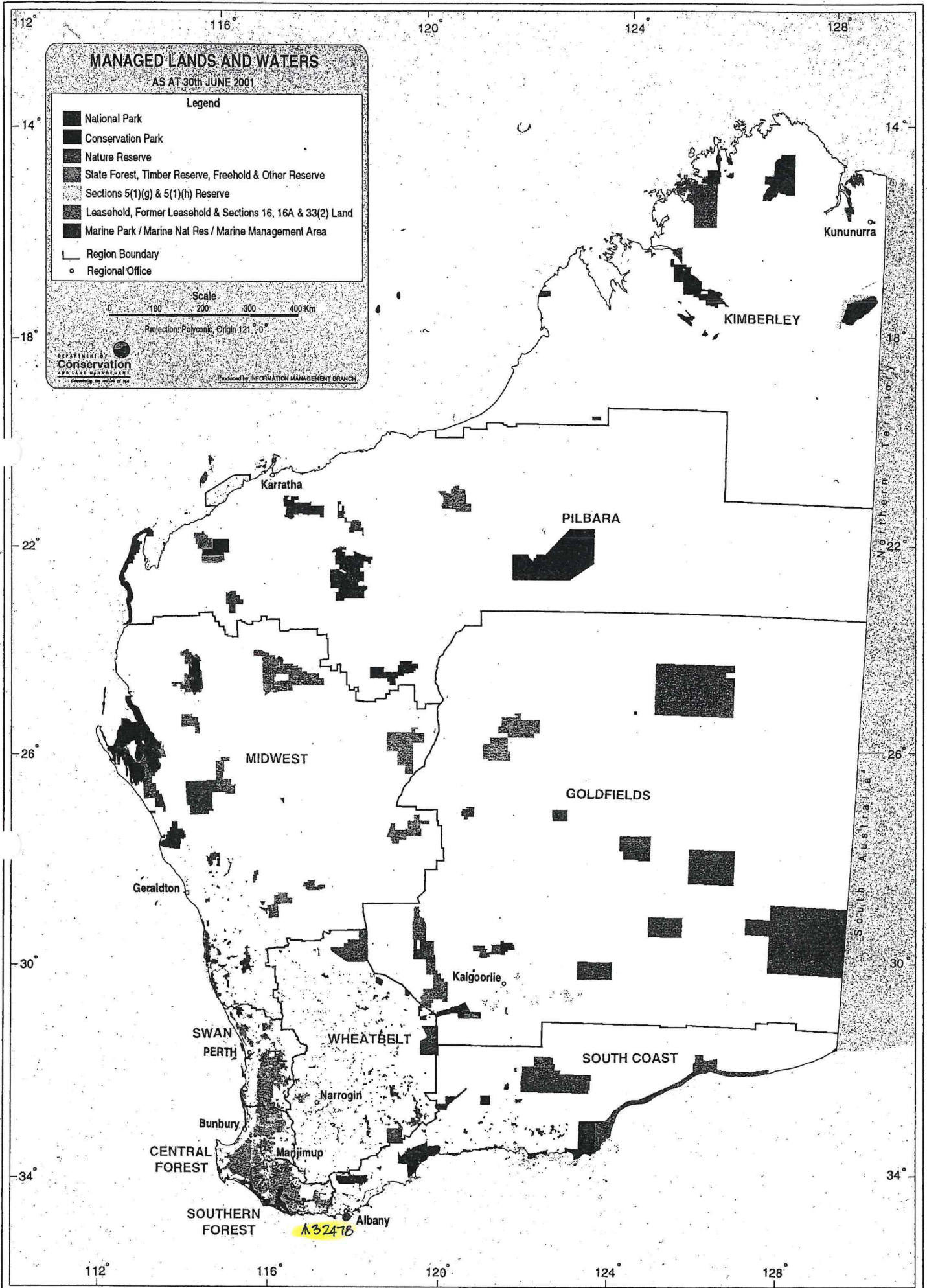

MANAGED LANDS AND WATERS

AS AT 30th JUNE 2001

Legend

- National Park
- Conservation Park
- Nature Reserve
- State Forest, Timber Reserve, Freehold & Other Reserve
- Sections 5(1)(g) & 5(1)(h) Reserve
- Leasehold, Former Leasehold & Sections 16, 16A & 33(2) Land
- Marine Park / Marine Nat Res / Marine Management Area
- Region Boundary
- Regional Office

Scale

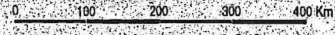

Projection: Polyconic, Origin 121° 0'

DEPARTMENT OF
Conservation
AND LAND MANAGEMENT

Produced by INFORMATION MANAGEMENT BRANCH

Kununurra

KIMBERLEY

PILBARA

MIDWEST

GOLDFIELDS

Geraldton

Kalgoorlie

SWAN
PERTH

WHEATBELT

SOUTH COAST

CENTRAL
FOREST

SOUTHERN
FOREST

Marjiminup

Albany

A 32478

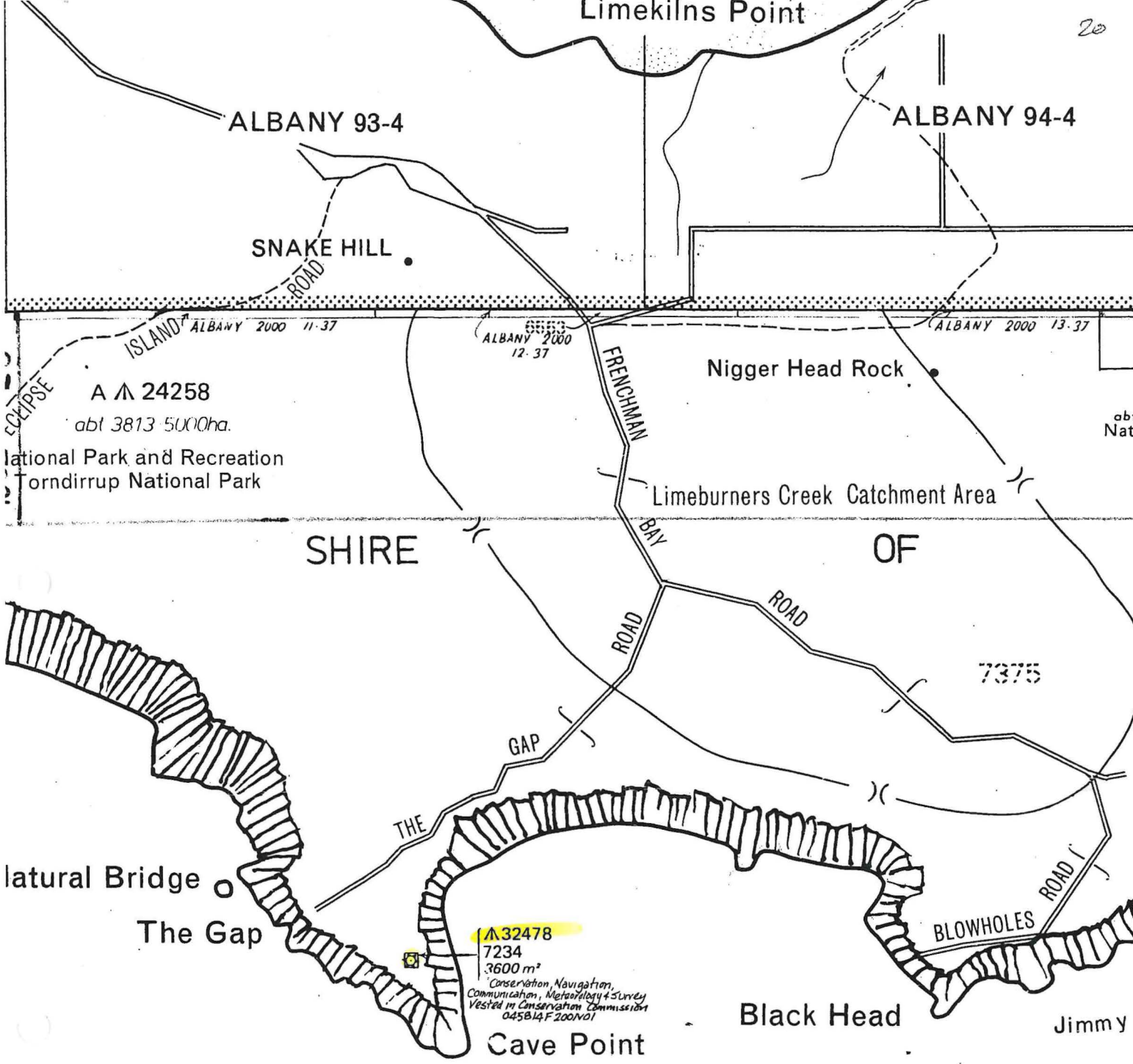

SOUTHERN

ON PART DOLA PLAN
 ALBANY NE & SE (2427-1 NE)
 SCALE 1:25000

ALBANY DIST
LGA.

| | | | | | | | | | |
|-------|--|-----------------|----------|---|---------|------------|--------------------|------------|--|
| 32341 | | 01185-1963-02RO | 3009-347 | Revocation of Management Order (City of Albany of York Street Albany) for the designated purpose of "". | H657138 | 31/01/2001 | Wright Street | 14.2349 Ha | Albany (2) 13.07 |
| 32341 | | 01185-1963-02RO | 3009-347 | Management Order to City of Albany of York Street Albany To be used for "Recreation" only, with power to lease for 21 years for the designated purpose of "" | H657139 | 31/01/2001 | Wright Street | 14.2349 Ha | Albany (2) 13.07 |
| 32478 | | 02161-1972-01RO | 3082-844 | Management Order to Conservation Commission of Western Australia C/- Department of Conservation and Land Management Locked Bag 104 Bentley Delivery Centre COMO W.A 6152 for the designated purpose of "Lighthouse" | H651914 | 23/01/2001 | | 0.36 Ha | Albany NE & SE (25) |
| 32558 | | 00499-1973-01RO | 3082-854 | Revocation of Management Order (City of Albany of York Street Albany) for the designated purpose of "". | H654750 | 30/01/2001 | Lindfield Crescent | 6725 sqm | Albany (2) 12.06 & 12.07 |
| 32558 | | 00499-1973-01RO | 3082-854 | Management Order to City of Albany of York Street Albany To be used for "Recreation" only for the designated purpose of "" | H654751 | 30/01/2001 | Lindfield Crescent | 6725 sqm | Albany (2) 12.06 & 12.07 |
| 33033 | | 02079-1972-01RO | 3009-548 | Revocation of Management Order (City of Albany of York Street Albany) for the designated purpose of "". | H655704 | 30/01/2001 | Brunswick Road | 139 sqm | Albany (2) 11.04 |
| 33033 | | 02079-1972-01RO | 3009-548 | Management Order to City of Albany of York Street Albany To be used for "Drainage" only for the designated purpose of "" | H655705 | 30/01/2001 | Brunswick Road | 139 sqm | Albany (2) 11.04 |
| 33271 | | 00780-1989-01RO | 3082-867 | Revocation of Management Order (City of Albany of York Street Albany) for the designated purpose of "". | H655900 | 30/01/2001 | Howell Road | 23.9406 Ha | Albany NW, Oyster Harbour SW 1:25 000 |
| 33271 | | 00780-1989-01RO | 3082-867 | Management Order to City of Albany of York Street Albany To be used for "Gravel" only for the designated purpose of "" | H655901 | 30/01/2001 | Howell Road | 23.9406 Ha | Albany NW, Oyster Harbour SW 1:25 000 |
| 33308 | | 04381-1974-01RO | 3103-338 | Revocation of Management Order (City of Albany of York Street Albany) for the designated purpose of "". | H656106 | 30/01/2001 | Ledge Beach Road | 403 Ha | Albany (10) 3.1 & 3.2, Albany NE & SE, Oyster Harbour SE(25) |
| 33308 | | 04381-1974-01RO | 3121-749 | Management Order to City of Albany of York Street Albany To be used for "Recreation and Botanical Garden" only for the designated purpose of "" | H656108 | 30/01/2001 | Ledge Beach Road | 403 Ha | Albany (10) 3.1 & 3.2, Albany NE & SE, Oyster Harbour SE(25) |
| 33850 | | 00685-1956-01RO | 3083-98 | Revocation of Management Order (City of Albany of York Street Albany) for the designated purpose of "Fish Processing Depot". | H661336 | 06/02/2001 | Cheyne Bay | 777 sqm | Haul Off Rock 1:50 000 |
| 33850 | | 00685-1956-01RO | 3083-98 | Management Order to City of Albany of York Street, Albany Western Australia 6330 for the designated purpose of "Fish Processing Depot" | H661337 | 06/02/2001 | Cheyne Bay | 777 sqm | Haul Off Rock 1:50 000 |
| 33857 | | 00823-1975-01RO | 3082-36 | Revocation of Management Order (City of Albany of York Street Albany) for the designated purpose of "". | H663317 | 07/02/2001 | Tennessee Road | 38.8953 Ha | Torbay NW 1:25 000 |
| 33857 | | 00823-1975-01RO | 3082-36 | Management Order to City of Albany of York Street, Albany Western Australia 6330 for the designated purpose of "Quarrying" | H663318 | 07/02/2001 | Tennessee Road | 38.8953 Ha | Torbay NW 1:25 000 |
| 34752 | | 00975-1975-01RO | 3009-580 | Revocation of Management Order (City of Albany of York Street Albany) for the designated purpose of "". | H661365 | 06/02/2001 | William Street | 438 sqm | Albany (2) 10.07 |
| 34752 | | 00975-1975-01RO | 3009-580 | Management Order to City of Albany of York Street, Albany Western Australia 6330 for the designated purpose of "Park" | H661366 | 06/02/2001 | William Street | 438 sqm | Albany (2) 10.07 |
| 34934 | | 01873-1961-01RO | 3082-905 | Revocation of Management Order (City of Albany of York Street Albany) for the designated purpose of "Parklands". | H663281 | 07/02/2001 | Bon Accord Road | 28.8671 Ha | Albany (2) 14.14 |

AA24258
7375

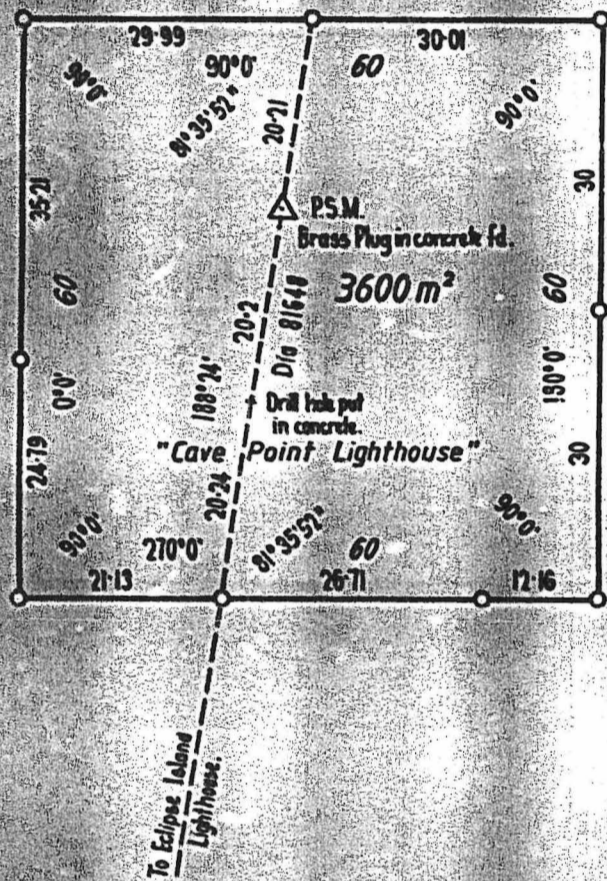

| | | | |
|---|--|--|--|
| <p>LAND DISTRICT PLANTAGENET</p> | <p>LOCATION 7234 (A32478)</p> | | <p>FILE No. 2161-972 SCALE 1:750 All measurements in metres</p> |
| <p>SURVEYOR'S CERTIFICATE I hereby certify that this survey was performed by me personally (or under my personal supervision, inspection and field check), in strict accordance with the Licensed Surveyors (Guidance of Surveyors) Regulations. Date _____ Licensed Surveyor _____</p> | <p>Azimuth observed at _____ or assumed from TRIG R 242 - MN 876 Date of marking 27th FEB 1989 Surveyor I. R. JACKSON Field Book No. 26 Page 1 of 3 Cadastral Plan ALBANY N.E. & S.E. 1:25000 Reference 582113 Diagram Drawn G. GILCHRIST Date 8-9-1988</p> | <p>Calc. Bk. No. G. SINGLETON Fol. _____ Compared with F.B. <i>20-9-88</i> Examined <i>[Signature]</i> In order for certification <i>[Signature]</i> MANAGE EXAMINATION Date 29/2/89</p> | <p>DIAGRAM CERTIFIED CORRECT <i>[Signature]</i> Date 29-9-89 Recorded on Public Plan Registered On Key Plan ALBANY N.E. & S.E. 1:25000 <i>G. Gilchrist</i> Supervisor Graphic Bank Crown Surveys 9-9-1988 DEPT. OF LAND ADMINISTRATION DIAGRAM No. 88793</p> |