

NATURE RESERVE

RESERVE NO: 35291

GOVERNMENT GAZETTE  
Date Page No.

FILE NUMBER: 949/80

PURPOSE: Conservation of Flora

22.8.80 2919

NAME:

CLASS (Land Act):

AREA: 4.6284 ha

22.8.80 2919

VESTING:

LOCATION NO(S): 28572

CLASSIFICATION:  
(Wildlife Act  
Section 12A)

**LITHO:**

LOCAL AUTHORITY: TOODYAY

Notes: (Clackline Toodyay Rd)

25 October 1996]

GOVERNMENT GAZETTE, WA

DEPARTMENT OF CONSERVATION AND LAND MANAGEMENT 5645

RESERVED 1978 (NO 32 OF 1996)

4 NOV 1996

13388, 13389, 13390, 13391, 13392, 13393, 13394, 13395, 13396, 13397, 13398, 13399, 13400, 13401, 13402, 13403, 13404, 13405, 13406, 13407, 13408, 13409, 13410, 13411, 13412, 13413, 13414, 13415, 13416, 13417, 13418, 13420, 13421, 13422, 13423, 13424, 13425, 13426, 13427, 13428, 13432, 13463 and 13481 as shown bordered red on Reserve Plan 367 (Sheets 1 to 6 inclusive) and Miscellaneous Diagrams 309, 316 and 525 and its area be established at about 115447 hectares.

DOLA File: 604/978

- 7. (i) Class 'C' Reserve 43182 (Canning Location 3893) "Conservation of Flora and Fauna" is cancelled.
- (ii) Class 'A' Reserve 23076 (Canning Location 3766) "Conservation of Flora and Fauna" is amended by the inclusion of Locations 3893 and 4107 (formerly Lot 35 on Plan 4742) and its area being increased to 21.9901 hectares.  
Public Plans: BG34(2) 23.21, 24.21 and 24.22  
DOLA File: 1930/950.
- 8. (i) Class 'A' Reserve 34772 (Meenaar Lot 71) "Conservation of Flora and Fauna" is cancelled.
- (ii) Class 'A' Reserve 29977 (Avon Location 28608) "Conservation of Flora and Fauna" is amended by the inclusion of Meenaar Lot 71 and its area being increased to 94.1208 hectares.  
Public Plans: Meenaar Townsite  
DOLA File: 3592/968
- 9. (i) Class 'C' Reserve 18625 (Bowgada Lot 52) "School Site" is cancelled.
- (ii) Class 'A' Reserve 29745 (Bowgada Lot 59) "Conservation of Flora and Fauna" is amended by the inclusion of Lot 52 and its area being increased to 152.2472 hectares.  
Public Plan: BG41 (2) 30.35  
DOLA File: 2046/969
- 10. Class 'A' Reserve 15162 (Plantagenet District) "Parklands" is amended by:-
  - (a) the excision of that area now contained in Location 7761.
  - (b) redescribing the reserve to comprise Plantagenet Location 6923 on Land Administration Plan 18597 and of its area being reduced to 58.0970 hectares.  
Public Plans: Mount Barker (25) SE and BJ27(10) 8.2  
DOLA File: 8777/913
- 11. Class 'A' Reserve 18325 (Swan Locations 3301, 3762, 5563, 7727 and 7583) "Recreation" is amended by the excision of the area now comprised on Location 11985 and its area being reduced to 161.5586 hectares.  
Public Plans: BG34(2) 14.28 and 14.29  
DOLA File: 5192/896 V7
- 12. Class 'A' Reserve 25039 (Emu Hill Lots 1 to 14 inclusive, 16, 17, 19 to 63 inclusive, 66, 67, 71, 72 and 73) "Conservation of Flora and Fauna" is amended by—
  - (a) the inclusion of Lot 74 (formerly Lot 15 on Plan 1711),
  - (b) by recalculation of its area so that the reserve comprises 61.7839 hectares.  
Public Plan: Emu Hill Townsite  
DOLA File: 2318/993
- 13. Class 'A' Reserve 39962 (Hamersley Lots 16 and 17, North Beach Lots 709 and 710 and Waterman Lots 4 and 6) "Conservation of Flora and Fauna, and Passive Recreation" is amended by the inclusion of North Beach Lot 715 and its area being increased to 95.9144 hectares.  
Public Plan: BG34(2) 7.35  
DOLA File: 3129/977 V4
- 14. (i) Class 'A' Reserve 35291 (Avon Location 28572) "Conservation of Flora and Fauna" is cancelled.
- (ii) Class 'A' Reserve 33254 (Avon Location 29024) "Conservation of Flora and Fauna" is amended by the inclusion of Location 28572 and its area being increased to 14.1015 hectares.  
Public Plans: Northam (25) SW and Toodyay (25) SE  
DOLA File: 544/972
- 15. Class 'A' Reserve 38924 (Avon Locations 28805 and 28937) "Conservation of Flora and Fauna" is amended by the inclusion of Location 29096 on Diagram 91497 and its area being increased to 931.7567 hectares.  
Public Plan: Toodyay (25) SW, BG35(10) 8.3 and 8.4  
DOLA File: 911/984 V2
- 16. (i) Class 'A' Reserve 34606 (Milyuga Location 13) "Conservation of Flora and Fauna" is amended by the excision of that area now comprised in Milyuga Location 14 on Reserve Diagram 1303 and of its area being reduced to about 1,842,864 hectares.  
Public Plan: Rawlinson 1:500,000  
DOLA File: 1687/976
- (ii) Class 'A' Reserve 29452 (Milyuga District) "Use and Benefit of Aboriginal Inhabitants" is amended to comprise Milyuga Location 14 on Reserve Diagram 1303 and of its area being increased to about 20,566 hectares.  
Public Plan: Rawlinson 1:500,000  
DOLA File: 1397/968

October 18, 1996.

MRR

TO A CLERK WOODVALE \*

FOR YOUR INFORMATION







A. A. SKINNER, Chief Executive.

Handwritten signatures and notes at the bottom of the page, including "1. 2. 3. A. Skinner" and "Mrs. Collins - for your letter plan" with initials "ise".

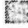
# CALM-MANAGED LANDS AND WATERS

AS AT 30th JUNE 1996

## Legend

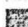
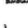
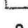
-  National Park
-  Conservation Park
-  Nature Reserve
-  State Forest, Timber Reserve, Freehold & Other Reserve
-  Section 5(g) Reserve
-  Leasehold in the name of the Executive Director
-  Marine Park / Marine Nature Reserve
-  CALM Region Boundary
-  CALM Regional Office

Scale  
0 100 200 300 400 Km

Projection: Polyconic, Origin 121°, 0°



Produced by INFORMATION MANAGEMENT BRANCH

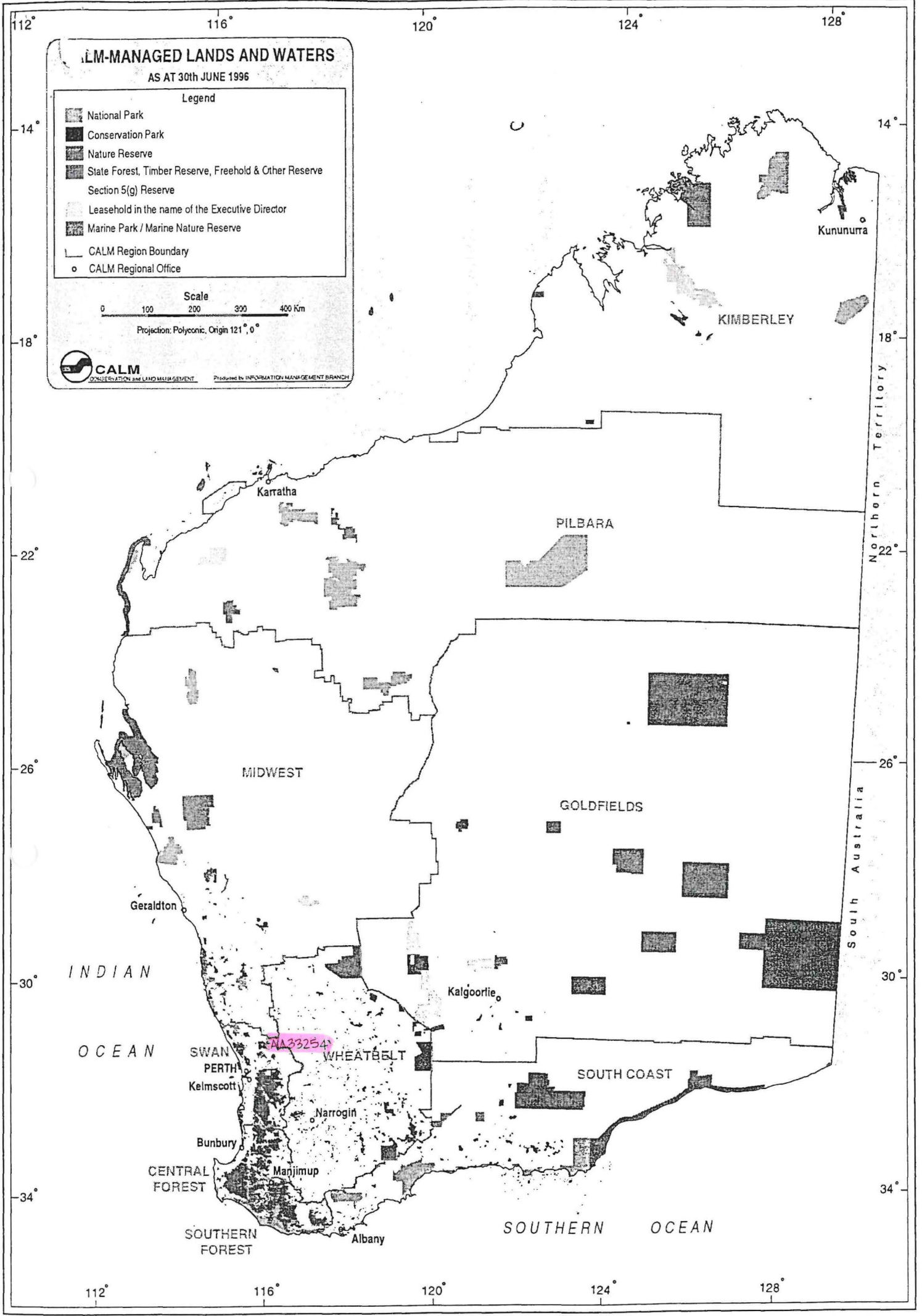



## CLAUSE 20

Class 'A' Reserve 35291 is set aside for the purpose of "Conservation of Flora and Fauna" and is vested in the National Parks and Nature Conservation Authority. The reserve comprises Avon Location 28572 and contains an area of about 4.6284 hectares.

To assist with management the Department of Conservation and Land Management has requested that Reserve 35291 be cancelled and the contained lands included into adjoining Class 'A' "Conservation of Flora and Fauna" Reserve 33254. This reserve is also vested in the NP&PCA.

Both the Shire of Toodyay and DOLA support this proposal.

As both Reserves 35291 and 33254 have Class 'A' status it is necessary to obtain the approval of both Houses of Parliament to give effect to the proposed cancellation and amalgamation.

Electoral District of Avon  
Agricultural Electoral Region  
Shire of Toodyay



1. CANCELLATION OF CLASS "A" RESERVE 35291 (AVON LOCATION 28572) AS COLOURED DARK RED.

2. AMENDMENT OF CLASS "A" RESERVE 33254 TO INCLUDE AVON LOCATION 28572 COLOURED DARK RED.

AVON DISTRICT

PUBLIC PLANS : NORTHAM (25) SW & TOODYAY (25) SE

corr. 3267/976

SCALE 1:12 500

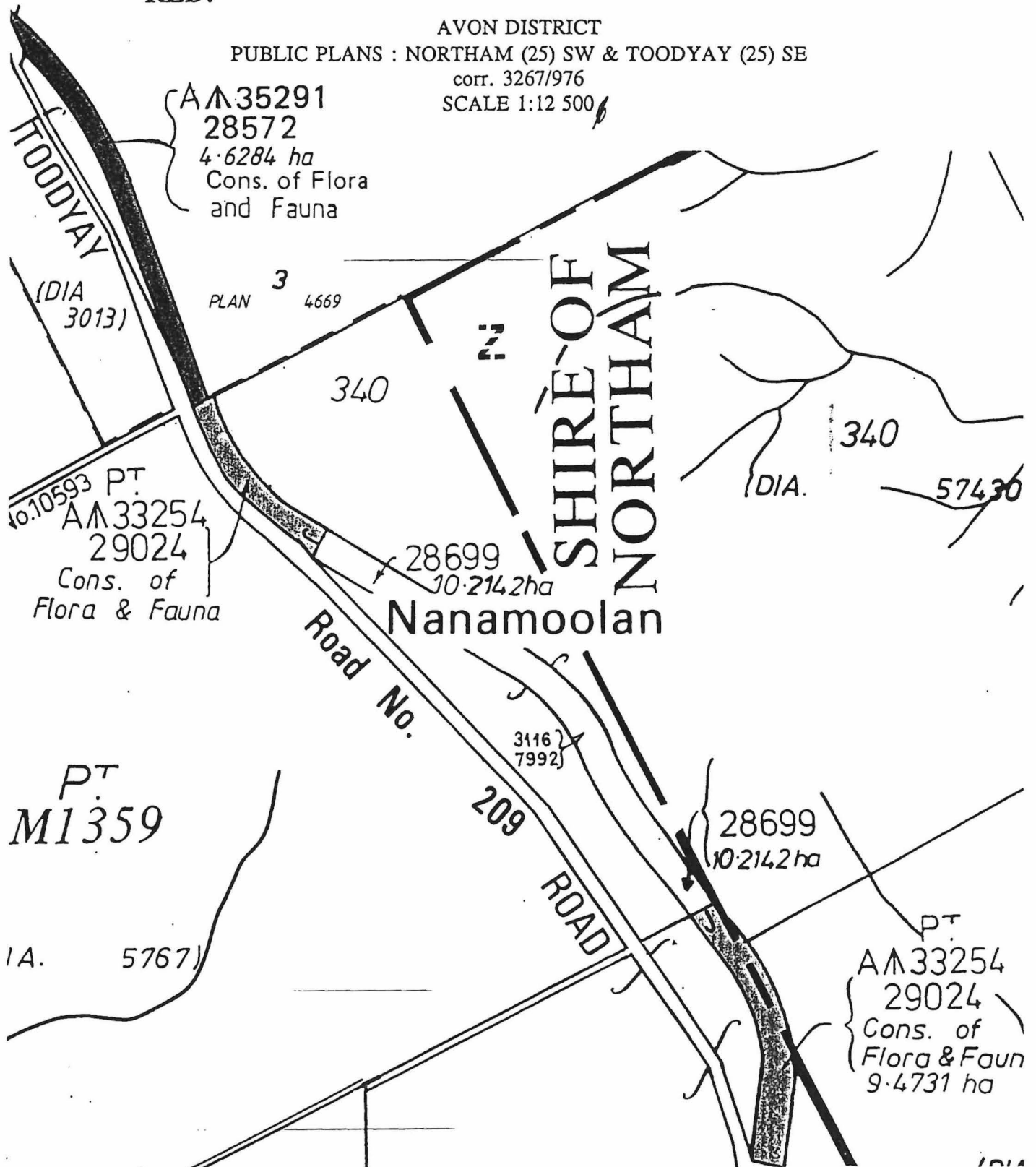

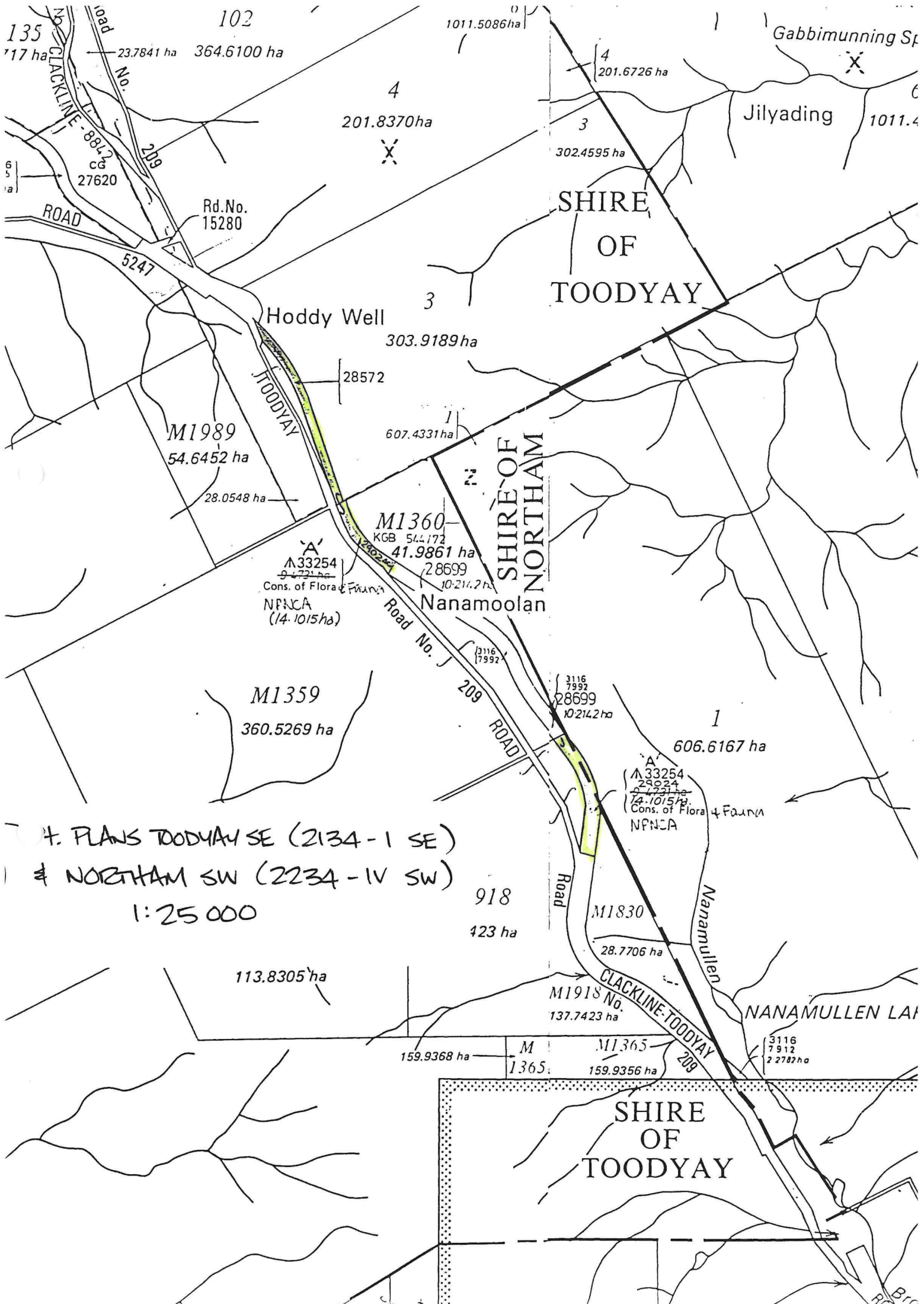

4. PLANS TOODYAY SE (2134 - I SE)  
 & NORTHAM SW (2234 - IV SW)  
 1:25 000

SHIRE OF TOODYAY

SHIRE OF NORTHAM

NANAMOOLAN

SHIRE OF TOODYAY

Hoddy Well

NANAMULLEN LAKE

TOODYAY

Nanamullen

CLACKLINE-TOODYAY ROAD

135 717 ha  
 23.7841 ha  
 364.6100 ha

4  
 201.8370 ha

4  
 201.6726 ha

Gabbimunning Sp  
 1011.4

ROAD No. 5247

Rd. No. 15280

M1989  
 54.6452 ha

M1360  
 KGB 54.172  
 41.9861 ha

M1359  
 360.5269 ha

1  
 606.6167 ha

A 33254  
 Cons. of Flora & Fauna  
 NP/CA  
 (14.1015 ha)

A 33254  
 Cons. of Flora & Fauna  
 NP/CA  
 (14.1015 ha)

918  
 423 ha

M1830

113.8305 ha

M1918 No.  
 137.7423 ha

M 1365  
 159.9368 ha

M1365  
 159.9356 ha

3116  
 7912  
 22782 ha