

**RESERVE GAZETTAL ACTION SHEET
FOR REGIONS AND DISTRICTS**

LANDS CLERK: Attach a copy of a map and forward to the following:

1. REGIONAL MANAGER:
CENTRAL FOREST, MIDWEST, GOLDFIELDS, KIMBERLEY, SWAN REGION ✓
PILBARA, SOUTH COAST, SOUTHERN FOREST, WHEATBELT
2. DISTRICT MANAGER: Parahdale ✓
3. DISTRICT WILDLIFE OFFICER: Como ✓
4. CLERK WOODVALE ✓
5. O.I.C. INVENTORY BUNBURY/KELMSCOTT/MANJIMUP

REASON FOR GAZETTAL:

Change in purpose from "Government Requirements" to "Conservation
of Flora + Fauna," automatically vested in the NPNCA.
Area reduced by 151.12 ha to 486.43 ha.

RESERVE NUMBER: 36096

CALM FILE NUMBER: 029874F3102

NAME OF RESERVE: _____

PURPOSE: Conservation of Flora + Fauna.

CLASS: C

AREA: 486.43 ha

VESTING: NPNCA

DATE OF CURRENT GAZETTAL: 30/11/92

MAP REFERENCE: Luptons SE 1:25,000

SHIRE: Brookton

A. Wat
LANDS CLERK
09 367 0221

8/1/93
DATE

Handwritten mark

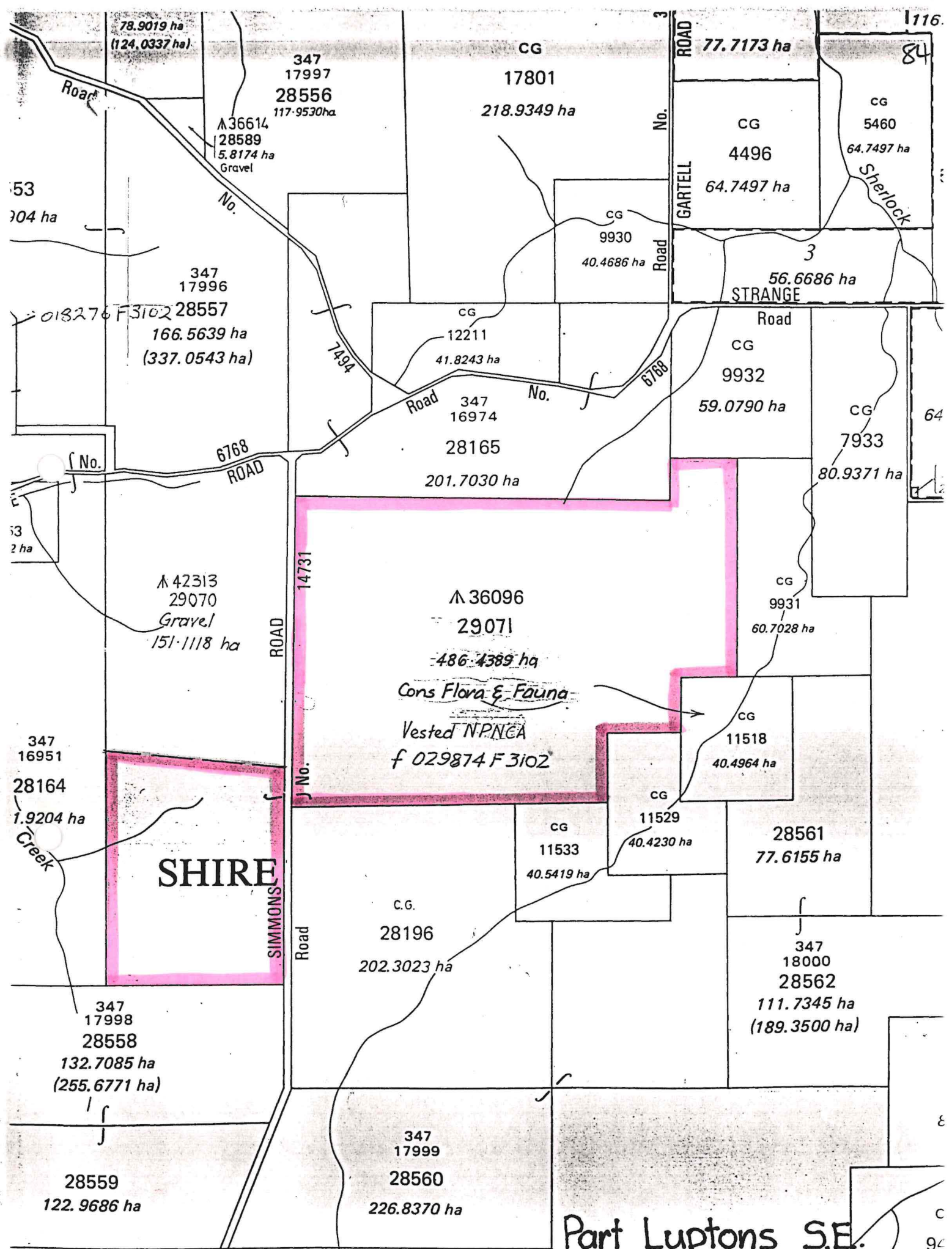

Part Luptons S.E.

Scale 1:25 000

C41 of System 6

508170

53
304 ha

78.9019 ha
(124.0337 ha)

347
17997
28556
117.9530 ha

CG
17801
218.9349 ha

ROAD
77.7173 ha

1116
84
CG
5460
64.7497 ha
Sherlock

347
17996
28557
166.5639 ha
(337.0543 ha)

CG
9930
40.4686 ha

CG
4496
64.7497 ha

3
56.6686 ha
STRANGE

CG
12211
41.8243 ha

CG
9932
59.0790 ha

CG
7933
80.9371 ha

42313
29070
Gravel
151.1118 ha

36096
29071
486.4389 ha

CG
9931
60.7028 ha

Cons Flora & Fauna
Vested NPNGA
f 029874 F3102

CG
11518
40.4964 ha

347
16951
28164
1.9204 ha
Creek

SHIRE

CG
11533
40.5419 ha

CG
11529
40.4230 ha

28561
77.6155 ha

C.G.
28196
202.3023 ha

347
18000
28562
111.7345 ha
(189.3500 ha)

347
17998
28558
132.7085 ha
(255.6771 ha)

28559
122.9686 ha

347
17999
28560
226.8370 ha

CG

80.93