



DEPARTMENT OF LANDS AND SURVEYS

Cathedral Avenue,
Perth,
Western Australia 6000

W 561/79 MAPPING
24/80 ✓
Don't understand what has to be done.

Your Ref. 561/79 DH:AH
Our Ref. 2830/985 CN:LF
Telephone Enquiries 3231278

Department of Conservation
and Land Management
- 8 MAY 1986
COMO, W.A.

EXECUTIVE DIRECTOR
DEPARTMENT OF CONSERVATION AND
LAND MANAGEMENT

CARRABIN NATURE RESERVE NO 16235 PROPOSED 50B STATION SEC

I refer to your memo of October 24, 1985 and advise for your information that Executive Council has:

1. approved of the amendment of Reserve No. 16235 (Jilbadji Locations 983 and 984) "Conservation of Flora and Fauna" to exclude that portion of Location 984 now comprised in Jilbadji Location 1002 and of its area being reduced to 760.2455 hectares.
2. approved of Jilbadji Location 1002 being set apart as Reserve No 39430 for the purpose of "Sub Station Site (State Energy Commission)" and issued an Order in Council directing that Reserve No 39430 for the purpose of "Sub Station Site (State Energy Commission)" and issued an Order in Council directing the Reserve No 39430 (Jilbadji Location 1002) shall vest in and be held by the State Energy Commission of Western Australia in trust for the purpose of "Sub Station Site (State Energy Commission)".

Notice to this effect was published in the Government Gazette of April 18, 1986 and I enclose a print showing the said amendment.

Carrabin Township - NO. 24/80 E1

B J O'Maureen
UNDER SECRETARY FOR LANDS

cf 8.10.86

May 7, 1986

1 Mr Hampton noted
2 S.C. RESERVES (see f. 86 also. dh)
[Signature]

A 16235
984
Res Plan 197

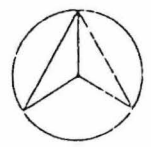
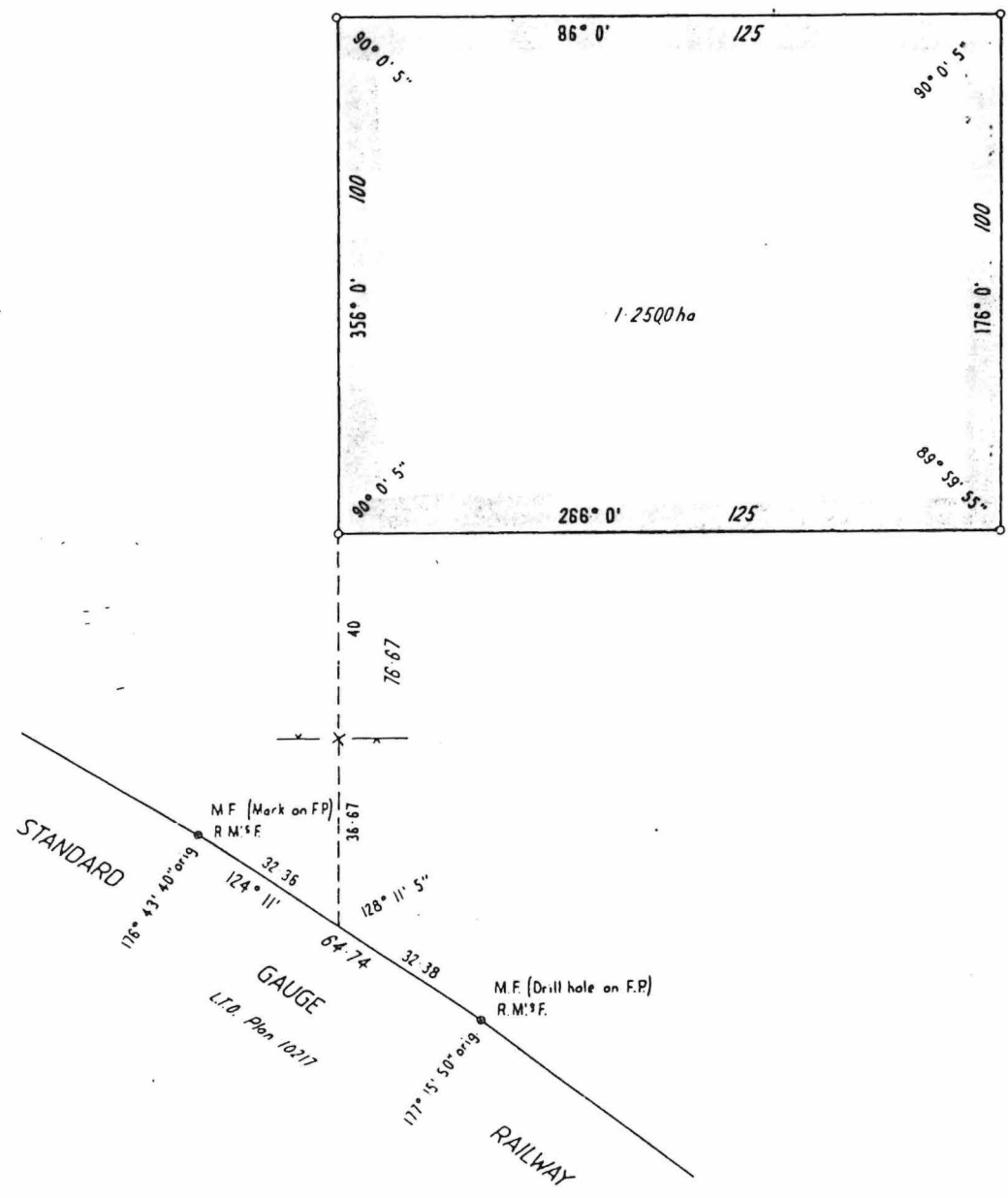

LAND DISTRICT JILBADJI	LOCATION 1002		FILE No. 2830/985
SURVEYOR'S CERTIFICATE I hereby certify that this survey was performed by me personally (or under my personal supervision, inspection and field check), in strict accordance with the Licensed Surveyors (Guidance of Surveyors) Regulations. Licensed Surveyor	Azimuth observed at..... or assumed from..... Date of marking 1-12-1985 Surveyor W.P. STEWART Field Book No. 42 Page 6-B Cadastral Plan 24/80 Reference E1		SCALE 1:1000 <i>REVISED</i> All measurements in metres
	Calc. Bk. No. Fol Compared with F.B. <i>B.G. Roy</i> Examined <i>B.G. Roy 27-2-85</i> Diagram passed Inspector of Plans and Surveys		SURVEY APPROVED Date Surveyor General Recorded on Public Plan Registered On Key Plan 24/80 <i>Stewart</i> Custodian of Plans 1.1985 DEPT. OF LANDS AND SURVEYS