

RESERVE ACTION SHEET - CONSERVATION RESERVES

RESERVE No. 40322

REASON FOR ACTION

The creation of a 5(1)(h) reserve with a management order issued to the Conservation Commission for the purpose 'Conservation, Navigation, Communication, Meteorology and Survey'.
Area: 0.15 hectares

Due to increasing use of satellite aided navigation and AMSA'S desire to rationalise its property holdings the Commonwealth has been divesting properties containing lighthouses and marine navigational aids. Reserve 40322 on Airlie Island is a former AMSA property which will be leased back to AMSA to permit continued operation of lighthouse facilities.

- Date of DOLA's advice: 23 January 2001 See folio: 15
- Plans at folios: 18,17,16

| OFFICER | ACTION |
|--|---|
| 1 CONSERVATION ESTATE OFFICER | - Fill in above details - Attach copies of DOLA's advice to file Send copies of advice & maps to: - Lisa Wright, Woodvale - Regional Manager, Pilbara Recommended IUCN classification: V |
| 2 LAND ACQUISITIONS OFFICER | To note: |
| 3 MANAGER, PLANNING & VISITOR SERVICES | To note & approve IUCN classification: |
| 4 DIRECTOR, NATURE CONSERVATION/ NATIONAL PARKS | To note: |
| 5 INDEX CLERK, RECORDS | To note: |
| 6 CONSERVATION ESTATE OFFICER | Attach copy of Reserve Details to inside cover of new file |

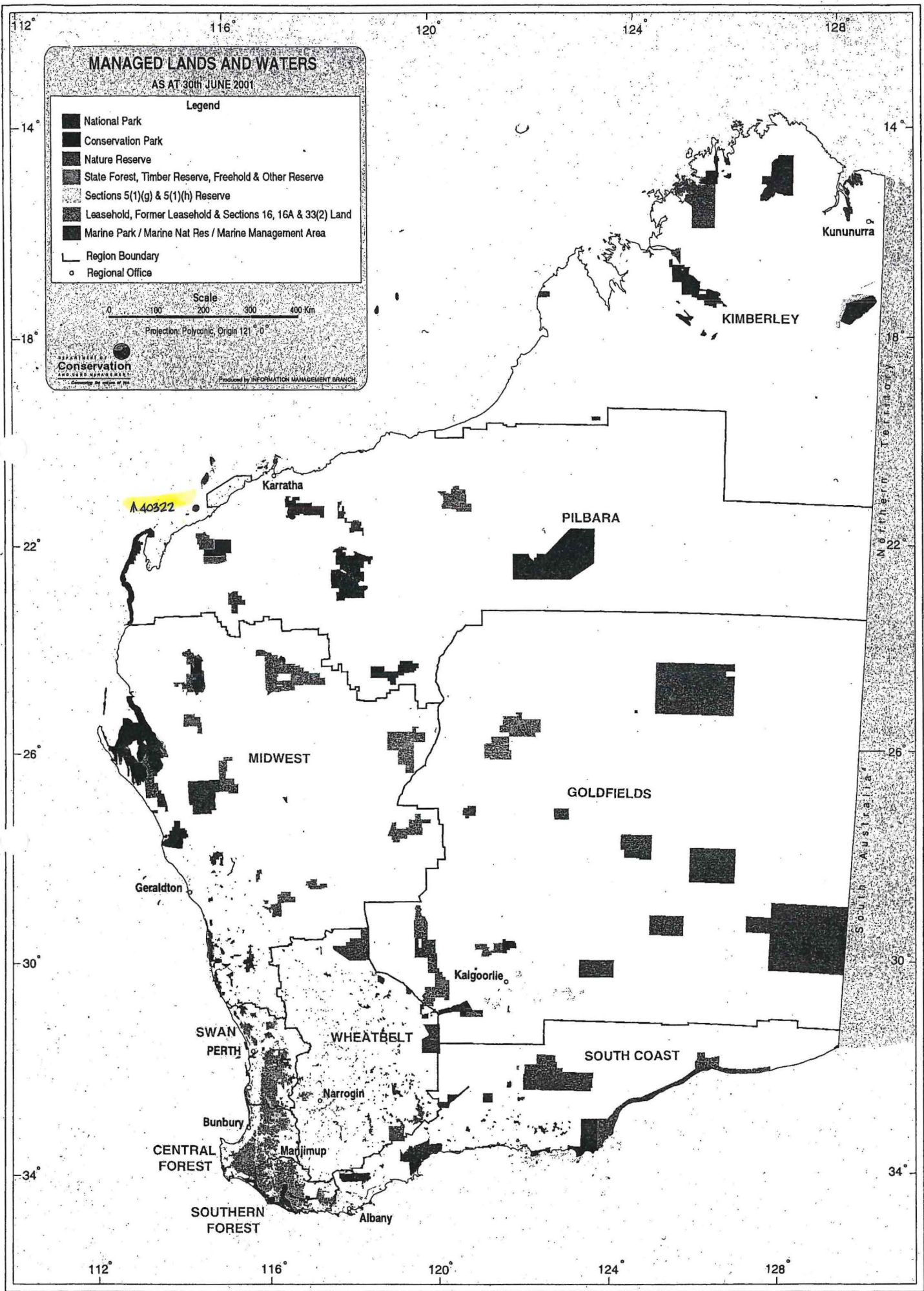

MANAGED LANDS AND WATERS

AS AT 30th JUNE 2001

Legend

- National Park
- Conservation Park
- Nature Reserve
- State Forest, Timber Reserve, Freehold & Other Reserve
- Sections 5(1)(g) & 5(1)(h) Reserve
- Leasehold, Former Leasehold & Sections 16, 16A & 33(2) Land
- Marine Park / Marine Nat Res / Marine Management Area
- Region Boundary
- Regional Office

Scale
0 100 200 300 400 Km

Projection: Polyconic, Origin 121° 0'



Produced by INFORMATION MANAGEMENT BRANCH

A 40322

Northern Territory

South Australia

112° 116° 120° 124° 128°

14° 18° 22° 26° 30° 34°

Kununurra

KIMBERLEY

Karratha

PILBARA

MIDWEST

GOLDFIELDS

Geraldton

Kalgoorlie

SWAN PERTH

WHEATBELT

SOUTH COAST

Narrogin

Bunbury

CENTRAL FOREST

SOUTHERN FOREST

Manjimup

Albany

Ripple Shoals
Mary Ann

Penguin Bank

ROSILY ISLANDS

Rosily Shoals

CALM Lease No. 1901/100
Airsie Island Light
Airsie Island
A 403221 144
1 500 m
Observation, Navigation, Communication, Meteorology Service
NPNC A
045815P2001Y01
A 403223 144
abt 41 0000 ha
Conservation of Flora & Fauna
NPNC A
f 025421 F0304

Taunton Reef

West Reef

A N

Cape Don Shoal

Little Shoals

Trap Reef

Thevenard Island Nature Reserve
A33174
147
Conservation of Flora and Fauna
abt 573-0389 ha
NPNC A
f 025536 F3102
CALM Lease No. 387/100
Thevenard Island
A 3116 142
abt 10-1700 ha

Sultan Reef

Moresby Shoals

Nares Rock

Middle Mangrove Island

ISLANDS

Little Rocky Is Nature Res
A A 34
abt 164
Conservation of Flora and Fauna
NPNC A
f 0

Brewia Reef

Herald Reef

NETwin Island

South Island

Weeks Shoal

SW Twin Island

Gorgon Patch

Direction Island
A 43
816
11844
abt 1,1380 ha

Mangrove

Yardie Landing

Australind Shoal Miles Shoal Paroo Shoal Richardson Shoal Hastings Shoal Saladin Shoal

Ashburton Island
MNF 855
17

Gravel Banks

Roller Shoal

Curlew Bank

1 Patch

kes Reef

Saddle Hill
A 1929
173
abt 4982 9497 ha
Commonwealth
Vested in Ashburton

Ward Reef
BE 63RL2
ONSLW
Beadon Point
Beadon Bay
ONSLW
R 28 (MNF)
See 1:10000 Enlarged Plan
BE 63RL1
ONSLW
Auradrome

Barrigombar Cliffs
A 1054
abt 24 0000 ha
Sewage Plant

3114 905

PEEDAMULLA

abt 224549 ha ex Locs, Res's & Res

149

ASHBURTON

186
1-0957ha
A 2126
101-174 ha
Racecourse & District

**Customer Advices for Reserve Actions
1/08/2001 - 31/08/2001**

Shire of Ashburton 1/08/2001 - 31/08/2001

*ILBARA REG
KARRATHA DIST.*

| Reserve No. | Land Description | DOLA File No. | Volume/Folio | Action | Document No. | Registered | Street Name | Area | Public Plans |
|-------------|------------------|-----------------|--------------|--|--------------|------------|----------------------------------|----------|--------------|
| 40322 | | 03437-1988-01RO | 3054-955 | Management Order to Conservation Commission of Western Australia C/- Department of Conservation and Land Management Locked Bag 104 Bentley Delivery Centre Como W.A 6152 for the designated purpose of "Conservation, Navigation, Communication, Meteorology & Survey" | H651909 | 23/01/2001 | Airline Island <u>AIRLIE!</u> | 1500 sqm | Onslow (250) |

*5(12)
15*

FORMERLY LOC. 10
 A40322 Gaz 27/11/88 pg.4263
 A40323 Gaz 27/11/88 pg.4263

AMENDMENTS

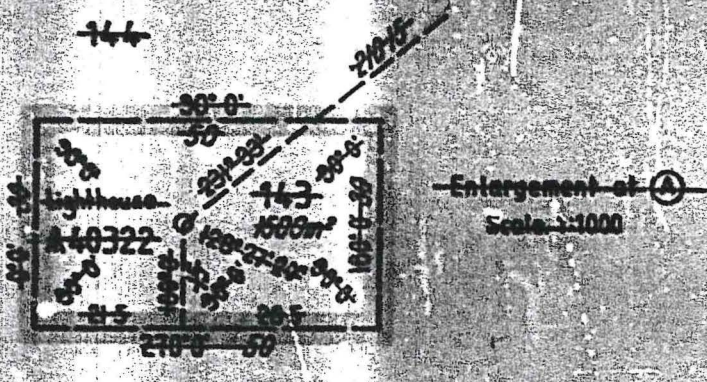

INDIAN
 Enlargement at (B)
 Scale 1:1000
 A40323
 144

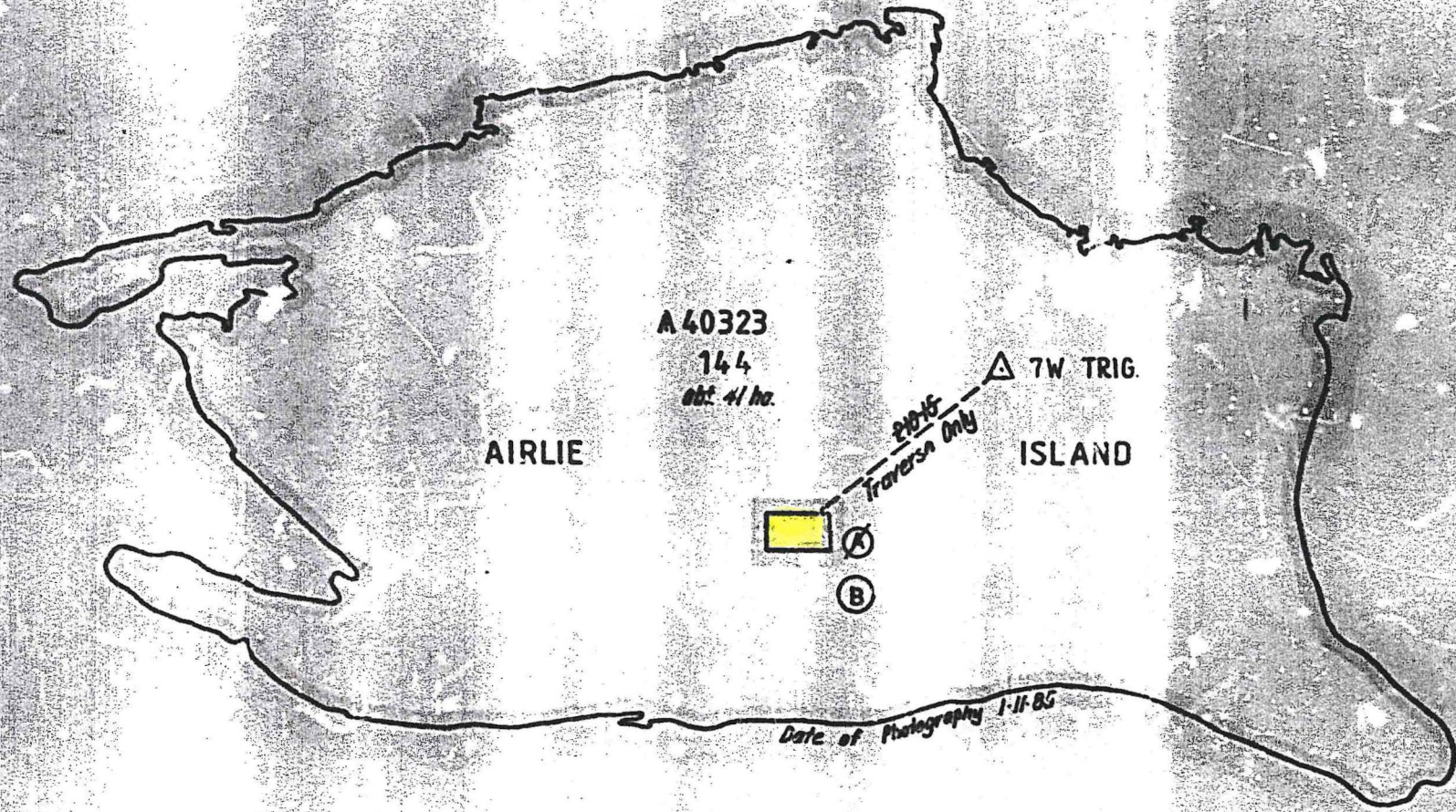
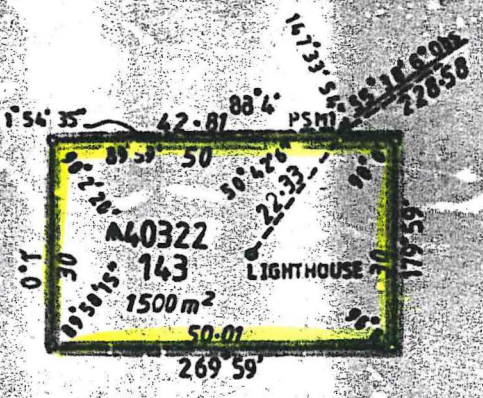
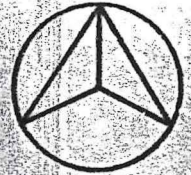

DIAGRAM CERTIFIED AS AMENDED (I. B. P. HUNT 161)
 LOC. 143
 10.10.89
 AUTHORIZED LAND OFFICER O'KYE



Location boundary extends to Low Water Mark
 Water lines shown on this diagram do not necessarily depict an exact cadastral boundary

| | | | |
|---|---|--|---|
| LAND DISTRICT ASHBURTON | LOCATIONS 143 AND 144 | | FILE No. 6036/13 D. |
| SURVEYOR'S CERTIFICATE I hereby certify that this survey was performed by me personally (or under my personal supervision, inspection and field check), in strict accordance with the Licensed Surveyors (Guidance of Surveyors) Regulations. | Azimuth observed at or assumed from _____ Date of marking _____ Surveyor _____ Field Book No. _____ Page _____ Cadastral Plan ONSLOW 1:250,000 Reference 310641 Diagram Drawn R. J. COOPER Date 13-11-1987 | Calc. Bl. No. D.W. HADDOW 12 Feb 85 Compared with F.B. _____ Examined 11/10 In order for certification 10/10/89 Date 3.8.88 Survey & Transit Drawing | SCALE 1:5000 All measurements in metres DIAGRAM CERTIFIED CORRECT Reg 3 SURVEYOR GENERAL Date 1.9.88 Recorded on Public Map R. Nelson 27/11/87 Registered on Key Plan Custodian of Plans 20.12.90 |
| COMPILED Licensed Surveyor. Date _____ | DEPT. OF LAND ADMINISTRATION DIAGRAM No. 88287 | | CP 24045/1/a - 40 |