

RESERVE GAZETTAL ACTION SHEET
FOR REGIONS AND DISTRICTS

LANDS CLERK: Attach a copy of map and forward to the following:

1. REGIONAL MANAGER:
CENTRAL FOREST, GREENOUGH, GOLDFIELDS, KIMBERLEY,
NORTHERN FOREST, PILBARA, SOUTH COAST, SOUTHERN FOREST,
WHEATBELT
2. DISTRICT MANAGER: PERTH
3. CLERK, WOODVALE
4. O.I.C. INVENTORY BUNBURY/KELMSCOTT/MANJIMUP
5. DISTRICT WILDLIFE OFFICER: COMO

REASON FOR GAZETTAL:

change in class "c" to "A" change in purpose from "Conservation of Flora + Fauna" to "Marine Park". to comprise location 11339 in lieu of location 11012 and its area being increased by 1.65ha to 5.52ha.

RESERVE DETAILS

RESERVE NUMBER: 40891
CALM FILE NUMBER: 016368F4101
MAP REFERENCE: PERTH 1:2000
SHIRE: SUBIACO

CHANGES MADE AT GIVEN GAZETTAL DATE

NAME OF RESERVE: _____
PURPOSE: Marine Park
CLASS: "A"
AREA: 5.52 ha.
VESTING: NPNCA
DATE AND PAGE NO. OF CURRENT GAZETTAL: 13/9/91 4791

LANDS CLERK

(09) 367 0221

14/4/92
DATE

13/9/91

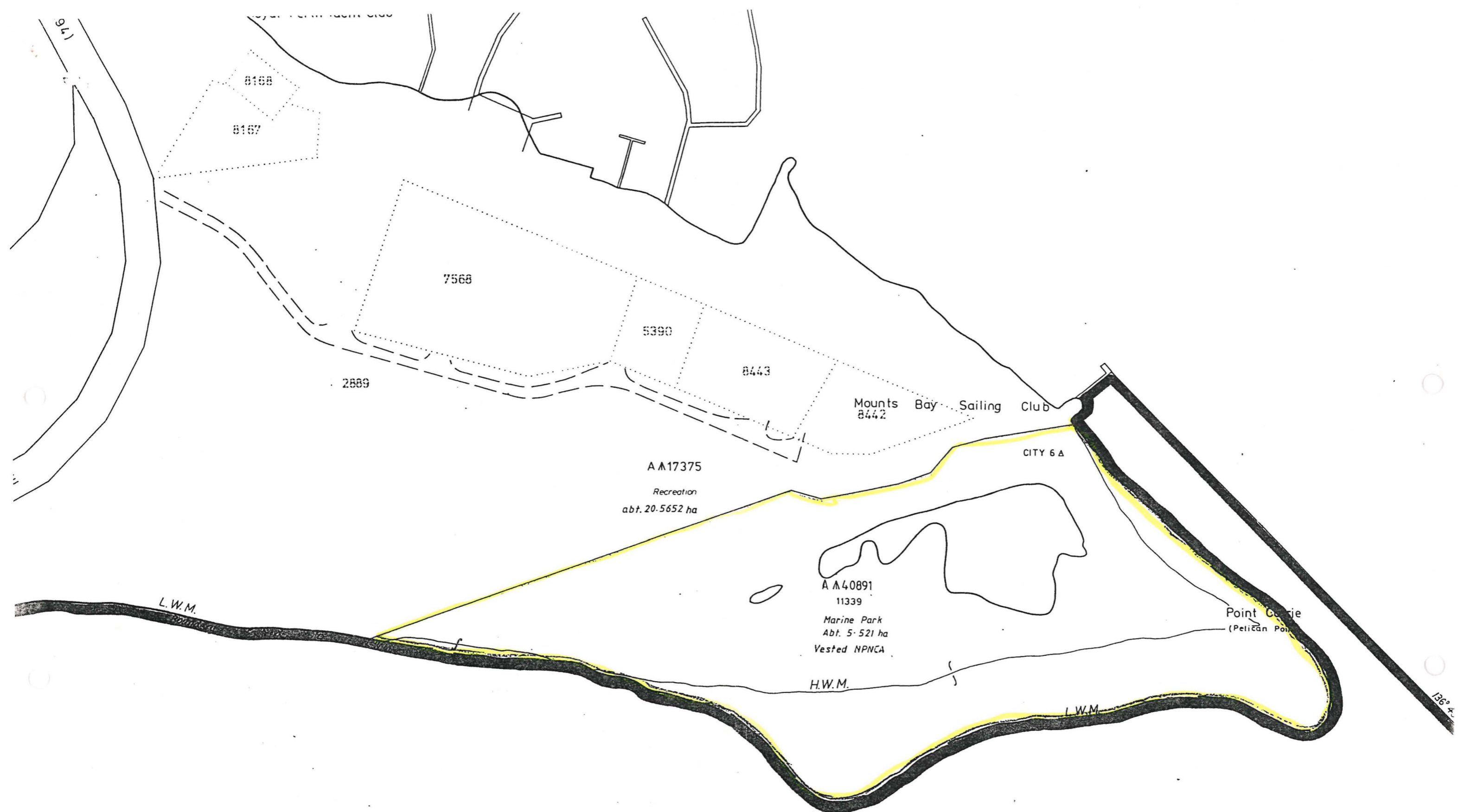

PART CLASS 'A' MARINE RESERVE No 4

'Swan Estuary Marine Park'

N.P.N.C.A.

027715 F4101

MELVILLE

WATER

Part Perth 2000 Bg. 34 / 11.21

Scale 1: 2000

