

**RESERVE GAZETTAL ACTION SHEET
FOR REGIONS AND DISTRICTS**

LANDS CLERK: Attach a copy of a map and forward to the following:

1. REGIONAL MANAGER:
CENTRAL FOREST, MIDWEST, GOLDFIELDS, KIMBERLEY, SWAN REGION,
PILBARA, SOUTH COAST, SOUTHERN FOREST, WHEATBELT
2. DISTRICT MANAGER: KATANNING
3. DISTRICT WILDLIFE OFFICER: NAAROOEN
4. **CLERK WOODVALE**
5. O.I.C. INVENTORY BUNBURY/KELMSCOTT/MANJIMUP

REASON FOR GAZETTAL:

Creation of a "c" class nature reserve vested in
NPNCA for "Conservation of flora & fauna".

RESERVE NUMBER: 42117

CALM FILE NUMBER: 029912 F3102

NAME OF RESERVE: -

PURPOSE: "Conservation of flora & fauna"

CLASS: 'c'

AREA: 474.0 ha

VESTING: NPNCA

DATE OF CURRENT GAZETTAL: 27 July 1992

MAP REFERENCE: Mandlaving 1:50,000

SHIRE: Lake Grace

M. Woodvale
LANDS CLERK
09 367 0221
3370221

19 July 1992
DATE

Gazetted: 24/7/92 PVH

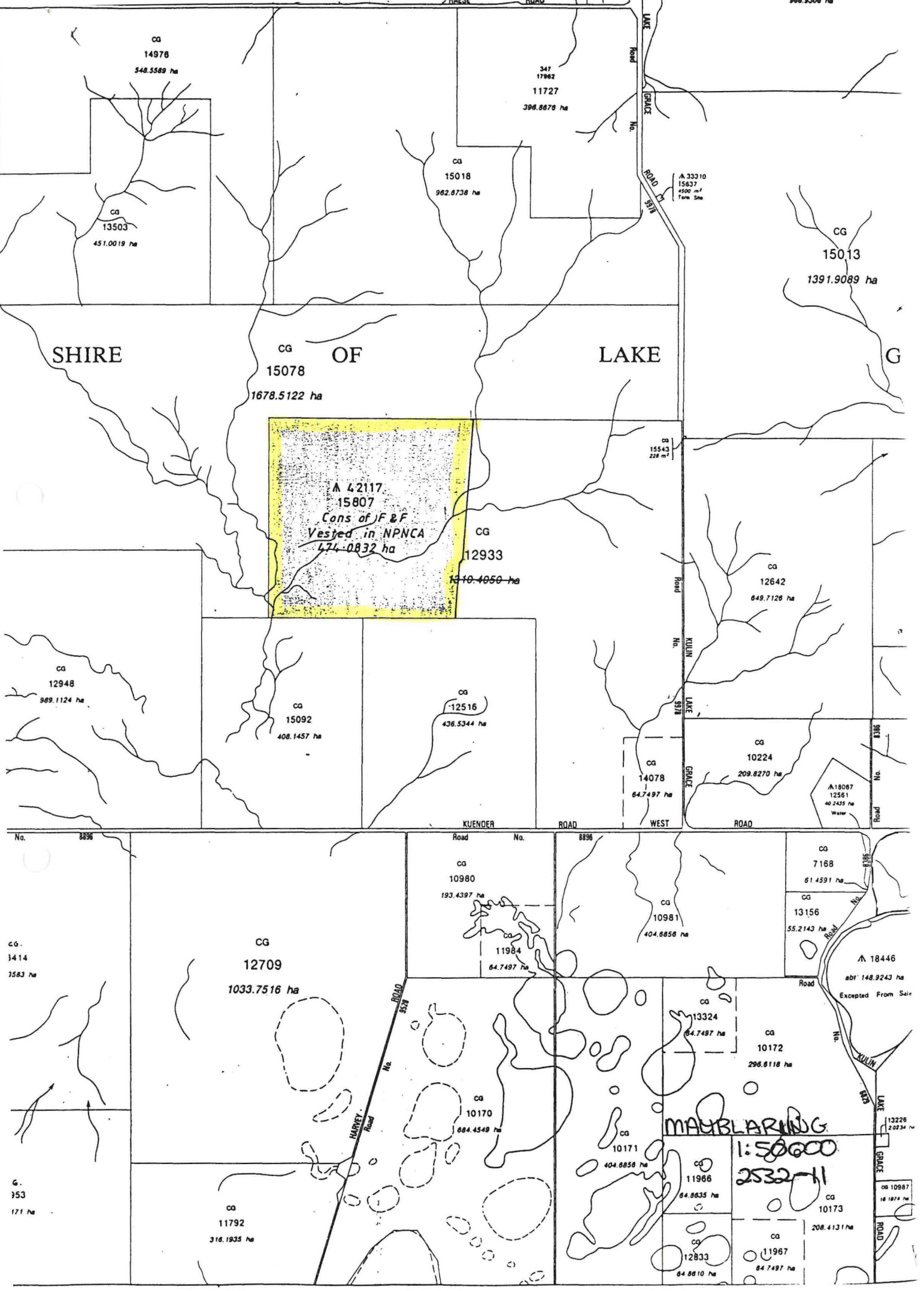

ca
14978
548.5589 ha

347
17962
11727
396.8676 ha

ca
13503
451.0019 ha

ca
15018
982.8738 ha

A 33310
15637
4500 m²
Tare 5ha

CG
15013
1391.9089 ha

SHIRE OF LAKE GEORGE

CG
15078
1678.5122 ha

**A 42117
15807
Cons of J & F
Vested in NPNCA
474-0832 ha**

CG
12933
1310.4050 ha

B
15543
228 m²

ca
12642
649.7126 ha

ca
12948
989.1124 ha

ca
15092
408.1457 ha

ca
12516
436.5344 ha

CG
14078
64.7497 ha

CG
10224
209.8270 ha

A 18067
12561
40.2435 ha
Water

KUENDER ROAD WEST ROAD

No. 8896

Road No. 8896

ca
10980
193.4397 ha

ca
10981
404.6856 ha

CG
7168
61.4591 ha

CG
13156
55.2143 ha

CG
3414
1583 ha

CG
12709
1033.7516 ha

ca
11984
64.7497 ha

A 18446
abt 148.9243 ha
Excepted From Sale

ca
13324
64.7497 ha

CG
10172
296.6118 ha

G.
353
171 ha

ca
11792
316.1935 ha

ca
10170
684.4549 ha

ca
10171
404.6856 ha

MAUBLARUNG
1:50000
2532-11

ca
11966
64.6635 ha

CG
10173
208.4131 ha

ca
12833
64.6610 ha

ca
11967
64.7497 ha

13226
2.0234 ha

ca 10987
18.1874 ha

ROAD

DOLA File: 1164/990.

Reserve No. 42149 comprising Wellington Location 5617 with an area of about 1980 square metres on Land Administration Reserve Diagram 1086 for "Railway Purposes".

Public Plan: MUJA BH30 (02) 01.24.

Local Authority—Shire of Collie.

DOLA File: 1396/991.

Reserve No. 42117 comprising Williams Location 15807 (formerly portion of Williams Location 12933) with an area of 474.0832 hectares on Land Administration Diagram 89915 for the designated purpose of "Conservation of Flora and Fauna".

Public Plan: Maublarling 1:50 000 (2532-II) near Kulin-Lake Grace Road.

Local Authority—Shire of Lake Grace.

Reserve 42117 is automatically vested in the National Parks and Nature Conservation Authority pursuant to section 7 (4) (a) of CALM Act 1984.

DOLA File: 1351/992.

Reserve No. 42246 comprising Swan Location 11756 (formerly portion of Swan Location 92 and being Lot 368 the subject of Plan 18373) with an area of 3.3839 hectares for the designated purpose of "Public Recreation and Drainage Under Section 20A".

Public Plan: Perth BG34 (2) 09.35 Balcatta Road.

Local Authority—City of Stirling.

DOLA File: 524/992.

Reserve No. 42172 comprising Canning Location 3774 (formerly portion of Canning Location 16 and being Lot 86 on Diagram 79160) with an area of 1728 square metres for the designated purpose of "Public Recreation" Under Section 20A.

Public Plan: Perth (2) BG34 20.10 near Bullfinch Street.

Local Authority—City of Gosnells.

DOLA File: 629/990.

Reserve No. 42173 comprising Cockburn Sound Location 4005 (formerly portion of Cockburn Sound Location 16 and being Lot 489 on Plan 17219) with an area of 3.3309 hectares for the designated purpose of "Public Recreation" Under Section 20A.

Public Plan: Murray (2) BG32 07.39 Wanjeep Street.

Local Authority—City of Mandurah.

DOLA File: 4268/989.

Reserve No. 42171 comprising Swan Location 11693 (formerly portion of each of Swan Location I and K and being Lot 110 on Plan 17203) with an area of 2.1291 hectares for the designated purpose of "Public Recreation" Under Section 20A.

Public Plan: Perth (2) BG34 14.36 Apple Blossom Drive.

Local Authority—City of Stirling.

DOLA File: 2835/991.

Reserve No. 42167 comprising Swan Location 11738 (formerly portion of Swan Location K and being Lot 561 on Plan 17201) with an area of 3 985 square metres for the designated purpose of "Public Recreation" Under Section 20A.

Public Plan: Perth (2) BG34 14.35 Allspice Vista.

Local Authority—City of Stirling.

DOLA File: 1299/980.

Reserve No. 42169 comprising Herdsman Lake Suburban Lot 493 (formerly portion of Herdsman Lake Lot 367 and being Lot 2 on Diagram 58850) with an area of 3 050 square metres for the designated purpose of "Public Recreation" Under Section 20A.

Public Plan: Perth (2) BG34 10.28.

Local Authority—City of Stirling.

DOLA File: 2836/991.

Reserve No. 42166 comprising Swan Location 11739 (formerly portion of Swan Location K and being Lot 508 on Plan 17200) with an area of 4 191 square metres for the designated purpose of "Public Recreation" Under Section 20A.

Public Plan: Perth BG34 14.35 Cedar Court.

Local Authority—City of Stirling.

DOLA File: 1041/992.

Reserve No. 42156 comprising Swan Location 11729 (formerly portion of Swan Location K and being Lot 785 on Plan 17476) with an area of 1.5389 hectares for the designated purpose of "Public Recreation" Under Section 20A.

Public Plan: Perth (02) 14.35 Allamanda Gardens.

Local Authority—City of Stirling.

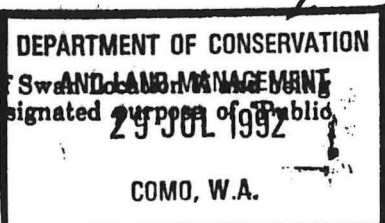

15078
O.P. 6838

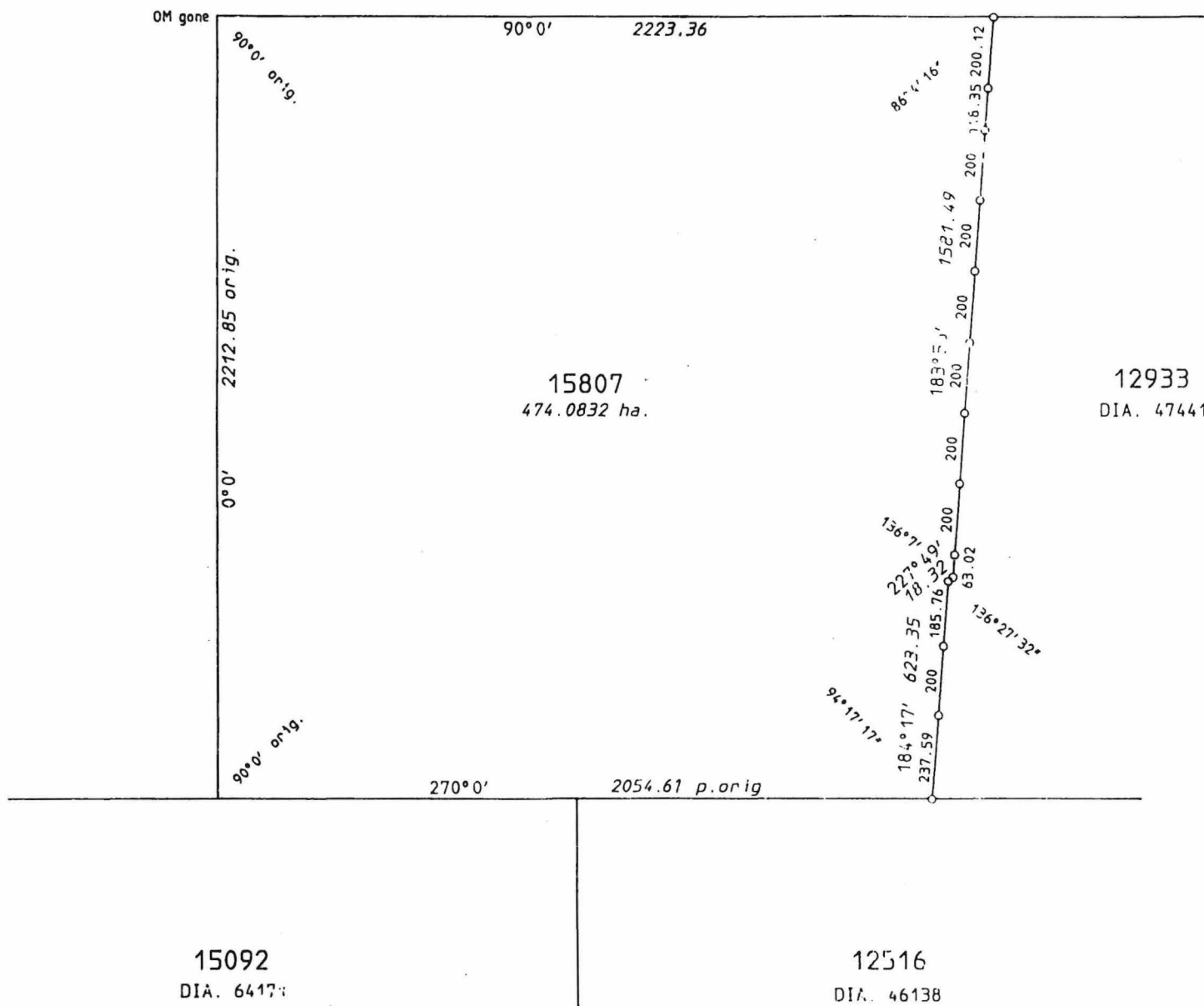

LAND DISTRICT WILLIAMS		LOCATION 15807			
SURVEYOR'S CERTIFICATE I hereby certify that:- (a) this plan of survey is a correct and accurate representation of the survey carried out by me personally / under my own personal supervision, inspection and field check and recorded in fieldbooks lodged for the purpose of this plan of survey; (b) the measurements are in strict accordance with the Licensed Surveyors (Evidence of Surveyors) Regulations 1951 and in particular regulations 12 and 34 of those regulations; and (c) this survey and this plan of survey are in strict accordance with the requirements of the Licensed Surveyors (Evidence of Surveyors) Regulations 1951 and the relevant law in relation to which it is lodged.			SCALE 1 : 15000 measurements in metres	FILE 1396/991	
Licensed Surveyor _____ Date _____ (to strike out which ever does not apply)			SURVEYOR D.C. CONSIGNINE	PUBLIC PLAN 2532-11	
Prepared H.S. PRESLAND <i>Mark Presland 2-9-91</i>			FIELD BOOK 572	INDEX PLAN	
In order for certification _____ Date _____			AZIMUTH FROM O.P. 6838	RECORDED ON KEYPLAN MAUBLARLING 1:50000 INDEX PLAN	
Examined <i>Bookend</i> Date 4-9-91 In order for further action _____ Date 5/9/91			DIAGRAM CERTIFIED CORRECT	DEPARTMENT OF LAND ADMINISTRATION	
Authorized Land Officer _____ Date _____			REGISTERED R.F.P. 19/8/1991	DIAGRAM 89915	