

RESERVE ACTION SHEET - CONSERVATION RESERVES

RESERVE No. **42450**

REASON FOR ACTION

- Regazettal of a class 'C' nature reserve vested in the NPNCA for the purpose of "Conservation of Flora and Fauna" Area: 10962.2166 ha
- **There has been no change to the boundaries or area of this reserve.** Regazettal was required to correct the reserve description by including Land Administration Plan 1709, (omitted from the gazettal notice when the addition of Swan Location 10501 was published in the Government Gazette of 15 November 1996.)
- Gazettal date: 20 - 1 - 1998 See folios 94 and 95
- Plans at folios 83 and 84

	OFFICER	ACTION
1	RESERVES <i>SC</i>	<ul style="list-style-type: none"> - Fill in above details _____ - Attach copies of gazettal notices to file _____
2	INDEX CLERK, RECORDS	<ul style="list-style-type: none"> - Index reserve's name _____ - Index reserve's number _____
3	RESERVES CLERK <i>SC</i>	Send copies of gazettal notices and Map to: <ul style="list-style-type: none"> - Clerk, Woodvale _____ - District Manager, Perth _____ - Regional Manager, Swan _____
4	CONSERVATION ESTATE OFFICER	To note: <i>Sharon Colliss 16.2.98</i>
5	LAND ACQUISITIONS OFFICER	To note:
6	MANAGER, PLANNING & VISITOR SERVICES	To note:
7	DIRECTOR, NATURE CONSERVATION/ NATIONAL PARKS	To note:

LA801*

LAND ACT 1933
AMENDMENT OF RESERVE

Made by His Excellency the Governor under Section 37.

The following reserves have been amended

DOLA File: 00586-1983-01RO.

Reserve No: 38259 (Murray District) "Water Supply" to comprise Location 2073 on Land Administration Diagram 93287 in lieu of Location 1772 and of its area being reduced to 271 square metres accordingly.

Public Plan/s: BG32 (2) 01.28 off Wilderness Drive

Local Authority: City of Mandurah.

DOLA File: 01836-1976-01RO.

Reserve No: 874 (Kojonup District) "Water Supply" to comprise Locations 9333 and 9334 as surveyed and shown bordered red on Land Administration Diagram 93270 in lieu of Location 9208 and of its area being increased to 53.1235 hectares accordingly.

Public Plan/s: Boscabel NW (25) Albany Highway

Local Authority: Shire of Woodanilling.

DOLA File: 03542-1907-01RD.

Reserve No: 1549 (Avon District) "Stopping Place for Travellers and Stock" to comprise Location 29219 on Diagram 82088 and of its area remaining unaltered.

Public Plan/s: Grass Valley SE (25) Parker Road

Local Authority: Shire of Northam.

DOLA File: 02998-1918-01RO.

Reserve No: 1862 (Williams District) "Resting Place for Travellers and Stock" to comprise Location 15886 on Land Administration Diagram 17211 and of its area remaining unaltered.

Public Plan/s: Highbury SW (25) Piesseville Tarwonga Road

Local Authority: Shire of Wagin.

DOLA File: 01585-1990-01RO.

Reserve No: 2434 (at Esperance) "Police Purposes" to comprise Lot 933 as surveyed and shown bordered red on Land Administration Diagram 93319 in lieu of Town Lot 29 and of its area being increased to 6006 square metres accordingly.

Public Plan/s: CG29 (2) 16.13 off Norfolk Lane

Local Authority: Shire of Esperance.

DOLA File: 05412-1897-02RO.

Reserve No: 4768 (at Perth) "Kindergarten and Infant Health Clinic" to comprise Lot 1092 as surveyed and shown bordered green on Land Administration Diagram 93384 in lieu of Lot 402 and of its area being increased to 1828 square metres accordingly.

Public Plan/s: BG34 (2) 13.22 Labouchere and Mill Point Roads

Local Authority: City of South Perth.

DOLA File: 07888-1901-01RO.

Reserve No: 7999 (Kalgoorlie Town Lot 1312) "Municipal" to include the area containing 88 square metres being portion of the land as delineated and shown bordered green on Land Administration Diagram 92922 and of its area being increased to 2326 square metres accordingly.

Public Plan/s: CF37 (2) 29.38 Croesus and Brookman Streets

Local Authority: City of Kalgoorlie-Boulder.

DOLA File: 06685-1906-02RO.

Reserve No: 10428 (Coolup Townsite) "Railway" to comprise Lot 191 on Land Administration Reserve Diagram 1460 in lieu of Lot 161 and of its area being reduced to 14.7752 hectares accordingly.

Public Plan/s: Coolup Townsite Fawcett Street

Local Authority: Shire of Murray.

DOLA File: 05212-1907-01RO.

Reserve No: 10955 (Kojonup District) "Recreation" to comprise Locations 9336, 9337 and 9338 as surveyed and shown bordered red on Land Administration Plan 19620 in lieu of Location 9292 and of its area being increased to 15.7209 hectares accordingly.

Public Plan/s: Martinup SW (25) Pallinup Road

Local Authority: Shire of Broomehill.

DOLA File: 06800-1900-01RO.

Reserve No: 11034 (at Kojonup) "Police" to comprise Lot 345 as surveyed and shown bordered red on Land Administration Diagram 93269 in lieu of Lot 129 and of its area being reduced to 3275 square metres accordingly.

Public Plan/s: BJ29 (2) 10.16. Vanzuilecom Street

Local Authority: Shire of Kojonup.

DOLA File: 02487-1992-01RO.

Reserve No: 42450 (Swan District) "Conservation of Flora and Fauna and Water" to comprise Locations 1993, 3461, 3470, 3471, 3472, 3527, 3529, 3531, 3533 to 3542 inclusive, 3555, 3556, 3560 to 3581 inclusive, 3587, 3627 to 3642 inclusive, 3660, 3661, 3662, 3668 to 3671 inclusive, 9370, 11619 and 11620 on Land Administration Miscellaneous Plan 1709 and Location 10501 as surveyed and shown bordered red on Land Administration Plan 19172 and of its area being established at 10962.2166 hectares accordingly.

Public Plan/s: Moore River NE & SE (25), Gingin NW (25) Duffy Road

Local Authority: Shire of Gingin.

DOLA File: 01477-1994-01RO.

Reserve No: 43690 (Murray Locations 1958 and 1905) "Conservation Park" to include Location 1987 (on LTO Plan 16556) and of its area being increased to 66.5244 hectares accordingly.

This Reserve is automatically vested in the National Parks and Nature Conservation Authority pursuant to Section 7 of the CALM Act 1984.

Public Plan/s: BG33 (2) 3.36 and 4.36 Silverton Crescent

Local Authority: City of Mandurah.

DOLA File: 02786-1996-01RO.

Reserve No: 44846 (Swan Location 12685) "Public Recreation" to include Location 12805 (formerly Lot 1291 on Plan 21830) and of its area being increased to 1.5849 hectares accordingly.

Public Plan/s: BG35 (1) 38.04 and 38.05 Sherbrooke Retreat and Daintree Loop

Local Authority: Shire of Swan.

DOLA File: 01853-1997-01RO.

Reserve No: 45095 (At Margaret River) "Public Recreation" to comprise Lot 266 (formerly Lot 121 on Plan 21818) in Lieu of Sussex Location 5118 and of its area remaining unaltered.

Public Plan/s: BF29 (2) 10.02 Waters Edge Boulevard

Local Authority: Shire of Augusta/Margaret River.

A. A. SKINNER, Chief Executive.

LA901

LAND ACT 1933

CHANGE OF PURPOSE OF RESERVES

Made by His Excellency the Governor under Section 37.

The purposes of the following reserves have been changed

DOLA File: 01836-1976-01RO.

Reserve No. 874 (Kojonup Locations 9333 and 9334) being changed from "Water Supply" to "Parklands and Recreation".

Public Plan/s: Boscabel NW (25) Albany Highway

Local Authority: Shire of Woodanilling.

DOLA File: 03542-1907-01RD.

Reserve No. 1549 (Avon Location 29219) being changed from "Stopping Place for Travellers and Stock" to "Landscape Protection".

Public Plan/s: Grass Valley SE (25) Parker Road

Local Authority: Shire of Northam.

DOLA File: 02998-1918-01RO.

Reserve No. 1862 (Williams Location 15886) being changed from "Resting Place for Travellers and Stock" to "Landscape Protection".

Public Plan/s: Highbury SW (25) Piesseville Tarwonga Road

Local Authority: Shire of Wagin.

DOLA File: 01585-1990-01RO.

Reserve No. 2434 (Esperance Lot 933) being changed from "Police Purposes" to "Police".

Public Plan/s: CG29 (2) 16.13 off Norfolk Lane

Local Authority: Shire of Esperance.

DOLA File: 05412-1897-02RO.

Reserve No. 4768 (Perth Lot 1092) being changed from "Kindergarten and Infant Health Clinic" to "Use and Requirements of the City of South Perth".

Public Plan/s : BG34 (2) 13.22 Labouchere and Mill Point Roads

Local Authority: City of South Perth.

107 CLERK WOODVILLE FOR YOUR RECORDS

DOLA File 564/989.

Reserve No. 40895 (Lancelin Lots 806 and 815) "Drainage" to exclude Lot 815 and of its area being reduced to 136 square metres accordingly.

Public Plan: BF37 (2) 21.06. Ayres Crescent.

Local Authority—Shire of Gingin.

DOLA File 2056/989.

Reserve No. 41128 (Southern Cross Lot 943) "Sewage Treatment Plant" to exclude that portion containing 1.4162 hectares now comprised in Lot 955 and the area shown coloured mid brown containing 426 square metres on Land Administration Diagram 92141 and of its area being reduced to 9895 square metres accordingly.

Public Plans: BM36 (2) 18.24 and 19.24. Antares Street.

Local Authority—Shire of Yilgarn.

DOLA File 887/992.

Reserve No. 42259 (Swan Location 11753) to include Swan Location 12561(formerly Lot 102 on Diagram 88448) and of its area being increased to 2190 square metres accordingly.

Public Plan: BG34 (2) 24.31. Buckingham Road.

Local Authority—Shire of Mundaring.

DOLA File 1253/992.

Reserve No. 42368 (Wellington Locations 5625 and 5680) "Public Recreation" to include Eaton Lots 1 and 2 (formerly Lots 291 and 292 on Plan 20885) and of its area being increased to 3.1368 hectares accordingly.

Public Plan: BG30 (2) 5.33. Pecan Lane.

Local Authority—Shire of Dardanup.

DOLA File 2487/992.

Reserve No. 42450 (Swan Locations 1993, 3461, 3470, 3471, 3472, 3527, 3529, 3531, 3533 to 3542 inclusive, 3555, 3556, 3560 to 3581 inclusive, 3587, 3627 to 3642 inclusive, 3660, 3661, 3662, 3668 to 3671 inclusive, 9370, 11619 and 11620) "Conservation of Flora and Fauna and Water" to include Location 10501 as surveyed and shown bordered red on Land Administration Plan 19172 and of its area being increased to 10 962.2166 hectares accordingly.

Public Plan: Moore River NE and SE, Gingin NW and SW (25).

Local Authority—Shire of Gingin.

Reserve 42450 is automatically vested in the National Parks and Nature Conservation Authority pursuant to Section 7 of CALM Act 1984.

DOLA File 1816/992

Reserve No. 42562 (Canning Locations 3812 and 3827) to include Canning Location 4091 (formerly Lot 138 on Plan 18813) and its area being increased to 9666 square metres accordingly.

Public Plan: BG34 (2) 14.14. Stringfellow Drive.

Local Authority—City of Melville.

DOLA File 1856/990.

Reserve No. 42674 (Swan Location 11392) "Public Utilities Services" to include Location 12563 (formerly Lot 301 on Diagram 77916) and of its area being increased to 9273 square metres accordingly.

Public Plans: BG 35 (2) 07.09 and 07.10. Burns Beach Road and Curran Court.

Local Authority—City of Wanneroo.

DOLA File 2397/992.

Reserve No. 42746 (Swan Location 11842) "Public Recreation" to include Location 12555 (formerly Lot 1068 on Plan 20804) and of its area being increased to 1.7253 hectares accordingly.

Public Plan: BG 35 (2) 09.04. Parkwood Avenue.

Local Authority—City of Wanneroo.

DOLA File 1564/993.

Reserve No. 42876 (Denmark Lot 1052) "Public Recreation" to include Lot 1076 (formerly Lot 20 on Diagram 90215) and of its area being increased to 588 square metres accordingly.

Public Plan: BJ26 (2) 21.13. near Scotsdale Road.

Local Authority—Shire of Denmark.

DOLA File 1371/995.

Reserve No. 43542 (Victoria Location 12056) "Public Recreation" to include Location 12103 (formerly Lot 140 on Diagram 87571) and of its area being increased to 1916 square metres accordingly.

Public Plan: BE42 (2) 35.03. Brand Highway.

Local Authority—Shire of Irwin.

DOLA File 2359/994.

Reserve No. 43662 (Cockburn Sound Locations 4136, 4137, 4138, 4144 and 4145) "Public Recreation" to include Location 4227 (formerly Lot 43 on Plan 20558 and Lot 44 on Plan 20559) and of its area being increased to 2.8283 hectares accordingly.

Public Plans: BG34 (2) 10.09, 11.09 and 11.10. Forrest Road and Marshwood Retreat.

Local Authority—City of Cockburn.

DEPARTMENT OF CONSERVATION AND LAND MANAGEMENT
21 NOV 1996
COMO, W.A.

1. AITE
2. N ^{MR} Swan
3. Mr. Collins - for
for the site
St 17.12.96

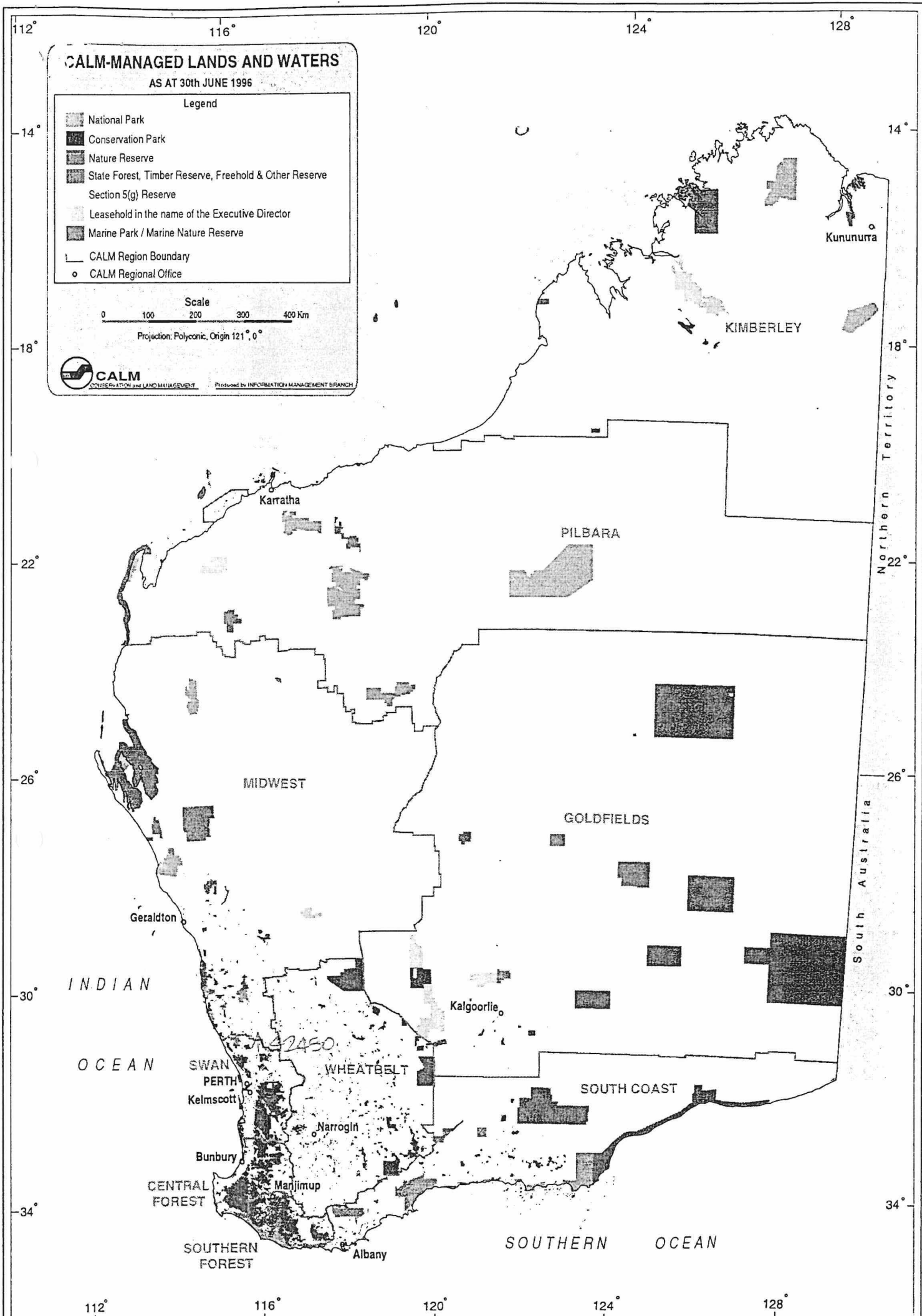

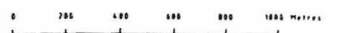
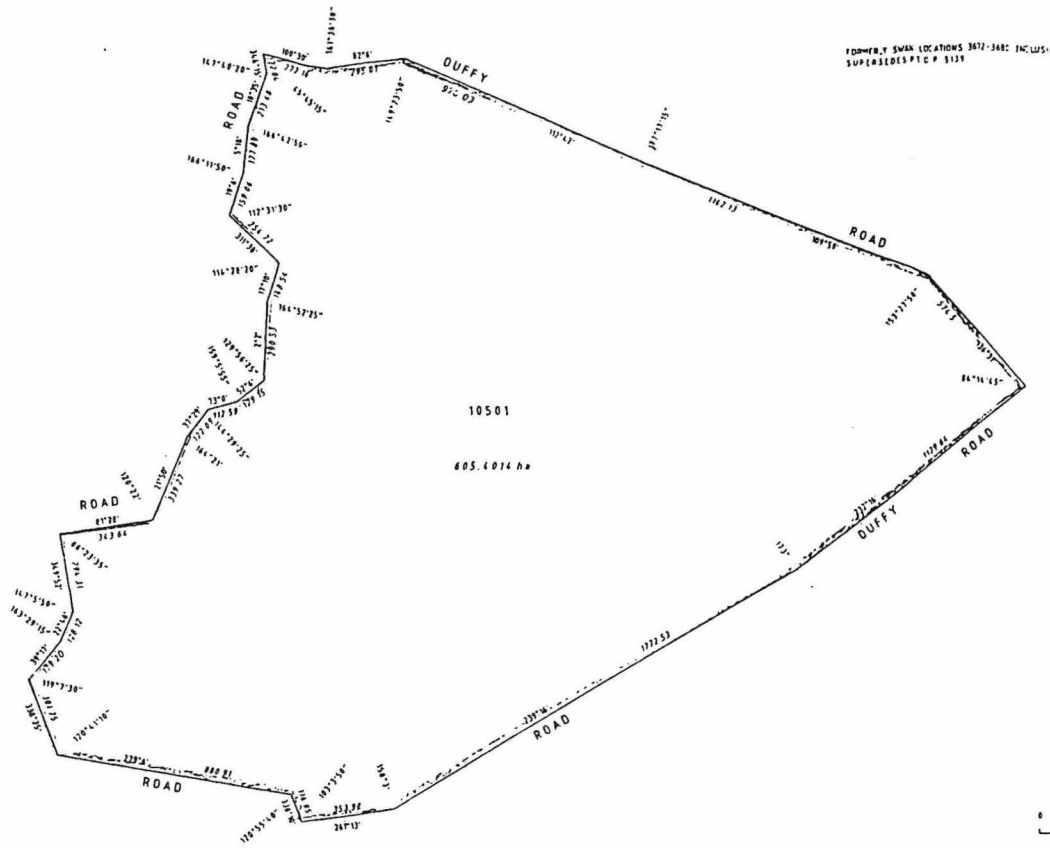

I, GLEGE hereby certify that:
 (a) this plan of survey is a correct and accurate representation of this survey for the subject land; and
 (b) this plan conforms with the relevant law in relation to which it is lodged.

TERMS OF PLAN
 DATE _____
 GLEGE
 SURVEYOR

COMPILED FROM P.C.P. 5133

G. I. COLE & ASSOCIATES PTY LTD
 Lic. Land Surveyors
 Pty. Surveyors
 Level 3, 11 Progress Road
 Mandurah WA 6210

LAND DISTRICT SWAN		LOCATION 10501			
SURVEYOR'S CERTIFICATE				SCALE: 1:10000	FILE: 1917/172
<small>1. I hereby certify that: (a) this plan of survey is a correct and accurate representation of this survey for the subject land; and (b) this plan conforms with the relevant law in relation to which it is lodged. I, GLEGE, Surveyor, hereby certify that: (a) this plan of survey is a correct and accurate representation of this survey for the subject land; and (b) this plan conforms with the relevant law in relation to which it is lodged.</small>				DATE OF SURVEY	DATE OF PLAN
				DATE OF PLAN	DATE OF PLAN
PLAN CORRECTED CORRECT				SHIRE OF GUNDA	DEPARTMENT OF LAND ADMINISTRATION
				PLAN 19172	

PLAN 19172
 DEPT. OF LAND ADMINISTRATION

**RESERVE GAZETTAL ACTION SHEET
FOR REGIONS AND DISTRICTS**

LANDS CLERK: Attach a copy of a map and forward to the following:

1. REGIONAL MANAGER:
CENTRAL FOREST, MIDWEST, GOLDFIELDS, KIMBERLEY, SWAN REGION,
PILBARA, SOUTH COAST, SOUTHERN FOREST, WHEATBELT
2. DISTRICT MANAGER: PERTH
3. DISTRICT WILDLIFE OFFICER: PERTH
4. CLERK WOODVALE
5. O.I.C. INVENTORY BUNBURY/KELMSCOTT/MANJIMUP

REASON FOR GAZETTAL:

Creation of Class 'c' nature reserve as a result of
implementation of EPA System 6 recommendation
M5.

RESERVE NUMBER: 42950

CALM FILE NUMBER: 033729F3102.

NAME OF RESERVE: -

PURPOSE: Conservation of Flora + Fauna + Water

CLASS: 'c'

AREA: 10,356.8 ha

VESTING: NPNCA

DATE OF CURRENT GAZETTAL: 18.12.92

MAP REFERENCE: YANCHEP 1:50,000

SHIRE: GENGEN

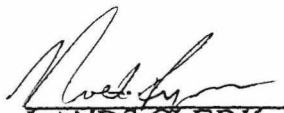
LANDS CLERK
09 367 0221

3395430.

20.5.93.
DATE

DOLA File: 1505/992

Reserve No. 42306 comprising Murray Location 1900 (formerly portion of Murray Location 66 and being Lot 1283 on Plan 16723) with an area of 7 277 square metres for the designated purpose of "Public Recreation" section 20A.

Public Plan: BG32 (2) 04.39 Peelwood Parade.

Local Authority—City of Mandurah.

DOLA File: 4533/919

Reserve No. 42418 comprising Cue Lot 625 with an area of 1 841 square metres on Land Administration Diagram 90797 for the designated purpose of "Use and Requirements of the Western Australian Mint".

Public Plan: BK47 (2) 16.06 Marshall and Railway Streets.

Local Authority—Shire of Cue.

DOLA File: 1485/964

Reserve No. 42435 comprising Canning Location 3797 with an area of 1.401 7 hectares on Land Administration Diagram 90686 for the designated purpose of "Use and Requirements of the Minister for Works".

Public Plan: BG34 (2) 18.18 Cecil Avenue.

Local Authority—City of Canning.

DOLA File: 11469/906

Reserve No. 10837 comprising Brunswick Estate Lot 41 with an area of 11.210 3 hectares on Land Administration Plan 18035 for the designated purpose of "Drain".

Public Plans: BG31 (10) 2.1, 3.1 Marriott Road.

Local Authority—Shire of Harvey.

DOLA File: 1845/984

Reserve No. 42438 comprising Bulga Location 7 with an area of 1.439 5 hectares on Land Administration Diagram 88017 for the designated purpose of "Repeater Station Site".

Public Plan: Youanmi (250).

Local Authority—Shire of Sandstone.

DOLA File: 1028/982

Reserve No. 42452 comprising Swan Location 11687 with an area of 1 378 square metres on Land Administration Diagram 90888 for the designated purpose of "Use and Requirements of the Minister for Works".

Public Plan: BG34 (2) 14.37 Henniker Way.

Local Authority—City of Wanneroo.

DOLA File: 5361/949

Reserve No. 42451 comprising De Grey Location 16 with an area of 173.182 7 hectares on Land Administration Miscellaneous Plan 1503 for the designated purpose of "Aerodrome".

Public Plan: Nullagine (250).

Local Authority—Shire of East Pilbara.

DOLA File: 3269/989

Reserve No. 41824 comprising Dampier Location 235 with an area of 17.839 1 hectares on Land Administration Diagram 88670 for the designated purpose of "Water Supply and Campsite".

Public Plan: Broome 1:250 000 Great Northern Highway.

Local Authority—Shire of Broome.

DOLA File: 2487/92

Reserve No. 42450 comprising Swan Locations 1993, 3527, 3529, 3531, 3533 to 3542 inclusive, 3555, 3556, 3560 to 3581 inclusive, 3587, 3627 to 3642 inclusive, 3660, 3662, 3668 to 3671 inclusive, 9370, 11619 and 11620 with an area of 10 356.815 2 hectares on Land Administration Miscellaneous Plan 1709 for the designated purpose of "Conservation of Flora and Fauna and Water".

Public Plans: Moore River NE and SE 1:25 000 Gingin NW and SW 1:25 000 Yeal Nature Reserve.

Local Authority—Shire of Gingin.

Reserve 42450 is automatically vested in the National Parks and Nature Conservation Authority pursuant to section 7 of CALM Act 1984.

DOLA File: 2502/992

Reserve No. 42454 comprising Tammin Lots 162, 163 and 164 with an area of 2 529 square metres on Land Administration Diagram 90927 for the designated purpose of "Use and Requirements of the Minister for Works".

Public Plan: Tammin Townsite Ridley Street.

Local Authority—Shire of Tammin.

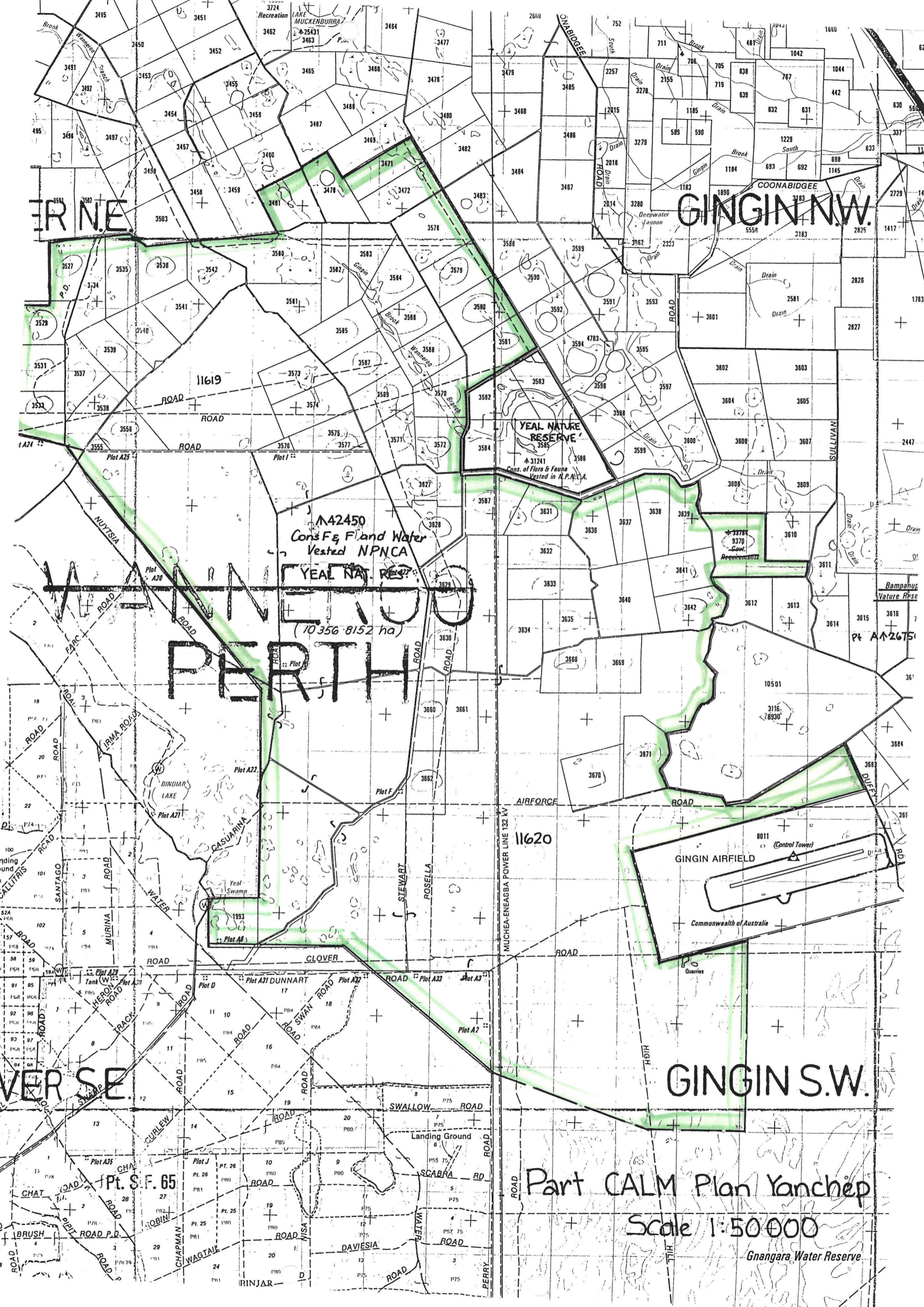

IR N.E.

GINGIN N.W.

PERTH

GINGIN S.W.

M42450
Cons Fg & Flood Water
Vested NPNC

YEAL NAT RES
(10 356 8152 ha)

YEAL NATURE RESERVE
Cons. of Flora & Fauna
Vested in R.P.N.C.A.

GINGIN AIRFIELD

Part CALM Plan Yanchep

Scale 1:50 000

Gningara Water Reserve

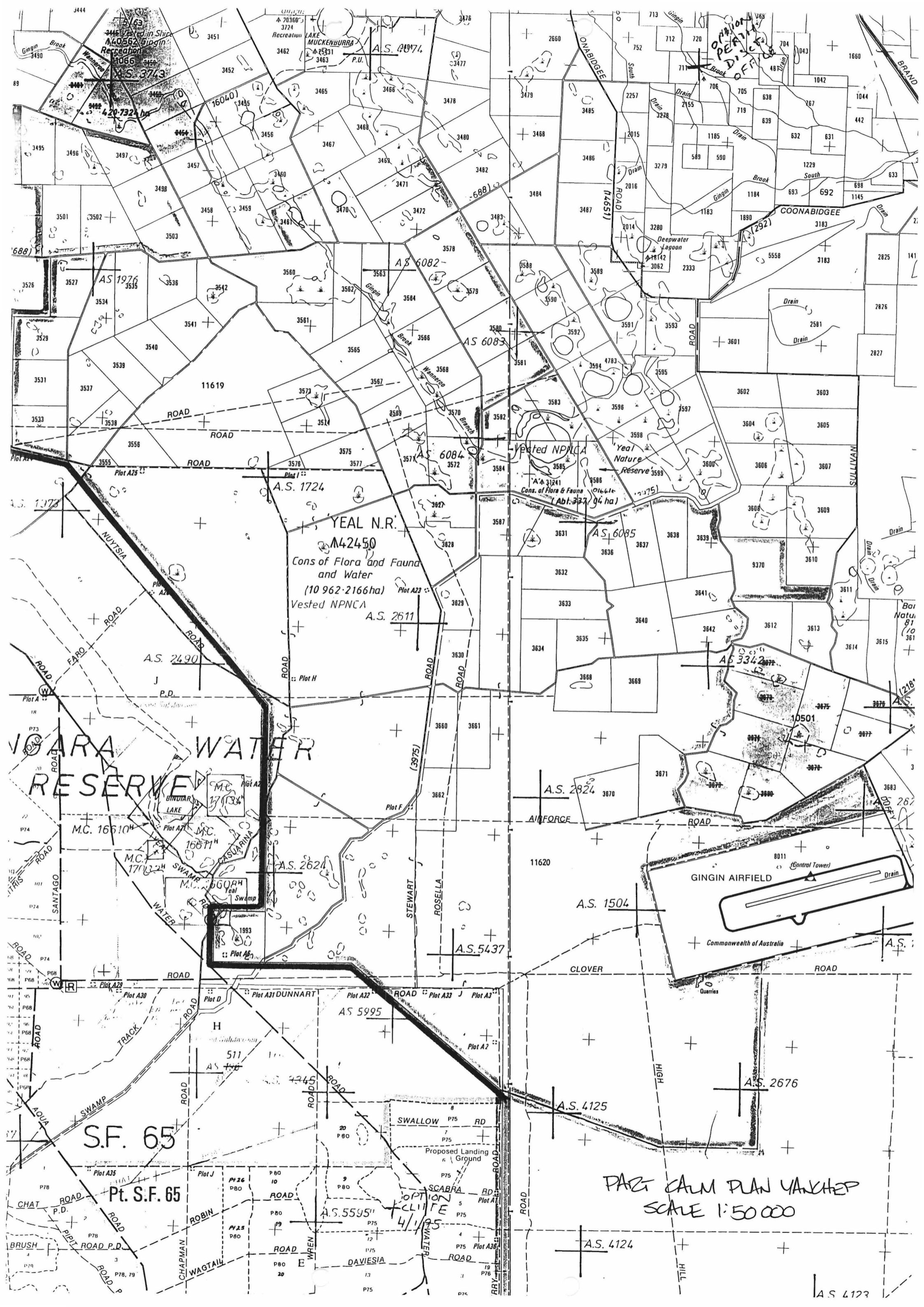

OPTIONAL
OPERATING
OFFICE

YEAL N.R.
M42450
Cons of Flora and Fauna
and Water
(10 962-2166 ha)
Vested NP/CA
A.S. 2611

YARRA WATER
RESERVE

GINGIN AIRFIELD
Control Tower
Commonwealth of Australia

PART C&M PLAN YANCHER
SCALE 1:50 000

S.F. 65

Pt. S.F. 65

OPTION
CLIFFE
4/1/95

A.S. 4123