

**RESERVE GAZETTAL ACTION SHEET
FOR REGIONS AND DISTRICTS**

LANDS CLERK: Attach a copy of map and forward to the following:

1. REGIONAL MANAGER:
CENTRAL FOREST, GREENOUGH, GOLDFIELDS, KIMBERLEY, SWAN REGION, PILBARA,
SOUTH COAST, SOUTHERN FOREST, WHEATBELT
2. DISTRICT MANAGER: _____
3. CLERK, WOODVALE
4. O.I.C. INVENTORY BUNBURY / KELMSCOTT / MANJIMUP
5. DISTRICT WILDLIFE OFFICER: _____

REASON FOR GAZETTAL:

Creation of reserve (class C, Cons. of Flora and Fauna)
following donation from private source.

RESERVE DETAILS

RESERVE NUMBER: 42815
CALM FILE NUMBER: 015636F 3102
MAP REFERENCE: YUNA 1941 III SE (25)
SHIRE: CHAPMAN VALLEY

CHANGES MADE AT GIVEN GAZETTAL DATE

NAME OF RESERVE: _____
PURPOSE: Conservation of Flora and Fauna
CLASS: C
AREA: 722.92 Ha
VESTING: NPNCA
DATE AND PAGE NO. OF CURRENT GAZETTAL: 24/8/93; 4567

BZ.
LANDS CLERK

334
(09) ~~367~~ 0221

2/3/94
DATE

VK 9/3/94.

LA302

LAND ACT 1933
LAND (CROWN GRANT IN TRUST) ORDER

DOLA File 1648/962.

Made by His Excellency the Governor under Section 33 (4).

It is directed that Reserve No. 27010 (Swan Location 11672) shall be granted to the Western Australian Fire Brigades Board to be held in trust for the designated purpose of "Fire Station Site" subject to the condition that the grantee shall not transfer, lease or mortgage the whole or any part of the land without the consent of the Governor.

Local Authority: City of Nedlands.

D. G. BLIGHT, Clerk of the Council.

LA401

LAND ACT 1933
ONSLOW TOWNSITE
Amendment of Boundaries

DOLA File 6281/922V5.

His Excellency the Governor in Executive Council has been pleased to approve, under section 10 of the Land Act 1933 of the amendment of the boundaries of Onslow Townsite to include the area described in the Schedule hereunder.

Schedule

All that portion of land the subject of Land Administration Plan 17908.

Public Plan: BE63 (2) 38.05.

A. A. SKINNER, Chief Executive.

LA701

LAND ACT 1933
RESERVATION NOTICES

Made by His Excellency the Governor under Section 29.

The Crown Lands described below have been set apart as public reserves.

DOLA File: 3351/988.

Reserve No. 42256 comprising Plantagenet Locations 2259, 6820, 7419, 7682, 7711 and 7712 on Land Administration Reserve Plan 370 and Location 7746 (formerly portion of Plantagenet Location 466 and being Lots 6 and 7 the subject of Diagram 79397) with an area of about 326.2317 hectares for the designated purpose of "Recreation and Drainage".

Public Plans: Torbay NE and SE (25).

Local Authority—Shire of Albany.

DOLA File: 164/971.

Reserve No. 42629 comprising Swan Location 11853 (formerly portion of each of Swan Locations V and 8815 and being Lot 23 on Plan 18155 and portion of Location 8605) with an area of 6234 square metres on Land Administration Diagram 90997 for the designated purpose of "Public Recreation". Section 20A.

Public Plan: BG34 (2) 13.32 Glanton Way.

Local Authority—City of Stirling.

DOLA File: 689/992.

Reserve No. 42815 comprising Victoria Location 11931 (formerly Victoria Location 6832 and portion of each of Victoria Locations 6835 and 6836) with an area of 722.9283 hectares on Land Administration Plan 18247 for the designated purpose of "Conservation of Flora and Fauna".

Public Plan: Yuna 1941 III SE (25). McGausan Road.

Local Authority—Shire of Chapman Valley.

Reserve 42815 is automatically vested in the National Parks and Nature Conservation Authority pursuant to Section 7 of CALM Act 1984.

*Copy passed to Nat. Parks, Glendon
with the former title of reserve from which a reserve diagram
is to be taken. A copy is attached.*

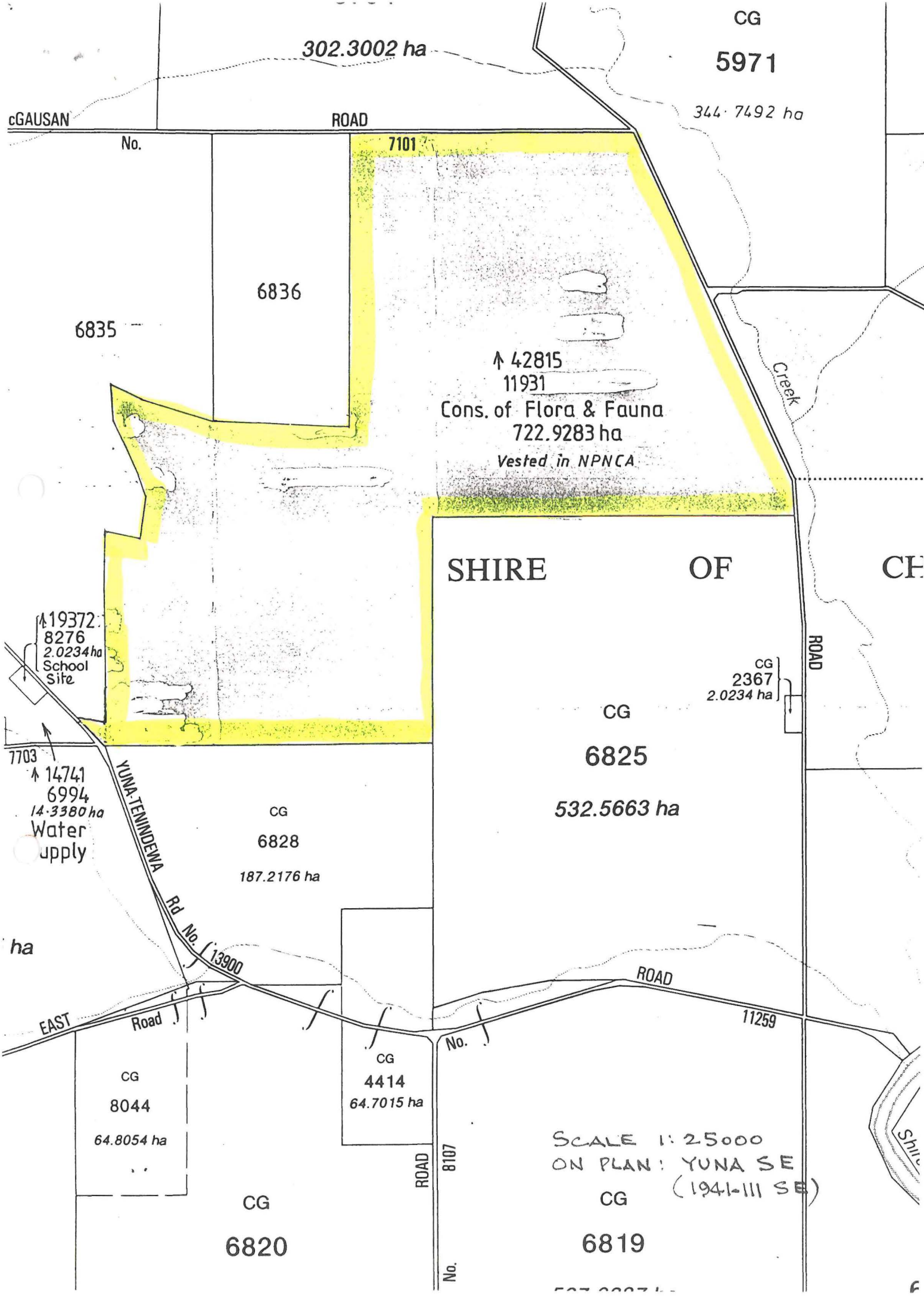

302.3002 ha

CG

5971

344.7492 ha

cGAUSAN

ROAD

No.

7101

6836

6835

↑ 42815
11931

Cons. of Flora & Fauna
722.9283 ha
Vested in NPNCA

Creek

SHIRE

OF

CHILTERN

↑ 19372
8276
2.0234 ha
School Site

CG
2367
2.0234 ha

ROAD

CG

6825

532.5663 ha

CG

6828

187.2176 ha

7703

↑ 14741
6994
14.3380 ha
Water supply

YUNA-TENNEDWA Rd. No. 13900

ha

EAST

Road

CG

8044

64.8054 ha

CG

4414

64.7015 ha

ROAD

No. 8107

No.

ROAD

11259

CG

6820

SCALE 1:25000
ON PLAN: YUNA SE
(1941-III SE)

CG

6819

Shire

AA102

LAND ACT 1933
CANCELLATION OF "B" CLASSIFICATION
PROCLAMATION

WESTERN AUSTRALIA } By His Excellency Major General Philip Michael
 P. M. Jeffery, Governor. } Jeffery, Officer of the Order of Australia, Military
 [L.S.] } Cross, Governor of the State of Western
 Australia.

DOLA File: 2101/976.

Under section 31 (2) of the Land Act 1933, I, the Governor acting with the advice and consent of the Executive Council, hereby cancel as of Class "B" Reserve No. 1091 (Guildford Lot 186) for the designated purpose of "Government Requirements".

Given under my hand and the Seal of the State on 2 August 1994.

By His Excellency's Command,

GEORGE CASH, Minister for Lands.

GOD SAVE THE QUEEN !

AA103

LAND ACT 1933
CLASSIFICATION OF RESERVED LANDS
PROCLAMATION

WESTERN AUSTRALIA } By His Excellency Major General Philip Michael
 P. M. Jeffery, Governor. } Jeffery, Officer of the Order of Australia, Military
 [L.S.] } Cross, Governor of the State of Western
 Australia.

DOLA File: 689/992.

Under section 31 (1) (a) of the Land Act 1933, I, the Governor acting with the advice and consent of the Executive Council, hereby classify as of Class "A" Reserve No. 42815 comprising Victoria Location 11931 with an area of 722.9283 hectares for the designated purpose of "Conservation of Flora and Fauna".

Local Authority—Shire of Chapman Valley.

Given under my hand and the Seal of the State on 2 August 1994.

By His Excellency's Command,

GEORGE CASH, Minister for Lands.

GOD SAVE THE QUEEN !

CONSERVATION AND LAND MANAGEMENT

CM401

CONSERVATION AND LAND MANAGEMENT ACT 1984
DEPARTMENT OF CONSERVATION AND LAND MANAGEMENT
Montebello Islands Conservation Park

Compatible Operations Notice

Call for public submissions on the intention to issue licences/leases for tourist and commercial recreation operations in Montebello Islands Conservation Park

This notice is made by the Executive Director of the Department of Conservation and Land Management under section 33A of the Conservation and Land Management Act 1984 with reference to compatible operations.

As a management plan does not exist for the Montebello Islands Conservation Park, the CALM Act 1984 requires the Department to notify the public of intentions to conduct "compatible operations" and seek comment on those operations.

The Department of Conservation and Land Management has been approached by tourist operators for approval to operate tourist services and facilities in the Montebello Islands Conservation Park.

The Department intends to call for "Expressions of Interest" by commercial operators to offer a variety of tourist services and facilities that will enhance public enjoyment whilst protecting the environmental integrity of the Park.

Submissions are invited until 6 October 1994. Please do not submit proposals for tourist and commercial operations at this time.

People wishing to make submissions should obtain the "Guide to Submissions" by contacting Denise Hamilton, Department of CALM, Pinnacle House, 16 Ogilvie Road, Mt Pleasant 6153, telephone (09) 364 0777, or Chris Muller, Department of CALM, SGIO Building, Welcome Road, Karratha 6714, telephone (091) 86 8288.

SYD SHEA, Executive Director,
 Department of Conservation and Land Management.

Clark Woodvale FYI.

1. Sharon Colliss - to note above and for plan amendment sheets.

2. Rebecca Clark - for action sheet.

6794

CG

302.3002 ha

5971

GAUSAN

ROAD

344.7492 ha

No.

71017

6836

6835

A ↑ 42815
11931

Cons. of Flora & Fauna
722.9283 ha
Vested in NPNCA

Creek

SHIRE OF CH

↑ 19372
8276
2.0234 ha
School Site

CG
2367
2.0234 ha

CG

6825

532.5663 ha

7703
↑ 14741
6994
3380 ha
Water Supply

CG

6828

187.2176 ha

ha

YUNA TENDEWA Rd No. 13900

13900

EAST

Road

ROAD

11259

CG

8044

64.8054 ha

CG

4414

64.7015 ha

ROAD

8107

CG

6820

SCALE 1:25000
ON PLAN: YUNA SE
(1941-III SE)

CG

6819

No.

Stm