

2/9
D.C.

035946F4301

51
B.C.

DOLA File 1031/990.

Reserve No. 43095 comprising Kyarra Location 169 with an area of 1 600 square metres on Land Administration Diagram 90943 for the designated purpose of "Regenerator Site".

Public Plan: Nannine Townsite. near Great Northern Highway.

Local Authority—Shire of Meekatharra.

DOLA File 2706/989.

Reserve No. 43098 comprising Kyarra Location 177 with an area of 3 046 square metres on Land Administration Diagram 90691 for the designated purpose of "Radio Communications Site".

Public Plan: Cue SE (25). Local Authority—Shire of Cue.

DOLA File 1496/994.

Reserve No. 43087 comprising Plantagenet Location 7233 with an area of 1 262.662 0 hectares on Land Administration Reserve Diagram 1200 for the designated purpose of "Landscape Protection".

Public Plans: Pallinup and Mount Groper (50). South Coast Highway. Local Authority—Shire of Albany.

DOLA File 2541/962.

Reserve No. 43099 comprising Fitzroy Location 279 with an area of 41 371.041 8 hectares on Land Administration Reserve Plan 421 for the designated purpose of "Conservation Park"

Public Plan: Lennard River (250). Local Authority—Shire of Derby-West Kimberley.

Reserve 43099 is automatically vested in the National Parks and Nature Conservation Authority pursuant to Section 7 of CALM Act 1984.

DOLA File 1019/961

Reserve No. 43100 comprising Fitzroy Location 280 with an area of 5 332 hectares on Land Administration Diagram 1261 for the designated purpose of "Conservation Park"

Public Plan: Noonkanbah (250). Local Authority—Shire of Derby-West Kimberley.

Reserve 43100 is automatically vested in the National Parks and Nature Conservation Authority pursuant to Section 7 of CALM Act 1984.

DOLA File 1214/994.

Reserve No. 43101 comprising Fitzroy Location 278 with an area of 7 967.392 4 hectares on Land Administration Reserve Diagram 1260 for the designated purpose of "Conservation Park"

Public Plan: Noonkanbah and Lennard River (250). Local Authority—Shire of Derby-West Kimberley.

Reserve 43101 is automatically vested in the National Parks and Nature Conservation Authority pursuant to Section 7 of CALM Act 1984.

A. A. SKINNER, Chief Executive.

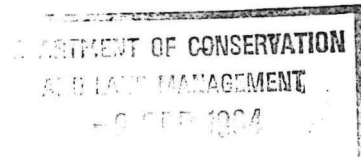

LA801

**LAND ACT 1933
AMENDMENT OF RESERVES**

Made by the Lieutenant-Governor and deputy of the Governor under Section 37.

The following reserves have been amended.

DOLA File: 1028/963.

Reserve No 27273 (Kununoppin Lot 215) "Hospital and Allied Purposes" to include Lot 212 and of its area being increased to 18.4132 hectares accordingly.

Public Plan: Kununoppin Townsite.

Local Authority—Shire of Trayning.

DOLA File: 3324/964V6.

Reserve No. 31165 (King Locations 373, 374, 380 and Luman Location 12) "Government Requirements" to exclude King Location 373 and of its area being reduced to about 128967 hectares accordingly.

Public Plans: Lissadell and Cambridge Gulf (250).

Local Authority—Shire of Wyndham-East Kimberley.

DOLA File: 2784/918.

Reserve No 17017 (Victoria District) "Water and Timber (Rabbit Dept.)" to comprise Location 11934 as shown delineated and bordered red on Land Administration Reserve Diagram 1085 and of its area being reduced (recalculated) to 254.0454 hectares accordingly.

Public Plan: Murgoo (250).

Local Authority—Shire of Yalgoo.

1. Records please file 2. Reserves Dept. 14.9.94

95

CHANGES IN RESERVE STATUS - JUNE 1994

GOVT. GAZETTE	RESERVE NO.	PURPOSE	NAME	SHIRE	RESULT OF GAZETTAL (i.e. change in vesting, purpose, area/cancellation, etc.)	REASON
28.6.94	43099	Conservation Park	(Devonian Reef)	Derby-West Kimberley	Creation of class "C" reserve for the purpose of "Conservation Park". Area: 41,371.04 ha. Vested NPNCA.	Result of excision from Fairfield, Brooking Springs and Kimberley Downs Stations.
28.6.94	43100	Conservation Park	(Geikie Gorge)	Derby-West Kimberley	Creation of class "C" reserve for the purpose of "Conservation Park". Area: 5332 ha. Vested NPNCA.	Result of excision from Brooking Springs Station.
28.6.94	43101	Conservation Park	(Brooking Gorge)	Derby-West Kimberley	Creation of class "C" reserve for the purpose of "Conservation Park". Area: 7,967.3 ha. Vested NPNCA.	Result of excision from Brooking Springs Station.

Parts Lennard River (SE 51-8)
 & Noonkanbah (SE 51-12)
 Scale 1:250 000

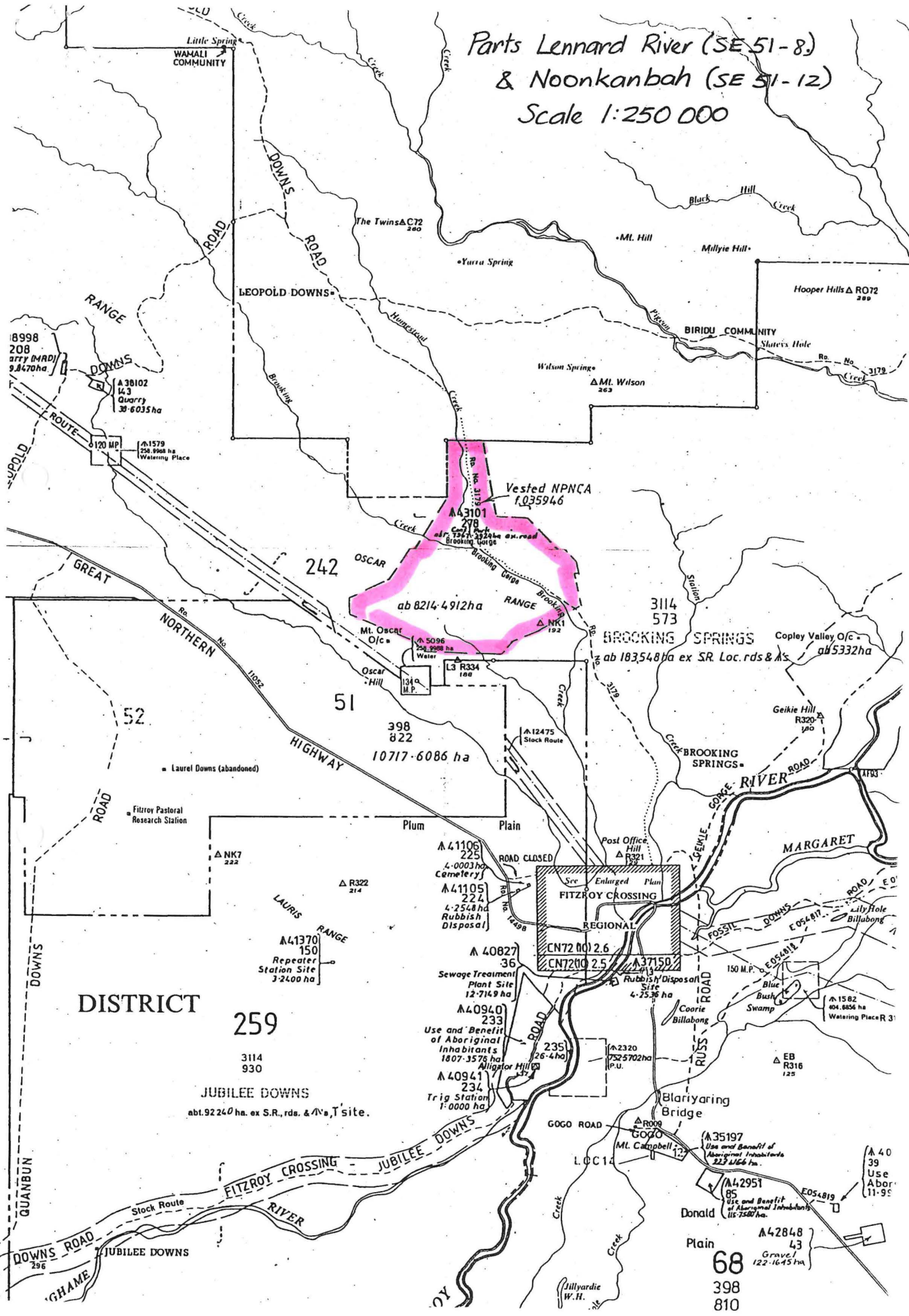

Vested NPNC
 1,035,946
 A43101
 278
 ab 8214.4912 ha
 Oscar Range

Enlarged Plan
 FITZROY CROSSING
 REGIONAL
 CN72(0) 2.6
 CN72(0) 2.5
 A37150

DISTRICT
 259
 3114
 930
 JUBILEE DOWNS
 abt. 92,240 ha. ex S.R., rds. & A's, T site.

Donald
 Plain
 68
 398
 810
 A42848
 43
 Gravel
 122.1645 ha
 A42951
 85
 Use and Benefit of
 Aboriginal Inhabitants
 115,750 ha
 A4039
 39
 Use
 Abor
 11,950 ha

A41106
 225
 4,0003 ha
 Cemetery
 A41105
 224
 4,2548 ha
 Rubbish
 Disposal
 A40827
 36
 Sewage Treatment
 Plant Site
 12,7149 ha
 A40940
 233
 Use and Benefit
 of Aboriginal
 Inhabitants
 1807,3576 ha
 Alligator Hill
 A40941
 234
 Trig Station
 1,0000 ha

A41370
 150
 Repeater
 Station Site
 3,2400 ha

A2320
 752,5702 ha
 P.U.
 Rubbish Disposal
 Site
 4,2536 ha

A1582
 404,8856 ha
 Watering Place R3

E054812
 E054811
 E054810

Blue
 Bush
 Swamp

EB
 R316
 125

E054819

A42848
 43
 Gravel
 122.1645 ha

A4039
 39
 Use
 Abor
 11,950 ha

A1582
 404,8856 ha
 Watering Place R3

A35197
 Use and Benefit of
 Aboriginal Inhabitants
 227,466 ha

A42951
 85
 Use and Benefit of
 Aboriginal Inhabitants
 115,750 ha

A42848
 43
 Gravel
 122.1645 ha

A4039
 39
 Use
 Abor
 11,950 ha

A1582
 404,8856 ha
 Watering Place R3