

DOLA File 2639/991.

Reserve No. 43274 comprising Leeman Lot 548 with an area of 747 square metres on Land Administration Plan 15429 for the designated purpose of "Use and Requirements of the Government Employees Housing Authority".

Public Plan: BE40 (2) 39.07.

Local Authority—Shire of Coorow.

DOLA File 2377/994.

Reserve No. 43286 comprising Williams Location 15841 with an area of 63.7241 hectares on Land Administration Reserve Diagram 1292 for the designated purpose of "Conservation of Flora and Fauna".

Public Plan: Kukerin SW (25). Rifle Range Road.

Local Authority—Shire of Dumbleyung.

Reserve 43286 is automatically vested in the National Parks and Nature Conservation Authority pursuant to Section 7 of CALM Act 1984.

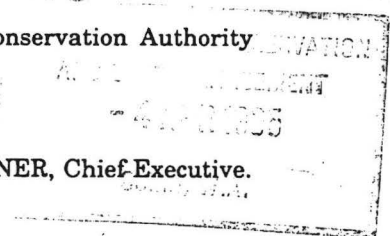
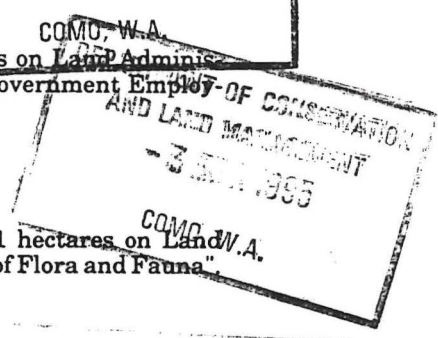

A. A. SKINNER, Chief Executive.

LA801

LAND ACT 1933
AMENDMENT OF RESERVES

Made by His Excellency the Governor under section 37.

The following reserves have been amended.

DOLA File 3621/915.

Reserve No. 865 (at Nannup) "Recreation and Tourist Information Centre" to comprise Lot 309 as surveyed on Land Administration Diagram 88339 in lieu of Lot 107 and of its area being reduced to 3986 square metres accordingly.

Public Plan: BG28 (2) 09.40. Brockman Street. Local Authority—Shire of Nannup.

DOLA File 2383/992.

Reserve No. 10638 (Victoria District) "Water Supply" to comprise Location 11981 as surveyed on Land Administration Diagram 91407 and of its area being increased (recalculated) to 18.2111 hectares accordingly.

Public Plan: Wongoondy (25) SW and SE. Off Depot Hill Road. Local Authority—Shire of Mingenew.

DOLA File 13983/911.

Reserve No. 14431 (Ninghan District) "Water" to comprise Location 4310 on Land Administration Plan 18620 and of its area being reduced to 2847 square metres accordingly.

Public Plan: BK42 (10) 10.11. Great Northern Road. Local Authority—Shire of Yalgoo.

DOLA File 1418/990.

Reserve No. 14972 (Ninghan Location 4245) "Water Supply" to exclude those portions now comprised in Location 4317 and portion of the road as shown coloured dark brown on Land Administration Plan 18620 and of its area being reduced to 33.5983 hectares accordingly.

Public Plan: BK42 (10) 10.11. Great Northern Road. Local Authority—Shire of Yalgoo.

DOLA File 6335/919 v3.

Reserve No. 17336 (Ninghan Location 660) "Common" to exclude those portions now comprised in Location 4317 and portion of the road as shown coloured dark brown on Land Administration Plan 18620 and of its area being reduced to 3759.0386 hectares accordingly.

Public Plan: BK42 (10) 10.11. Great Northern Road. Local Authority—Shire of Yalgoo.

DOLA File 1017/929.

Reserve No. 20333 (at Nannup) "Government Requirements (Forests Department)" to comprise Lot 308 on Land Administration Diagram 88339 in lieu of lots 215, 219 and 257 and of its area being increased to 2.1987 hectares accordingly.

Public Plan: BG28 (2) 09.40. Brockman Street. Local Authority—Shire of Nannup.

DOLA File 3241/982.

Reserve No. 38418 (Cockburn Sound Locations 2740 and 3099) "Public Recreation" to exclude that portion of Location 2740 now comprised in Location 4104 as surveyed on Land Administration Diagram 91940 and of its area being reduced to 8.2383 hectares accordingly.

Public Plan: BG33 (2) 07.24 Rand Avenue. Local Authority—City of Rockingham.

DOLA File 3282/980.

Reserve No. 42284 (Williams District) "Gravel" to comprise Location 15842 as shown delineated and bordered red on Land Administration Reserve Diagram 1291 in lieu of Locations 15818 and 15819 and of its area being reduced to 19.8349 hectares accordingly.

Public Plan: Kukerin SW (25). Rifle Range Road. Local Authority—Shire of Dumbleyung.

1. *file.*
2. *MRR*
3. *M.S. Collins - for letter etc. thanks MRR*

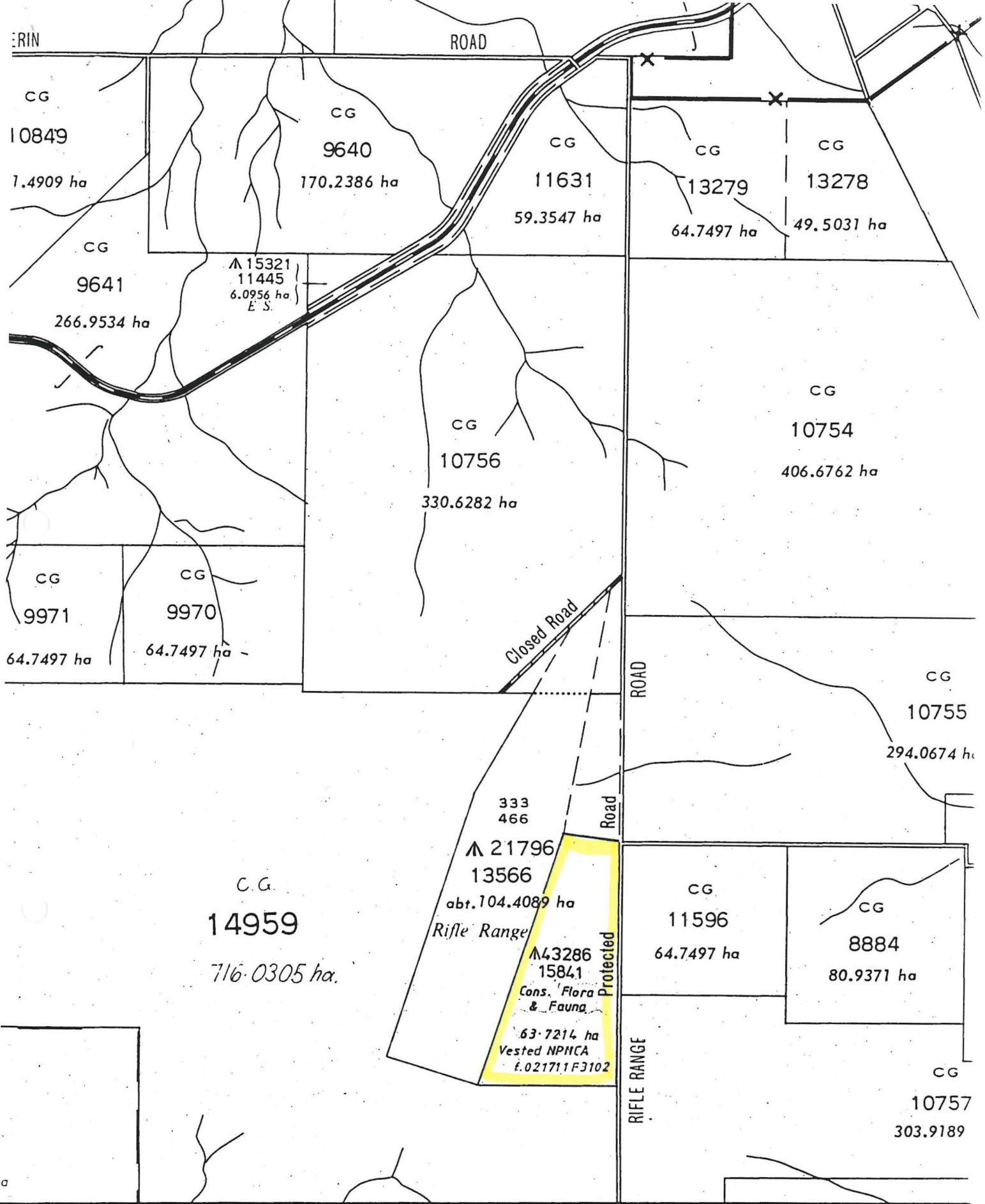

Part Kukerin SW (2531-1VSW)

Scale 1:25 000

600 000 mE

05