

DOLA

Department of LAND ADMINISTRATION

033698F#30P

145



MIDLAND SQUARE, MIDLAND
WESTERN AUSTRALIA
Postal Address: PO Box 2222
Midland, Western Australia 6056

Your Ref: 033698F4304

Our Ref: 1477/1994

Telephone: 273 7286

Enquiries: Mr Nazim . B

EXECUTIVE DIRECTOR
DEPARTMENT OF CONSERVATION
AND LAND MANAGEMENT
PO BOX 104
COMO 6152.

Dear Sir

Reserve 43690 - BR SKINE C.P.

I advise for your information that Executive Council has approved the amendment of Reserve No. 43690 (Murray Location 1958) "Conservation Park" to include Murray Location 1905 and of its area being increased accordingly.

Notice to this effect was published in the Government Gazette dated 3 October 1995 and I enclose a print showing the said reserve.

Yours faithfully,

K. Emrose
K. EMROSE
A / MANAGER

ACQUISITIONS, ROADS AND RESERVES
LAND OPERATIONS DIVISION

C C TO CITY OF MANDURAH

Encl
10NBRE27

MR

CLERK, WOODVALE - F.I.

DOLA File 2949/987.

Reserve No 40342 (at Halls Creek) "Access and Parking" to comprise Lot 444 as surveyed and shown on Land Administration Plan 18671 in lieu of Lot 416 and of its area being increased to 2413 square metres accordingly.

Public Plan: DF72 (2) 32.25. Great Northern Highway.

Local Authority—Shire of Halls Creek.

DOLA File 3046/988.

Reserve No 41483 (Swan Location 11346) "Public Recreation" to include Location 12265 (formerly Lot 900 on Plan 18455) and of its area being increased to 6.6579 hectares accordingly.

Public Plan: BG35 (1) 08.31. Baltimore Parade.

Local Authority—City of Wanneroo.

The Notice published at page 3160 of the *Government Gazette* dated 25 July 1995 is hereby superseded.

DOLA File 1477/994.

Reserve No 43690 (Murray Location 1958) "Conservation Park" to include Murray Location 1905 (formerly Lot 6 on Plan 17120) and of its area being increased to 62.4707 hectares accordingly.

Public Plan: BG32 (2) 03.36 & BG32 (10) 1.8.

Local Authority—City of Mandurah.

Reserve 43690 is automatically vested in the National Parks and Nature Conservation Authority pursuant to Section 7 of the CALM Act 1984.

A. A. SKINNER, Chief Executive.

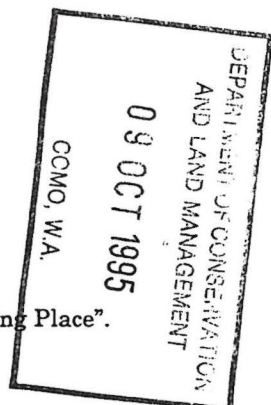

LA901

LAND ACT 1933
CHANGE OF PURPOSE OF RESERVES

Made by His Excellency the Governor under Section 37.

The purpose of the following reserves have been changed.

DOLA File 1288/894V2.

Reserve No 2602 (Avon Location 29146) being changed from "Water" to "Historic Watering Place".

Public Plan: Grass Valley SW (25). Great Eastern Highway.

Local Authority—Shire of Northam.

DOLA File 11976/903.

Reserve No 8961 (Avon Location 29005) being changed from "Camping" to "Landscape Protection".

Public Plan: Dattening NE (25). Wandering Pingelly Road.

Local Authority—Shire of Wandering.

DOLA File 1268/909.

Reserve No 20242 (Wellington Location 3784) being changed from "Schoolsite" to "Historic School Site".

Public Plan: Donnybrook SW (25). Upper Capel Road.

Local Authority—Shire of Donnybrook-Balingup.

DOLA File 69/941.

Reserve No 22227 (Cockburn Sound Locations 4062, 4089, 4090, 4100 and 4106) being changed from "Drainage" to "Public Recreation and Drainage".

Public Plans: BG34 (2) 08.06, 08.07 and 09.06. Garden Road.

Local Authority—City of Cockburn.

DOLA File 2612/957.

Reserve No 25343 (Geraldton Lots 1511 and 1717) being changed from "Infant Health Centre" to "Infant Health Centre and Kindergarten".

Public Plan: BE43 (2) 14.14. Whitfield Place.

Local Authority—City of Geraldton.

DOLA File 1321/961.

Reserve No 26090 (Boyup Brook Lot 176) being changed from "School Quarters Site" to "Use and Requirements of the Government Employees Housing Authority".

Public Plan: BH29 (2) 5.16. Dickson Street.

Local Authority—Shire of Boyup Brook.

Ms Collins - for your letter pls.

1 Site - Ershine Conservation Park

*me
11.10.95*



DOLA

Department of LAND ADMINISTRATION

033698F4304

138

MIDLAND SQUARE, MIDLAND
WESTERN AUSTRALIA
Postal Address: PO Box 2222
Midland, Western Australia 6056

1995

Your Ref: 033698F4304

Our Ref: 1880/1993

Telephone: 273 7286

Enquiries: Mr NAZIM .B

EXECUTIVE DIRECTOR
DEPARTMENT OF CONSERVATION
AND LAND MANAGEMENT
PO BOX 104
COMO 6152

Dear Sir

Reserve 43690

I advise for your information that Executive Council has approved of Murray Location 1958 being set apart as Reserve No 43690 for the designated purpose of "Conservation Park".

Reserve No 43690 is automatically vested in the National Parks and Nature Conservation Authority pursuant to Section 7 of CALM Act 1984.

Notice to this effect was published in the Government Gazette dated 25 July 1995 and I enclose a print showing the said reserve .

Yours faithfully,

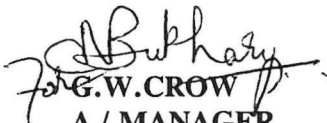
G.W. CROW

A / MANAGER
ACQUISITIONS, ROADS AND RESERVES
LAND OPERATIONS DIVISION

August 7 1995

Encl
C C TO CITY OF MANDURAH FOR INFORMATION

08NBRE51

CLERK, WOODVALE - FYI

HUNGERFORD

MANDURAH & ENVIRONS 05.39

13

PT 703

13288

MA. S.W. 5

PLAN

(17948)

Res. for Rec. 10 17550

A39886 2892

(17948)

MANDURAH ESTUARY BRIDGE

Murray Cockburn Pond
S (DIA)
Box of Loc. 16 extends to the shore

62939

TOWNSITE

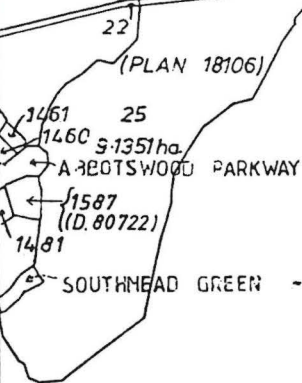

PT 1011

Loc. 16

COODANUP

MANDURAH 05.38

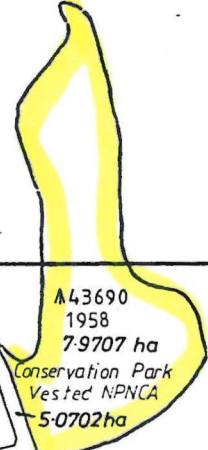

1
36.0533 ha

PLAN

16824

The Chimneys

Pt 1011

PLAN 14694

Channel

6
5000 ha

17120

extends to shore

Sticks

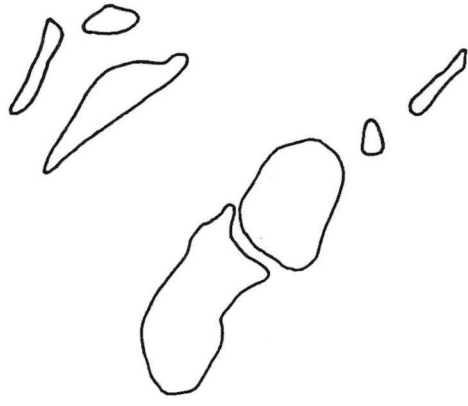

Channel Island

'A'
PT. A 8185
4004
Cons F & F

X (Abt. 74.0941 ha)
NPNC

Boundary Island

Creary Island

Mandurah
ray

EEL INLET

MANDURAH & ENVIRONS

Sticks

BG 32 / 1.8

1 : 10 000

127
NLS

LA File 1625/995

Reserve No. 43682 comprising Waroona Lot 410 (formerly Lot 156 on Diagram 82934) with an area of 1031 square metres for the designated purpose of "Drainage".

Section 20A.

Public Plan: BG32 (2) 18.05 and 18.06. Clements Place.

Local Authority—Shire of Waroona.

DOLA File 606/995

Reserve No. 43683 comprising Swan Location 12207 (formerly Lot 104 on Diagram 84356) with an area of 1.4466 hectares for the designated purpose of "Foreshore Management".

Section 20A.

Public Plan: BG36 (2) 16.13. Edgar Street.

Local Authority—Shire of Gingin.

DOLA File 611/995

Reserve No. 43684 comprising Swan Lot 12210 (formerly Lot 10 on Diagram 77273) with an area of 2.3463 hectares for the designated purpose of "Public Recreation".

Section 20A.

Public Plan: Moore River NE. Gingin Brook Road.

Local Authority—Shire of Gingin.

DOLA File 605/995

Reserve No. 43685 comprising Lancelin Lot 1024 (formerly Lot 115 on Plan 14390) with an area of 110 square metres for the designated purpose of "Drainage".

Section 20A.

Public Plan: BF37 (2) 21.09. Hawcroft Place

Local Authority—Shire of Gingin.

DOLA File 3180/985

Reserve No. 43686 comprising Swan Location 12116 (formerly Lot 369 on Plan 15360) with an area of 7.1170 hectares for the designated purpose of "Public Recreation and Water Supply".

Section 20A.

Public Plan: BG36 (2) 24.06. Robin Grove.

Local Authority—Shire of Chittering.

DOLA File 1477/994

Reserve No. 43690 comprising Murray Location 1958 (formerly Lot 5 on Plan 16825) with an area of 7.9707 hectares for the designated purpose of "Conservation Park".

Section 20A.

Public Plan: BG32 (10) 1.8. The Chimneys.

Local Authority—City of Mandurah.

Reserve 43690 is automatically vested in the National Parks and Nature Conservation Authority pursuant to Section 7 of CALM Act 1984.

DOLA File 1436/989

Reserve No. 43691 comprising Murray Locations 1956 (formerly Lot 2 on Plan 16825) and 1957 (formerly Lot 3 on Diagram 76383) with an area of 5.7940 hectares for the designated purpose of "Foreshore Conservation".

Section 20A.

Public Plan: BG32 (10) 1.8. The Chimneys.

Local Authority—City of Mandurah.

DOLA File 678/991

Reserve No. 43692 comprising Jandakot Agricultural Area Lot 664 (formerly Lot 52 the subject of Diagram 79622) with an area of 1962 square metres for the designated purpose of "Family Centre".

Public Plan: BG34 (2) 11.05. Dunraven Drive.

Local Authority—City of Cockburn.

DOLA File 2300/994

Reserve No. 43693 comprising Williams Lots 239, 242, 246, 248 and 252 with an area of 5060 square metres on Land Administration Plan Williams 99/1 for the designated purpose of "Use and Requirements of the Shire of Williams".

Public Plan: BH31 (2) 34.27. Carne and Cowcher Streets.

DOLA File 2799/994

Reserve No. 43694 comprising Swan Locations 12096, 12097 and 12098 with an area of 7763 square metres for the designated purpose of "Drainage".

Section 20A.

Public Plans: BG34 (1) 35.61 and 35.62. Carman Way/Iolanthe Street.

Local Authority—Town of Bassendean.

1. *[Signature]*

2. 28.95
MS Collins - for your letter pls.

RESERVE ACTION SHEET - CONSERVATION RESERVES

RESERVE No. 43690

REASON FOR ACTION

- Amendment of a class 'C' conservation park vested in the NPNCA for the purpose of "Conservation Park" Area: 66.5244 ha
- Reserve amended by the addition of the area comprised in cancelled Reserve 43868, ("Public Recreation", unvested), which was contiguous with Reserve 43690. The area contains remnant vegetation in good condition. The amalgamation was suggested by the Peel Preservation Group as a means of protecting the area.
- Gazettal date: 20.1.1998 See folios 167 - 170
- Plans at folios 172 - 174

	OFFICER	ACTION	
1	RESERVES <i>Sc 27.2</i>	- Fill in above details - Attach copies of gazettal notices to file	✓ ✓
2	INDEX CLERK, RECORDS	- Index reserve's name - Index reserve's number	_____ _____
3	RESERVES CLERK <i>Sc. 27.2</i>	Send copies of gazettal notices and Map to: - Lisa Wright, Woodvale - District Manager, Dwellingup - Regional Manager, Swan	_____ _____ _____
4	CONSERVATION ESTATE OFFICER	To note: <i>Sharon Colliss 23.98</i>	
5	LAND ACQUISITIONS OFFICER	To note:	
6	MANAGER, PLANNING & VISITOR SERVICES	To note:	
7	DIRECTOR, NATURE CONSERVATION/ NATIONAL PARKS	To note:	

DOLA File: 02487-1992-01RO.

Reserve No: 42450 (Swan District) "Conservation of Flora and Fauna and Water" to comprise Locations 1993, 3461, 3470, 3471, 3472, 3527, 3529, 3531, 3533 to 3542 inclusive, 3555, 3556, 3560 to 3581 inclusive, 3587, 3627 to 3642 inclusive, 3660, 3661, 3662, 3668 to 3671 inclusive, 9370, 11619 and 11620 on Land Administration Miscellaneous Plan 1709 and Location 10501 as surveyed and shown bordered red on Land Administration Plan 19172 and of its area being established at 10962.2166 hectares accordingly.

Public Plan/s: Moore River NE & SE (25), Gingin NW (25) Duffy Road

Local Authority: Shire of Gingin.

DOLA File: 01477-1994-01RO.

Terms d'base amended GLM 13/2

Reserve No: 43690 (Murray Locations 1958 and 1905) "Conservation Park" to include Location 1987 (on LTO Plan 16556) and of its area being increased to 66.5244 hectares accordingly.

This Reserve is automatically vested in the National Parks and Nature Conservation Authority pursuant to Section 7 of the CALM Act 1984.

Public Plan/s: BG33 (2) 3.36 and 4.36 Silverton Crescent

Local Authority: City of Mandurah.

DOLA File: 02786-1996-01RO.

Reserve No: 44846 (Swan Location 12685) "Public Recreation" to include Location 12805 (formerly Lot 1291 on Plan 21830) and of its area being increased to 1.5849 hectares accordingly.

Public Plan/s: BG35 (1) 38.04 and 38.05 Sherbrooke Retreat and Daintree Loop

Local Authority: Shire of Swan.

DOLA File: 01853-1997-01RO.

Reserve No: 45095 (At Margaret River) "Public Recreation" to comprise Lot 266 (formerly Lot 121 on Plan 21818) in Lieu of Sussex Location 5118 and of its area remaining unaltered.

Public Plan/s: BF29 (2) 10.02 Waters Edge Boulevard

Local Authority: Shire of Augusta/Margaret River.

A. A. SKINNER, Chief Executive.

LA901

LAND ACT 1933

CHANGE OF PURPOSE OF RESERVES

Made by His Excellency the Governor under Section 37.

The purposes of the following reserves have been changed

DOLA File: 01836-1976-01RO.

Reserve No. 874 (Kojonup Locations 9333 and 9334) being changed from "Water Supply" to "Parklands and Recreation".

Public Plan/s: Boscabel NW (25) Albany Highway

Local Authority: Shire of Woodanilling.

DOLA File: 03542-1907-01RD.

Reserve No. 1549 (Avon Location 29219) being changed from "Stopping Place for Travellers and Stock" to "Landscape Protection".

Public Plan/s: Grass Valley SE (25) Parker Road

Local Authority: Shire of Northam.

DOLA File: 02998-1918-01RO.

Reserve No. 1862 (Williams Location 15886) being changed from "Resting Place for Travellers and Stock" to "Landscape Protection".

Public Plan/s: Highbury SW (25) Piesseville Tarwonga Road

Local Authority: Shire of Wagin.

DOLA File: 01585-1990-01RO.

Reserve No. 2434 (Esperance Lot 933) being changed from "Police Purposes" to "Police".

Public Plan/s: CG29 (2) 16.13 off Norfolk Lane

Local Authority: Shire of Esperance.

DOLA File: 05412-1897-02RO.

Reserve No. 4768 (Perth Lot 1092) being changed from "Kindergarten and Infant Health Clinic" to "Use and Requirements of the City of South Perth".

Public Plan/s : BG34 (2) 13.22 Labouchere and Mill Point Roads

Local Authority: City of South Perth.

DOLA File: 14039-1903-03RO.

Reserve No: 9055 (Geraldton Lot 811) "Railway".

Public Plan/s: BE43 (2) 15.18 cnr Nichols Street and North West Coastal Highway

Local Authority: City of Geraldton.

DOLA File: 02819-1904-01RO.

Reserve No: 9220 (Kojonup District and Location 7899) "Government Requirements".

Public Plan/s: Martinup SW (25) Pallinup Road

Local Authority: Shire of Broomehill.

DOLA File: 04616-1915-01RO.

Reserve No: 16291 (Weld Business Area Lot 29) "Hallsite".

Public Plan/s: Laverton (250) - not charted

Local Authority: Shire of Laverton.

DOLA File: 03066-1918-01RO.

Reserve No: 17061 (Kojonup Location 4090) "Water".

Public Plan/s: Martinup SW (25) Pallinup Road

Local Authority: Shire of Broomehill.

DOLA File: 04550-1952-02RO.

Reserve No: 23765 (Geraldton Lot 1385) "Railway Purposes".

Public Plan/s: BE43 (2) 15.18 cnr Davis Street and Chapman Road

Local Authority: City of Geraldton.

DOLA File: 00772-1988-01RO.

Reserve No: 28935 (Kununurra Lot 727) "Use and Requirements of the Government Employees Housing Authority".

Public Plan/s: DH79 (2) 23.16 and 23.17 Silver Box Avenue

Local Authority: Shire of Wyndham/East Kimberley.

DOLA File: 02555-1969-01RO.

Reserve No: 31235 (Geraldton Lot 2559) "Recreation".

Public Plan/s: BE43 (2) 15.18 cnr Smith Street and North West Coastal Highway

Local Authority: City of Geraldton.

DOLA File: 01559-1995-01RO.

Reserve No: 43868 (Murray Location 1987) "Public Recreation".

Public Plan/s: BG32 (2) 3.36 and 4.36 Silverton Crescent

Local Authority: City of Mandurah.

DOLA File: 00602-1979-01RO.

Reserve No: 44766 (Morawa Lots 413, 448, 450 and 451) "Use and Requirements of the Shire of Morawa".

Public Plan/s: BG42 (2) 20.08 Tilley and Valentine Streets

Local Authority: Shire of Morawa.

DOLA File: 00823-1997-01RO.

Reserve No: 44793 (Swan Location 12684) "Use and Requirements of the Minister for Works".

Public Plan/s: BG34 (2) 16.33 Walmsley Drive and McCarthy Place

Local Authority: City of Bayswater.

DOLA File: 02259-1996-01RO.

Reserve No: 44947 (Merredin Lots 1424 and 1426) "Use and Requirements of the Minister for Works".

Public Plan/s: BK 35 (2) 36.36 Muscat Street

Local Authority: Shire of Merredin.

DOLA File: 03094-1982-01RO.

Reserve No: 44995 (Bencubbin Lot 246) "Use and Requirements of the Shire of Mount Marshall".

Public Plan/s: BK37 (2) 12.31 Collins Street

Local Authority: Shire of Mount Marshall.

DOLA File: 01658-1997-01RO.

Reserve No: 45022 (Canning Location 4134) "Use and Requirements of the Minister for Works".

Public Plan/s: BG34 (2) 21.14 Yule Street

Local Authority: City of Gosnells.

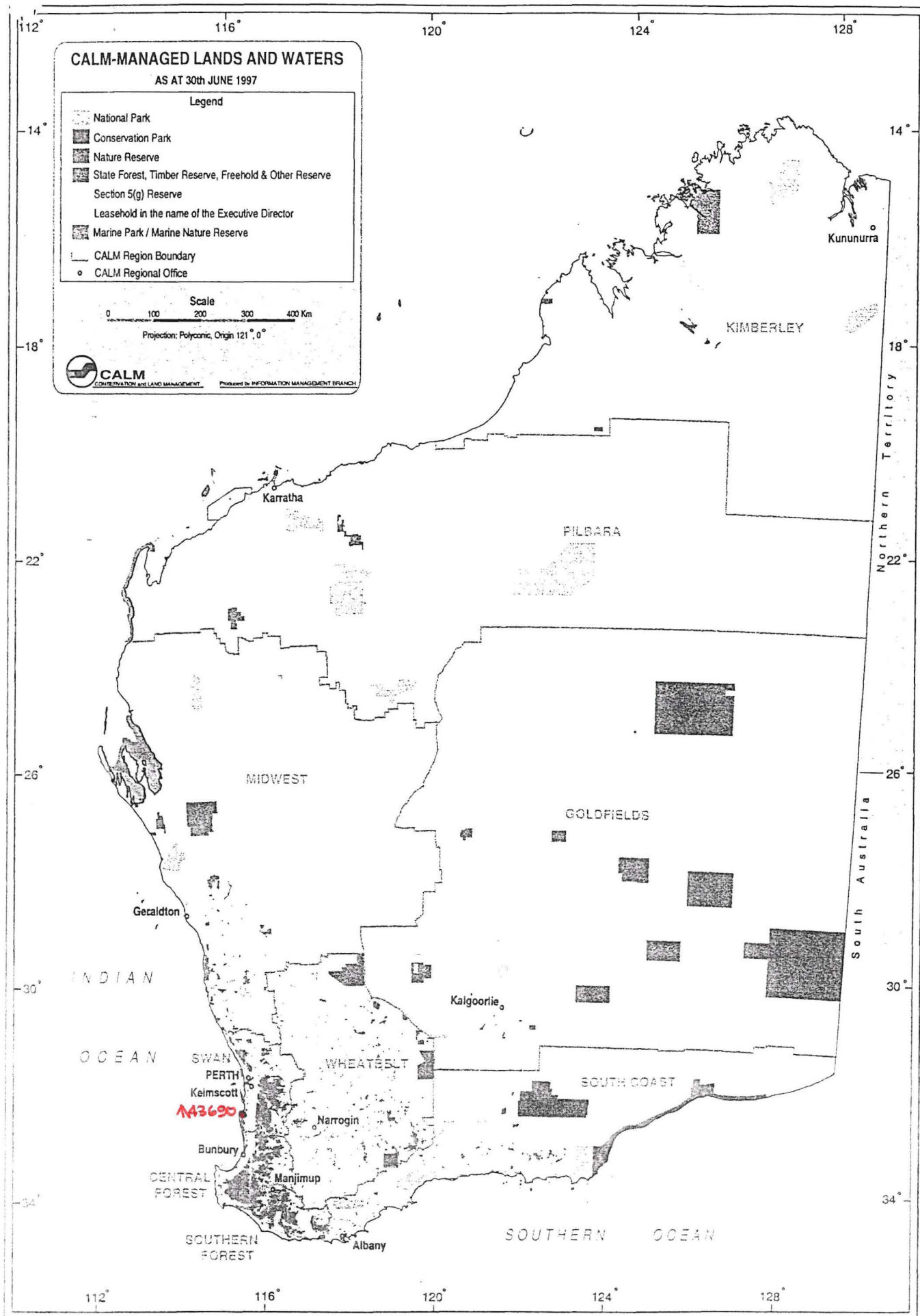

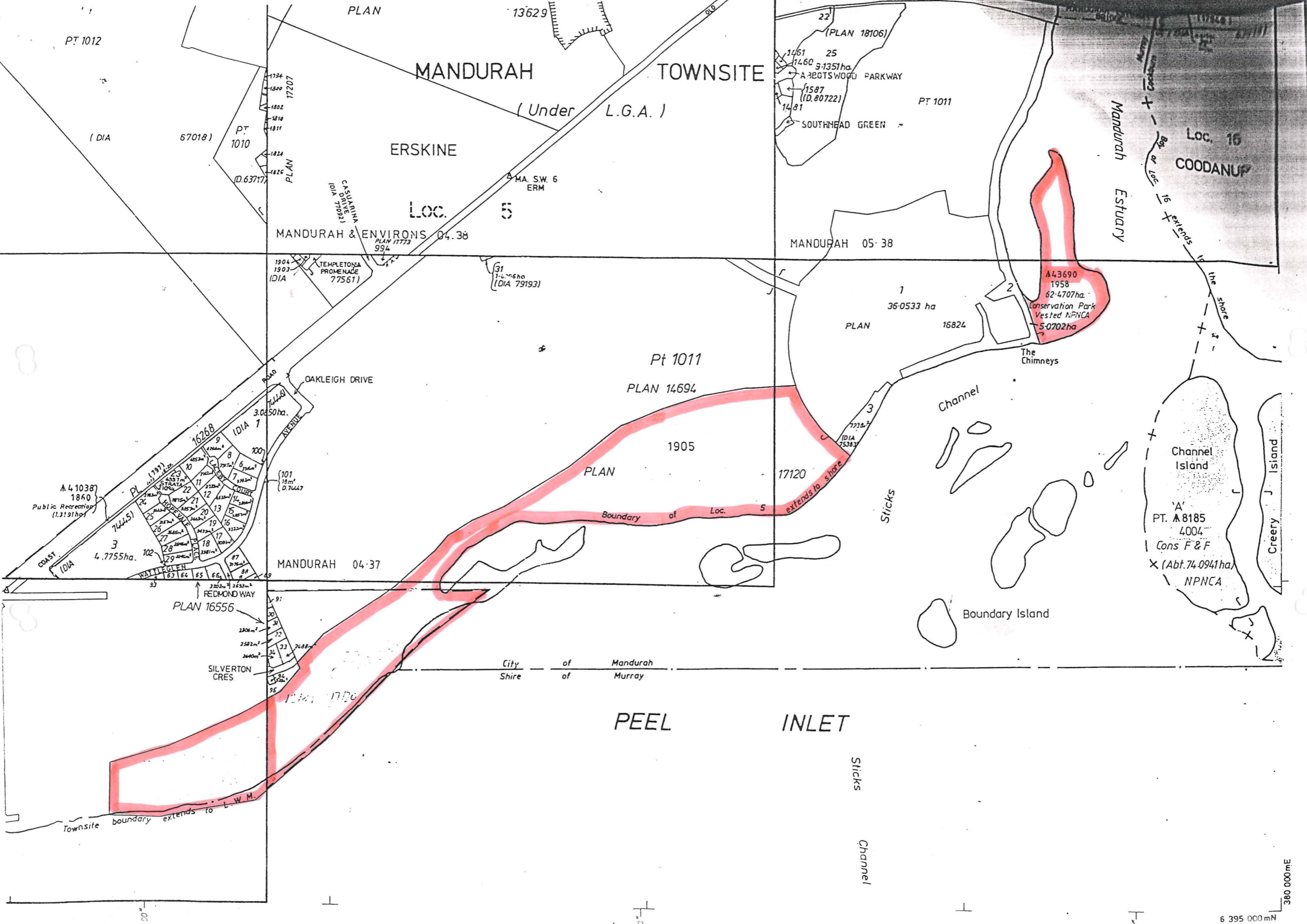

PT 1012

PLAN 13629

MANDURAH TOWNSITE (Under L.G.A.)

ERSKINE

LOC. 5

MANDURAH & ENVIRONS 04.38

MANDURAH 05.38

Loc. 16 COODANUP

Mandurah Estuary

1904 1903 IDIA TEMPLETONA PROMENADE 77561

31 1.606ha (DIA 79193)

Pt 1011

PLAN 14694

1905

PLAN

17120

Boundary of Loc. 5 extends to shore

Channel

Sticks

Channel Island

Creery Island

Boundary Island

City Shire of Mandurah Murray

PEEL INLET

Sticks

Channel

Townsite boundary extends to L.W.M.

SILVERTON CRES

REDMOND WAY PLAN 16556

A 41038 1860 Public Recreation (1.3191ha)

3 4.7755ha

MANDURAH 04.37

A 43690 1958 62.4707ha Conservation Park Vested NPWCA 5.0702ha

The Chimneys

A PT. A 8185 4004 Cons F & F (Abt. 74.0941ha) NPWCA

6 395 000mN

380 000mE

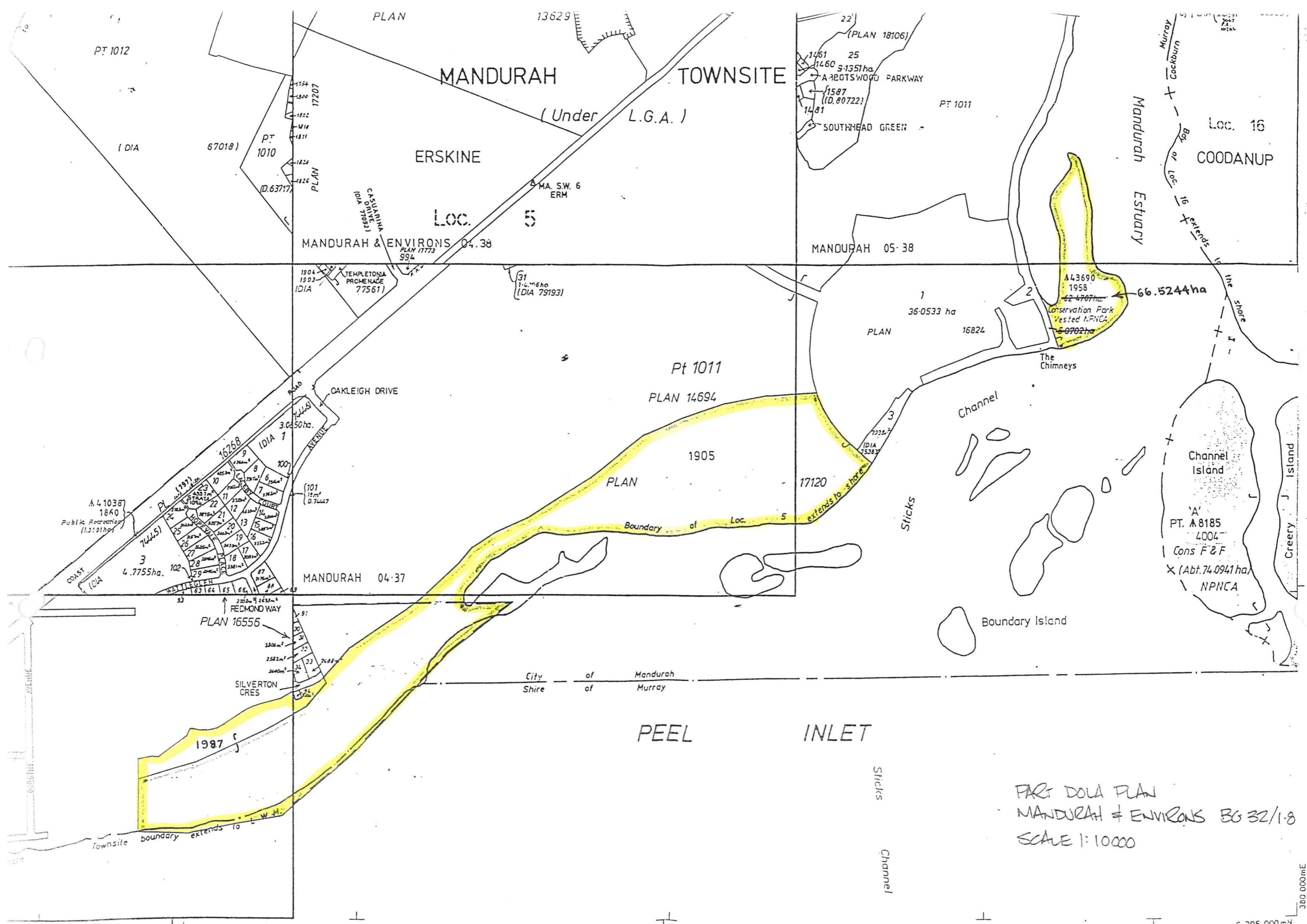

PT 1012

PLAN

13629

MANDURAH

TOWNSITE

(Under L.G.A.)

ERSKINE

LOC. 5

MANDURAH & ENVIRONS 04.38

MANDURAH 05.38

Loc. 16
COODANUP

Mandurah Estuary

Murray Cockburn Bay of Loc. 16 extends to the slope

67018

PT 1010

PLAN

17207

CASUARINA DRIVE (DIA 77093)

MA. S.W. 6 ERM

(PLAN 18106)
1461 25
1460 9.1351 ha
A 3025 WOOD PARKWAY
1587 (D. 80722)
1481
SOUTHHEAD GREEN

PT 1011

1904 1903 (DIA 77561)
TEMPLETONA PROMENADE

31 1.0066 ha (DIA 79193)

66.5244 ha
A 43690 1958
62.4707 ha
Conservation Park
Vested NPWCA
50702 ha

1 36.0533 ha
PLAN 16824

The Chimneys

Pt 1011

PLAN 14694

OAKLEIGH DRIVE

Channel

1905

PLAN

17120

Boundary of Loc. 5 extends to shore

Sticks

Channel Island

PT. A 8185
4004
Cons F & F
X (Abt. 74.0941 ha)
NPWCA

Creery Island

Boundary Island

MANDURAH 04.37

City of Mandurah
Shire of Murray

PEEL INLET

Sticks

Channel

REDMOND WAY
PLAN 16556

SILVERTON CRES

1987

Townsite boundary extends to

PART DOLA PLAN
MANDURAH & ENVIRONS BG 32/1-8
SCALE 1:10000

380 000m

6 395 000mH

