

RESERVE ACTION SHEET - CONSERVATION RESERVES

RESERVE No. 44077

REASON FOR ACTION

The inclusion of Port Kennedy Lot 217 into class A reserve 40541 and the subsequent amalgamation of reserve 40541 (redescribed as Port Kennedy Lot 216) into class A reserve 44077, for the purpose 'Conservation of Flora and Fauna'.

Area: 693.44 hectares

The Port Kennedy Area is of outstanding significance. The area is an important resource for research in modeling sea level change and shoreline response. The area contains three unusual vegetation associations: *Acacia lasiocarpa* complex, *Olearia Avillaris-Jacksonia furcellata* complex and the *O.Axillaris-Melaluca* complex. It also supports the rare southern brown bandicoot, *Isoodon obesulus*. The two reserves are contiguous and amalgamation would rationalise the management boundaries

Date of DOLA's advice: 26 October 2000
Plans at folios: 192,191,174, 174,137

See folio: 179

	OFFICER	ACTION
1	CONSERVATION ESTATE OFFICER	<ul style="list-style-type: none"> - Fill in above details _____ / - Attach copies of DOLA's advice to file _____ / Send copies of advice & maps to: - Lisa Wright, Woodvale _____ / - District Manager, Wanneroo _____ / - Regional Manager, Swan _____ / Recommended IUCN classification: _____ 1a
2	LAND ACQUISITIONS OFFICER	To note: _____
3	MANAGER, PLANNING & VISITOR SERVICES	To note & approve IUCN classification: _____
4	DIRECTOR, NATURE CONSERVATION/ NATIONAL PARKS	To note: _____
5	INDEX CLERK, RECORDS	To note: _____
6	CONSERVATION ESTATE OFFICER	Attach copy of Reserve Details to inside cover of new file _____

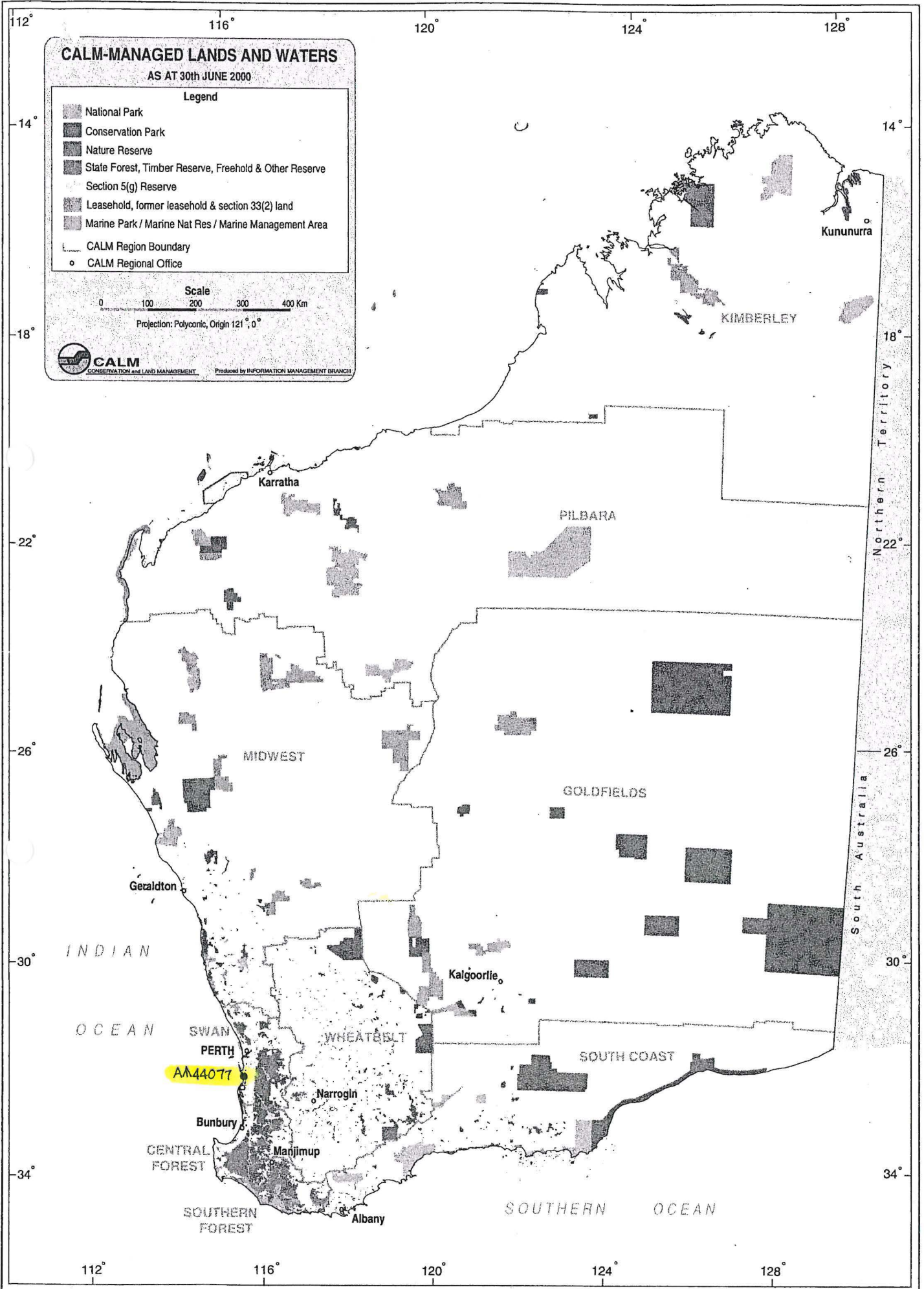

**Customer Advices for Reserve Actions
1/02/2001 - 28/02/2001**

City of Rockingham 1/02/2001 - 28/02/2001

Reserve No.	Land Description	DOLA File No.	Volume/Folio	Action	Document No.	Registered	Street Name	Area	Public Plans
44077		03211-1995-01RO	3121-169	Management Order to National Parks and Nature Conservation Authority, Corner Hackett Drive and Australia II Drive, CRAWLEY WA 6009 To be utilised for the designated purpose of "Conservation of Flora and Fauna" only, for the designated purpose of "	H583023	26/10/2000	Adjacent to Port Kennedy Drive and Warnbro Sound Avenue, Port Kennedy.	693.4395 Ha	BG33 (2) 06.18, 07.15, 07.18 and (10) 1.4 and 2.4
44077		03211-1995-01RO	3106-513	Revocation of Management Order (National Parks and Nature Conservation Authority) for the designated purpose of "Conservation of Flora and Fauna".	H583024	26/10/2000	Adjacent to Port Kennedy Drive, Port Kennedy.	82.597 Ha	BG33 (2) 06.18 and (10) 1.4 and 2.4
45041		02687-1996-01RO	3109-348	Revocation of Management Order (National Parks and Nature Conservation Authority) for the designated purpose of "Conservation of Flora and Fauna".	H583017	26/10/2000	Corner Port Kennedy Drive and Warnbro Sound Avenue, Port Kennedy.	589.4965 Ha	BG33 (2) 07.15 and 07.18 and (10) 2.4
CLASS A 23780	Peel Estate lot 1126 and Peel Estate lot 1286	03746-1946-01RO	0000-000	Amendment of Reserve to To exclude Peel Estate Lot 1435 on Office of Titles Plan 23038 and of it's area being reduced to 296.9694 hectares accordingly.	H527209	16/08/2000	Safety Bay Rd	296.9694 Ha	BG 33 (2) 8.23
A 44077	Port Kennedy Lot 138 as shown on Department of Land Administration Plan 19088	03211-1995-01RO	3106-513	Amendment of Reserve to To now comprise Port Kennedy Lot 138 on Land Administration Plan 19088 and Port Kennedy Lot 216 on Land Administration Plan 19447 and its area being increased to 693.4395 hectares.	H583022	26/10/2000	Adjacent to Port Kennedy Drive and Warnbro Sound Avenue, Port Kennedy.	693.4395 Ha	BG33 (2) 06.18, 07.15, 07.18 and (10) 1.4 and 2.4
A 45041	Port Kennedy Lot 213 as shown on Department of Land Administration Plan 19520	02687-1996-01RO	3109-348	Amendment of Reserve to To now comprise Port Kennedy Lot 216 on Department of Land Administration Plan 19947 in lieu of Port Kennedy Lot 213, and its area being increased to 610.8416 hectares.	H583019	26/10/2000	Corner Port Kennedy Drive and Warnbro Sound Avenue, Port Kennedy.	610.8416 Ha	BG33 (2) 07.15 and 07.18 and (10) 2.4
A 45041	Port Kennedy Lot 216 as shown on Department of Land Administration Plan 19947	02687-1996-01RO	3111-500	Reserve Cancellation "Conservation of Flora and Fauna"	H583021	26/10/2000	Corner Port Kennedy Drive and Warnbro Sound Avenue, Port Kennedy.	610.8416 Ha	BG33 (2) 07.15 and 07.18 and (10) 2.4

*Jenny / Graham J plans
Scottis*



137

PURPOSE - PROPOSED INCLUSION OF LOT 217 INTO A CLASS RESERVE 45041

DISTRICT - COCKBURN SOUND

PUBLIC PLANS - BG33 (2) 6.18, 7.15 & 7.18 & BG33 (10) 2.3 & 2.4

CORR. - 2687/996

SCALE - 1:20000

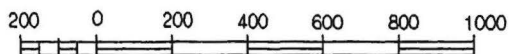
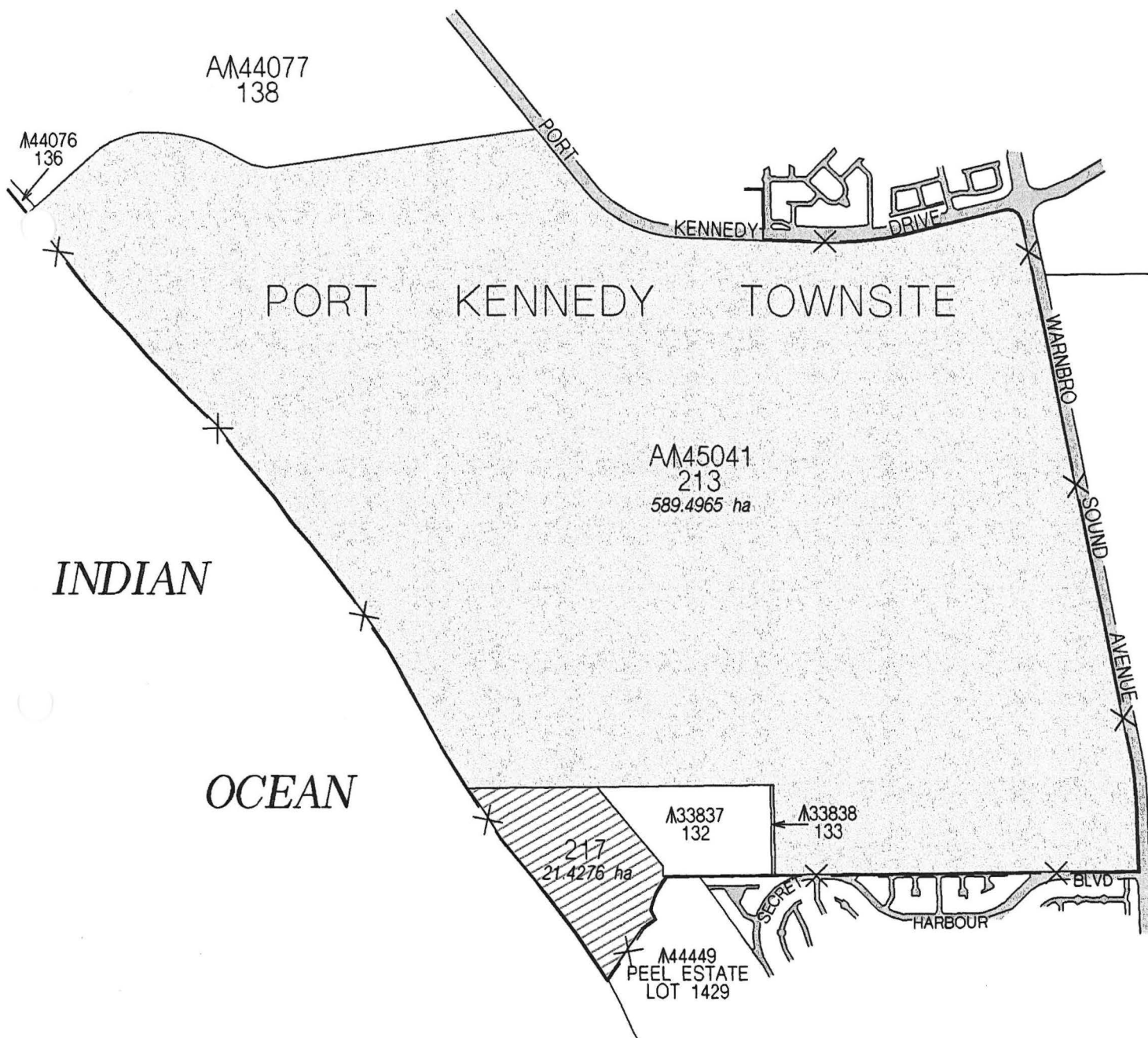

DOLA

Department of LAND ADMINISTRATION
 PRODUCED BY STATUTORY SERVICES GROUP 1
 OUR REF: F:\MSFILES\ARCHIVE\PARLIDGN\PARL37.DGN
 DRAWN BY A.S. PEARSON

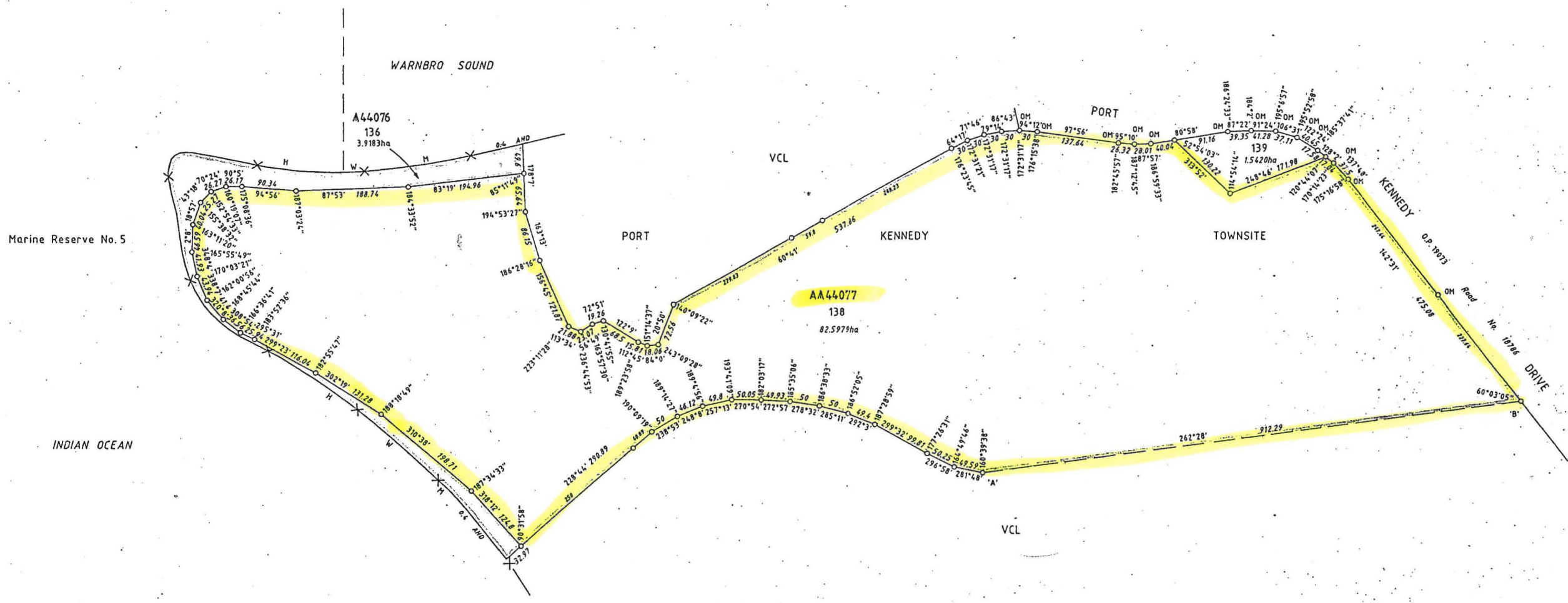

Marine Reserve No. 5

INDIAN OCEAN

LOTS 136 & 138 SET ASIDE AS PUBLIC OPEN SPACE AND BEACH RESERVE IN ACCORDANCE WITH THE PORT-KENNEDY DEVELOPMENT AGREEMENT ACT, 1992.

- NOTE
1. INTERMEDIATE MARKING HAS NOT BEEN PLACED ALONG LINE A-B DUE TO VEGETATION AND CONSERVATION CONSTRAINTS.
 2. TRENCHING HAS NOT BEEN CARRIED OUT DUE TO CONSERVATION AND SECURITY CONSTRAINTS.
 3. WATERLINE HEREON DOES NOT NECESSARILY DEPICT AN EXACT CADASTRAL BOUNDARY.

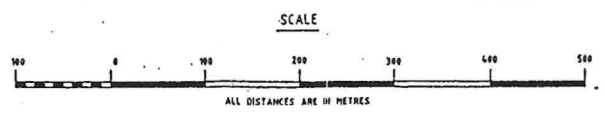
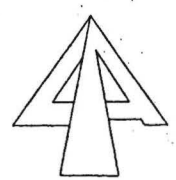
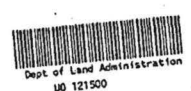

LAND DISTRICT COCKBURN SOUND		PORT KENNEDY LOTS 136, 138 & 139			
SURVEYOR'S CERTIFICATE <small>I hereby certify that this plan of survey is a correct and accurate representation of the survey carried out by me personally, under my own personal supervision, inspection and field check and recorded in Fieldbooks lodged for the purpose of this plan of survey. All the measurements are in strict accordance with the Licensed Surveyors (Guidance of Surveyors) Regulations 1981 and in particular regulations 23 and 24 of those regulations. and all the survey and this plan of survey are in strict accordance with the requirements of the Licensed Surveyors (Guidance of Surveyors) Regulations 1981 and the relevant law in relation to which it is lodged.</small>					
Prepared by: WIELANS SURVEY & MAPPING GROUP 133 Scarborough Beach Rd. St. Helens WA 6016 Ph. (09) 443 1511 Fax. (09) 444 3391		In order for certification: Date: 21.11.95 Date: 21.11.95		SURVEYOR GREGORY JOHN WELAND FIELD BOOK 70350 Page 1-15 Date of Marking 22-11-95	
TYPE OF VALIDATION Full Audit Date Legal Component Date 21.11.95 In order for further action Date		PLAN CERTIFIED CORRECT - REG. 26A Date: 21.11.95 Date: 21.11.95		LOCAL AUTHORITY: CITY OF ROCKINGHAM LOCALITY: PORT KENNEDY LOADED Date 11-11-95	
				PUBLIC PLAN (S) 8033 (M) L4.2.4 RECORDED B. FRANCIS Date 26.4.96 SURVEY INDEX PLAN (S) 8033 (M) L4.2.4 RECORDED Date	
				DEPARTMENT OF LAND ADMINISTRATION PLAN 19088	

DEPT. OF LAND ADMINISTRATION
 PLAN 19088

AMENDMENTS

FORMER TENURE
LOT 213
VCL

ON PLAN/DIAGRAM
OP 19520

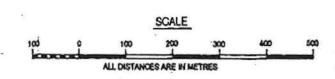
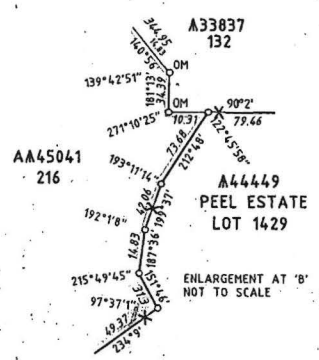
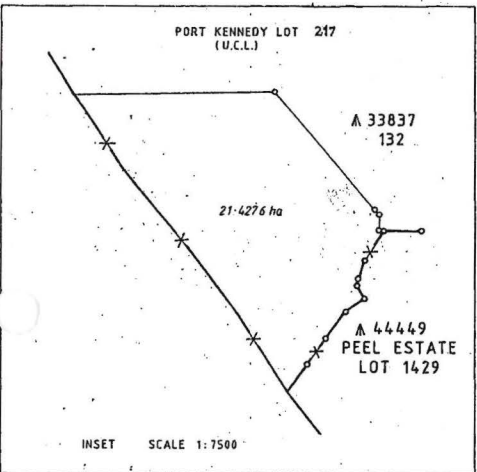
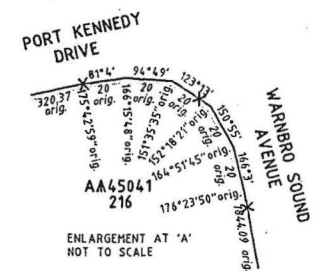
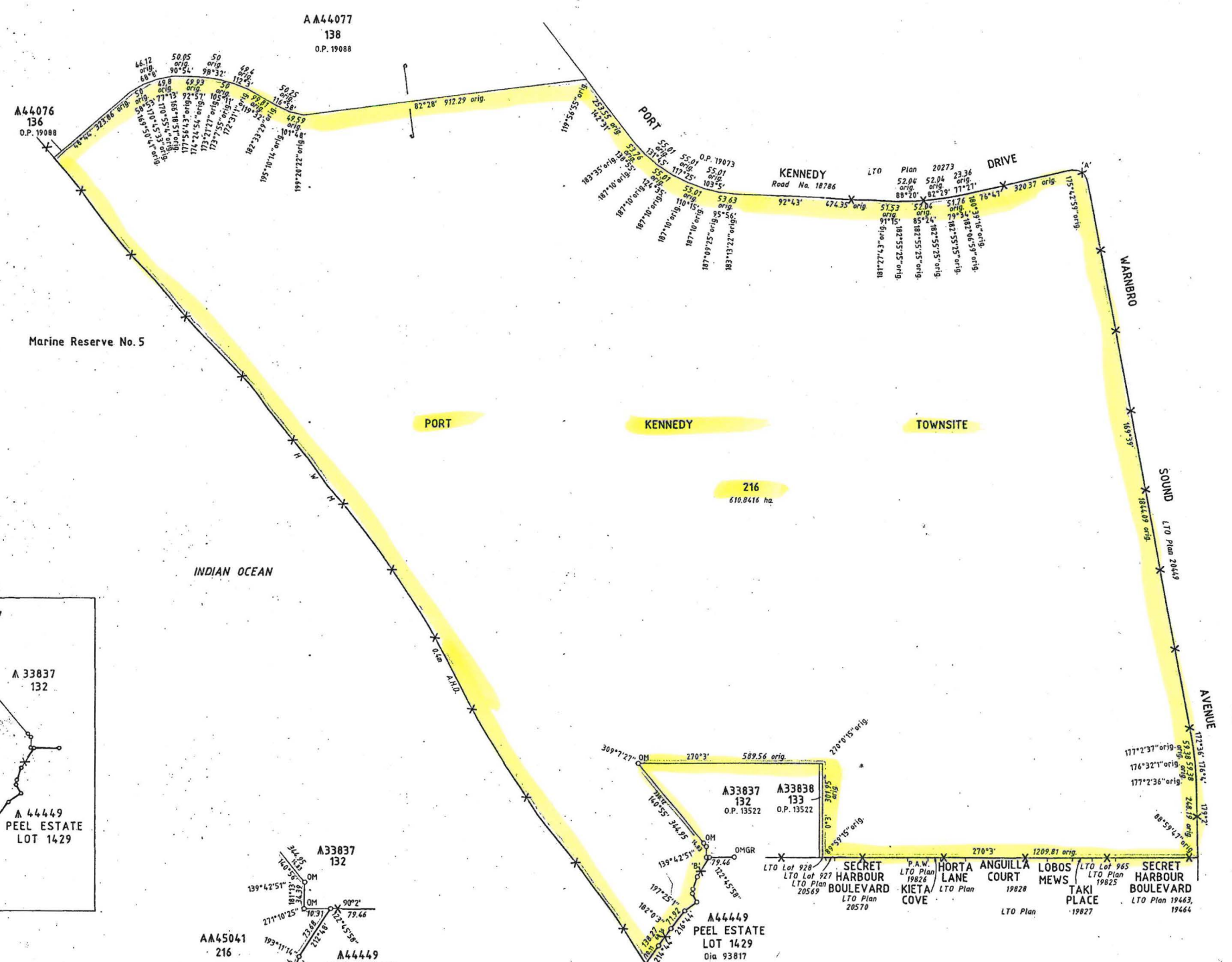

HIGH WATER MARK DEFINED BY GPS OBSERVATIONS
WATERLINE HEREON DOES NOT NECESSARILY DEPICT AN EXACT CADASTRAL BOUNDARY



LAND DISTRICT COCKBURN SOUND		PORT KENNEDY LOT 216	
SURVEYOR'S CERTIFICATE - Reg. 54 I, PETER JAMES READ, hereby certify that this plan is a correct representation of the survey and/or subdivision from measurements recorded in the field book lodged for the purpose of this plan and that it complies with the provisions of the Act in relation to which it is lodged.		TYPE OF VALIDATION Full Ass'd Date Legal Component Date Certified Correct Date Licensed Surveyor Date	SCALE 1:7500 measurements in metres SURVEYOR PETER JAMES READ FIELD BOOK 77282 Page Date of Making 6-8-98 AZIMUTH FROM O.P. 19520 LOCAL AUTHORITY CITY OF ROCKINGHAM LOCALITY PORT KENNEDY LOGGED ORN 17-8-98
SURVEYOR'S CERTIFICATE - Compiled I, PETER JAMES READ, hereby certify that this compiled plan is a correct and accurate representation of the original of the subject land and is in accordance with the relevant law in relation to which it is lodged.		In order for dealings subject to: 1. Plan approved by Plan 1920 2. Redevelopment of a Township by Approved Land Officer Date APPROVED (REG 24A) 14/8/2001 26.10.2000 Date	FILE 6711/920 V2 PUBLIC PLAN (S) 8633(2) 04, 16, 7, 15, 7, 18 8633(1) 1, 3, 2, 4 RECORDED Date SURVEY INDEX PLAN (S) 8633(2) 04, 16, 7, 15, 7, 18 8633(1) 1, 3, 2, 4 RECORDED Date DEPARTMENT OF LAND ADMINISTRATION PLAN 19947

DEPT. OF LAND ADMINISTRATION
PLAN 19947