

## RESERVE ACTION SHEET - CONSERVATION RESERVES

**RESERVE No.** 44660

### REASON FOR ACTION

The creation of a 5(1)(h) reserve for the purpose 'National Park, Tourism, Navigation, Communication, Meteorology and Survey', vested in the Conservation Commission.

Area: 0.353 hectares

Due to increasing use of satellite-aided navigation and AMSA's desire to rationalise its property holding, the Commonwealth has been divesting properties containing lighthouses and marine navigational aids. Reserve 44660 at Cape Leeuwin is a former AMSA property which will be lease back to AMSA to permit continued operation of lighthouse facilities.

- Date of creation: 4 December 2000 (Customer Advice: p. 8)
- Native Title Clearance: Freehold
- Plans at folios: 21, 31, 32

OFFICER	ACTION
<b>1 CONSERVATION ESTATE OFFICER</b>	Send copies of advice & maps to: - Lisa Wright, Woodvale - District Manager, Busselton - Regional Manager, Bunbury - Melissa D'Silva, Finance  Recommended IUCN classification: <u>II</u>
<b>2 LAND ACQUISITIONS OFFICER</b>	To note: _____
<b>3 UNIT LEADER, LAND &amp; EXTERNAL FUNDING</b>	1. To note & approve IUCN classification 2. To note native title clearance: _____
<b>4 DIRECTOR, NATURE CONSERVATION</b>	To note: _____
<b>5 INDEX CLERK, RECORDS</b>	To note: _____
<b>6 CONSERVATION ESTATE OFFICER</b>	Reserve details to inside cover of new file _____

8/11/02 JWW/19/11

33

CONSERVATION ESTATE OFFICER  
LAND ADMINISTRATION SECTION  
PARK POLICY AND TOURISM BRANCH

Reserve 44660 within SOUTHWEST / BLACKWOOD Region/District, was  
created/amended, effective from 4 DECEMBER 2000.

Copies of notification of this action and amended plans have been placed at  
folios 11, 29, 30, 32, 33.

Would you please advise the relevant offices of this amendment through your  
Reserve Action Sheet.



Program Leader  
Tenure Group, GIS  
Information Management Branch

14.6.02

**Customer Advices for Reserve Actions  
1/04/2001 - 30/04/2001**

1/04/2001 - 30/04/2001

Reserve No.	Land Description	DOLA File No.	Volume/Folio	Action	Document No.	Registered	Street Name	Area	Public Plans
19400	Kyarra District	01500-1998-01RO	3115-401	Amendment of Reserve to To comprise Kyarra Location 222 on Land Administration Miscellaneous Diagram 94638 and its area being reduced (recalculated) to 3.0251 ha.	H601810	20/11/2000		3.0251 Ha	Cue (100,000)
3688	Bailingup Lot	01985-2000-01RO	0000-000	Reserve Cancellation "Railway Purposes"	H604668	23/11/2000		0 sqm	
3870	Bridgetown Lot 25 on Land Administration Plan Bridgetown 26/2	01985-2000-01RO	0000-000	Reserve Cancellation "Resting Place for Travellers & Stock"	H604667	23/11/2000		0 sqm	
41354			3054-823	Revocation of Management Order () for the designated purpose of "".	H612353	04/12/2000		0 sqm	
41354	Ashburton Location 48 on Land Administration Reserve Diagram 853		3054-823	Change of Purpose to "Navigation, Communication, Meteorology & Survey."	H612352	04/12/2000		0 sqm	
44660	Sussex Location 5049 on Land Administration Miscellaneous Diagram 544 Sussex Location 5050 on Land Administration Miscellaneous Diagram 544 Sussex Location 5076 on Land Administration Miscellaneous Diagram 544		3087-4	Reserve Creation for the designated purpose of "National Park, Tourism, Navigation, Communication, Meteorology and Survey."	H612413	04/12/2000		0 sqm 0.353	Cape Heerum Lighthouse
44665	Lyndon Location 225 on Land Administration Miscellaneous Diagram 541		3086-933	Reserve Creation for the designated purpose of "Navigation, Communication, Meteorology, Survey and Conservation."	H612447	04/12/2000		0 sqm	
44666	Lyndon Location 230 on Land Administration Reserve Diagram 1435		3108-300	Reserve Creation for the designated purpose of "Conservation of Flora and Fauna".	H612448	04/12/2000		0 sqm	
44667	Ashburton Location 183 on Land Administration Miscellaneous Diagram 553		3086-941	Reserve Creation for the designated purpose of "Navigation, Communication, Meteorology, Survey and Conservation."	H612452	04/12/2000		0 sqm	
44668	Ashburton Location 188 on Land Administration Reserve Diagram 1438		3108-299	Reserve Creation for the designated purpose of "Conservation of Flora and Fauna".	H612453	04/12/2000		0 sqm	
44673	Meda Location 28 on Land Administration Miscellaneous Diagram 539		3061-298	Reserve Creation for the designated purpose of "Navigation, Communication, Meteorology, Survey and Conservation."	H612383	04/12/2000		0 sqm	
44674	Meda Location 31 on Land Administration Miscellaneous Diagram 608		3107-596	Reserve Creation for the designated purpose of "Conservation of Flora and Fauna".	H612384	04/12/2000		0 sqm	
44675	Meda Location 37 on Land Administration Reserve Diagram 1433		3108-296	Reserve Creation for the designated purpose of "Conservation of Flora and Fauna".	H612386	04/12/2000		0 sqm	
44677	Marmdoc Location 13 on Land Administration Miscellaneous Diagram 551		3061-297	Reserve Creation for the designated purpose of "Navigation, Communication, Meteorology, Survey and Conservation."	H612349	04/12/2000		0 sqm	
44678	Marmdoc Location 14 on Land Administration Reserve Diagram 1434		3108-298	Reserve Creation for the designated purpose of "Conservation of Flora and Fauna".	H612398	04/12/2000		0 sqm	
44684	King Location 813 on Land Administration Diagram 92975		3107-792	Reserve Creation for the designated purpose of "Navigation, Communication, Meteorology and Survey."	H612281	04/12/2000		0 sqm	
44689	Broome Lot 3078 on Land Administration Miscellaneous Diagram 550		3086-977	Reserve Creation for the designated purpose of "Navigation, Communication, Meteorology, Survey and Conservation."	H612397	04/12/2000		0 sqm	

*Jim Fitzpatrick for plans please  
se*

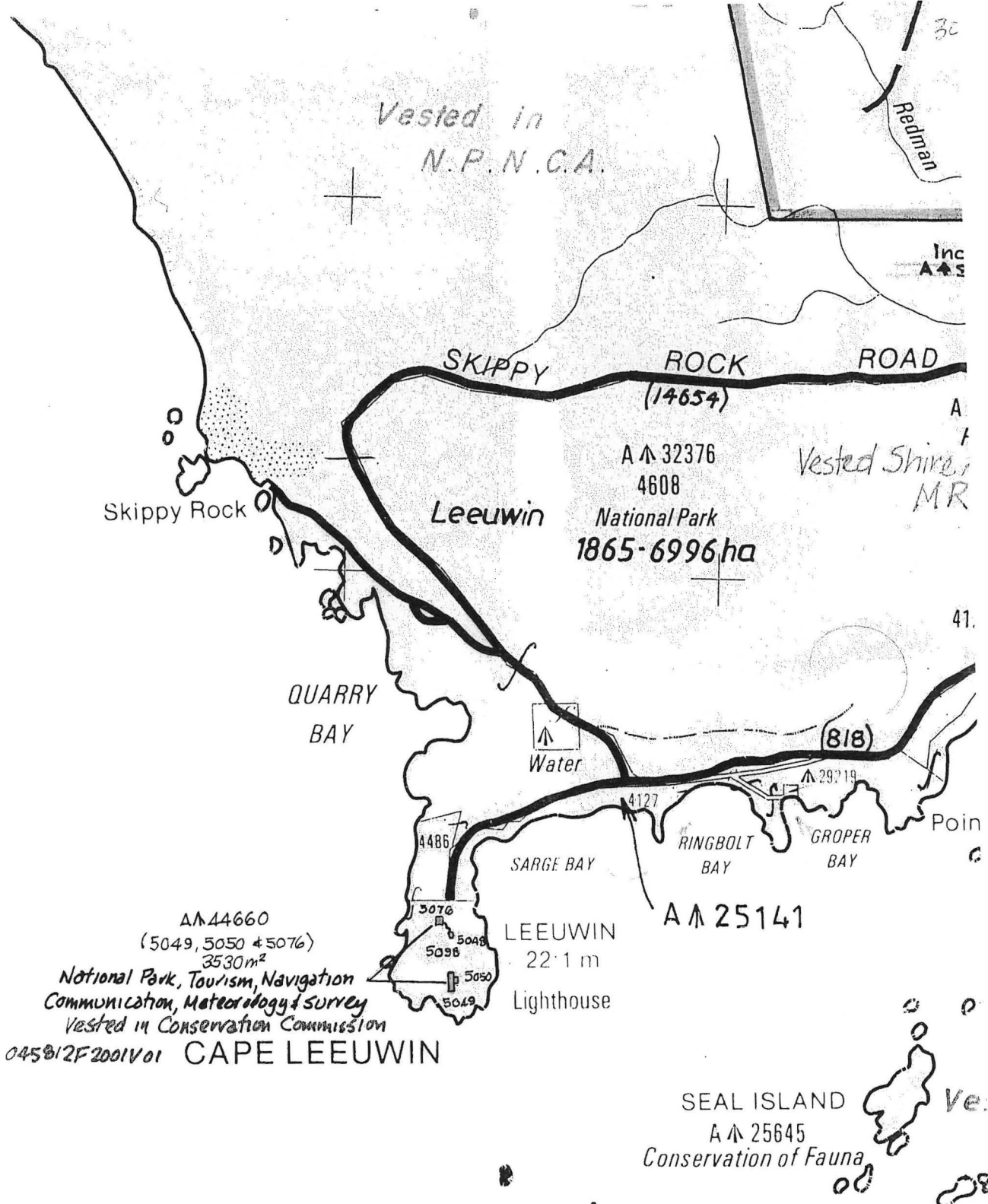

PAGE CALM PLAN:  
AUGUSTA.  
ENLARGED SCALE 1:25000

Enlargement Not To Scale

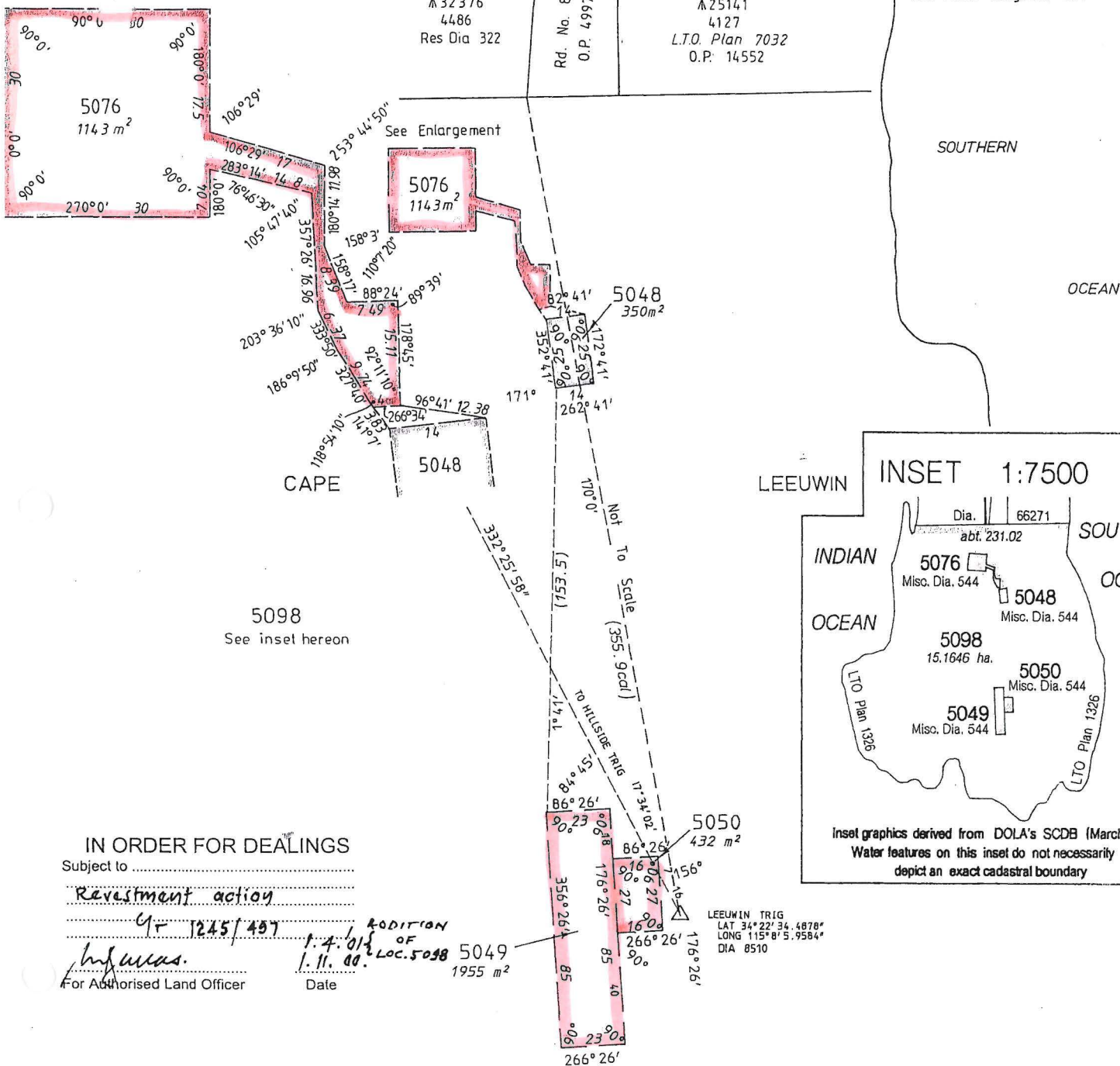

Supersedes — Diagram 66271 and Misc. Diagram 609

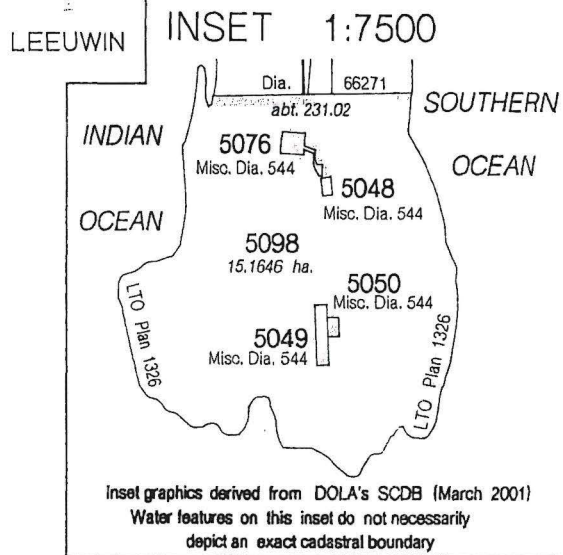

Inset graphics derived from DOLA's SCDB (March 2001)  
Water features on this inset do not necessarily depict an exact cadastral boundary

IN ORDER FOR DEALINGS

Subject to .....

Revestment action

1245/487

For Authorised Land Officer Date

ADDITION OF LOC. 5098 5049 1955 m²

NOT FOR ALIENATION PURPOSES  
MISC. DIA. 544

CERTIFIED...  
Authorised Land Officer.



Dept of Land Administration  
UO 137611

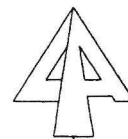

SUSSEX LOCATIONS 5048, 5049, 5050, 5076 & 5098 CREATED ON THIS DIAGRAM

RESERVE No. A44660 AREA 3530m <sup>2</sup> AA44660 Comprises Loc's 5049, 5050 & 5076 Purpose National Park, Lighthouse and Meteorological Station		FILE No. 1925 / 996, 365 / 972
DISTRICT SUSSEX		SCALE 1:1500 All measurements in metres
Public Plan LEEUWIN N.E., S.E. (25)	SUBJECT TO SURVEY	
Reference Page	AMENDMENTS	
Prepared by AUSLIG Date	Gazette Page	Initials
Checked Taylor Date 6.6.96	REVESTED Doc. H612411	Reg. 1-12-2000
Approved Taylor Date 17.2.97		
Manager Statutory Services	DEPT. OF LAND ADMINISTRATION MISCELLANEOUS DIAGRAM No. 544	