

## RESERVE ACTION SHEET - CONSERVATION RESERVES

**RESERVE No. 44677 & 44678**

### REASON FOR ACTION

The creation of a 5(1)(h) reserve for the purpose 'Conservation, Navigation, Communication, Meteorology and Survey' and the creation of a new nature reserve for the purpose 'Conservation of Flora and Fauna', both vested in the Conservation Commission.

Area: 0.11 & 57.8 hectares

Due to increasing use of satellite aided navigation and AMSA'S desire to rationalise it's property holdings the Commonwealth has been divesting properties containing lighthouses and marine navigational aids. Reserve 44677 on Lesueur Island is a former AMSA property which will be leased back to AMSA to permit continued operation of lighthouse facilities. Reserve 44678 on Lesueur Island is a former AMSA property, which will now be managed as a nature reserve.

- Date of DOLA's advice: 4 December 2000      See folio: 19
- Plans at folios: 21,20,16

OFFICER	ACTION	
1 <b>CONSERVATION ESTATE OFFICER</b>	<ul style="list-style-type: none"> <li>- Fill in above details</li> <li>- Attach copies of DOLA's advice to file</li> </ul> <p>Send copies of advice &amp; maps to:</p> <ul style="list-style-type: none"> <li>- Lisa Wright, Woodvale</li> <li>- Regional Manager, Kimberley</li> </ul> <p>Recommended IUCN classification:</p>	<p>_____</p> <p>_____</p> <p>_____</p> <p>_____</p> <p style="text-align: center;">V &amp; 1a</p>
2 <b>LAND ACQUISITIONS OFFICER</b>	To note:	_____
3 <b>MANAGER, PLANNING &amp; VISITOR SERVICES</b>	To note & approve IUCN classification:	_____
4 <b>DIRECTOR, NATURE CONSERVATION/ NATIONAL PARKS</b>	To note:	_____
5 <b>INDEX CLERK, RECORDS</b>	To note:	_____
6 <b>CONSERVATION ESTATE OFFICER</b>	Attach copy of Reserve Details to inside cover of new file	_____

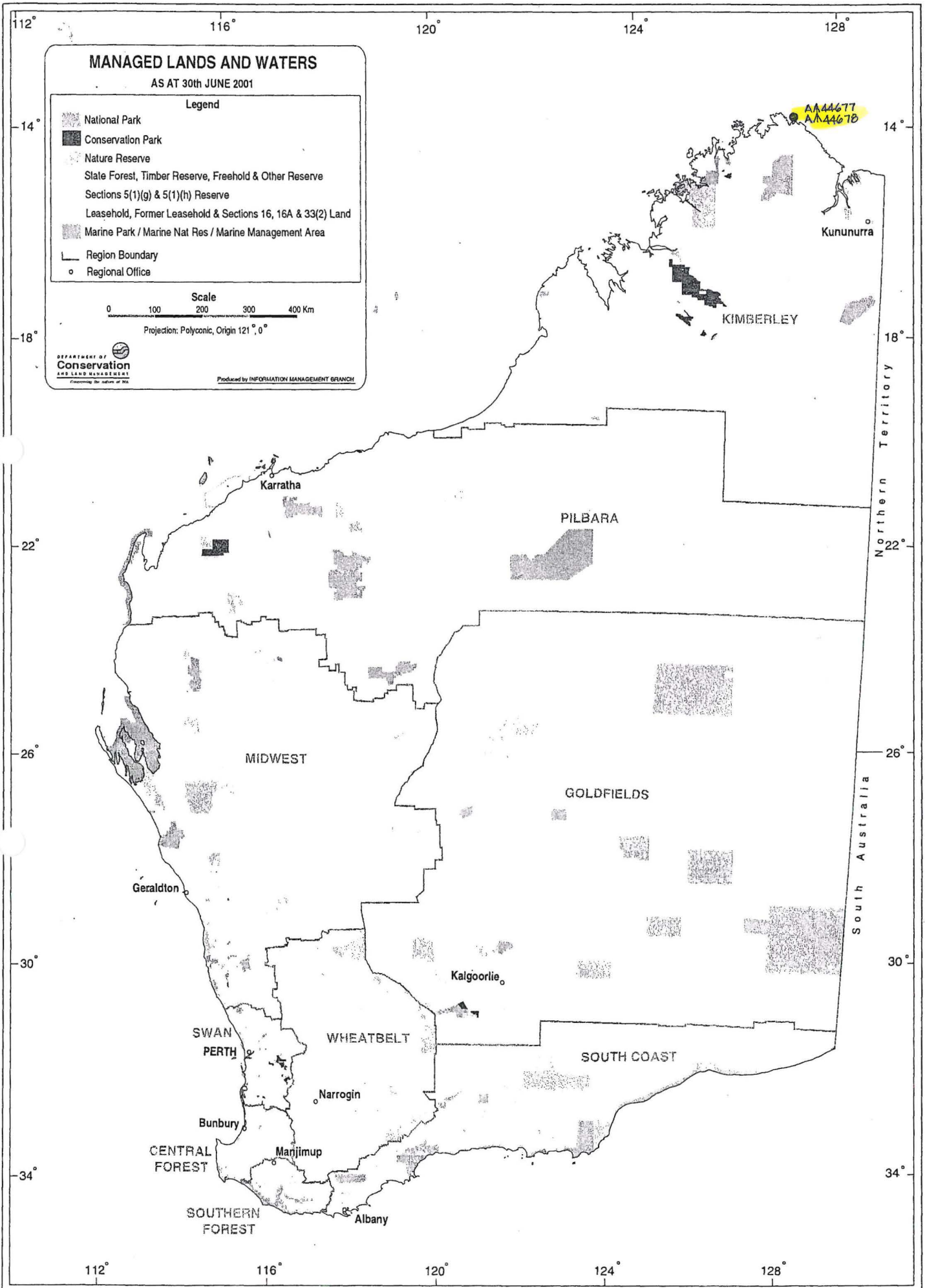

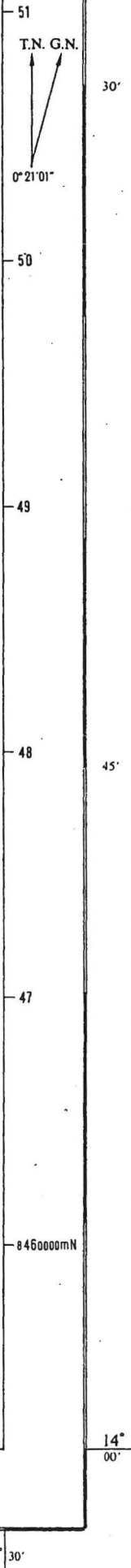

1090m<sup>2</sup> LESUEUR ISLAND  
S 165°  
AA 44677  
Marndoc Loc 13  
Navigation, Communication,  
Meteorology, Survey + Conservation  
Vested in Cons' Comm

AA 44678  
Marndoc Loc. 14  
57 7610 ha  
Cons of Flora + Fauna  
Vested in Conservation Commission

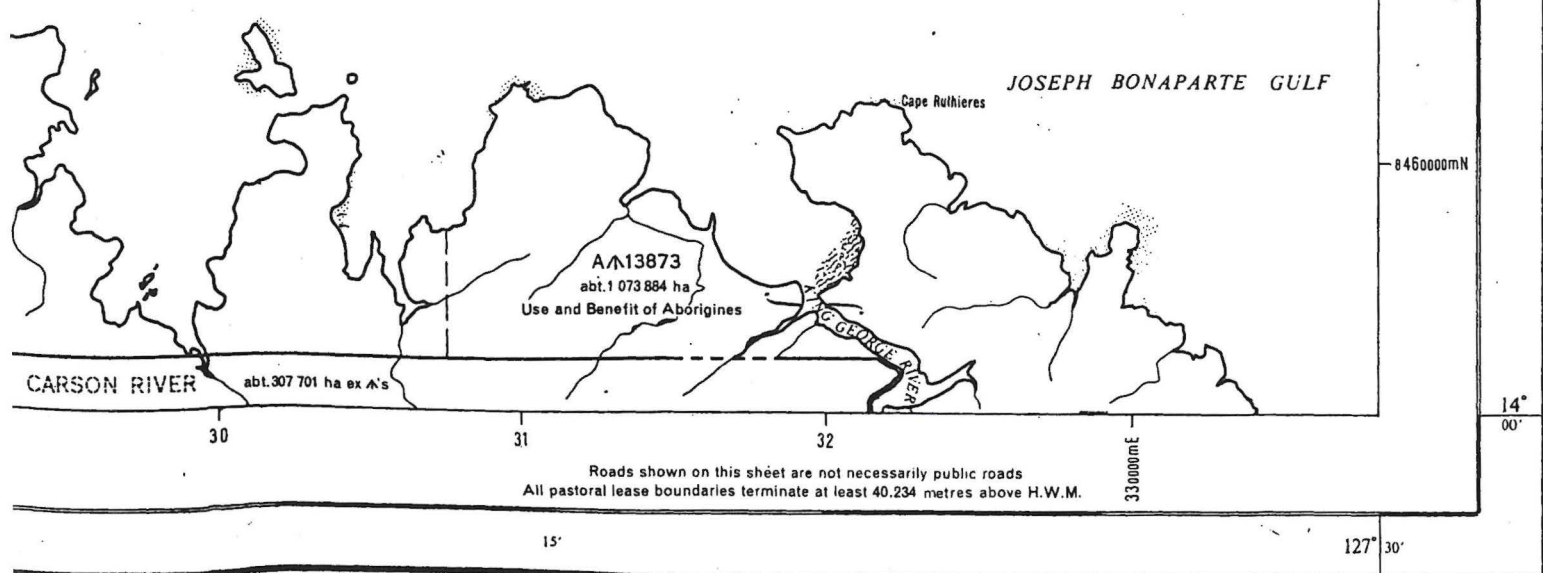

FACT DOCA PLAN (SD52-5)

NO DUPLICATE ISSUED

REGISTER VOLUME

FOLIO

16

Application H612348  
Revestment Order H612347  
Corr. 00473-1903-01ro  
Volume. Folio.  
1259 991

WESTERN AUSTRALIA



3061

297



CERTIFICATE OF

CROWN LAND TITLE

UNDER THE "TRANSFER OF LAND ACT 1893" AS AMENDED AND THE "LAND ADMINISTRATION ACT 1997"

The undermentioned land is Crown land, in the name of the STATE of WESTERN AUSTRALIA, subject to the interests and status orders in the First Schedule which interests and status orders are subject to the interests, easements, encumbrances and notices shown in the Second Schedule hereto.

Dated 1 December 2000

*J. Hyde*



REGISTRAR OF TITLES

LAND REFERRED TO

Marmdoc Location 13 on Land Administration Miscellaneous Diagram 551 delineated on the sketch in the Third Schedule.

THIRD SCHEDULE

Subject to Survey  
Not for Alienation Purposes

COPY OF ORIGINAL  
INFORMATION  
PURPOSES ONLY

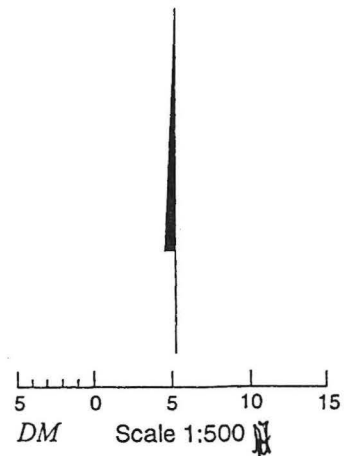
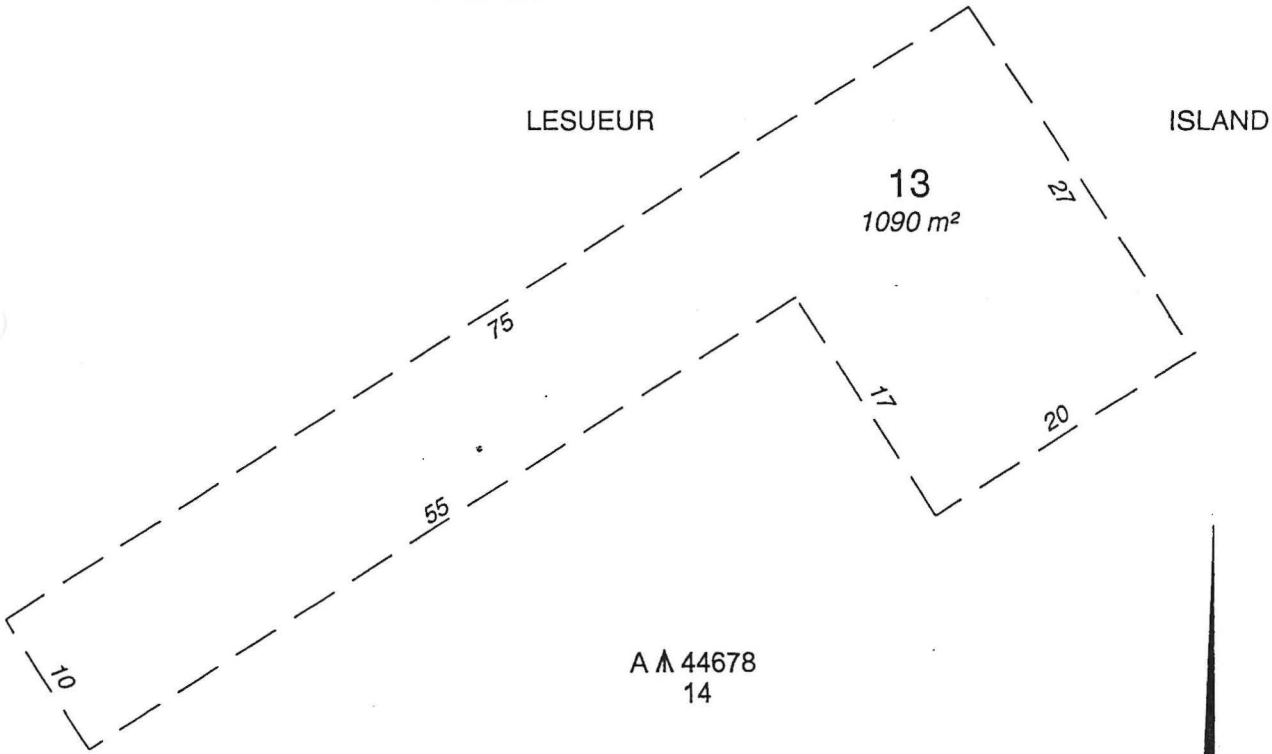

Page 1 (of 2 pages)

**Customer Advices for Reserve Actions**  
1/04/2001 - 30/04/2001

1/04/2001 - 30/04/2001

Reserve No.	Land Description	DOLA File No.	Volume/Folio	Action	Document No.	Registered	Street Name	Area	Public Plans
19400	Kyarra District	01500-1998-01RO	3115-401	Amendment of Reserve to To comprise Kyarra Location 222 on Land Administration Miscellaneous Diagram 94638 and its area being reduced (recalculated) to 3.0251 ha.	H601810	20/11/2000		3.0251 Ha	Cue (100,000)
3688	Bailingup Lot	01985-2000-01RO	0000-000	Reserve Cancellation "Railway Purposes"	H604668	23/11/2000		0 sqm	
3870	Bridgetown Lot 25 on Land Administration Plan Bridgetown 26/2	01985-2000-01RO	0000-000	Reserve Cancellation "Resting Place for Travellers & Stock"	H604667	23/11/2000		0 sqm	
41354			3054-823	Revocation of Management Order () for the designated purpose of ""	H612353	04/12/2000		0 sqm	
41354	Ashburton Location 48 on Land Administration Reserve Diagram 853		3054-823	Change of Purpose to "Navigation, Communication, Meteorology & Survey."	H612352	04/12/2000		0 sqm	
44660	Sussex Location 5049 on Land Administration Miscellaneous Diagram 544 Sussex Location 5050 on Land Administration Miscellaneous Diagram 544 Sussex Location 5076 on Land Administration Miscellaneous Diagram 544		3087-4	Reserve Creation for the designated purpose of "National Park, Tourism, Navigation, Communication, Meteorology and Survey."	H612413	04/12/2000		0 sqm	
44665	Lyndon Location 225 on Land Administration Miscellaneous Diagram 541		3086-933	Reserve Creation for the designated purpose of "Navigation, Communication, Meteorology, Survey and Conservation."	H612447	04/12/2000		0 sqm	
44666	Lyndon Location 230 on Land Administration Reserve Diagram 1435		3108-300	Reserve Creation for the designated purpose of "Conservation of Flora and Fauna"	H612448	04/12/2000		0 sqm	
44667	Ashburton Location 183 on Land Administration Miscellaneous Diagram 553		3086-941	Reserve Creation for the designated purpose of "Navigation, Communication, Meteorology, Survey and Conservation."	H612452	04/12/2000		0 sqm	
44668	Ashburton Location 188 on Land Administration Reserve Diagram 1438		3108-299	Reserve Creation for the designated purpose of "Conservation of Flora and Fauna"	H612453	04/12/2000		0 sqm	
44673	Meda Location 28 on Land Administration Miscellaneous Diagram 539		3061-298	Reserve Creation for the designated purpose of "Navigation, Communication, Meteorology, Survey and Conservation."	H612383	04/12/2000		0 sqm	
44674	Meda Location 31 on Land Administration Miscellaneous Diagram 608		3107-596	Reserve Creation for the designated purpose of "Conservation of Flora and Fauna"	H612384	04/12/2000		0 sqm	
44675	Meda Location 37 on Land Administration Reserve Diagram 1433		3108-296	Reserve Creation for the designated purpose of "Conservation of Flora and Fauna"	H612386	04/12/2000		0 sqm	
44677	Marndoc Location 13 on Land Administration Miscellaneous Diagram 551		3061-297	Reserve Creation for the designated purpose of "Navigation, Communication, Meteorology, Survey and Conservation."	H612349	04/12/2000		0 sqm	
44678	Marndoc Location 14 on Land Administration Reserve Diagram 1434		3108-298	Reserve Creation for the designated purpose of "Conservation of Flora and Fauna"	H612398	04/12/2000		0 sqm	
44684	King Location 813 on Land Administration Diagram 92975		3107-792	Reserve Creation for the designated purpose of "Navigation, Communication, Meteorology and Survey."	H612281	04/12/2000		0 sqm	
44689	Broome Lot 3078 on Land Administration Miscellaneous Diagram 550		3086-977	Reserve Creation for the designated purpose of "Navigation, Communication, Meteorology, Survey and Conservation."	H612397	04/12/2000		0 sqm	

5 (h) + NR 19