

036 20313102

43  
93

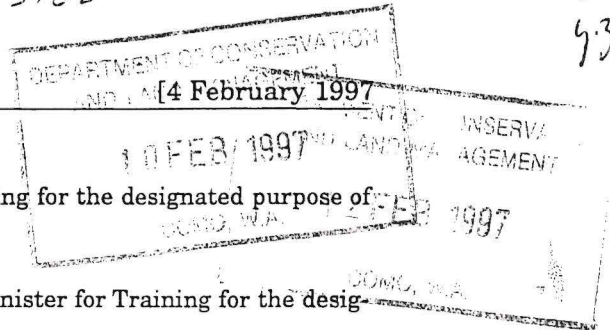

DOLA File 2806/977.

Reserve No 37585 (Perth Lot 1009) vested in the Minister for Training for the designated purpose of "Technical College".

DOLA File 1790/982.

Reserve No 37822 (Cockburn Sound Location 2680) vested in the Minister for Training for the designated purpose of "Technical School Site".

DOLA File 1203/985.

Reserve No 39125 (Kellerberrin Lot 421) vested in the Minister for Training for the designated purpose of "Regional Office (Technical and Further Education)".

DOLA File 2070/986.

Reserve No 39531 (Canning Location 3540) vested in the Minister for Training for the designated purpose of "Technical College Site".

DOLA File 2325/990.

Reserve No 39699 (Swan Location 10817) vested in the Minister for Training for the designated purpose of "Technical College".

DOLA File 3658/986.

Reserve No 39867 (Carnarvon Lot 1235) vested in the Minister for Training for the designated purpose of "Technical School Site".

DOLA File 2310/987

Reserve No 40259 (Jandakot Agricultural Area Lot 583) vested in the City of Cockburn for the designated purpose of "Emergency Services" with power, subject to the approval in writing of the Minister for Lands to each and every lease or assignment of lease being first obtained, to lease the whole or any portion thereof for any term not exceeding twenty one (21) years from the date of the lease.

DOLA File 1801/996.

Reserve No 44426 (Narrogin Lot 1683) vested in the Town of Narrogin for the designated purpose of "Access".

DOLA File 1224/995.

Reserve No 44692 (Plantagenet Location 7827) vested in the Shire of Albany for the designated purpose of "Drainage"

DOLA File 2718/995

Reserve No 44713 (Swan Location 12432) vested in the National Parks and Nature Conservation Authority for the designated purpose of "Conservation and Recreation"

DOLA File 2277/996.

Reserve No 44721 (Ongerup Lot 25) vested in The Bunbury Diocesan Trustees for the designated purpose of "Church Site".

Local Authority—Shire of Gnowangerup.

DOLA File 1674/996.

Reserve No 44723 (Avon Locations 29178, 29179, 29180 and 29181) vested in the Shire of Toodyay for the designated purpose of "Public Recreation."

DOLA File 1375/996.

Reserve No 44743 (Plantagenet Location 7856) vested in the Shire of Albany for the designated purpose of "Public Recreation".

DOLA File 2714/980.

Reserve No 44744 (Port Hedland Lot 5930) vested in the Town of Port Hedland for the designated purpose of "Public Recreation"

DOLA File 727/996.

Reserve No 44745 (Murray Locations 2034, 2035 and 2036) vested in the City of Mandurah for the designated purpose of "Public Recreation".

DOLA File 3300/977.

Reserve No 44746 (Brunswick Junction Lot 1) vested in the Shire of Harvey for the designated purpose of "Drainage".

DOLA File 1632/972.

Reserve No 44747 (Melbourne Location 3983) vested in the Shire of Moora for the designated purpose of "Recreation."

DOLA File 2517/996.

Reserve No 44751 (Esperance Location 2106) vested in the Shire of Esperance for the designated purpose of "Water Supply."

JOHN PRITCHARD, Clerk of the Council.

File - 2. N. Ryan 13-2-97

DOLA File 2718/995

Reserve No. 44713 comprising Swan Location 12432 (formerly Lot 171 on Plan 15353) with an area of 5.9486 hectares for the designated purpose of "Conservation and Recreation"

Section 20A

Public Plan: BG36 (5) 11.03 Parkside Gardens

Local Authority—Shire of Chittering

DOLA File 2277/996.

Reserve No. 44721 comprising Ongerup Lot 25 with an area of 987 square metres on Land Administration Diagram A1151 for the designated purpose of "Church Site".

Public Plan: Ongerup TS. Woods Street.

Local Authority—Shire of Gnowangerup.

DOLA File 1674/996.

Reserve No. 44723 comprising Avon Locations 29178, 29179, 29180 and 29181 (formerly Lot 695 on Plan 21259, Lot 696 on Plan 21257, Lot 697 on Plan 21256 and Lot 698 on Plan 21258) with an area of 5237 square metres for the designated purpose of "Public Recreation."

Section 20A.

Public Plan: Dewars Pool SE and SW (25); BH35 (5) 02.14. Coondle West Road.

Local Authority—Shire of Toodyay.

DOLA File 1375/996.

Reserve No. 44743 comprising Plantagenet Location 7856 (formerly Lot 111 on Diagram 33616) with an area of 809 square metres for the designated purpose of "Public Recreation".

Section 20A

Public Plan: BK26 (2) 14.12. near Andrews Crescent.

Local Authority—Shire of Albany.

DOLA File 2714/980.

Reserve No. 44744 comprising Port Hedland Lot 5930 (formerly Lot 142 on Plan 13326) with an area of 364 square metres for the designated purpose of "Public Recreation"

Section 20A

Public Plan: BL66 (2) 25.24. Traine Crescent.

Local Authority—Town of Port Hedland.

DOLA File 727/996.

Reserve No. 44745 comprising Murray Locations 2034, 2035 and 2036 (formerly Lots 16, 49 and 50 on Plan 20733) with an area of 4555 square metres for the designated purpose of "Public Recreation".

Section 20A.

Public Plan: BG32 (2) 5.37. Sirrocco Drive.

Local Authority—City of Mandurah.

DOLA File 3300/977.

Reserve No. 44746 comprising Brunswick Junction Lot 1 (formerly the land coloured blue and marked Drain Reserve on Diagram 53398) with an area of 163 square metres for the designated purpose of "Drainage".

Section 20A.

Public Plan: BG31 (2) 13.01. Shines Crescent.

Local Authority—Shire of Harvey.

DOLA File 1632/972.

Reserve No. 44747 comprising Melbourne Location 3983 (formerly Lot 4 on Plan 3010) with an area of 1012 square metres for the designated purpose of "Recreation."

Public Plan: BG38 (2) 23.30. Coorin, Kiaka and Ridley Streets.

Local Authority—Shire of Moora.

DOLA File 2517/996.

Reserve No. 44751 comprising Esperance Location 2106 (formerly Lot 28 on Diagram 91377) with an area of 345 square metres for the designated purpose of "Water Supply."

Section 20A.

Public Plan: CG29 (10) 04.05. Melijinup Road.

Local Authority—Shire of Esperance.

17

11

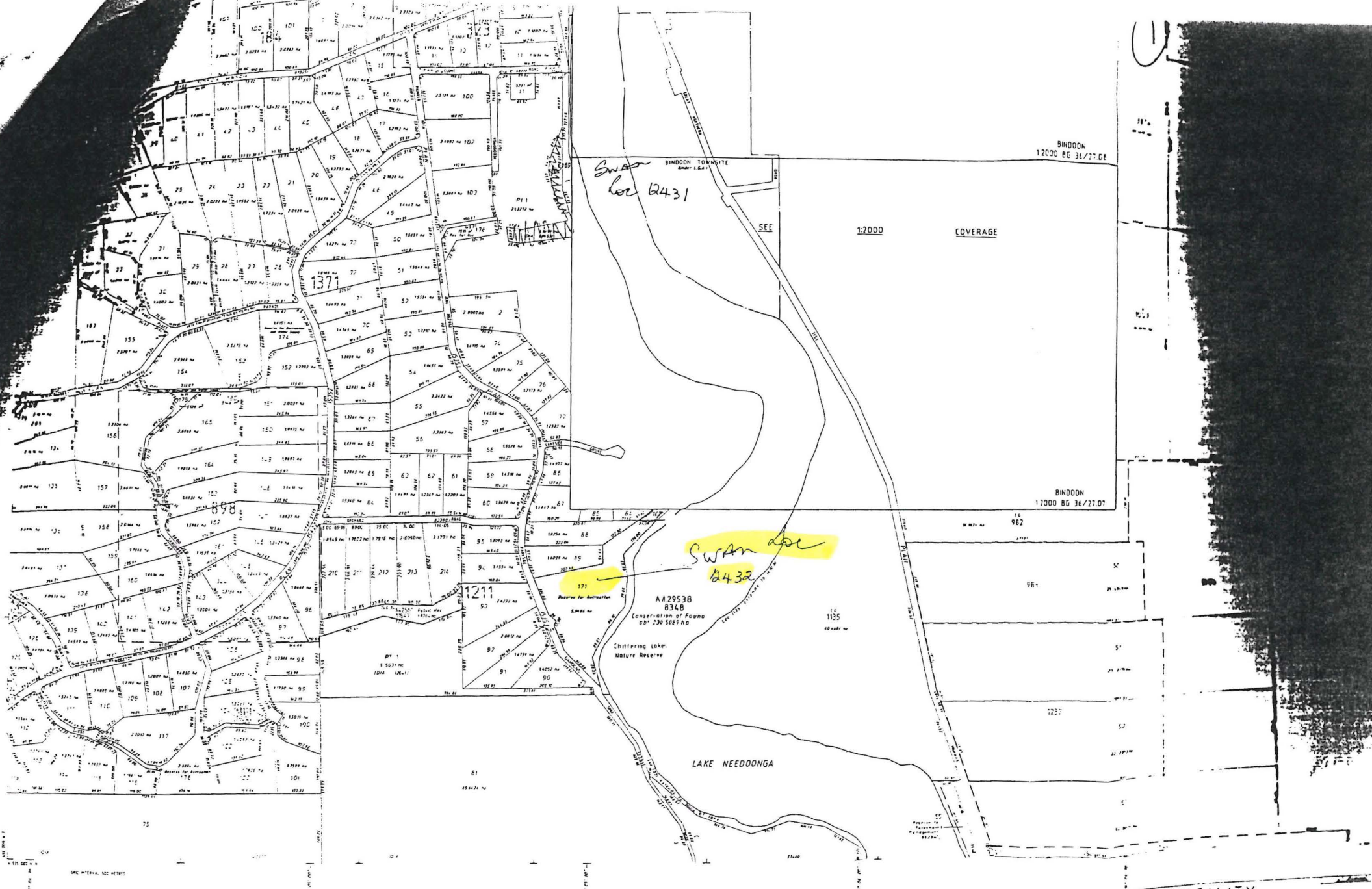

NOT TO BE USED AS PART OF THE STATE LANDS TITLE SYSTEM  
 THIS PLAN IS A COPY OF THE ORIGINAL PLAN AND IS NOT A REPRODUCTION OF THE ORIGINAL PLAN  
 THE ORIGINAL PLAN IS KEPT AT THE OFFICE OF THE SURVEYOR GENERAL  
 THE ORIGINAL PLAN IS KEPT AT THE OFFICE OF THE SURVEYOR GENERAL  
 THE ORIGINAL PLAN IS KEPT AT THE OFFICE OF THE SURVEYOR GENERAL

Symbol	Description
—	Boundary Line
—	Lot Line
—	Water
—	Other

Symbol	Description
—	Boundary Line
—	Lot Line
—	Water
—	Other

C.M.A. COPY

CHITTERING LOCALITY  
 Scale: 1:5000  
 LAND DISTRICT: SWAN  
 LOCAL AUTHORITY: SHIRE OF CHITTERING  
 ON PLAN: 125000 INT. 12431, 12432  
 Sheet No: CHITTERING 5000 EG 36 / 11.1

