

RESERVE ACTION SHEET - CONSERVATION RESERVES

RESERVE No. 45337

REASON FOR ACTION

- Creation of a Nature Reserve (↑45337), not of class A, vested in the National Parks and Nature Conservation Authority for the purpose of 'Conservation of Flora and Fauna'. Area: 152.23 ha
- The reserve was bought by CALM with assistance from the National Reserves System program of the Natural Heritage Trust and monies allocated under the State's Salinity Action Plan.
- Gazettal date: 2 September 1998 See folio: 152
- Plans at folios: 153 and 154

	OFFICER	ACTION
1	CONSERVATION ESTATE OFFICER	- Fill in above details _____ - Attach copies of gazettal notices to file _____ Send copies of gazettal notices and Map to: - Lisa Wright, Woodvale _____ - District Manager, Moora _____ - Regional Manager, Geraldton _____ To note:
2	INDEX CLERK, RECORDS	- Index reserve's name _____ - Index reserve's number _____
3	LAND ACQUISITIONS OFFICER	To note:
4	MANAGER, PLANNING & VISITOR SERVICES	To note:
5	DIRECTOR, NATURE CONSERVATION/ NATIONAL PARKS	To note:

Customer Advices for Reserve Actions
1/09/98 - 30/09/98









Shire of Moora 1/09/98 - 30/09/98

Reserve No.	Land Description	DOLA File No.	Volume/Folio	Action	Document No.	Lodge Date	Street Name	Area	Public Plans
45337	Melbourne Location 4168 on Land Administration Diagram 93570	00874-1998-01RO	3110-885	Reserve Creation for the designated purpose of "Conservation of Flora and Fauna."	G892340	02/09/98	Bulbarnet Road	152,2177 Ha	New Norcia NW (25)

CALM-MANAGED LANDS AND WATERS

AS AT 30th JUNE 1998

Legend

-  National Park
-  Conservation Park
-  Nature Reserve
-  State Forest, Timber Reserve, Freehold & Other Reserve
-  Section 5(g) Reserve
-  Leasehold in the name of the Executive Director
-  Marine Park / Marine Nat Res / Marine Management Area
-  CALM Region Boundary
-  CALM Regional Office

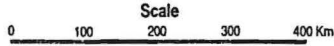

Projection: Polyconic, Origin 121°, 0°



Produced by INFORMATION MANAGEMENT BRANCH

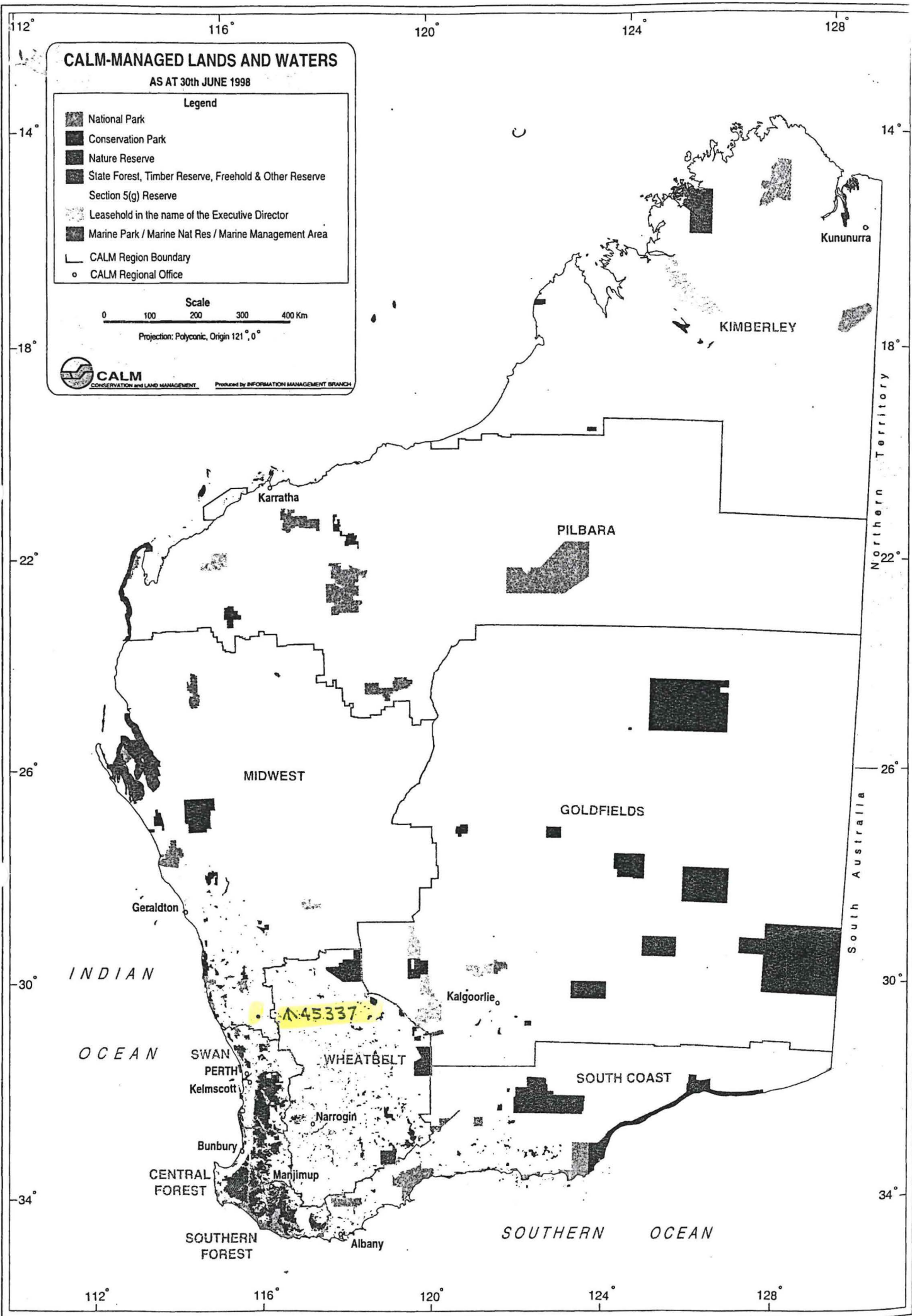

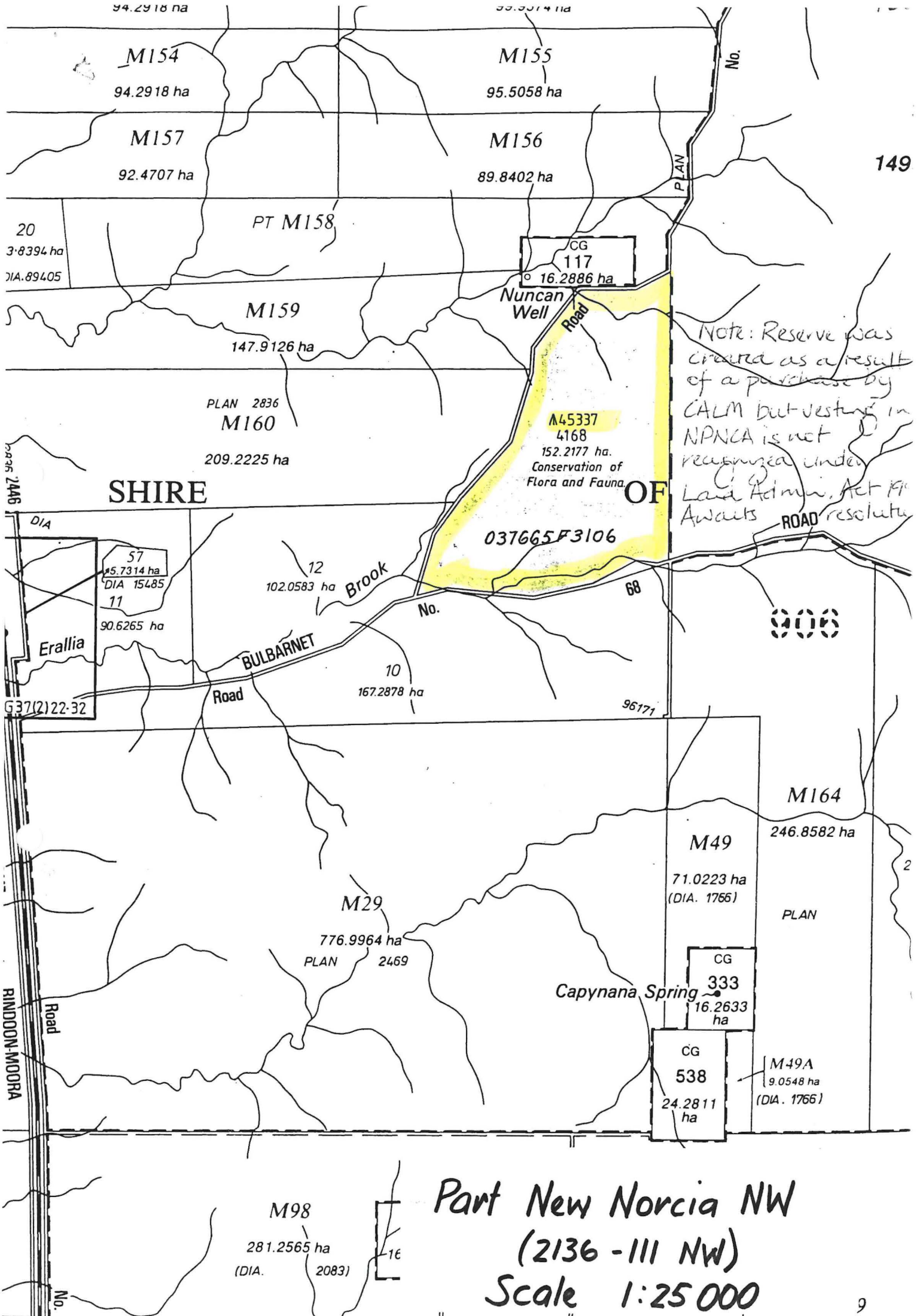

Note: Reserve was created as a result of a purchase by CALM but vesting in NPNCFA is not recognized under Land Admin. Act 1990 Awaits ROAD resolution

Part New Norcia NW
 (2136 - III NW)
 Scale 1:25 000