

## RESERVE ACTION SHEET - CONSERVATION RESERVES

**RESERVE No. 46108**

### REASON FOR ACTION

- Creation of a new reserve, vested in the NPNCA for the purpose 'Conservation of Flora and Fauna'. Area: 11.8 ha.
- The reserve was created as a result of the amalgamation of reserves 23374, 23375 (unvested, 'Public Utility'), 23376 (unvested, 'Government Requirements'), 18397 (Minister for Works, 'Government Requirements'), and the adjoining unallocated Crown land. It contains the flora species *Aponogeton hexatepalus*, which is recorded on CALM's Declared Rare Flora List.
- Date of DOLA's advice: 29 March 2000                      See folio: 139
- Plans at folios: 142-147

	OFFICER	ACTION
1	<b>CONSERVATION ESTATE OFFICER</b>	- Fill in above details _____ - Attach copies of DOLA's advice to file _____  Send copies of advice & maps to: - Lisa Wright, Woodvale _____ - District Manager, Mornington _____ - Peter Hanly, Bunbury _____ (Atten: Andrew Horan) Rec. IUCN classification: _____ <span style="float: right;">1a</span>
To note:		
2	<b>INDEX CLERK, RECORDS</b>	Index reserve's name _____ Index reserve's number _____
3	<b>LAND ACQUISITIONS OFFICER</b>	To note:
4	<b>MANAGER, PLANNING &amp; VISITOR SERVICES</b>	To note & approve IUCN classification:
5	<b>DIRECTOR, NATURE CONSERVATION/ NATIONAL PARKS</b>	To note:
6	<b>PROGRAM LEADER (TENURE)</b>	To note & update IUCN records:

**Customer Advices for Reserve Actions  
1/03/2000 - 31/03/2000**

**Shire of Dardanup 1/03/2000 - 31/03/2000**

Reserve No.	Land Description	DOLA File No.	Volume/Folio	Action	Document No.	Lodge Date	Street Name	Area	Public Plans
18397	Collie Agricultural Area Lot 62 on Land Administration Diagram 49815	04438-1989-01RO	3081-849	Reserve Cancellation "Government Requirements"	H403036	29/03/2000	South Western Highway	7354 sqm	BG 30 (2) 08.32
18397		04438-1989-01RO	3081-849	Revocation of Management Order (Minister For Works) for the designated purpose of "Government Requirements".	H403037	29/03/2000	South Western Highway	7354 sqm	BG 30 (2) 08.32
23374	Collie Agricultural Area Lot 70	06403-1951-01RO	3081-853	Reserve Cancellation "Public Utility"	H403039	29/03/2000	Wireless Road	3624 sqm	BG 30 (2) 08.32
23375	Collie Agricultural Area Lot 71	06404-1951-01RO	3081-854	Reserve Cancellation "Public Utility"	H403038	29/03/2000	South Western Highway	4529 sqm	BG 30 (2) 08.32
23376	Wellington Location 3010 on Land Administration Diagram P1112 Collie Agricultural Area Lot 72	06405-1951-01RO	3079-543	Reserve Cancellation "Government Requirements"	H403040	29/03/2000	South Western Highway	7,9272 Ha	BG 30 (2) 08.32 and 09.32
43955	Boyanup Agricultural Area Lot 441 on Office of Titles Plan 20505	02338-1995-01RO	3106-413	Amendment of Reserve to include Boyanup Agricultural Area Lot 449 (formerly Lot 7) on Office of Titles Plan 20190 and of its area being increased to 1,8484 hectares accordingly.	H390762	16/03/2000	Harold Douglas Drive	1,8484 Ha	BG 30 (10) 2.5
43955		02338-1995-01RO	3106-413	Revocation of Management Order (Shire of Dardanup) for the designated purpose of "Public Recreation".	H390761	16/03/2000	Harold Douglas Drive	1,5058 Ha	BG 30 (10) 2.5
43955		02338-1995-01RO	3110-576	Management Order to Shire of Dardanup of 1 Council Drive EATON WA To be utilised for the designated purpose of Public Recreation only for the designated purpose of "Public Recreation"	H390763	16/03/2000	Harold Douglas Drive	1,8484 Ha	BG 30 (10) 2.5
46073	Collie Agricultural Area Lot 98 on Land Administration Plan 19402 Collie Agricultural Area Lot 99 on Land Administration Plan 19402	02877-1995-01RO	3108-240	Reserve Creation for the designated purpose of "Drain".	H387205	13/03/2000	Harris Road	3578 sqm	BG 30 (10) 2.6
46108	Collie Agricultural Area Lot 62 on Land Administration Diagram 49815 Collie Agricultural Area Lot 93 on Land Administration Reserve Plan 448 Collie Agricultural Area Lot 94 on Land Administration Reserve Plan 448 Collie Agricultural Area Lot 95 on Land Administration Reserve Plan 448 Collie Agricultural Area Lot 96 on Land Administration Reserve Plan 448 Collie Agricultural Area Lot 97 on Land Administration Reserve Plan 448 Wellington Location 3010 on Land Administration Diagram P1112	01792-1992-01RO	3081-849	Reserve Creation for the designated purpose of "Conservation of Flora and Fauna".  DOLA ADVISED THAT CALM REF. IS : 031148F3103	H403042	29/03/2000	South Western Highway	11,821 Ha	BG 30 (2) 08.32 and 09.32

(A) NOTE :  
NO MENTION OF MANAGEMENT ORDER BEING ISSUED TO THE NPWA.  
WRITE NO DOLA BEFORE ADVISING THE DISTRICT / REGION OF OBTAINING PLANS FROM GREATHAM / SHARON.  
C. BATHGATE  
12/5/00.

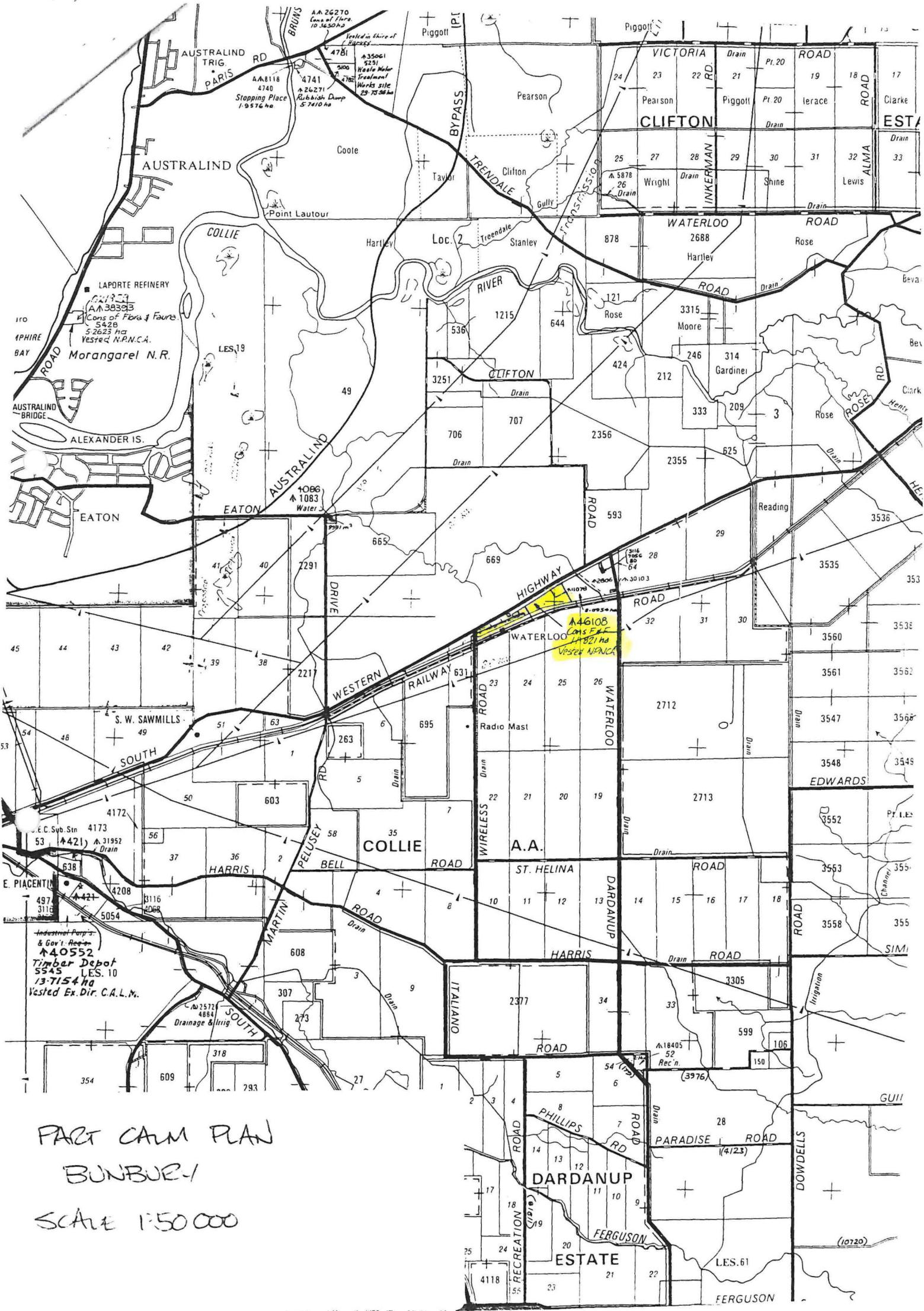









PART CALM PLAN  
 BUNBURY-1  
 SCALE 1:50 000

# CALM-MANAGED LANDS AND WATERS

AS AT 30th JUNE 1999

## Legend

-  National Park
-  Conservation Park
-  Nature Reserve
-  State Forest, Timber Reserve, Freehold & Other Reserve
-  Section 5(g) Reserve
-  Leasehold in the name of the Executive Director
-  Marine Park / Marine Nat Res / Marine Management Area
-  CALM Region Boundary
-  CALM Regional Office

Scale  
0 100 200 300 400 Km

Projection: Polyconic, Origin 121°, 0°



**CALM**  
CONSERVATION and LAND MANAGEMENT

Produced by INFORMATION MANAGEMENT BRANCH

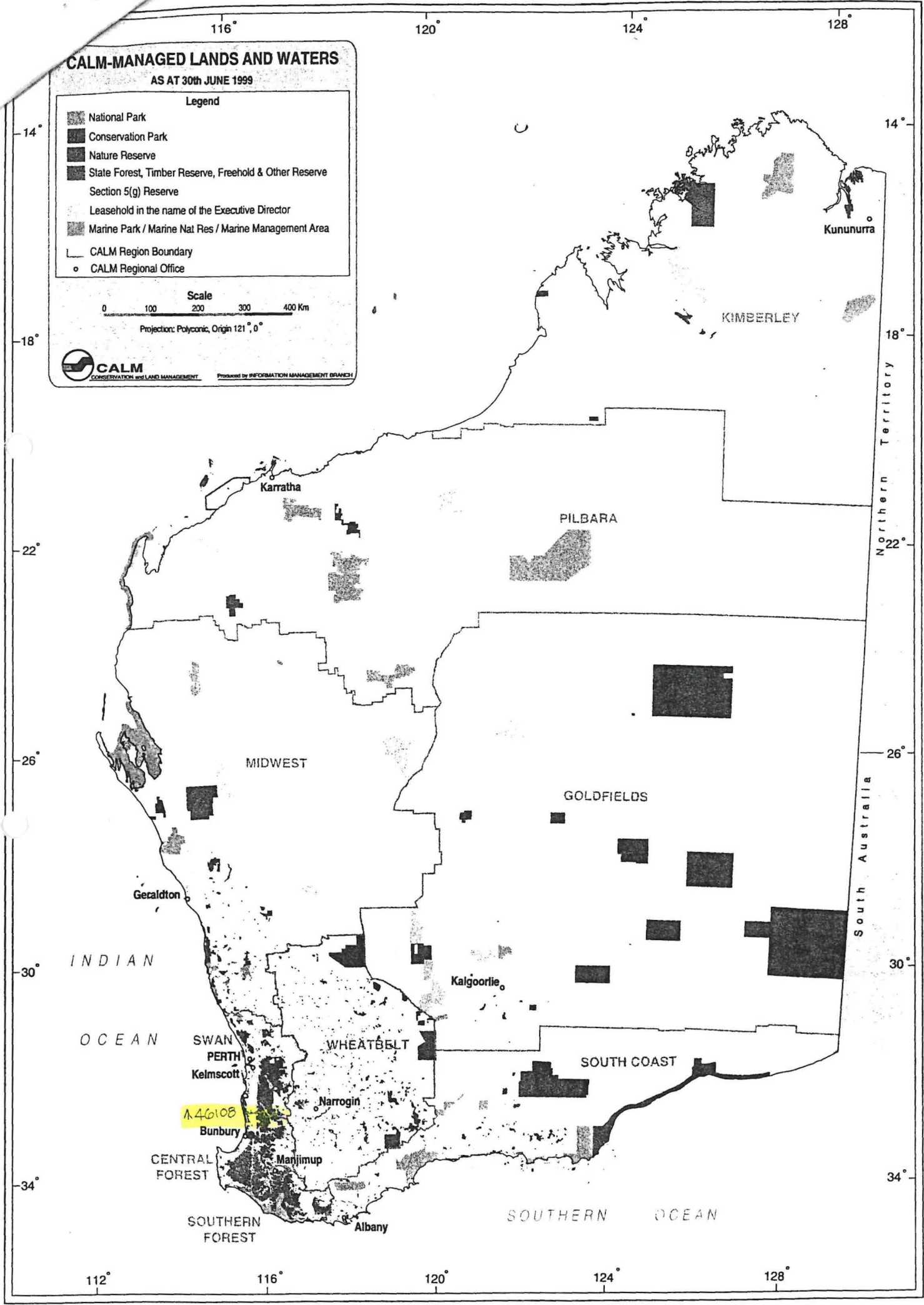

Calculated dimensions shown hereon are SUBJECT TO SURVEY  
 Includes A18397, A23374 (lot 70), A23375 (lot 71), A23376 (lot 72) and Closed Road (LTD Plan 1805)  
 Supersedes Ptn. O.P. Wellington 74

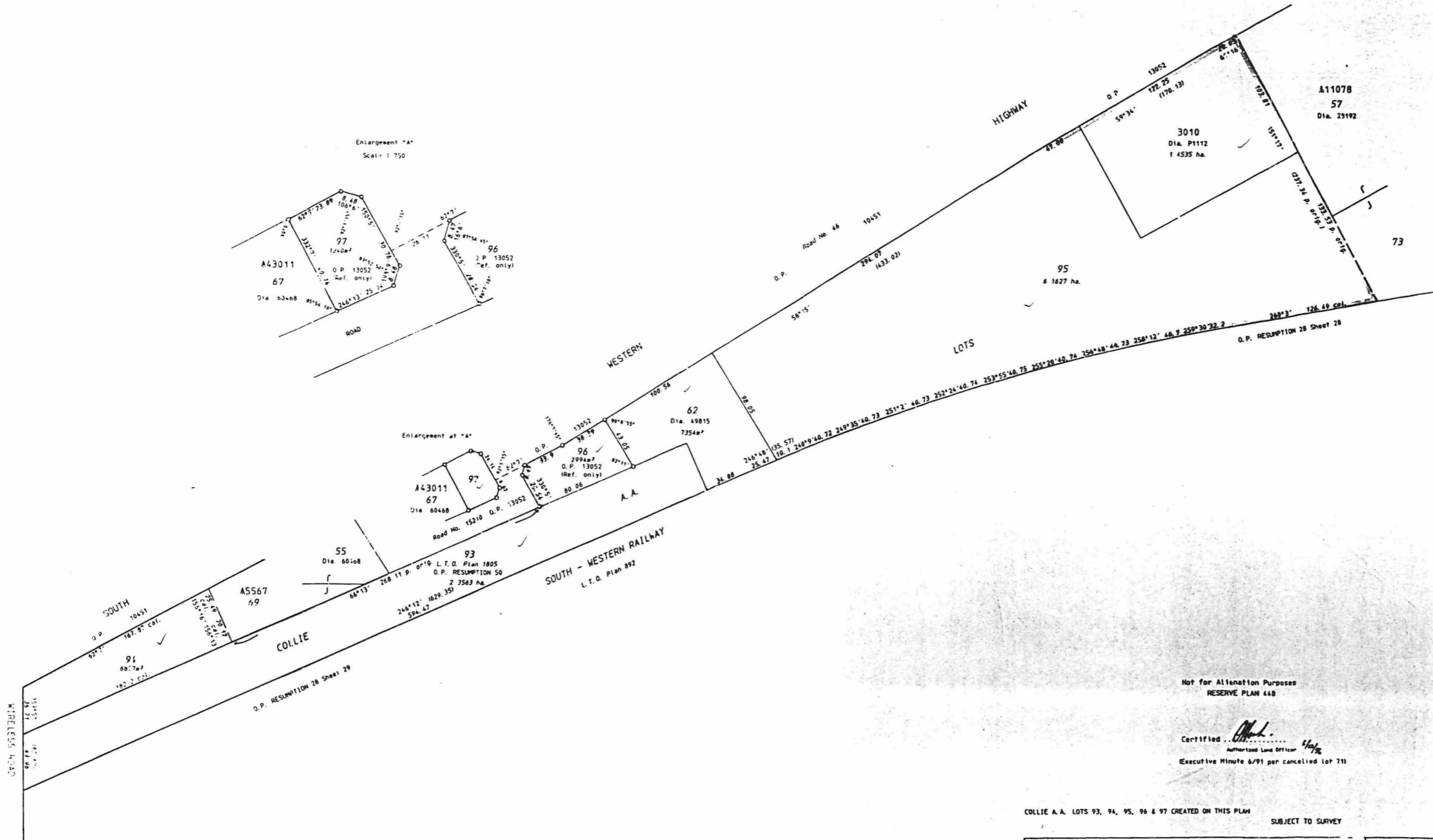

Not for Alienation Purposes  
 RESERVE PLAN 448  
 Certified *[Signature]*  
 Authorized Land Officer  
 Executive Minute 6/91 per cancelled lot 711

COLLIE A.A. LOTS 93, 94, 95, 96 & 97 CREATED ON THIS PLAN  
 SUBJECT TO SURVEY

RESERVE No	Area	11.8210 ha	FILE No.	1792/992
Purpose	Conservation of Flora & Fauna		SCALE	1:1500
DISTRICT.	WELLINGTON		Executed	EXECUTIVE MINUTE 6/91
Public Plan	RES. OF. 48 10 29 33		Recorded on Public Plan	
Prepared by	DATE	19/11/96	Registered	R.C. 12/11/96
Checked	DATE	6.12.96	On Survey Index Plan	RES. OF. 48 10 29 33
Drawn	DATE	10.12.96	DEPT. OF LAND ADMINISTRATION	
			RESERVE	
			PLAN NO. 448	

