

Customer Advices for Reserve Actions
1/02/2005 - 28/02/2005

Shire of Three Springs 1/02/2005 - 28/02/2005

Reserve No.	Land Description	DOLA File No.	Volume/Folio	Action	Document No.	Registered	Street Name	Area	Public Plans
48098	Lot 12713 on Deposited Plan 35696. Lot 1371 on Deposited Plan 82757.	00997-2002-01RO	3135-439 3135-440	Reserve Creation for the designated purpose of "Conservator of Flora and Fauna".	J186203	17/02/2005		209.447 Ha	

• TENVIS d'base amended
 • white folder "

for c/c

MOORA DIST

(1938-1)

lat -29.654666

long 115.413502

* graphics in TENVIS

for c/c

PIN 906889

1117522

CALM Tenure Information System - Report Generated on Wednesday, 11 May 2005

Page 2

Report Name: Gazettal History

Query Criteria

Crown Reserve No. = 48098

Special Comments

Crown Reserve **48098**

Class: A

Name:

Name Approval: Un-Named

Tenure: Nature Reserve

Area: 209.4 ha

Purpose: Conservation Of Flora And Fauna

Vesting: Conservation Commission Of W A

<u>Date</u>	<u>Gazettal Action</u>	<u>Description</u>
17-Feb-2005	Class	C - An Update from DOLA is pending.
17-Feb-2005	Class	A - An Update from DOLA is pending.
17-Feb-2005	Purpose	Conservation Of Flora And Fauna - An Update from DOLA is pending.
17-Feb-2005	Vesting	Conservation Commission Of W A - An Update from DOLA is pending.
17-Feb-2005	Original Gazettal	Lot 12713 On Dp 35696, Lot 1371 On Dp 82757 (209.447 ha) - An Update from DOLA is pending.

Query Criteria

Crown Reserve No. = 48098

Special Comments

Crown Reserve: 48098

Tenure: Nature Reserve

Name:

Name Approval: Un-Named
Date:

Vesting: Conservation Commission Of W A

Gazettal Date: 17-Feb-2005

Purpose: Conservation Of Flora And Fauna

Gazettal Date: 17-Feb-2005

Class: A **Gazettal Date:** 17-Feb-2005

Area: 209.45 **Gazettal Date:** 17-Feb-2005

Surveyed Status: Surveyed

CALM File: **Management Plan:**

Remark:

Notes:

Information shown must be considered in the context of the applied query criteria as detailed in full on the cover sheet.

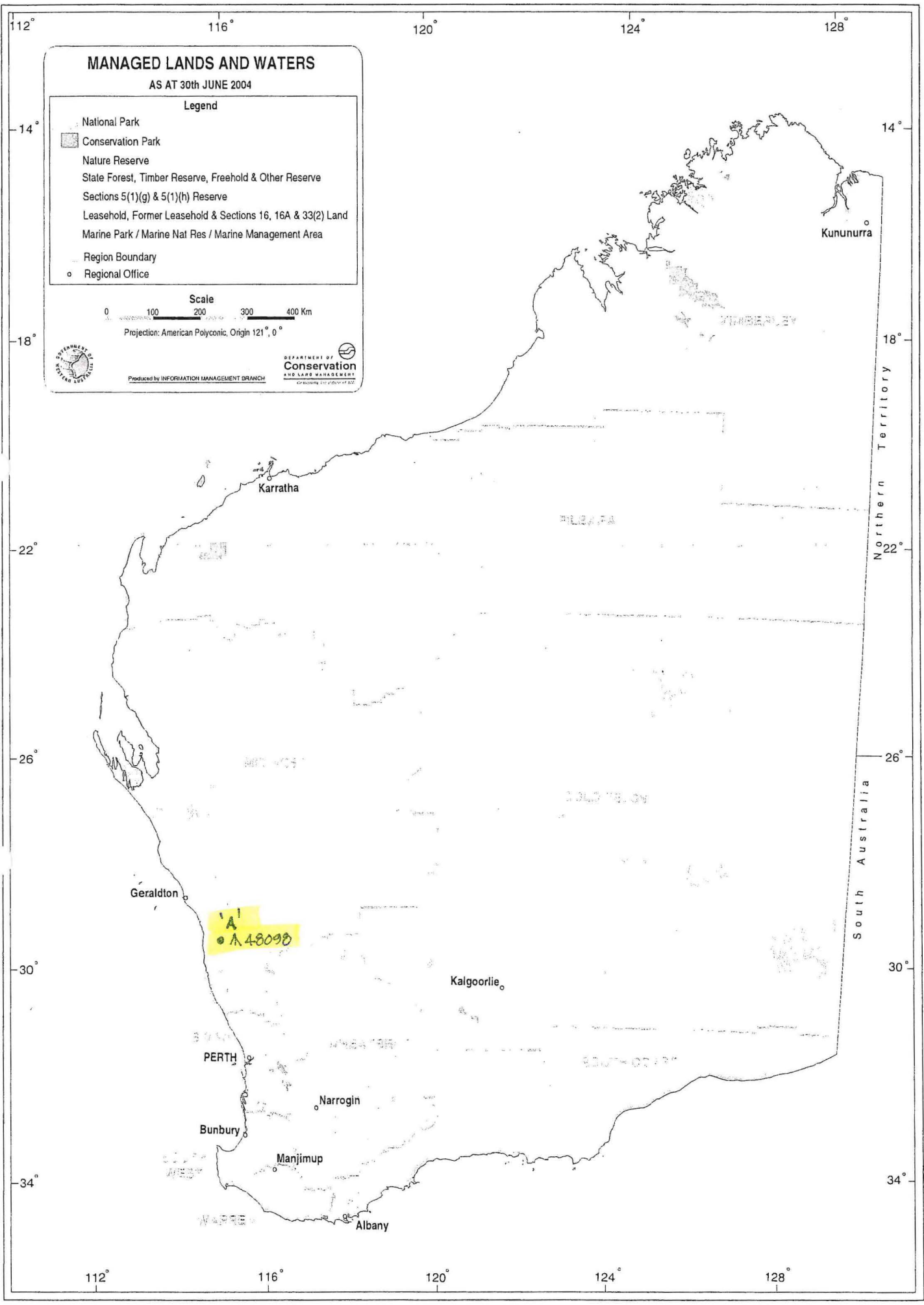

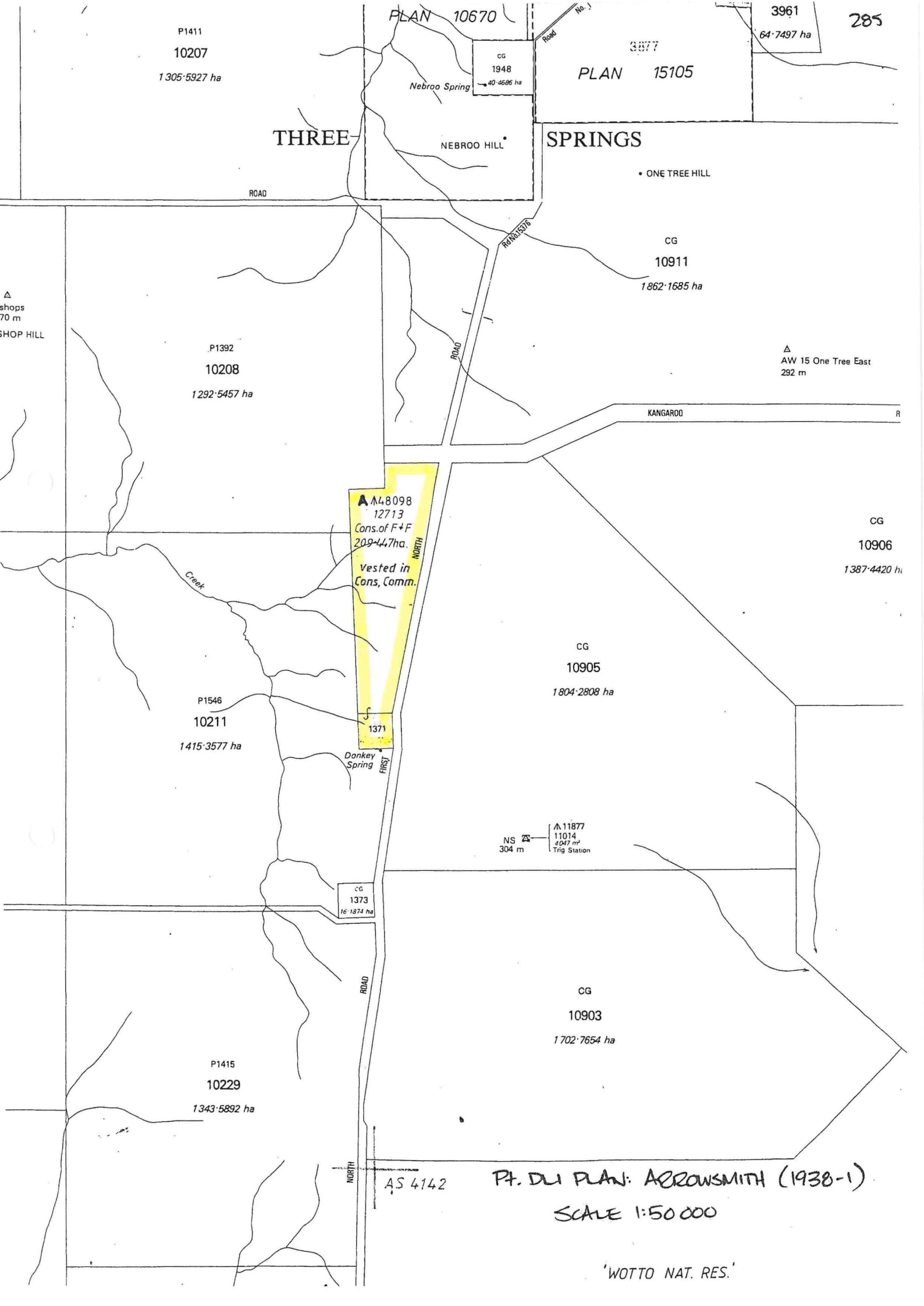

P1411
10207
1 305 5927 ha

PLAN 10670

3961
64 7497 ha

285

3877

PLAN 15105

THREE

NEBROO HILL

SPRINGS

• ONE TREE HILL

ROAD

Rd No 3376

CG

10911
1862 1685 ha

shops
70 m
SHOP HILL

P1392
10208
1 292 5457 ha

△
AW 15 One Tree East
292 m

KANGAROO

A 48098
12713
Cons. of F+F
209 447 ha
Vested in
Cons. Comm.

CG
10906

1 387 4420 ha

P1546
10211
1 415 3577 ha

CG
10905
1 804 2808 ha

1371

Donkey Spring

NS 304 m
△ 11877
11014
2 047 m²
Trig Station

CG
1373
16 1874 ha

CG
10903
1 702 7654 ha

P1415
10229
1 343 5892 ha

AS 4142

Pt. DU PLAN: ABBOWSMITH (1938-1)

SCALE 1:50 000

'WOTTO NAT. RES.'

