

**Customer Advices for Reserve Actions  
1/12/2008 - 31/12/2008**

**Shire of Gingin 1/12/2008 - 31/12/2008**

Reserve No.	Land Description	DPI File No.	Volume/Folio	Action	Document No.	Registered	Street Name	Area	Public Plans
26561	Lot 7573 on Office of Titles Plan 7703	02398-1998-01RO	3045-547	Amendment of Reserve to To now comprise Lot 7573 on Office of Titles Plan 7703 and Lot 365 on Deposited Plan 53158 and its area being increased to 12.7955 hectares.	K774119	17/11/2008	Stephens Crescent	12.7955 Ha	Guilderton 02 32.11,32.12
49994	Lot 9755 on Deposited Plan 90107 Lot 9756 on Deposited Plan 202656 Lot 9757 on Deposited Plan 149952	04093-1974-04RO	3053-517 3053-518 3053-520	Reserve Creation for the designated purpose of "Conservation Park".	K784734	27/11/2008		2772.77 Ha	29/80ch Division EF2

*Geoff Banks Tenure Section GIS Section*

*For maps please.*

*Can you please return the file to me when your action is complete.*

*AMENDED & MAPS  
PREPARED 8/10/09.*

*Starr Colliss  
22.1.09.*

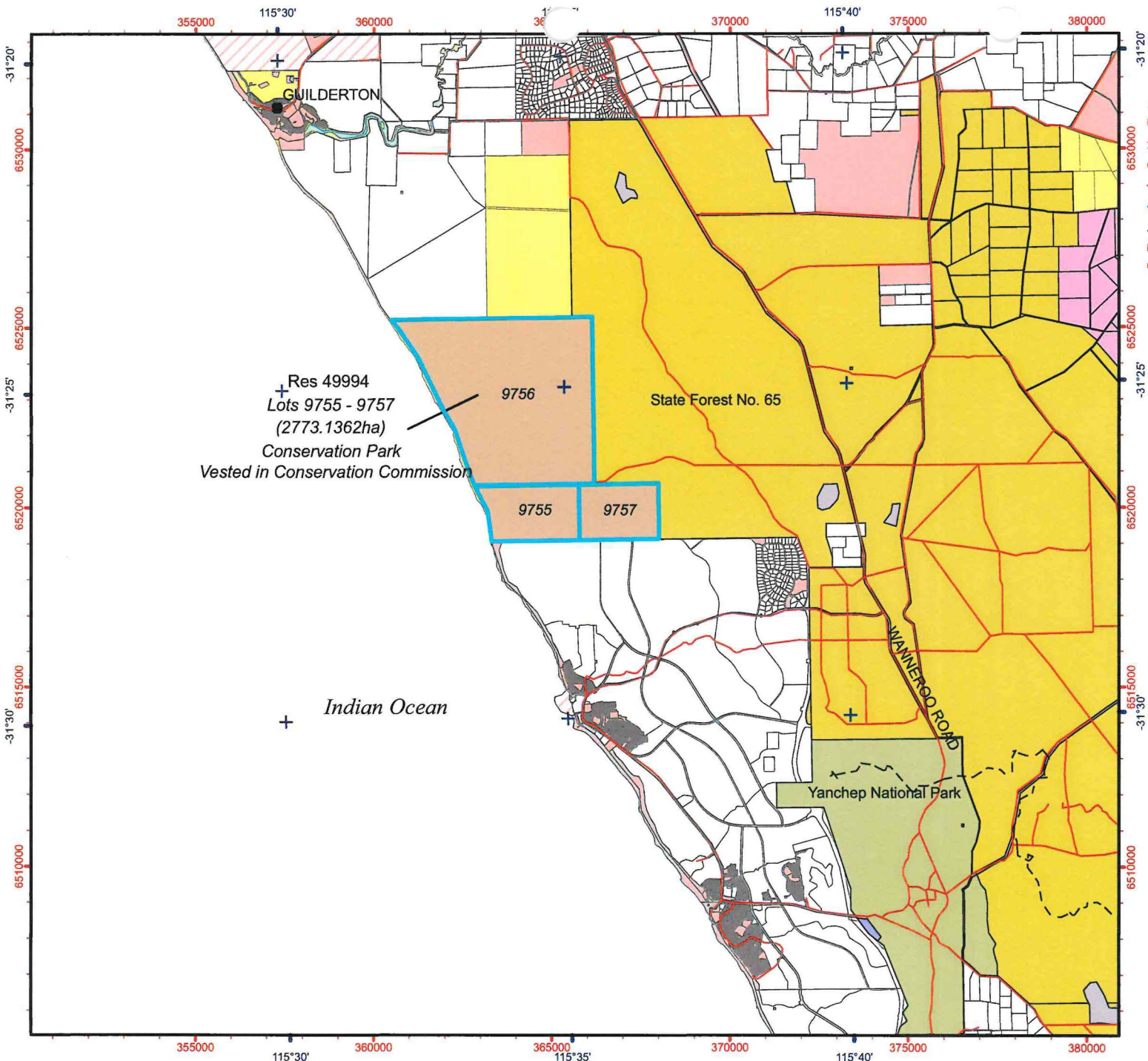

**Legend**

- WA Townsites
- SWAN Road Lines**
  - Road Bridge
  - Road Causeway
  - Road Ford
  - Road
  - Ferry Route
  - - - Foot Track
  - Road on Dam
  - Road Tunnel
- DEC Estate (statewide)**
  - 5(1)(g) Reserve
  - 5(1)(h) Reserve
  - CALM Exec Body
  - CALM Exec Body Freehold
  - Conservation Park
  - Former Leasehold
  - Marine Management Area
  - Marine Nature Reserve
  - Marine Park
  - Miscellaneous Reserve
  - National Park
  - Nature Reserve
  - State Forest
  - Timber Reserve
- PERTH OUTER Cadastre (Land Parcels)**
  - Crown Lease
  - Crown Reserve
  - Freehold
  - Lease / Reserve
  - Lease on State Forest / Timber Reserve
  - Marine Park
  - Public Roads
  - State Forest / Timber Reserve
  - Unallocated Crown Land
  - Water



1:150,000 (A4)



Projection: Universal Transverse Mercator  
MGA Zone 50. Datum: GDA94

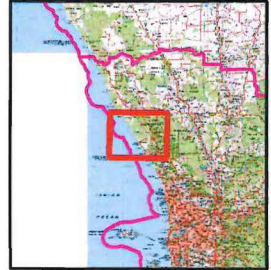

Produced under the Direction of  
Keiran McNamara  
Director General, Department of  
Environment and Conservation

Graticule shown at 5 minutes intervals  
Grid shown at 5000 metre intervals

The Dept. of Environment and Conservation does not guarantee that this map is without flaw of any kind and disclaims all liability for any errors, loss or other consequence which may arise from relying on any information depicted

Produced at 15:35pm, on October 7, 2009

1/19

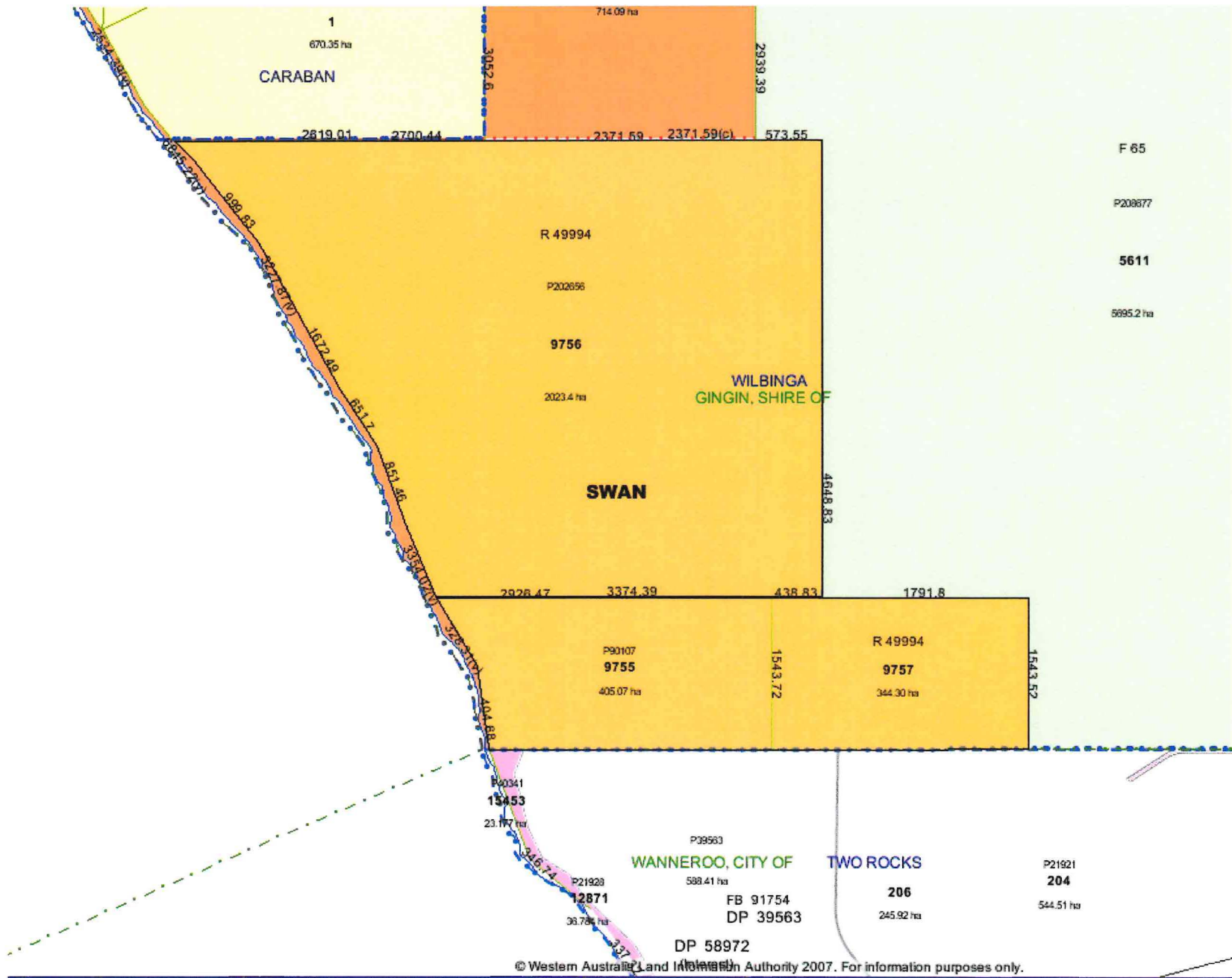



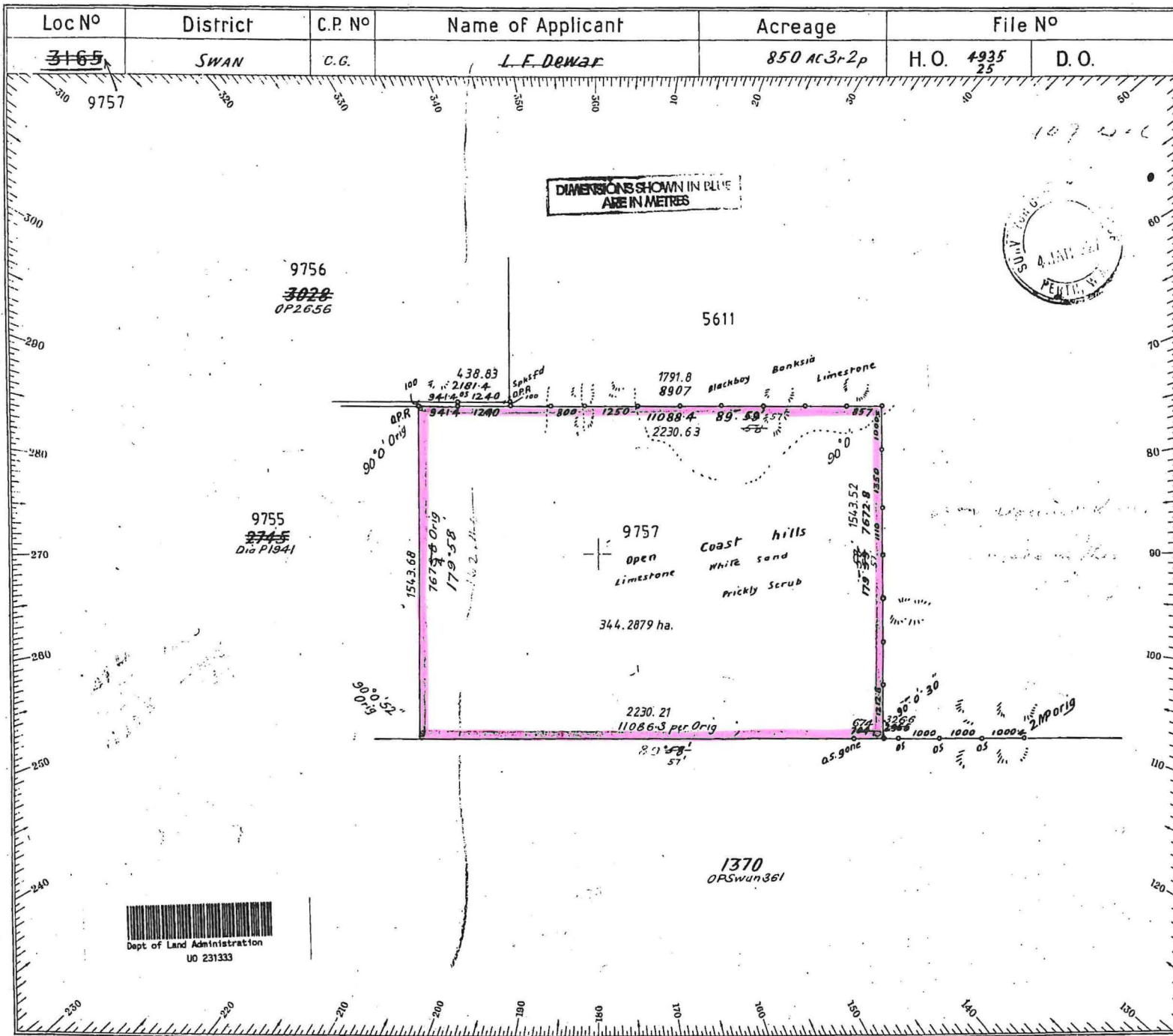

Azimuth observed at.....  
 Or assumed from..... 2745  
 Date of marking..... 28 11 1925  
 Field Book No..... 454 Page 1  
 Scale..... 20 chains to an Inch.  
 Publio Plan No..... 29/80 Division F2

REFERENCE TO TREES.				
Corner.	Bearing.	Distance in Links.	No. and Mark on Tree.	Description of Trees.
A				
B				
C				
D				
E				
F				

**SURVEYOR'S CERTIFICATE.**

I hereby certify that this Survey was performed by me personally, (or under my own personal supervision, inspection and field check) in strict accordance with the Regulations for the Guidance of Surveyors, and that this plan is in all respects accurate.

B W Ridley  
Licensed Surveyor.

Date 27.2.27

**OFFICE REFERENCE.**

Account No. 1726 Passed CR 9/27  
 Calculation Book No. 3 Fol. 35  
 Chainage close N.T. 1.0 E+2.1  
 Angular close -1.22  
 Area 850.7656 ac  
 Compared with F.B. W. H. G. 15/1/27  
 Examined  
 Diagram passed 27/2/27

Date 17/2/27  
 C. Exam Draftsman-in-charge.

Survey approved.....  
 Date 17.2.27

On D.O. Publio Plan.....  
 On Standard Plan.....  
 On Publio Plan.....  
 On Completion.....

**DIAGRAM No. 49952**

Registered.....

117

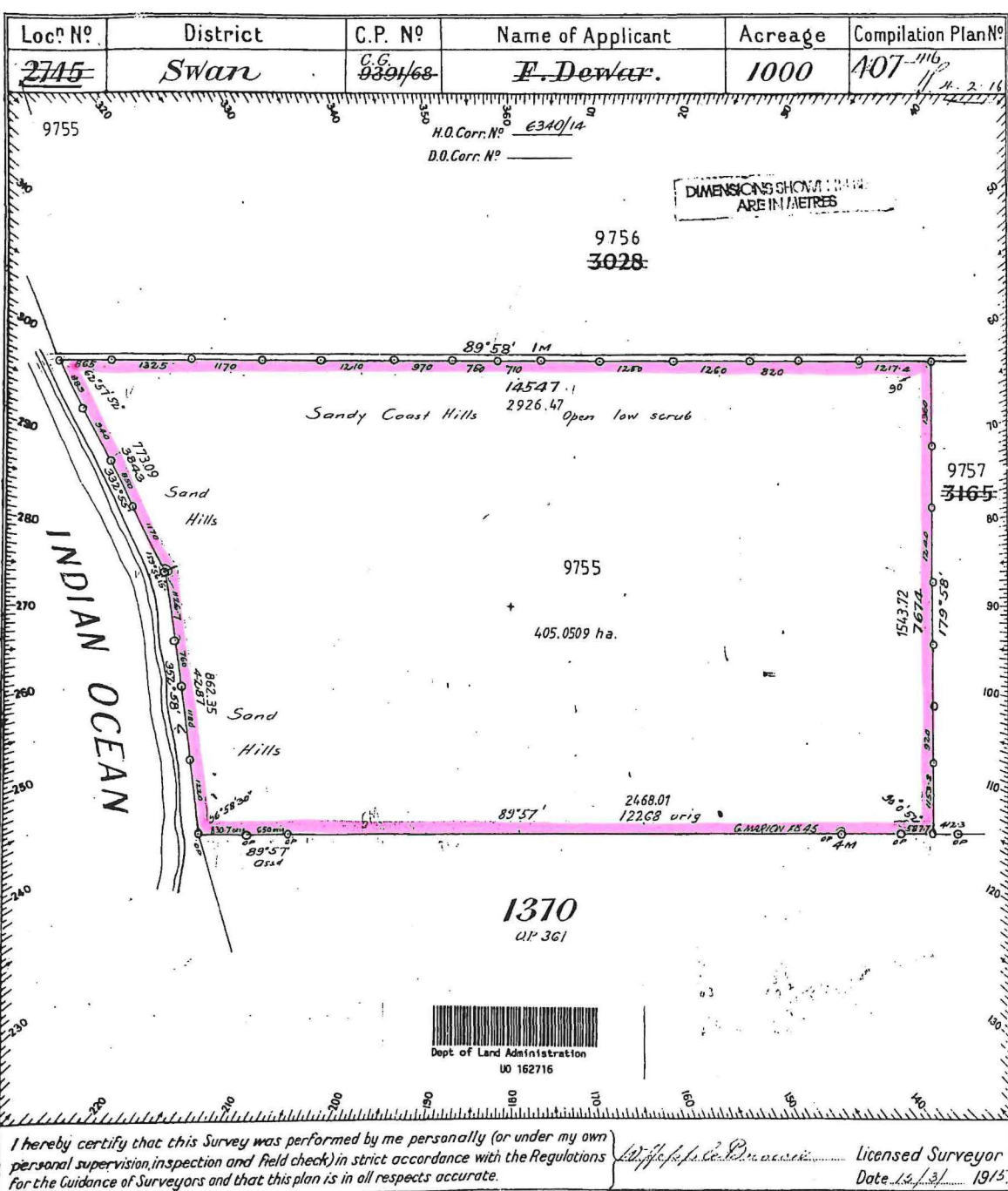

		Calculations for Area									
N <sup>o</sup> & Page of Field Book	Bearing	Distance	N	S	E	W	Multipliers	Double Areas			
127	90° 1'	14547.1		1.7	14547.0		14547			61027	
13	180° 1'	7674.2		7674.0		2.1	29091.9		2232	52008	
	270° 0'	1227.1			1227.0		16818.8				
17	333° 1'	122.7	122.56			511.2	4026.6	171	35522		
17	332° 58'	384.3	384.1			1746.9	1758.5	60	2128.0		
					14211.2			231	5687.9	2232	
			7674.7	7678.2	14347.0					731	
									2	2001	
									Acca-	1000	
										56226	
										78113	

*Azimuth observed at* \_\_\_\_\_  
*or assumed from* \_\_\_\_\_  
*Date of Marking* 23/2/1915  
*Field Book N<sup>o</sup>* 127 *Pages* 17 to 20  
*Scale* 16 Chains to an Inch  
*Working Plan N<sup>o</sup>* 29/80 *Division* E.F.2

REFERENCE TO TREES				
Corner	Bearing	Dist. in Links	N <sup>o</sup> & Mark on Tree	Description of Tree
A				
B				
C				
D				
E				
F				

**OFFICE REFERENCE**

*Account N<sup>o</sup>* 2/15 *Passed* 14/11/15  
*Calculation Book N<sup>o</sup>* P.A. Folio 69  
*Chainage Close* N.-o.1. E.+B.A.  
*Angular Close* 0'40"  
*Area* 1000.887 ac.  
*Compared with* F.B. Whitland 15/4/15  
*Examined* Whitland 15/4/15  
*Diagram passed* all full

*Or D.O. Working Plan* 29/80 *of* 14/11/15  
*Or Standard Plan* 1/15 *of* 15/11/15  
*Or Working Plan* 1/15 *of* 15/11/15

*Survey approved* \_\_\_\_\_  
*Surveyor General*  
*Date* April 21<sup>st</sup> 1915

**Diagram N<sup>o</sup>**  
**1941**

District Office	Head Office
Regd. <u>11/23/15</u>	Regd. <u>11/23/15</u>

*for District Surveyor*  
*Date* 20/4/1915

*Licensed Surveyor*  
*Date* 23/3/1915

I hereby certify that this Survey was performed by me personally (or under my own personal supervision, inspection and field check) in strict accordance with the Regulations for the Guidance of Surveyors and that this plan is in all respects accurate.





