

RESERVE ACTION SHEET: CONSERVATION RESERVES

RESERVE No. 51272

LOCAL GOVERNMENT: Shire of Dandaragan

NAME: Unnamed Conservation Park

PURPOSE: Conservation Park

VESTING: Conservation Commission of Western Australia

ACTION

Reserve creation for the purpose of "Conservation Park".

Total Area: 40.4686 hectares

REASON FOR ACTION

Freehold Lot 3860 on Deposited Plan 17663 was purchased on 12 November 2001 for addition to Leseur National Park. The Lot was identified in the *Lesueur National Park and Coomaloo Nature Reserve Management Plan* of 1995 because it would rationalise the national parks boundary. The Department of Mines and Petroleum opposed addition of the Lot to the national park because of the potential for coal and coal-seam methane. Subsequent negotiations concluded with DMP agreeing to an unclassified conservation park tenure.

Date of amendment: 19/09/2012

Maps: 32, 44

Customer advice: 35

Proposal Summary: 45-46

IUCN classification:

1	LAND UNIT LEADER	To note	BN 23/9/2013
2	LAND UNIT	Send copies of advice and maps to: <ul style="list-style-type: none"> • Lisa Wright (Kensington) DIGITAL COPY • District Manager DIGITAL COPY • Regional Manager DIGITAL COPY Attach TENIS gazettal history to file Delete from District Proposals spreadsheets Create Conservation Commission summary	BN BN BN BN BN
3	DIRECTOR PVS	To note	
4	C.I.S.	Please rename file Keyword: Conservation Estate Activity: Tenure Management Subject: Conservation Park Free text: 51272	

(MIDWEST REGION)
MOORA DISTRICT

Shire of Dandaragan 1/01/2013 - 31/01/2013

Customer Advises for Reserve Actions
1/01/2013 - 31/01/2013

(DEC FILE NO 2012/007700)

Reserve No.	Land Description	DPI File No.	Volume/Folio	Action	Document No.	Registered	Street Name	Area	Public Plans
19206	Lot 12007 on Deposited Plan 243177	02831-1925-04RO	3134-891	Amendment of Reserve to include Lots 323 and 324 on Deposited Plan 56938 and Lot 325 on Deposited Plan 56940 in lieu of Lot 12007 on Deposited Plan 243177 and its area being decreased to about 1852.6018 hectares.	M109237	2011/2012	Indian Ocean Drive	1852.6018 Ha	Junen Regional BF39 1:1000 11 & 12
24496	Lot 328 on Deposited Plan 49915 Lot 12804 on Deposited Plan 39607 Lot 12805 on Deposited Plan 39607 Lot 12806 on Deposited Plan 39607	02831-1925-04RO	3155-820 3133-27 3133-28 3133-29	Amendment of Reserve to now include Lots 320, 321, 322 and 327 on Deposited Plan 56938 in lieu of Lots 328 on 12805 and 12806 on Deposited Plan 39607 and its area being increased to about 66484.3401 hectares.	M109238	2011/2012	Indian Ocean Drive	66484.3401 Ha	Dongara SE (2B)
51272	Lot 3880 on Deposited Plan 133912	00869-2008-01RO	0000-000	Reserve Creation for the designated purpose of "Conservation Park".	M052164	19/09/2012		40.507 Ha	Smart Plan

Former purchase now 451272 M052163

NEW: CONSERVATION PARK (40.507ha)
NEAR LESUEUR NP

To ANNE GREIG (LANDUNIT),
ALL RELEVANT DATABASES INCLUDING
TENNIS AMENDED. DOCUMENTS
PLACE ON THIS FILE AT
PGS 35-44.

WHITE FOLDER - 12/6/13 RD
TENNIS - 12/6/13 RD
SHAPEFILE - 12/6/13 RD
MAPINFO - UNAVAILABLE
SINCE JAN '13

R. Donia
TENURE OFFICER
(GIS SECTION)
14/6/13.



MAP VIEWER

Landgate MAP VIEWER

Window Show/Hide

Cadastral Parcels

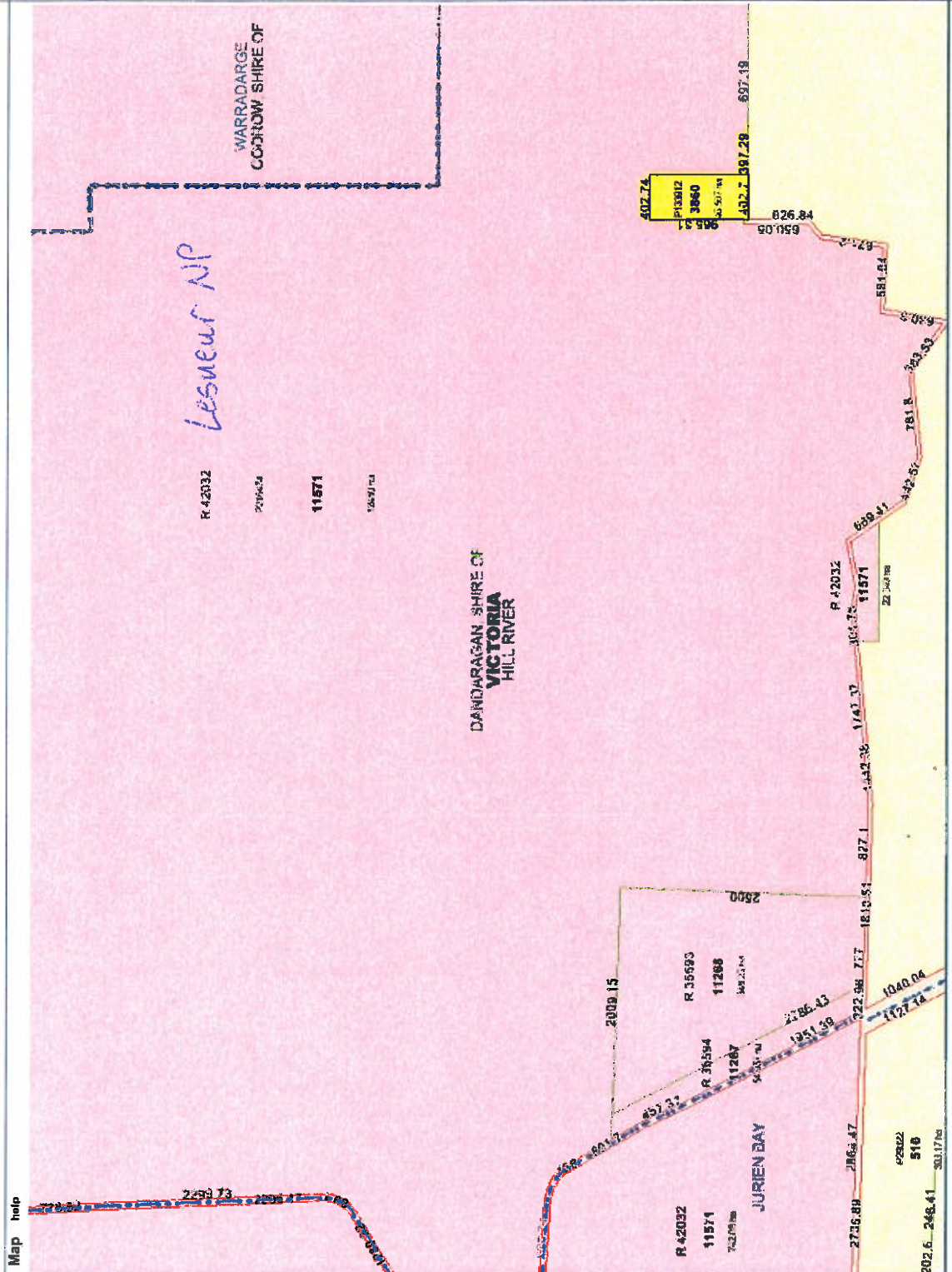

Map help

Catalogue (tick box to select) help

Property View help

Aerial Photography

Street Maps

Service Details - Property View help

Transparency

Layers Legend Search

Lot On Survey

Survey Type Deposited Plan

Survey Number 133912

Lot Number 3860

Search Type New

Submit Reset