

# RESERVE ACTION SHEET: CONSERVATION RESERVES

**RESERVE No.** A14792

**LOCAL GOVERNMENT:** Shire of Plantagenet

**NAME :** Stirling Range National Park

**PURPOSE:** National Park

**VESTING:** Conservation Commission

**ACTION**

Excision of 770 sqm for road widening of Chester Pass Road and the addition of 16,500 sqm of unconstructed Albany Lake Road to the Stirling Range National Park.

**Total Area:** 99932.3 to 115662.3ha

**REASON FOR ACTION**

The widening of Chester Pass Road required an excision from the National Park of 770 square meters. As an offset Main Roads agreed to relinquish 16,500 square meters of the Albany Lake Grace Road, an unconstructed and redundant road reserve.

On the 23 June 2011 770 square meters was excised from Stirling Range National Park and 16,500 square meters was added to the same park as an offset.

**Date of amendment:** 23/6/2011

**Maps:** 50-52

**Customer advice:** 60

**Proposal Summary:** 54

**IUCN classification:** 1a

1	<b>LAND UNIT LEADER</b>	To note	
2	<b>LAND UNIT</b>	Send copies of advice and maps to: <ul style="list-style-type: none"> <li>• Lisa Wright (Kensington) DIGITAL COPY</li> <li>• District Manager DIGITAL COPY</li> <li>• Regional Manager DIGITAL COPY</li> </ul> Attach TENIS gazettal history to file Delete from District Proposals spreadsheets Create Conservation Commission summary	3/1/12 NM 3/1/12 NM 3/1/12 N.M 3/1/12 N.M 3/1/12 N.M
3	<b>DIRECTOR, NATURE CONSERVATION</b>	To note	
4	<b>C.I.S.</b>	Please rename file/create new file  Keyword: Activity: Subject: Free text:	

Customer Advices for Reserve Actions  
1/07/2011 - 31/07/2011

(SOUTH COAST REGION)  
ALBANY DISTRICT

(DEC FILE 2009/004 221)

Shire of Plantagenet 1/07/2011 - 31/07/2011

Reserve No.	Land Description	DPI File No.	Volume/Folio	Action	Document No.	Registered	Street Name	Area	Public Plans
14792	Lot 300 on Deposited Plan 49443 Lot 2585 on Deposited Plan 141535 Lot 6978 on Deposited Plan 251326 Lot 6979 on Deposited Plan 251325 Lot 6980 on Deposited Plan 251324 Lot 7035 on Deposited Plan 172044 Lot 7255 on Deposited Plan 213326 Lot 7258 on Deposited Plan 213326 Plantagenet Location 1605 Plantagenet Location 248909 Plantagenet Location 7094	03809-1908-05RO	3136-812 3136-814 3136-816 3136-817 3136-818 3136-819 3136-821 3136-822 0000-000 0000-000 0000-000	Amendment of Reserve to include Lots 500 and 501 on Deposited Plan 66438 in lieu of Lot 6956 on Deposited Plan 248909, with the total area increased to 115662.361 hectares.	L661637	23/06/2011	Stirling Range National Park	115662.361 Ha	
14792, 14792, 14792, 14792, 14792, 14792, 14792, 14792, 14792, 14792, 14792	Lot 300 on Deposited Plan 49443 Lot 2585 on Deposited Plan 141535 Lot 6978 on Deposited Plan 251326 Lot 6979 on Deposited Plan 251325 Lot 6980 on Deposited Plan 251324 Lot 7035 on Deposited Plan 172044 Lot 7255 on Deposited Plan 213326 Lot 7258 on Deposited Plan 213326 Plantagenet Location 1605 Plantagenet Location 248909 Plantagenet Location 7094	03809-1908-05RO	3136-812 3136-812 3136-812 3136-812 3136-812 3136-814 3136-816 3136-816 3136-817 3136-818 3136-819 3136-821 3136-822 0000-000 0000-000 0000-000 0000-000	?	L661634	23/06/2011	Stirling Range National Park	115661.4357 Ha	

AREA INCREASE DUE TO ROAD REALIGNMENT  
OF CHESTER PASS ROAD (+ 0.9253ha)

WHITE FOLDER - 6/12/11  
SHAPE FILE - 6/12/11  
TENIS - 6/12/11  
MAPINFO - 6/12/11

TO: Bok Ho, ALL DATABASES INCLUDING  
TENIS HAVE BEEN AMENDED.  
ADDED RELEVANT DOCUMENTATION TO  
THIS FILE. *Raina*  
6/12/11



# Chester Pass road - Stirling Range National Park

## Legend



Projection: Universal Transverse Mercator  
MGA Zone 50. Datum: GDA94



Department of  
Environment and Conservation  
*Our environment, our future*

Produced by Land Unit  
Under the Direction of  
Kerrian McNameara  
Director General, Department of  
Environment and Conservation

Produced at 10:9am, on April 28, 2010



Chester Pass road -  
for enlargement see attachment 2

Reserve No. 14792

Reserve No. 14792

Graticule shown at 10 minutes intervals  
Grid shown at 10000 metre intervals

The Dept. of Environment and Conservation does not guarantee that this map is without flaw of any kind and disclaims all liability for any errors, loss or other consequence which may arise from relying on any information depicted

Attachment 1  
52

A



44

<p><b>LEGEND</b></p> <p>LAND REQUIRED FOR ROAD PURPOSES</p> <p>BOUNDARY TO BE SURVEYED</p> <p>ROAD TO BE CLOSED AND VESTED WITH DEPARTMENT OF ENVIRONMENT AND CONSERVATION</p>	<p><b>NOTES</b></p> <p>1 DIMENSIONS AND AREAS ARE APPROXIMATE ONLY AND ARE SUBJECT TO SURVEY</p> <p>2 S.L.K. IS M.R. STRAIGHT LINE KILOMETRE AND IS APPROXIMATE ONLY</p> <p>3 HORIZONTAL DATUM IS MGA 94</p>	<p>SCALE 1:2000</p> <p>WESTERN AUSTRALIA</p> <p>mainroads</p> <p>REGIONAL SERVICES DIRECTORATE GREAT SOUTHERN REGION ALBANY 6170 LESTERPASS RD Telephone 9322 8933 Fax 9321 8915</p> <p>PROJECT NUMBER</p> <p>DESIGN / DRAWN JS / JS</p> <p>DATE 16/10/15</p> <p>APPROVED</p> <p>ALBANY LAKE-GRACE RD M001 HONGUP SPRINGS SECTION SLK 0.1 TO SLK 66.77 LAND DEALINGS EMA 8100 TO EMA 60778 LOCAL AUTHORITY SHEET OF ROAD RESERVE 1031</p> <p>200901-058</p>
--	--	---

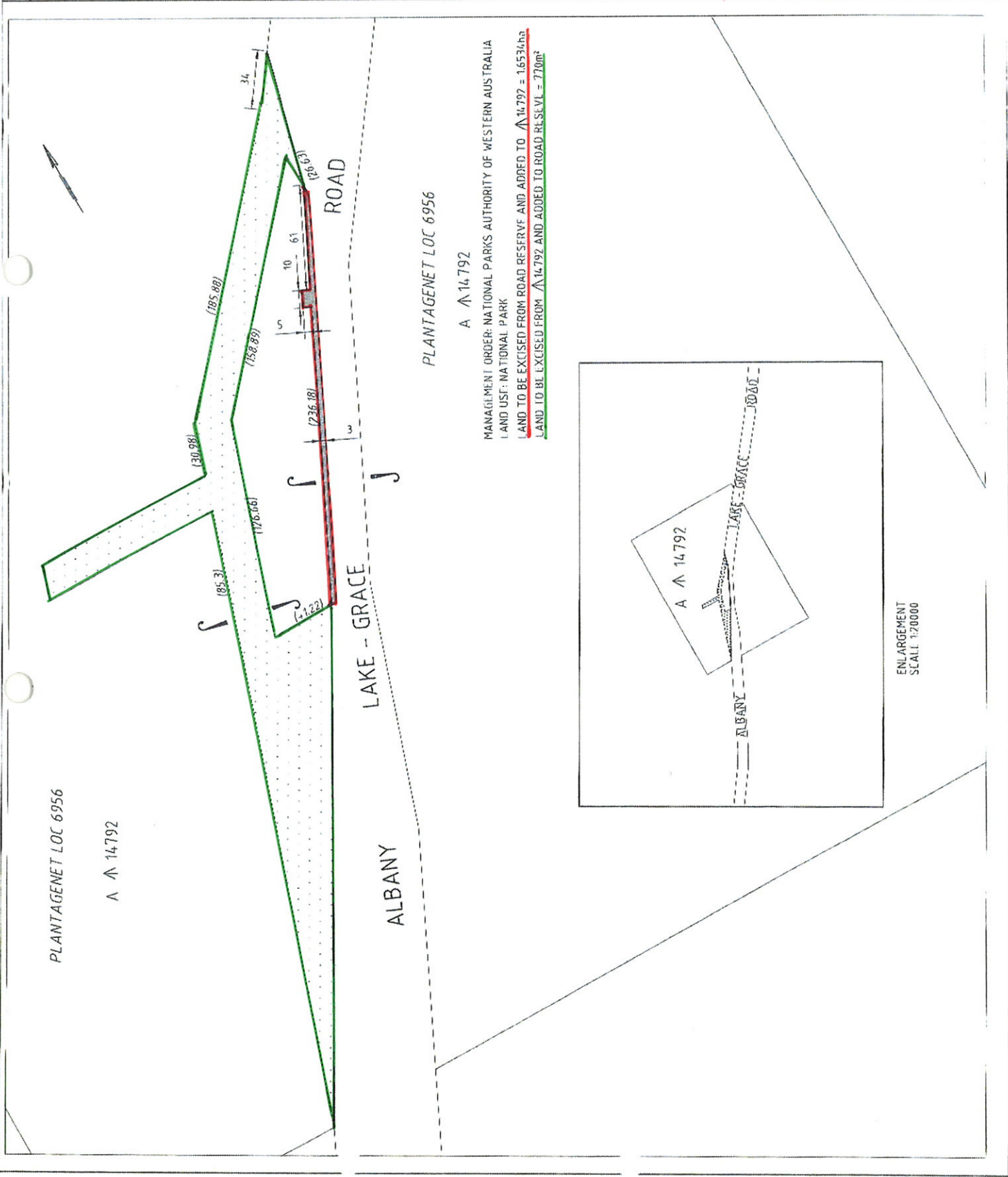



2008 CAD 7.10.08

Attachment 3  
§650

